

## GEARMOTOR MOUNTING PACKAGE & GEARMOTOR SELECTION STEPS

- Step 1:** Select a **Gearmotor Mounting Package**. For End drive conveyors, select a side, bottom, top, flush (pages 48-49). Be sure to note if it is for a **90°** or **Parallel Shaft Gearmotor**.
- Step 2:** Using **Belt Speed and Load** Requirements, determine the required **Gearmotor Type** (Light, Heavy or Standard) for your application using the chart below.
- Step 3:** Go to the set of Belt Speed Charts on page 50 and choose between the **Fixed** or **Variable Speed** chart.
- Step 4:** Go down the first column of the Belt Speed Chart and locate the required **Belt Speed** for your application. If the desired belt speed is not listed, round up to the next higher speed.  
(Dorner offers much more than just the belt speeds listed in the tables, contact the factory for complete details)
- Step 5:** From the row containing your required **Belt Speed**, check to be sure that speed is available for the **Mount Package** you chose. (End Drive Only - Top, Bottom or Side)
- Step 6:** Use the Drive / Driven Pulley Kit combination to complete your Mounting Package Part Number
- Step 7:** Note the **RPM from Gearmotor**, it will be needed to select the correct Gearmotor from the Gearmotor Chart.
- Step 8:** Reference the **Gearmotor Chart #** to locate a compatible Gearmotor Chart on pages 52-56. Be sure to select a Gearmotor Chart to match your **Gearmotor Type** (Light, Standard or Heavy) and your **Mounting Package** while meeting your electrical requirements.  
(Red = Parallel Shaft or Blue = 90°)
- Step 9:** Using the **RPM from Gearmotor** (Step 6), locate the **Part Number** for your Gearmotor from the Gearmotor Table.

	GEARMOTOR TYPE	Conveyor Load - Lbs (Kg)											
		Conveyor Load - Lbs (Kg)											
		Light Load	20 (9.1)	30 (13.6)	40 (18.2)	50 (22.7)	60 (27.3)	70 (31.8)	80 (36.4)	90 (40.9)	100 (45.5)	110 (50)	120 (54.5)
		Standard Load	10 (4.5)	20 (9.1)	30 (13.6)	40 (18.2)	50 (22.7)	60 (27.3)	70 (31.8)	80 (36.4)	90 (40.9)	100 (45.5)	110 (50)
Belt Speed - Ft/min (m/min)	Heavy Load	10 (4.5)	20 (9.1)	30 (13.6)	40 (18.2)	50 (22.7)	60 (27.3)	70 (31.8)	80 (36.4)	90 (40.9)	100 (45.5)	110 (50)	120 (54.5)
	0-15 (0-4.6)												
	16-30 (4.9-9.1)												
	31-45 (9.5-13.7)												
	46-60 (14-18.3)												
	61-75 (18.6-22.9)												
	76-90 (23.2-27.4)												
	91-110 (27.7-33.5)												
	111-130 (33.8-39.6)												
	131-150 (39.9-45.7)												
	151-175 (46-53.4)												
	176-200 (53.7-61)												
	201-225 (61.3-68.6)												
226-250 (68.9-76.2)													
251-275 (76.5-83.8)													

# 2200 MPB SERIES: GEARMOTOR MOUNTING PACKAGES

## Top Mount Package, Standard Load, 90°

Uses gearmotor type: **S**

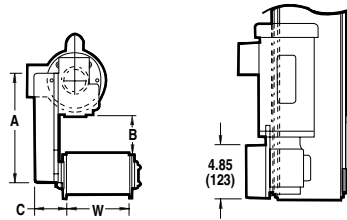

- A:** Flat Belt = 9.13" (232)  
Cleated Belt = 12.69" (322)
- B:** Flat Belt = 3.17" (81)  
Cleated Belt = 4.37" (111)
- C:** Flat Belt = 2.74" (69)  
Cleated Belt = 3.48" (88)

## Bottom Mount Package, Standard Load, 90°

Uses gearmotor type: **S**

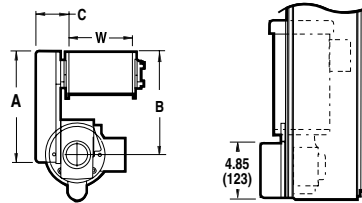

- A:** Flat Belt = 9.13" (232)  
Cleated Belt = 12.69" (322)
- B:** Flat Belt = 8.46" (215)  
Cleated Belt = 9.73" (247)
- C:** Flat Belt = 2.74" (69)  
Cleated Belt = 3.48" (88)

## Side Mount Package, Standard Load, 90°

Uses gearmotor type: **S**

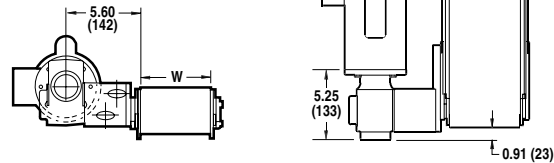

## Top Mount Package, Heavy Load, 90°

Uses gearmotor type: **H**

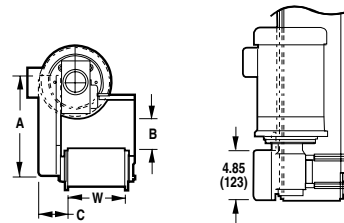

- A:** Flat Belt = 9.13" (232)  
Cleated Belt = 12.69" (322)
- B:** Flat Belt = 2.78" (71)  
Cleated Belt = 4.05" (103)
- C:** Flat Belt = 2.74" (69)  
Cleated Belt = 3.48" (88)

## Bottom Mount Package, Heavy Load, 90°

Uses gearmotor type: **H**

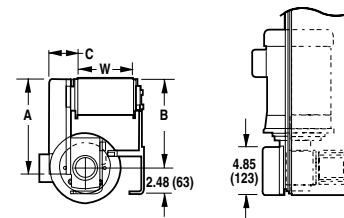

- A:** Flat Belt = 9.13" (232)  
Cleated Belt = 12.69" (322)
- B:** Flat Belt = 8.46" (215)  
Cleated Belt = 9.73" (247)
- C:** Flat Belt = 2.74" (69)  
Cleated Belt = 3.48" (88)

## 90° Gearmotor Location Options

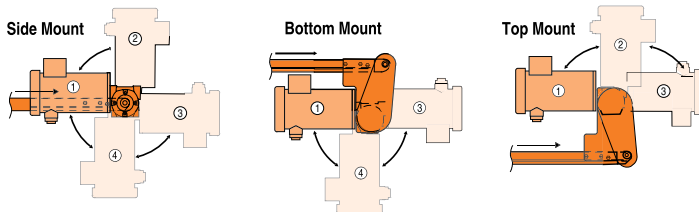

### Notes:

- Position 1 recommended
- Vertical positions 2 and 4 may require additional stabilizing bracket. Consult factory for details.
- Heavy load bottom drive cannot be mounted in Position 4

Note: Dimensions = in (mm)

For ordering information, see page 74

# 2200 MPB SERIES: GEARMOTOR MOUNTING PACKAGES

## Top Mount Package, Light Load, Parallel Shaft

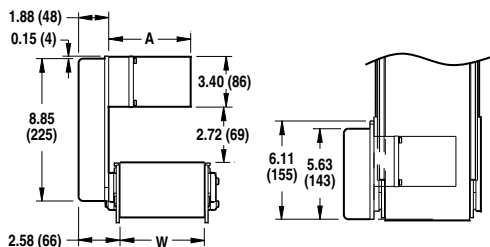

Flat Belt Models Only



Uses gearmotor type:

**L = Fixed Speed**  
**V = Variable Speed**

A: Fixed Speed and VFD Variable Speed = 4.61" (117)  
DC Variable Speed = 6.69" (170)

## Bottom Mount Package, Light Load, Parallel Shaft

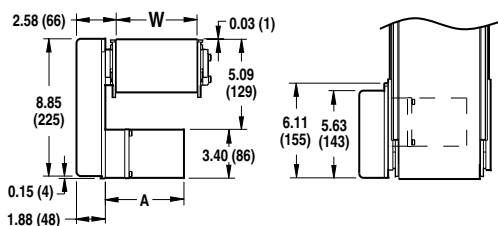

Flat Belt Models Only



Uses gearmotor type:

**L = Fixed Speed**  
**V = Variable Speed**

A: Fixed Speed and VFD Variable Speed = 4.61" (117)  
DC Variable Speed = 6.69" (170)

## Side Mount Package, Light Load, Parallel Shaft

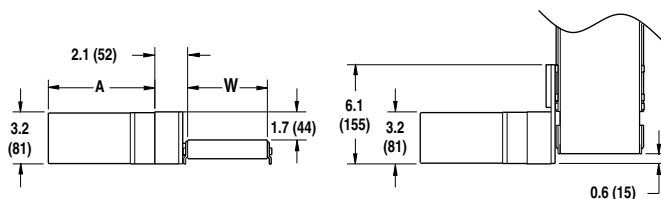

Uses gearmotor type:

**L = Fixed Speed**  
**V = Variable Speed**

A: Fixed Speed and VFD Variable Speed = 4.61" (117)  
DC Variable Speed = 6.69" (170)

## Top Mount Package, Standard Load, Parallel Shaft

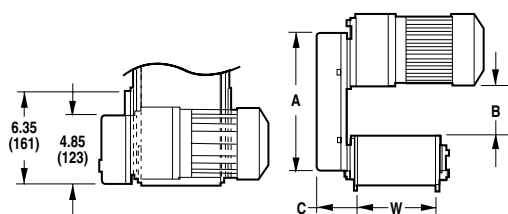

A: Flat Belt = 9.19" (234)  
Cleated Belt = 12.69" (322)  
B: Flat Belt = 3.29" (84)  
Cleated Belt = 5.09" (129)  
C: Flat Belt = 2.74" (69)  
Cleated Belt = 3.48" (88)



Uses gearmotor type: **S**

## Bottom Mount Package, Standard Load, Parallel Shaft

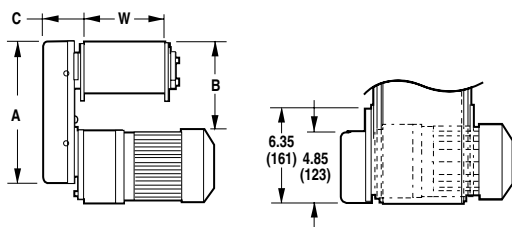

A: Flat Belt = 9.19" (234)  
Cleated Belt = 12.69" (322)  
B: Flat Belt = 5.66" (144)  
Cleated Belt = 7.47" (190)  
C: Flat Belt = 2.74" (69)  
Cleated Belt = 3.48" (88)



Uses gearmotor type: **S**

Note: Dimensions = in (mm)

For ordering information, see page 74

# 2200 MPB SERIES: BELT SPEED CHARTS

Refer to the Gearmotor Selection Steps on page 47 for instructions on using the Belt Speed Charts.

Fixed Speed									
Belt Speed		RPM From Gearmotor	Mount Package		Pulley Kit		Gearmotor Chart #		
Ft/min	m/min		Top & Bottom	Side	Drive Pulley	Driven Pulley	Light Load	Standard Load	Heavy Load
4.5	1.4	10	x		22	32		5	
6.5	2	10	x		28	28		5	
13	4.1	29	x		22	32		4, 5	12, 13
20	6.0	29	x	x	28	28		4, 5	12, 13
25	7.5	42	x		28	32	1		
28	8.6	42	x	x	28	28	1		
29	8.9	43	x	x	28	28		4	12, 13
39	11.9	58	x		28	28		5	
44	13.4	43	x		48	32		4	12, 13
45	13.6	42	x		44	28	1		
57	17.3	42	x		44	22	1		
59	17.9	86	x	x	28	28		4, 5	12, 13
 Gearmotor RPM at 50 Hz.									
11	3.3	23	x		22	32		6	
16	4.8	23	x	x	28	28		6	
24	7.4	35	x	x	28	28		6	
24	7.4	41	x		28	32	2		
28	8.5	41	x	x	28	28	2		
36	10.9	35	x		48	32		6	
44	13.3	41	x		44	28	2		
48	14.5	70	x	x	28	28		6	
56	16.9	41	x		44	22	2		
65	19.9	70	x		44	32		6	

Variable Speed									
Belt Speed		RPM From Gearmotor	Mount Package		Pulley Kit		Gearmotor Chart #		
Ft/min	m/min		Top & Bottom	Side	Drive Pulley	Driven Pulley	Light Load	Standard Load	Heavy Load
1.1 - 9	0.3 - 2.9	14	x		28	28		10	
1.3 - 13.4	0.4 - 4.1	29	x		22	32		8, 11	15, 16
2.0 - 19	0.9 - 5.9	29	x		28	28		8, 11	15, 16
2.3 - 19	0.7 - 5.9	42	x		22	32	3	7, 10	14
3.4 - 28	1 - 8.6	42	x	x	28	28	3	7, 10	14
2.9 - 29	0.9 - 8.9	43	x		28	28		8	15, 16
5.1 - 42	1.6 - 12.9	63	x	x	28	28		7	14
5.3 - 44	1.6 - 13	42	x		44	28	3	7, 10	14
6.8 - 57	2.1 - 17	83	x		28	28		10	
5.9 - 59	1.8 - 18	86	x		28	28		8, 11	15, 16
10 - 85	3 - 26	125	x	x	28	28		7, 10	14
11 - 94	3.5 - 28	139	x	x	28	28	3		
11 - 117	3.6 - 36	173	x		28	28		8, 11	15, 16
15 - 127	4.7 - 39	125	x		48	32		7, 10	14
11 - 148	5 - 45	139	x		44	28	3		
20 - 170	6 - 52	250	x	x	28	28		7, 10	14
17 - 175	5.4 - 54	173	x		48	32		8, 11	15, 16
23 - 234	7.1 - 71	345	x		28	28		8, 11	15, 16
31 - 255	9 - 77	250	x		48	32		7, 10	14
 RPM from 50 Hz. gearmotors. VFD drive at 63 max. Hz. output.									
5.4 - 13.7	1.7 - 4.2	23	x		22	32		9	
7.9 - 20	2.4 - 6.1	23	x	x	28	28		9	
11.9 - 30	3.6 - 9.1	35	x	x	28	28		9	
24 - 60	7.2 - 18	70	x	x	28	28		9	
36 - 90	11 - 27	70	x		48	32		9	
48 - 120	14 - 36	140	x	x	28	28		9	
71 - 180	22 - 55	140	x		48	32		9	
95 - 240	29 - 73	280	x	x	28	28		9	

Note: Red = Parallel Shaft, Blue = 90°