

ADJUSTABLE LANE GUIDING

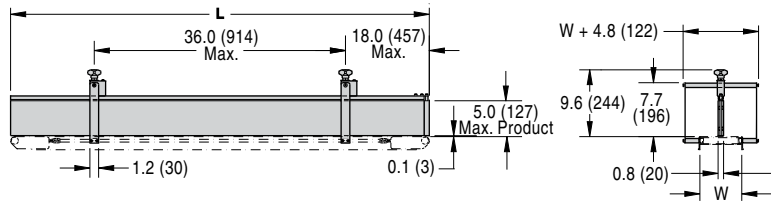

Specifications:

- UHMW guide surface on an anodized aluminum mounting rail
- Painted Steel mounting hardware
- Available in standard 1' (305 mm) increments or can be ordered to any length
- 5" (127 mm) maximum, 0.25" (7 mm) minimum part height
- 0.25" (6 mm) minimum lane width
- Package includes one lane guide, mounting hardware and adjusting knobs
- For conveyors up to 24" (610 mm) wide – Consult factory for wider lane guide availability

Features & Benefits:

- Compatible with standard Dorner bolt-on profiles
- Easily adjusts for quick product change over
- Attach additional guides to create multiple lanes
- Create lanes, plows, merges and transfers



Order additional lane kits separately

Important: Exceeding 5" (127 mm) product height will produce a pinch point.

PULLEY TRANSFER PLATE*



Specifications:

- 1.25" (32 mm) diameter minimum product transfer for 3200 Series
- Hard coat anodized finish
- Package includes extruded aluminum transfer plate, required pulley tail plates and mounting hardware

3200 Series
3" (76)
Transfer Plate

3200 Series
1" (25)
Transfer Plate

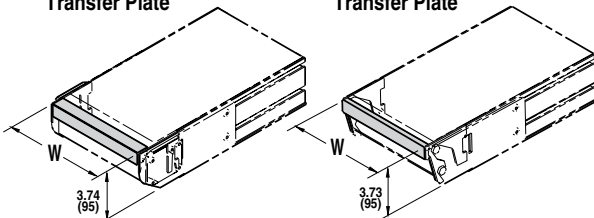

* Not compatible with clipper splice or high friction belts

Note: Dimensions = in (mm)

Due to the wide variety of drive set ups and applications, point of installation guarding is the responsibility of the end user.

For ordering information, see page 127

90° ADJUSTABLE TRANSFER

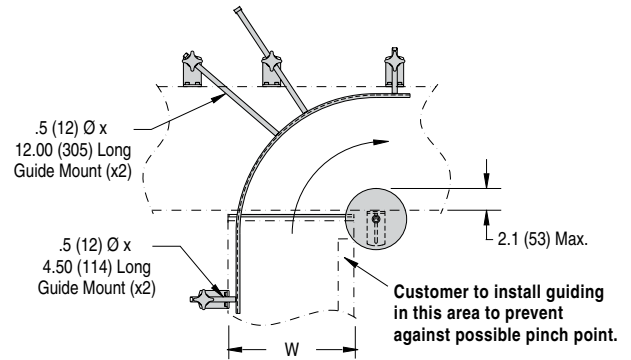
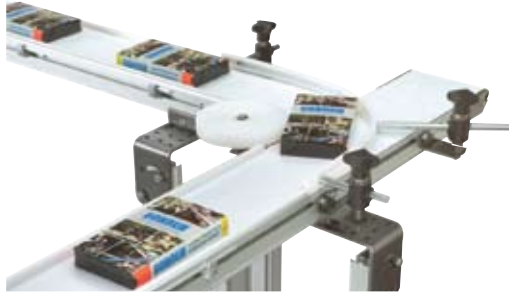

Specifications:

- For conveyors up to 12" (305 mm) wide
- Requires low side conveyors
- 0.25" (6 mm) minimum part thickness
- Hard coat anodized transfer plate
- Painted steel mounting hardware
- 48" (1,219 mm) long UHMW outside turn guide, customer can trim to fit
- Maximum recommended part weight is 20 lbs (9 kg) at 50 ft/min (15 m/min) belt speed. Consult factory regarding applications for higher product weights or faster belt speeds.
- 0.25" (32 mm) minimum product size for 3200 Series
- Package includes outside turn guide, guide wheel, adjustable mounting hardware and extruded aluminum transfer plate

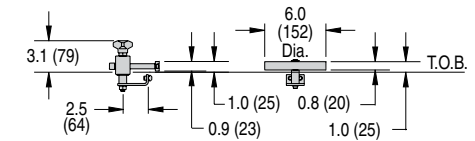

Features & Benefits:

- Pre-engineered guided turns adjust to a variety of products
- Accepts standard Dorner bolt-on profiles outside of transfer area
- Place adjusting rods where required
- Easily adjusts for quick product change-over

Note: Due to the wide variety of drive setups and applications point of installation guarding is the responsibility of the end user.

Important: Do not use with 03, 08, 55, 62, or 64 High Friction Belts on Infeed conveyor

For ordering information, see page 127

HARDWARE ACCESSORIES

Spring T-Nut

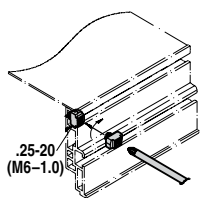

- Mounts in T-slots to attach light weight accessories
- Recommended for vertical aluminum stand T-slots

Part Number	Description
200124	Spring T-nut, 0.25 - 20
200124M	Spring T-nut, M6 - 1.0
200300	Package of 5 Spring T-nuts, 0.25 - 20
200300M	Package of 5 Spring T-nuts, M6 - 1.0

T-Slot Extenders

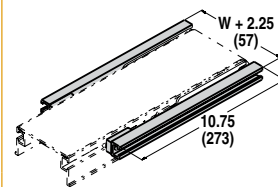

- Provides additional T-slots to the end of conveyor
- Includes mounting brackets and hardware
- Metric fasteners

Part Number	Description
307000M	T-Slot Extender, Pair

3200 & Z-frame Series T-Bars

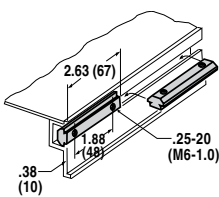

- Mounts in T-slots to attach heavy accessories
- 2.63" (67 mm) long 2 hole model, 0.75" (19 mm) 1 hole model

Part Number	Description
639971	1 hole T-bar, 0.25 - 20
639971M	1 hole T-bar, M6 - 1.0
300150	2 hole T-bar, 0.25 - 20
300150M	2 hole T-bar, M6 - 1.0

T-Slot Cover

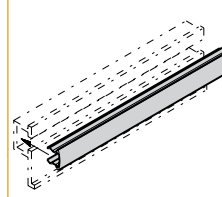

- Snaps into conveyor and aluminum stand T-slots
- Black plastic extrusion
- Can be trimmed to fit

Part Number	Description
645656P	T-Slot Cover, Per 1' (305) of length

Note: Dimensions = in (mm)

SIDE TABLES

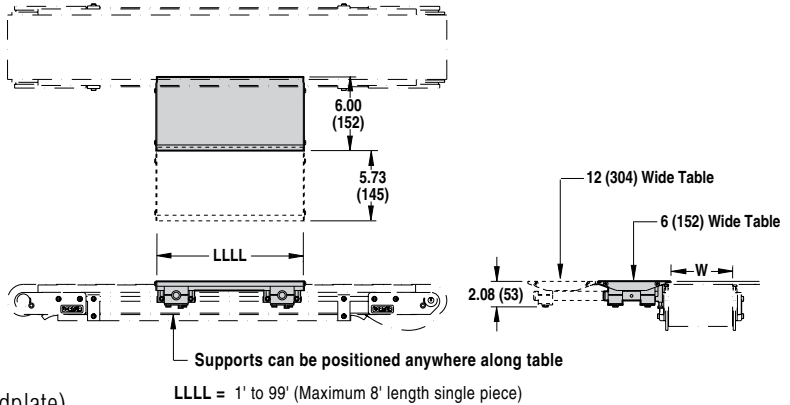

Specifications:

- Provides a 6" (152 mm) or 12" (305 mm) wide working surface
- Adjusts in/out and up/down (0.25" max above bedplate) for product transfer on/off conveyor belts
- Can be positioned anywhere along the conveyor
- Anodized aluminum work surface
- Max load: 5 lbs/ft (6 kg/m), use Adjustable Tie Brackets for added capacity
- Available in 1' (305 mm) increments from 1' (305 mm) to 99' (30,175 mm)
- Compatible with 2200, 3200 and 5200 Series Conveyors

For ordering information, see page 127

SIDE GUIDES

Flared Side Guide

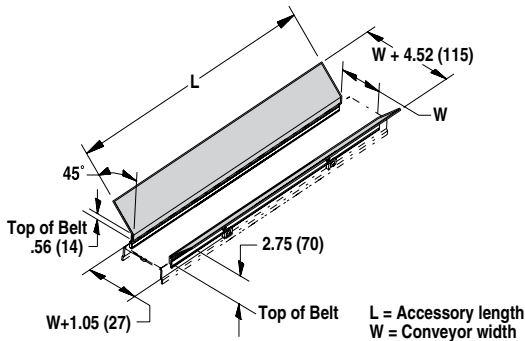

- Guides parts onto conveyor belt surface
- Includes metric mounting hardware

Part Number	Description
280802M	2' (610 mm) Flared Side
280803M	3' (914 mm) Flared Side
280804M	4' (1,219 mm) Flared Side
280805M	5' (1,524 mm) Flared Side
280806M	6' (1,829 mm) Flared Side

Note: Dimensions = in (mm)

Z-FRAME CHUTES

Z-frame Horizontal Infeed Chute

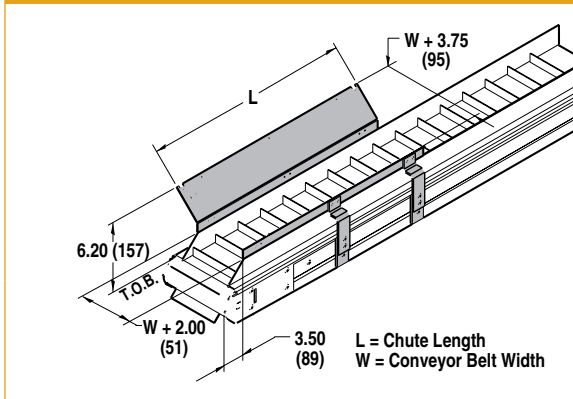

For Standard Cleated Belt Conveyors

Part Number	Description
38M501	1' (305 mm) Infeed chute, Standard Cleated, for 2' (610 mm) long section
38M502	2' (610 mm) Infeed chute, Standard Cleated, for 3' (914 mm) long section
38M503	3' (914 mm) Infeed chute, Standard Cleated, for 4' (1,219 mm) long section
38M504	4' (1219 mm) Infeed chute, Standard Cleated, for 5' (1,524 mm) long section

For Sidewall Cleated Belt Conveyors

Part Number	Description
38M601	1' (305 mm) Infeed chute, Sidewall Cleated, for 2' (610 mm) long section
38M602	2' (610 mm) Infeed chute, Sidewall Cleated, for 3' (914 mm) long section
38M603	3' (914 mm) Infeed chute, Sidewall Cleated, for 4' (1,219 mm) long section
38M604	4' (1,219 mm) Infeed chute, Sidewall Cleated, for 5' (1,524 mm) long section

Z-frame Hinged Chute Extensions

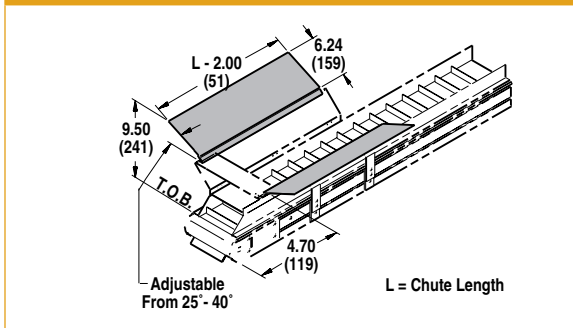

Part Number	Description
38M302	Extensions, 02' (610 mm) chute
38M303	Extensions, 03' (914 mm) chute
38M304	Extensions, 04' (1,219 mm) chute

Z-frame Backstop for Horizontal Infeed Chute

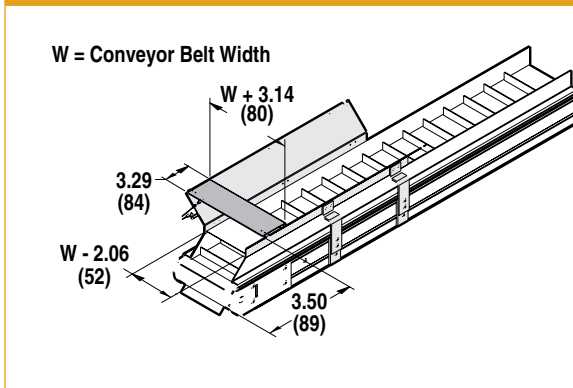

For Standard Cleated Belt Conveyors

Part Number	Description
38M108	Backstop, Standard Cleated, 08 conveyor width reference
38M112	Backstop, Standard Cleated, 12 conveyor width reference
38M118	Backstop, Standard Cleated, 18 conveyor width reference
38M124	Backstop, Standard Cleated, 24 conveyor width reference

For Sidewall Cleated Belt Conveyors

Part Number	Description
38M408	Backstop, Sidewall Cleated, 08 conveyor width reference
38M412	Backstop, Sidewall Cleated, 12 conveyor width reference
38M418	Backstop, Sidewall Cleated, 18 conveyor width reference
38M424	Backstop, Sidewall Cleated, 24 conveyor width reference

STOPS

Adjustable Stop*

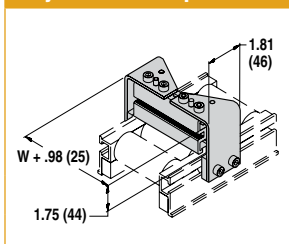

- Slides up and down T-slot length
- Includes mounting hardware

Part Number	Description
3076WWM	Adjustable Stop

3200 Series End Stop*

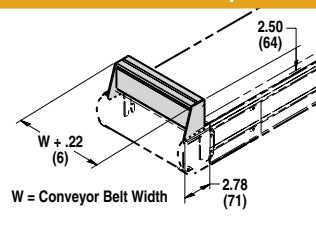

- Includes mounting hardware

Part Number	Description
3255WWM	3200 End Stop

WW = Conveyor Width Reference * Not compatible with high friction belts

BRACKETS

Adjustable Height Bracket ‡

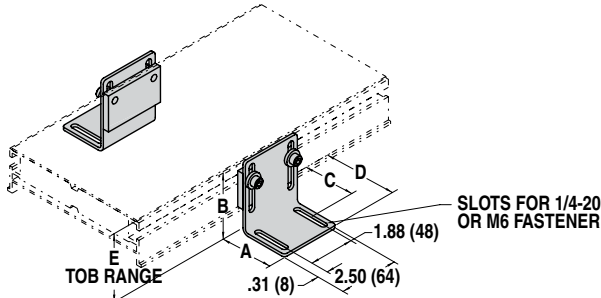

- Provides height adjustment
- (2) Height Ranges
- Includes mounting hardware

Part Number	Description	A	B	C	D	E
201557	2" x 3" Bracket	2 (51)	3 (76)	1.4 (36)	2.4 (61)	1.9 (48) to 3.4 (86)
201558	3" x 5" Bracket	3 (76)	5 (127)	2 (51)	3.4 (86)	3.3 (84) to 5.3 (135)

Table Top Mounting Bracket ‡

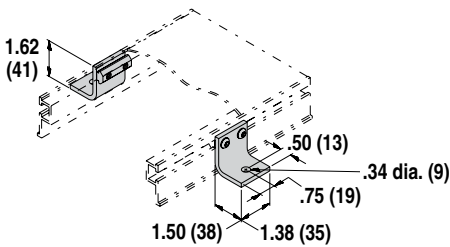

- Includes metric mounting hardware

Part Number	Description
200349M	Table top bracket

‡ = If the discharge end of conveyor is mounted over a table or similar structure, the customer must provide guiding to prevent against possible pinch point.

Frame Mount Casters

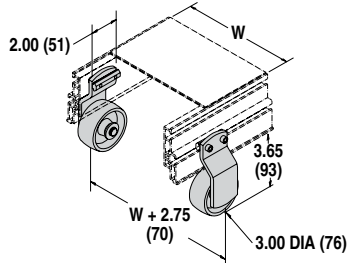

- Includes metric mounting hardware

Part Number	Description
390207	Frame mount casters, pair

Floor Mount Brackets

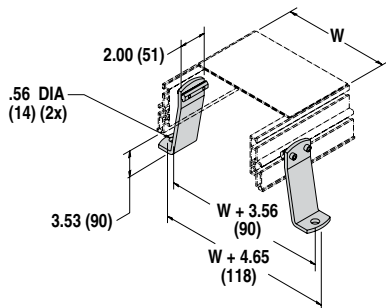

- Includes metric mounting hardware

Part Number	Description
390217	Floor mount brackets, pair

WW = Conveyor Width Reference

Note: Dimensions = in (mm)