



# 2200 Series Roller Conveyor

## Installation, Maintenance & Parts Manual



DORNER MFG. CORP.  
P.O. Box 20 • 975 Cottonwood Ave.  
Hartland, WI 53029-0020 USA

INSIDE THE USA  
TEL: 1-800-397-8664  
FAX: 1-800-369-2440

OUTSIDE THE USA  
TEL: 262-367-7600  
FAX: 262-367-5827

For other service manuals visit our website at:  
[www.dorner.com/service\\_manuals.asp](http://www.dorner.com/service_manuals.asp)

---

# Table of Contents

---

Introduction .....	2	Install End Stop .....	6
Warnings - General Safety .....	3	Preventive Maintenance and Adjustment .....	7
Product Description .....	4	Roller Replacement .....	7
Specifications .....	4	Service Parts .....	8
Models: .....	4	2200 Roller Conveyor .....	8
2200 Series Roller Conveyor .....	4	Connecting Hardware .....	9
Conveyor Supports: .....	4	Fixed End Stop .....	10
Maximum Distances: .....	4	-04 3" (76 mm) Aluminum Side .....	11
Specifications: .....	5	-05 1.5" (38 mm) Aluminum Side .....	12
Roller Quantity / Load Capacity .....	5	-09 0.5" (12 mm) Aluminum Side .....	13
Installation .....	6	-10 0.5" (12 mm) Extruded Plastic Side .....	14
Required Tools .....	6	-13 Adjustable Guiding .....	15
Recommended Installation Sequence .....	6	-14 Tool-Less Adjustable Guiding .....	16
Install Support Stands .....	6	Notes .....	17
Connecting Conveyors .....	6	Return Policy .....	18

---

## Introduction

---

Upon receipt of shipment:

- Compare shipment with packing slip. Contact factory regarding discrepancies.
- Inspect packages for shipping damage. Contact carrier regarding damage.
- Accessories may be shipped loose. See accessory instructions for installation.

Dorner's Limited Warranty applies.

Dorner has convenient, pre-configured kits of Key Service Parts for all conveyor products. These time saving kits are easy to order, designed for fast installation, and guarantee you will have what you need when you need it. Key Parts and Kits are marked in the Service Parts section of this manual with the Performance Parts Kits logo .

Dorner reserves the right to make changes at any time without notice or obligation.

## Warnings - General Safety

### WARNING

The safety alert symbol, black triangle with white exclamation, is used to alert you to potential personal injury hazards.

### DANGER



Climbing, sitting, walking or riding on conveyor will cause severe injury. **KEEP OFF CONVEYORS.**

### DANGER



**DO NOT OPERATE CONVEYORS IN AN EXPLOSIVE ENVIRONMENT.**

### WARNING



Exposed moving parts can cause severe injury. **LOCK OUT POWER** before removing guards or performing maintenance.

### WARNING



Dorner cannot control the physical installation and application of conveyors. Taking protective measures is the responsibility of the user.

When conveyors are used in conjunction with other equipment or as part of a multiple conveyor system, **CHECK FOR POTENTIAL PINCH POINTS** and other mechanical hazards before system start-up.

### WARNING



Loosening stand height or angle adjustment screws may cause conveyor sections to drop down, causing severe injury.

**SUPPORT CONVEYOR SECTIONS PRIOR TO LOOSENING STAND HEIGHT OR ANGLE ADJUSTMENT SCREWS.**

# Product Description

Refer to Figure 1 for typical components.

- |   |                                   |
|---|-----------------------------------|
| 1 | Conveyor                          |
| 2 | Profiles (3" Aluminum Side Shown) |
| 3 | End Stop                          |
| 4 | Stands                            |

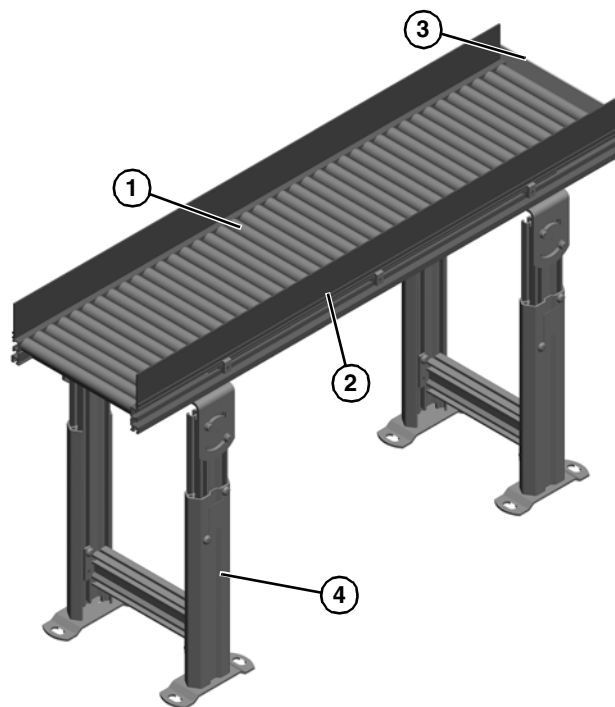
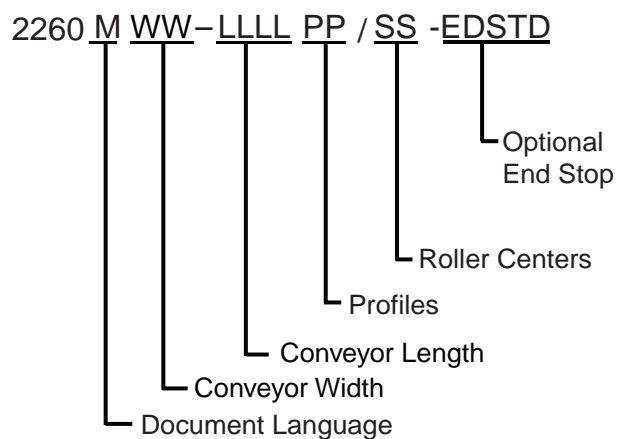

Figure 1

## Specifications

### Models:

#### 2200 Series Roller Conveyor



### Conveyor Supports:

#### Maximum Distances:

1 = 18" (457 mm)

2 = 6 ft (1829 mm)\*\*\*

3 = 18" (457 mm)

\*\*\* For conveyors longer than 12 ft (3658 mm), install support at joint.

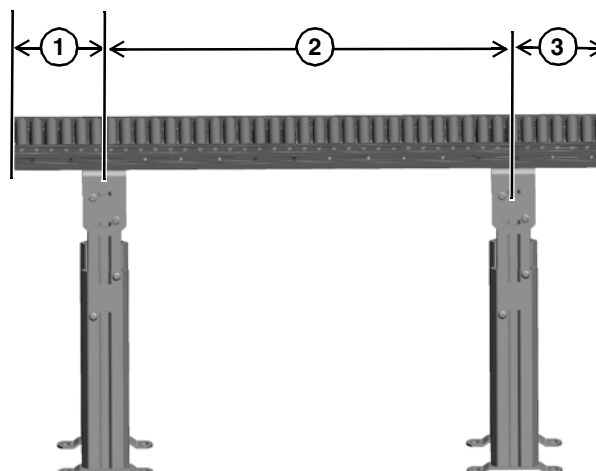

Figure 2

# Specifications

## Specifications:

Conveyor Width Reference (WW)	06	12	18	24
Conveyor Belt Width	6" (152 mm)	12" (304 mm)	18" (457 mm)	24" (609 mm)
Conveyor Roller Width (inch)	5" (127 mm)	11" (279 mm)	17" (431 mm)	23" (584 mm)
Conveyor Length Reference (LLLL)	0200	0050 increments up to 1200		
Conveyor Length (Feet)	2 ft	0.50 feet increments up to 12 ft		
Roller Center Reference (SS)	12	24	36	
Roller Centers (inch)	1.2" (30 mm)	2.4" (60 mm)	3.6" (91 mm)	

## Roller Quantity / Load Capacity

### NOTE

*It is recommended that 3 rollers be in contact with the part at all times.*

Length (ft)	Roller Centers					
	1.2" (30 mm)		2.4" (60 mm)		3.6" (91 mm)	
	# of Rollers	Load Capacity (lbs/ft)	# of Rollers	Load Capacity (lbs/ft)	# of Rollers	Load Capacity (lbs/ft)
2	20	80	11	50	8	40
3	30	80	16	50	12	40
4	40	80	21	50	16	40
5	50	80	26	50	20	40
6	60	80	31	50	24	40
7	70	80	36	50	28	40
8	80	80	41	50	32	40
9	90	80	46	50	36	40
10	100	80	51	50	40	40
11	110	80	56	50	44	40
12	120	80	61	50	48	40

# Installation

## Required Tools

- Hex-key wrenches:  
4 mm, 5 mm

## Recommended Installation Sequence

- Install support stands
- Connecting Conveyors (if required)
- Install end stop (if required)

## Install Support Stands

1. Insert mounting nuts (**Figure 3, item 1**) into the bottom t-slots on the conveyor (**Figure 3, item 2**).

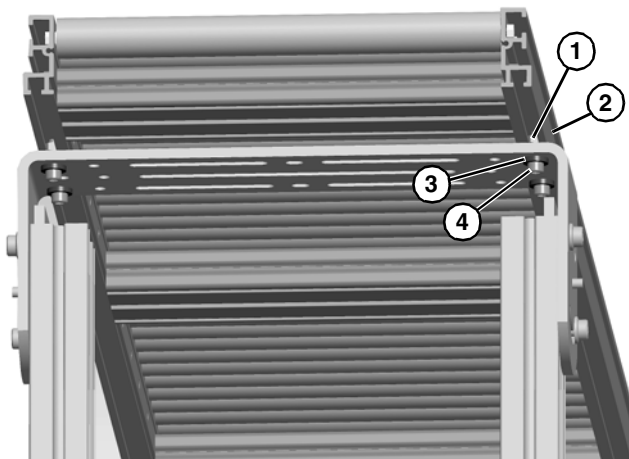

**Figure 3**

2. Attach stands to the bottom of the conveyor frame using four washers (**Figure 3, item 3**) and screws (**Figure 3, item 4**) for each stand.

## Connecting Conveyors

### NOTE

*Support stand is required at frame connection.*

3. Insert t-bars (**Figure 4, item 1**) into conveyor t-slots (**Figure 4, item 2**) on each side of conveyor.

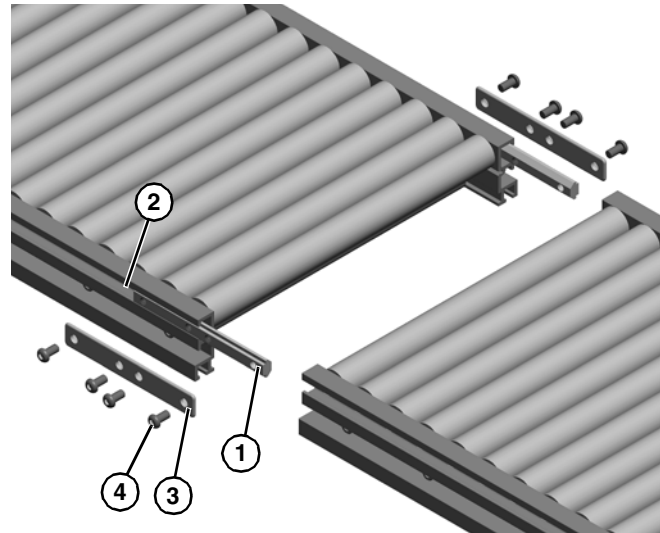
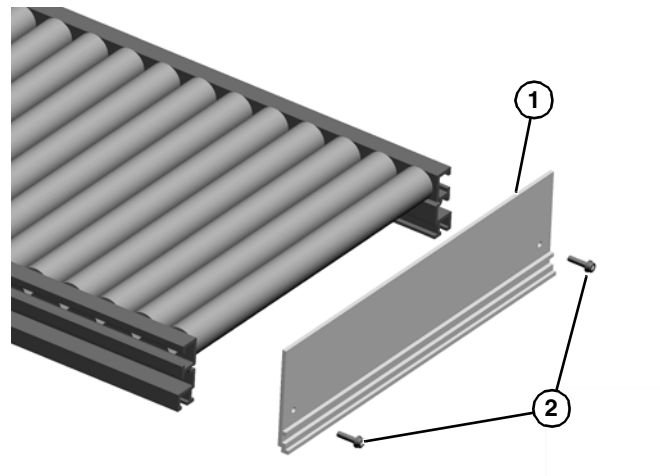

**Figure 4**

4. Attach clamp plate (**Figure 4, item 3**) with four screws (**Figure 4, item 4**) on each side of conveyor.

## Install End Stop

1. Attach the flat side of the end stop (**Figure 5, item 1**) to the conveyor with two screws (**Figure 5, item 2**).



**Figure 5**

## Roller Replacement

1. Compress end (**Figure 6, item 1**) of roller and remove male hex end (**Figure 6, item 2**) from the conveyor female hex end (**Figure 6, item 3**).

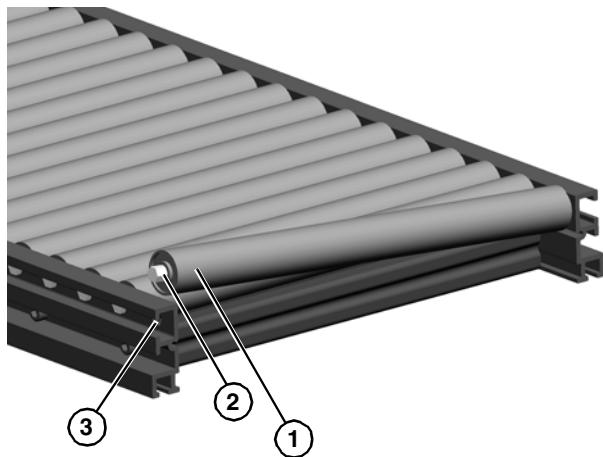

*Figure 6*

# Service Parts

## NOTE

For replacement parts other than those shown in this section, contact an authorized Dorner Service Center or the factory. Key Service Parts and Kits are identified by the Performance Parts Kits logo . Dorner recommends keeping these parts on hand.

## 2200 Series Roller Conveyor

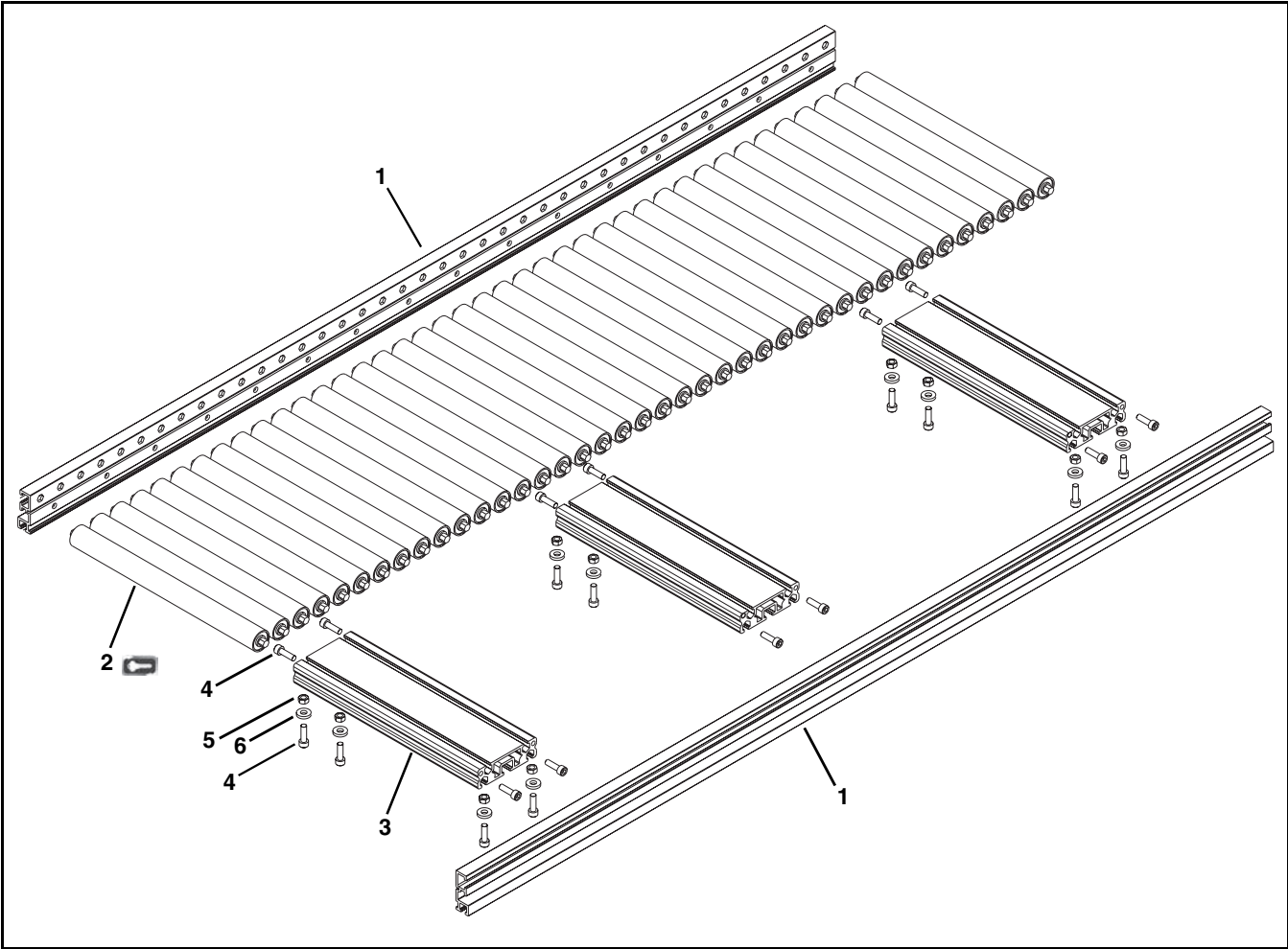

Item	Part Number	Description
1	202646- <u>LLLL</u>	Side Rail
2	202664- <u>WW</u>	Roller
3	202665- <u>WW</u>	Crossmember
4	920620M	Socket Head Screw, M6-1.00 x 20 mm
5	990601M	Hex Nut
6	605279P	Washer
<u>LLLL</u> = Part length in inches with 2 decimal places		
Example: Part Length = 35.25" <u>LLLL</u> = 03525		
<u>WW</u> = Conveyor width reference: 06, 12, 18, 24		



**Connecting Hardware**

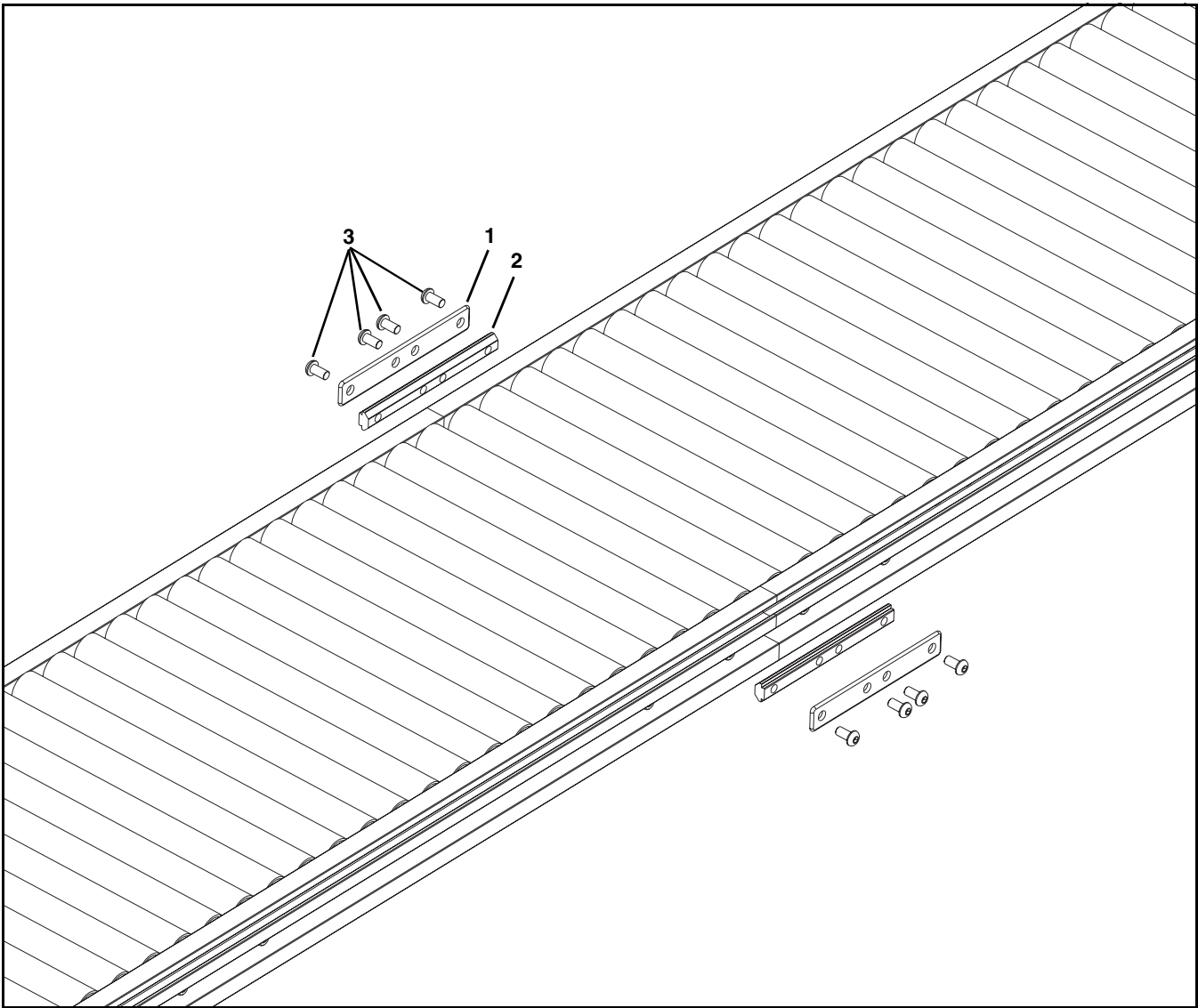

Item	Part Number	Description
1	300153M	Clamp Plate
2	300429M	T-Bar
3	910612M	Button Head Screw, M6-1.00 x 12 mm

# Service Parts

## Fixed End Stop

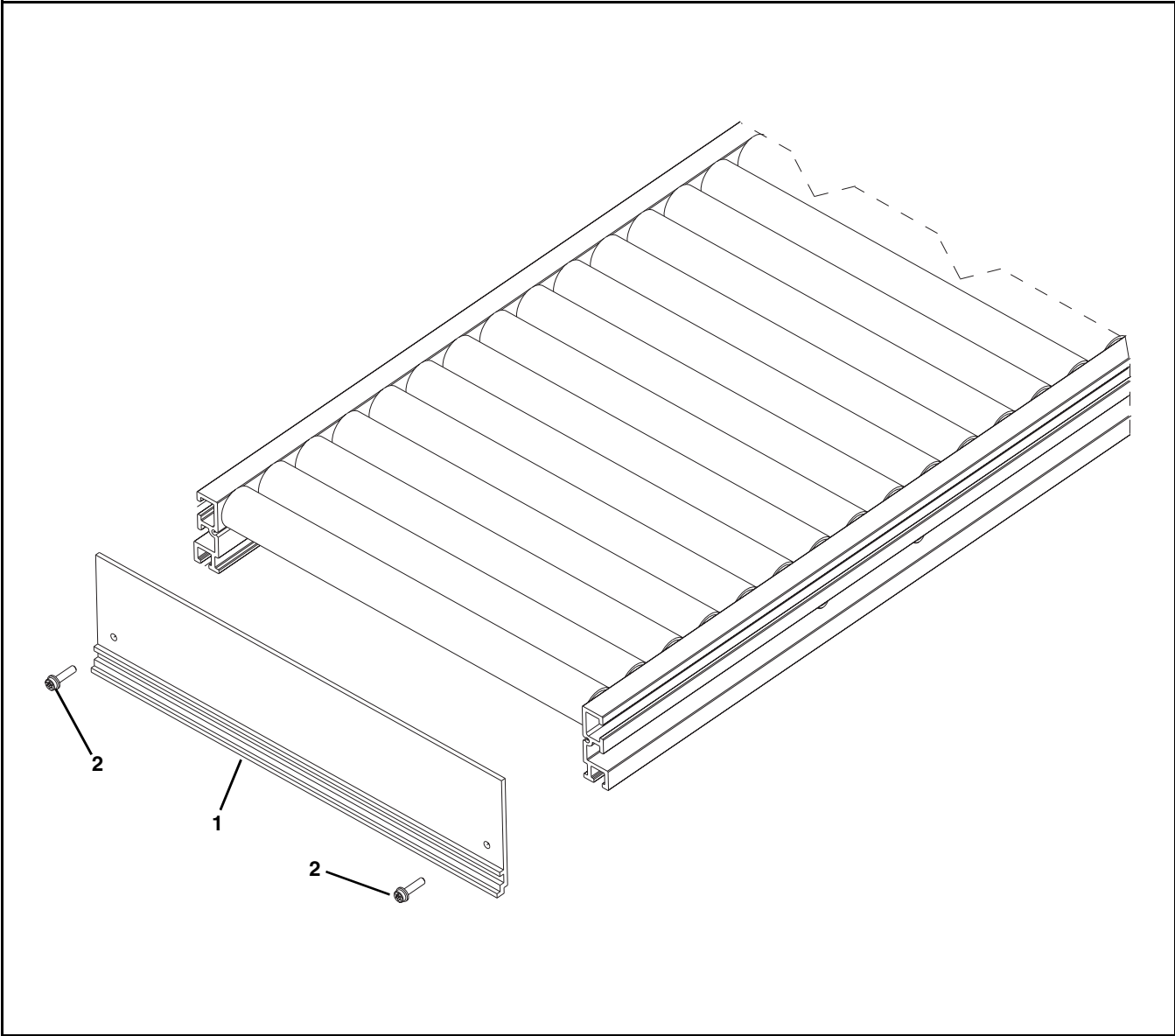

Item	Part Number	Description
1	202667- <u>WW</u>	End Stop
2	960498M	Hex Head Cap Screw, M4-.70 x 12 mm
<u>WW</u> = Conveyor width reference: 06, 12, 18, 24		

-04 3" (76 mm) Aluminum Side

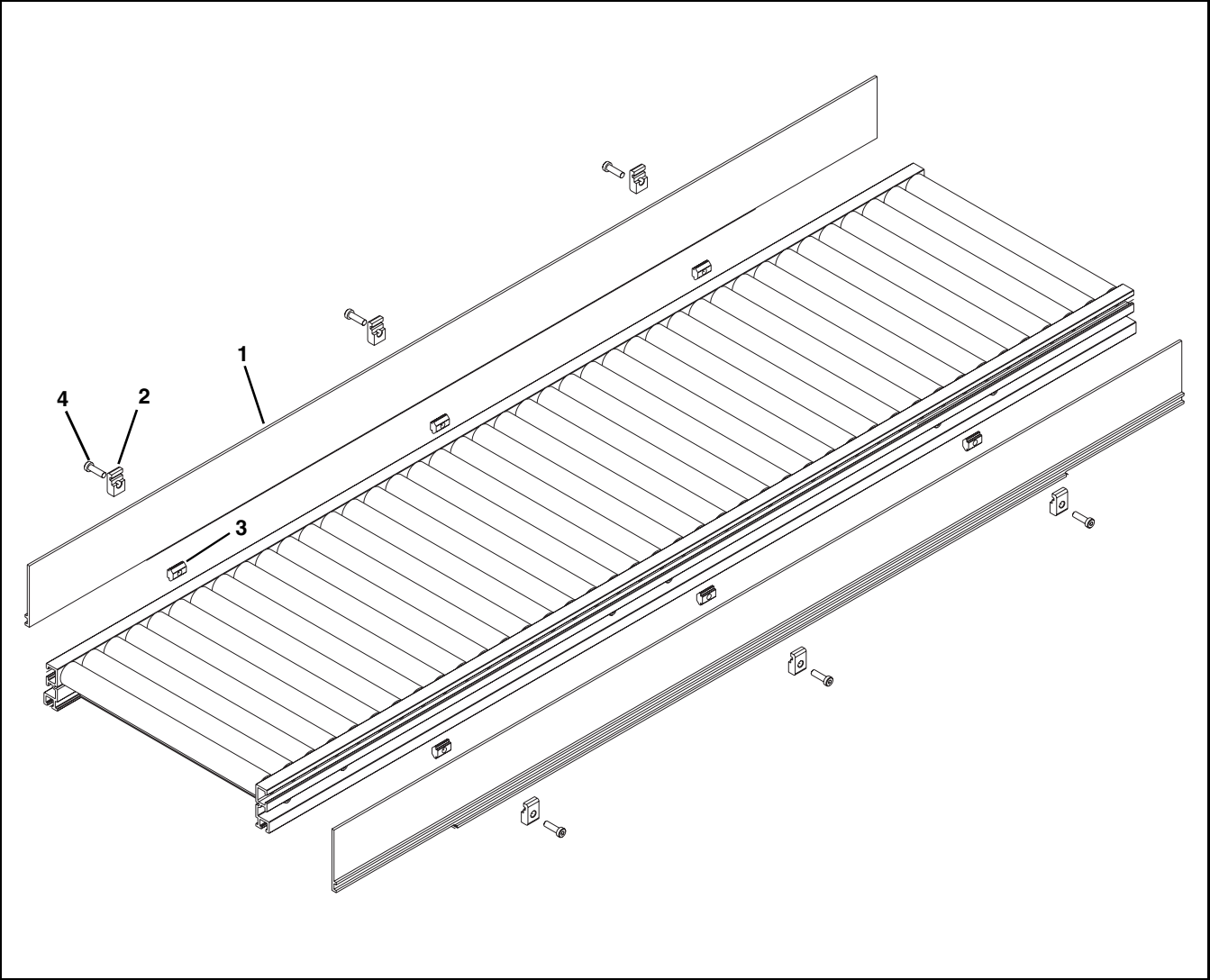

Item	Part Number	Description
1	280404- <u>LLLLL</u>	3" (76 mm) Guide Rail
2	202669	Guide Clip - Roller Conveyor
3	639971MK10	Single Drop-In Tee Bar (x10)
4	920694M	Socket Head Screw, M6-1.00 x 20 mm
<u>LLLLL</u> = Part length in inches with 2 decimal places		
Example: Part Length = 35.25" <u>LLLLL</u> = 03525		

# Service Parts

## -05 1.5" (38 mm) Aluminum Side

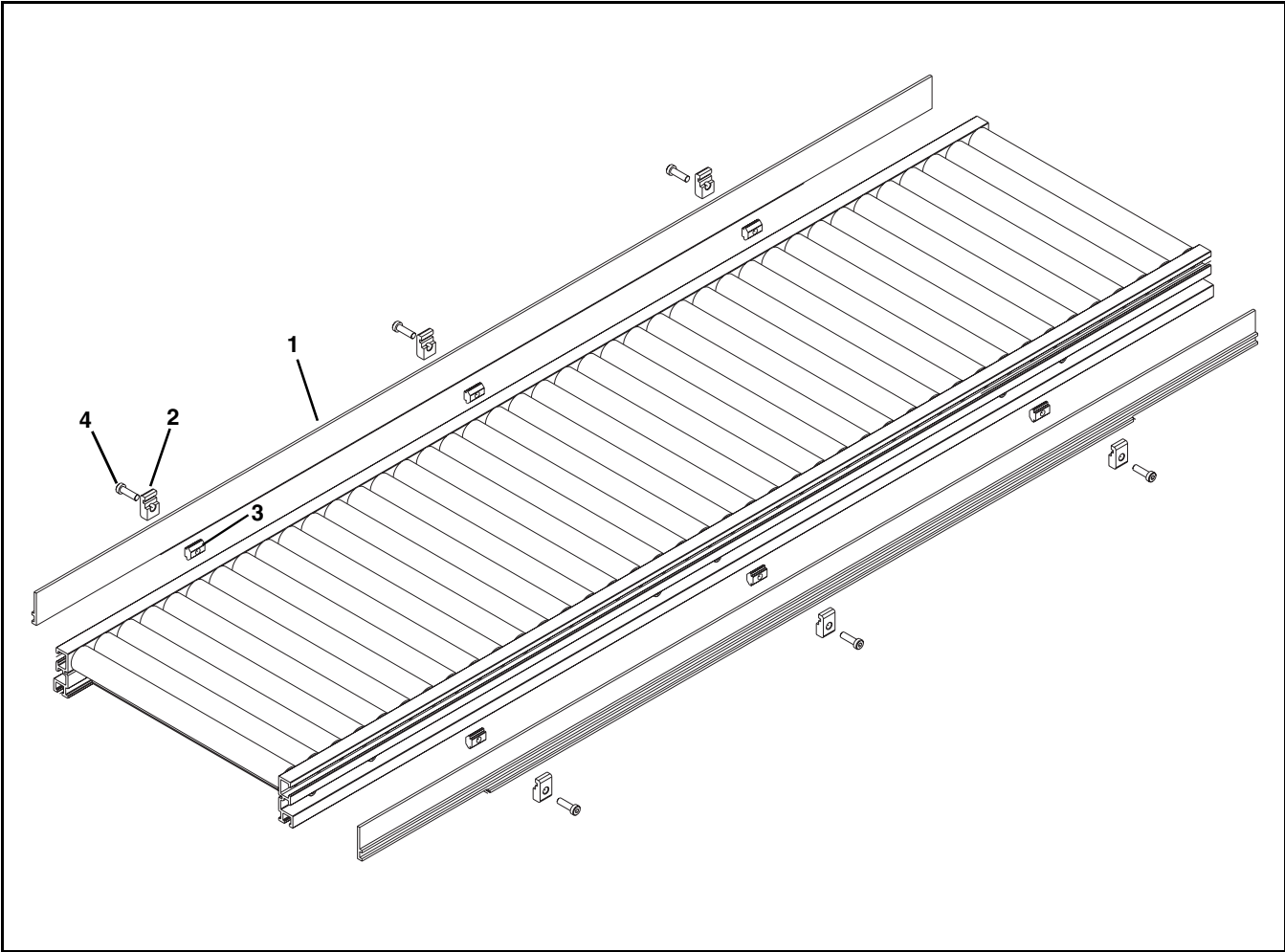

Item	Part Number	Description
1	280504- <u>LLLLL</u>	1.5" (38 mm) Guide Rail
2	202669	Guide Clip - Roller Conveyor
3	639971MK10	Single Drop-In Tee Bar (x10)
4	920694M	Socket Head Screw, M6-1.00 x 20 mm
<u>LLLLL</u> = Part length in inches with 2 decimal places		
Example: Part Length = 35.25" <u>LLLLL</u> = 03525		

-09 0.5" (12 mm) Aluminum Side

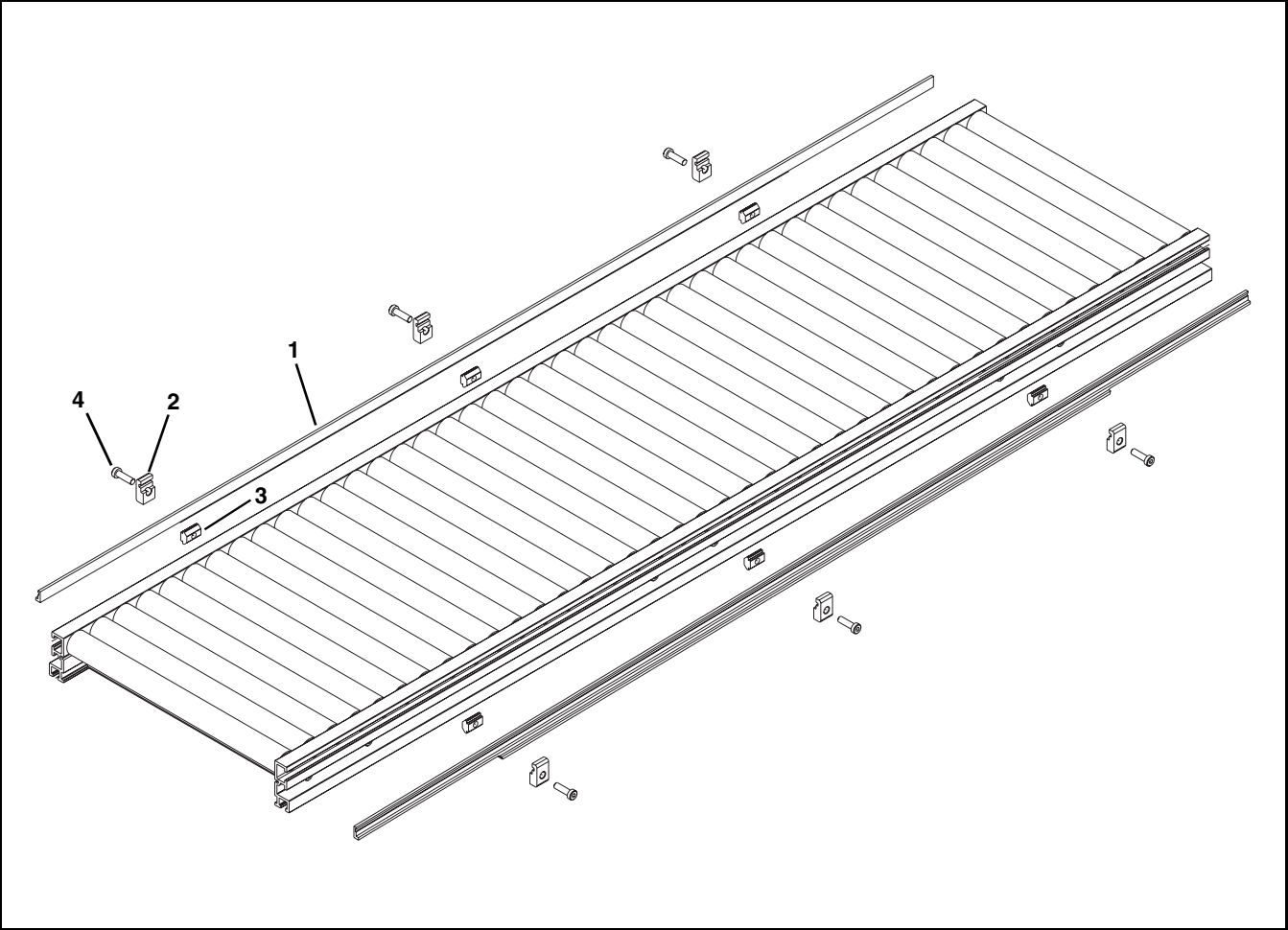

Item	Part Number	Description
1	280904-LLLLL	0.5" (12 mm) Guide Rail
2	202669	Guide Clip - Roller Conveyor
3	639971MK10	Single Drop-In Tee Bar (x10)
4	920694M	Socket Head Screw, M6-1.00 x 20 mm
LLLLL = Part length in inches with 2 decimal places		
Example: Part Length = 35.25" LLLLL = 03525		

# Service Parts

## -10 0.5" (12 mm) Extruded Plastic Side

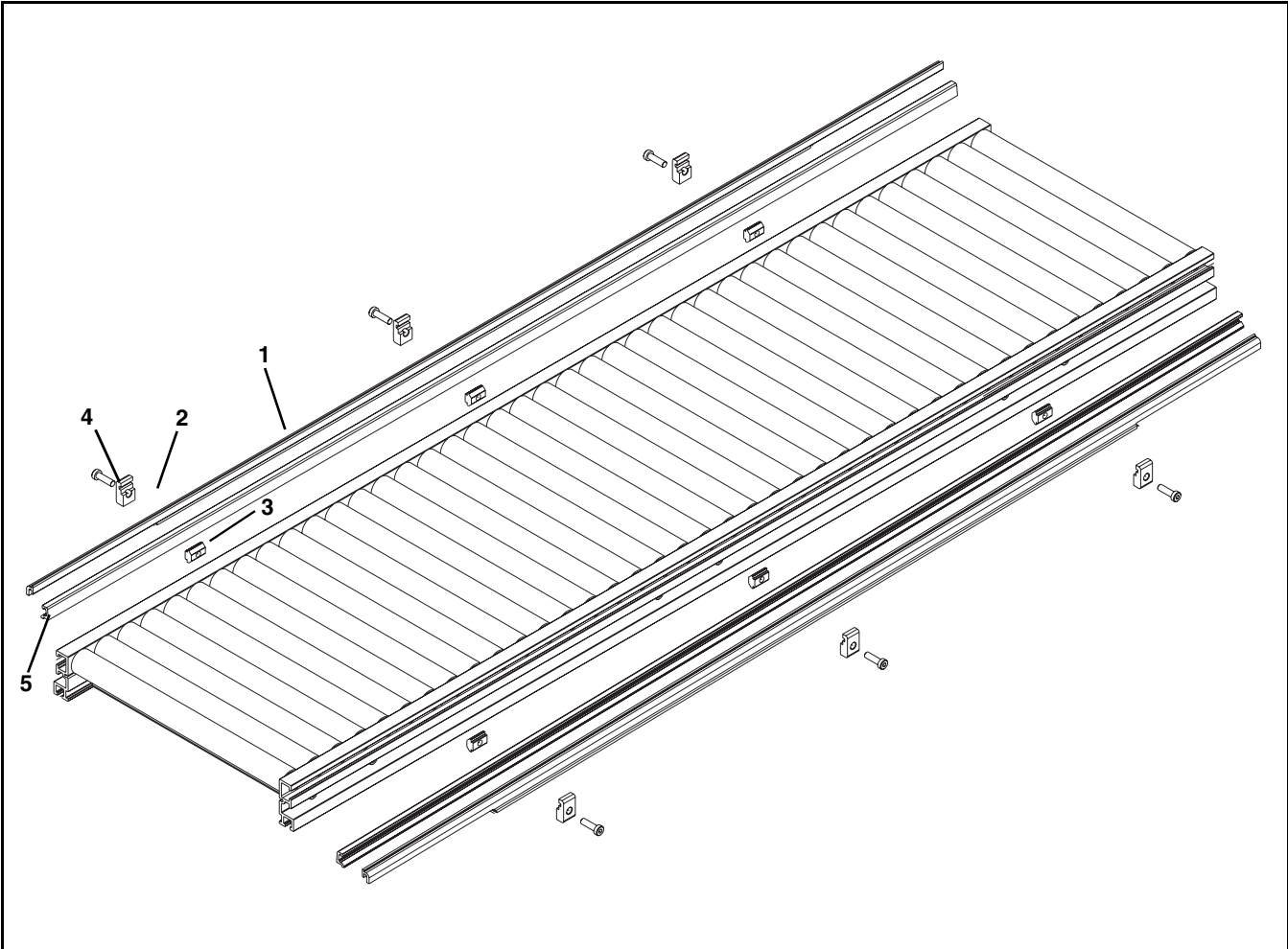

Item	Part Number	Description
1	281004- <u>LLLLL</u>	0.5" (12 mm) Guide Rail
2	202669	Guide Clip - Roller Conveyor
3	639971MK10	Single Drop-In Tee Bar (x10)
4	920694M	Socket Head Screw, M6-1.00 x 20 mm
5	200054P	Snap-On Guide (per foot)
<u>LLLLL</u> = Part length in inches with 2 decimal places		
Example: Part Length = 35.25" <u>LLLLL</u> = 03525		

## -13 Adjustable Guiding

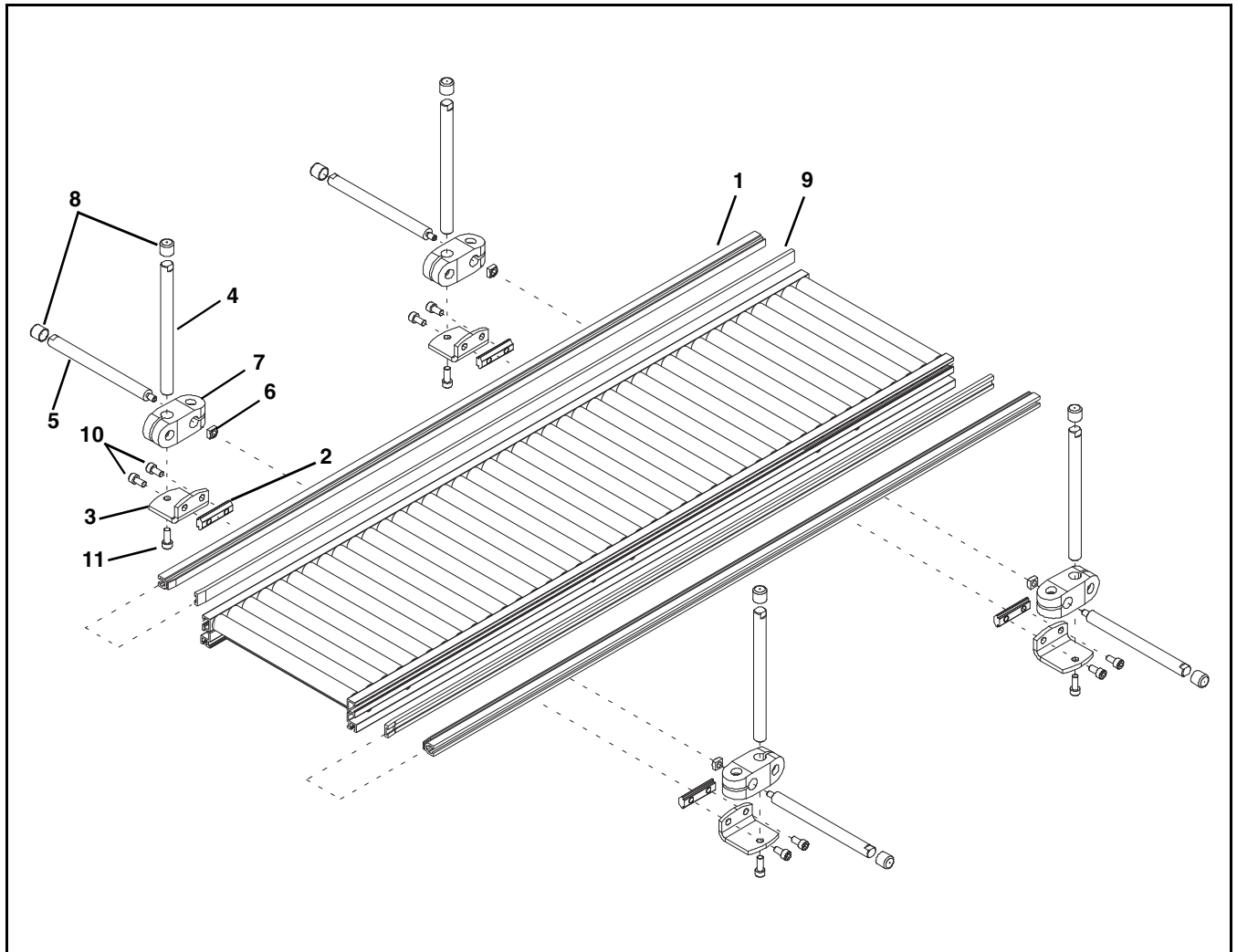

Item	Part Number	Description
1	460063- <u>LLLLL</u>	Aluminum Profile Guide
2	200830M	Drop-In Tee Bar
3	202004M	Mounting Bracket
4	202027M	Guide Mounting Shaft Vertical
5	202028M	Guide Mounting Shaft Horizontal
6	674175MP	Square Nut
7	807-652	Cross Block
8	807-948	Vinyl Shaft Cap
9	614068P- <u>LLLLL</u>	Extruded Guide
10	920612M	Socket Head Screw M6-1.00 x 12mm
11	920616M	Socket Head Screw M6-1.00 x 16mm
<u>LLLLL</u> = Part length in inches with 2 decimal places		
Example: Part Length = 35.25" <u>LLLLL</u> = 03525		

# Service Parts

## -14 Tool-Less Adjustable Guiding

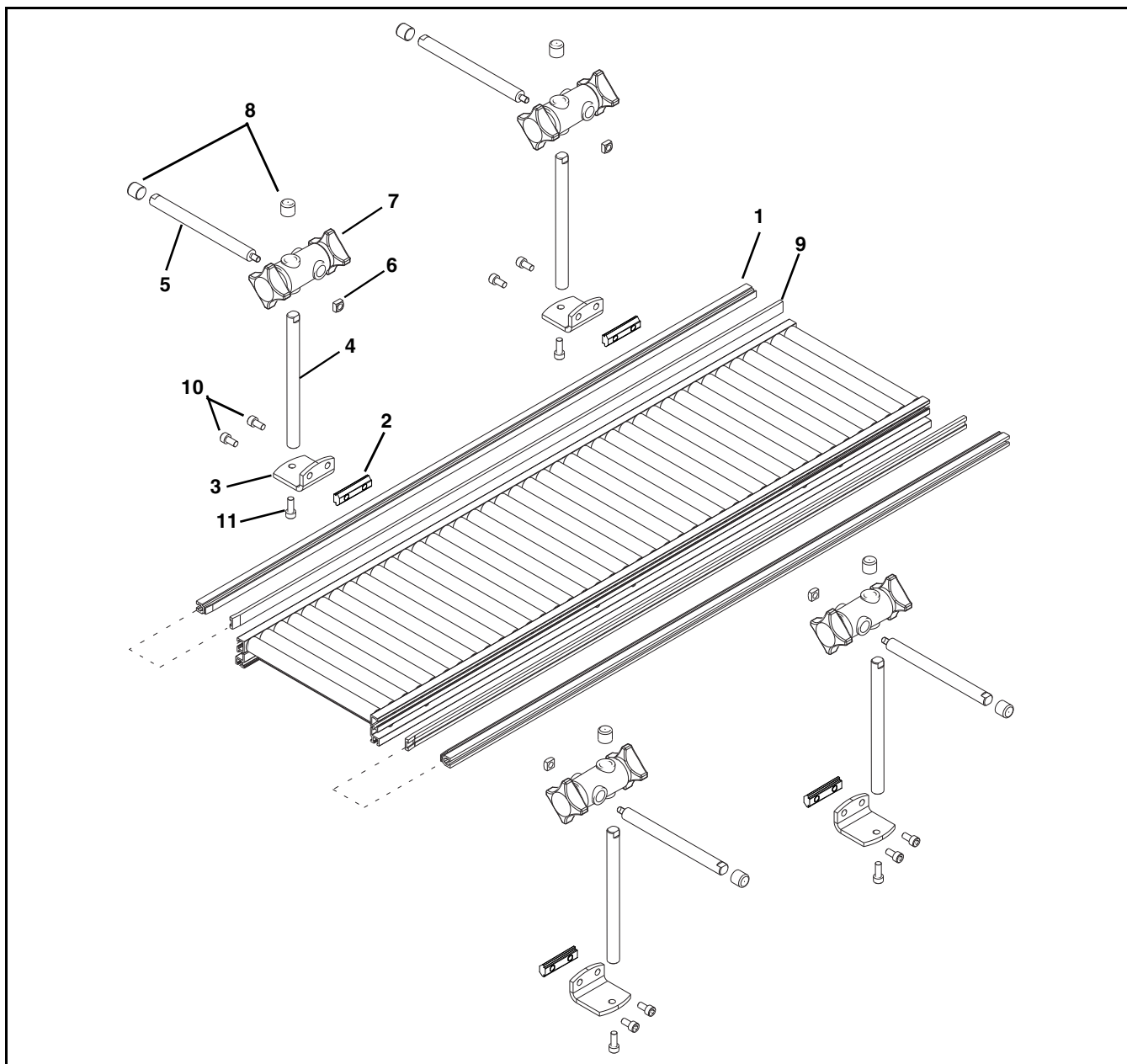

Item	Part Number	Description
1	460063- <u>LLLLL</u>	Aluminum Profile Guide
2	200830M	Drop-In Tee Bar
3	202004M	Mounting Bracket
4	202027M	Guide Mounting Shaft Vertical
5	202028M	Guide Mounting Shaft Horizontal
6	674175MP	Square Nut
7	807-1470	Cross Block
8	807-948	Vinyl Shaft Cap
9	614068P- <u>LLLLL</u>	Extruded Guide
10	920612M	Socket Head Screw M6-1.00 x 12mm
11	920616M	Socket Head Screw M6-1.00 x 16mm
<u>LLLLL</u> = Part length in inches with 2 decimal places		
Example: Part Length = 35.25" <u>LLLLL</u> = 03525		





# Return Policy

Returns must have prior written factory authorization or they will not be accepted. Items that are returned to Dorner without authorization will not be credited nor returned to the original sender. When calling for authorization, please have the following information ready for the Dorner factory representative or your local distributor:

1. Name and address of customer.
2. Dorner part number(s) of item(s) being returned.
3. Reason for return.
4. Customer's original order number used when ordering the item(s).
5. Dorner or distributor invoice number (if available, part serial number).

A representative will discuss action to be taken on the returned items and provide a Returned Goods Authorization (RMA) number for reference. RMA will automatically close 30 days after being issued. To get credit, items must be new and undamaged. There will be a return charge on all items returned for credit, where Dorner was not at fault. It is the customer's responsibility to prevent damage during return shipping. Damaged or modified items will not be accepted. The customer is responsible for return freight.

	Product Type								
	Standard Products								Engineered to order parts
Product Line	Conveyors	Gearmotors & Mounting Packages	Support Stands	Accessories	Spare Parts (non-belt)	Spare Belts - Standard Flat Fabric	Spare Belts - Cleated & Specialty Fabric	Spare Belts - Plastic Chain	All equipment and parts
1100	30% return fee for all products except: 50% return fee for conveyors with modular belt, cleated belt or specialty belts						non-returnable		case-by-case
2200									
2200 Modular Belt									
2200 Precision Move									
2300									
2300 Modular Belt									
3200									
3200 LPZ									
3200 Precision Move									
4100									
5200									
5300									
6200									
Controls									
7200 / 7300	50% return fee for all products								
7350	non-returnable								
7360									
7400									
7600									

Returns will not be accepted after 60 days from original invoice date. The return charge covers inspection, cleaning, disassembly, disposal and reissuing of components to inventory. If a replacement is needed prior to evaluation of returned item, a purchase order must be issued. Credit (if any) is issued only after return and evaluation is complete.

Dorner has representatives throughout the world. Contact Dorner for the name of your local representative. Our Customer Service Team will gladly help with your questions on Dorner products.

For a copy of Dorner's Warranty, contact factory, distributor, service center or visit our website at [www.dorner.com](http://www.dorner.com).

For replacement parts, contact an authorized Dorner Service Center or the factory.



Dorner Mfg. Corp. reserves the right to change or discontinue products without notice. All products and services are covered in accordance with our standard warranty. All rights reserved. © Dorner Mfg. Corp. 2013

#### DORNER MFG. CORP.

975 Cottonwood Ave., PO Box 20  
Hartland, WI 53029-0020 USA  
TEL 1-800-397-8664 (USA)  
FAX 1-800-369-2440 (USA)  
Internet: [www.dorner.com](http://www.dorner.com)

Outside the USA:  
TEL 1-262-367-7600  
FAX 1-262-367-5827