



A-Frame Support Stands

Installation, Maintenance & Parts Manual



DORNER MFG. CORP.
P.O. Box 20 • 975 Cottonwood Ave.
Hartland, WI 53029-0020 USA

INSIDE THE USA
TEL: 1-800-397-8664
FAX: 1-800-369-2440

OUTSIDE THE USA
TEL: 262-367-7600
FAX: 262-367-5827

For other service manuals visit our website at:
www.dorner.com/service_manuals.asp

Table of Contents

Introduction	2	Pre-Drill for Standard Screws.....	7
Warnings - General Safety	3	Preventive Maintenance and Adjustment	8
Product Description	4	Stand Height Adjustment	8
Specifications	4	Required Tools.....	8
A-Frame Support Stand	4	Stands With Feet.....	8
Installation	5	Stands With Casters	8
Required Tools.....	5	Service Parts.....	10
Recommended Installation Sequence	5	A-Frame Stand for 2200	
Stand Attachment to the Conveyor	5	and 3200 Series Conveyors	10
Horizontal Mount	5	A-Frame Stand Mounted Under Bottom Drives	
Angle Mount	5	for 2200 Series Conveyors	11
Diagonal Brace Attachment	6	A-Frame Stand for 2300 Series DustPruf Conveyors	12
Proper Methods of Attachment to Side Rails	6	A-Frame Stand for 5200 and 5300 Series Conveyors	13
Self-Drilling Screws.....	6	Return Policy.....	14

Introduction

IMPORTANT

Some illustrations may show guards removed. DO NOT operate equipment without guards.

Upon receipt of shipment:

- Compare shipment with packing slip. Contact factory regarding discrepancies.

- Inspect packages for shipping damage. Contact carrier regarding damage.
- Accessories may be shipped loose. See accessory instructions for installation.

Dorner’s Limited Warranty applies.

Dorner reserves the right to make changes at any time without notice or obligation.

Warnings - General Safety

WARNING

The safety alert symbol, black triangle with white exclamation, is used to alert you to potential personal injury hazards.

DANGER



Climbing, sitting, walking or riding on conveyor will cause severe injury.
KEEP OFF CONVEYORS.

DANGER



DO NOT OPERATE CONVEYORS IN AN EXPLOSIVE ENVIRONMENT.

DANGER



Supports marked with this symbol must be anchored to the floor. Supports not anchored to floor will tip, causing severe injury or death.
SUPPORT MUST BE ANCHORED TO FLOOR.

WARNING



Exposed moving parts can cause severe injury.
LOCK OUT POWER before removing guards or performing maintenance.

WARNING



Loosening stand height or angle adjustment screws may cause conveyor sections to drop down, causing severe injury.

SUPPORT CONVEYOR SECTIONS PRIOR TO LOOSENING STAND HEIGHT OR ANGLE ADJUSTMENT SCREWS.

WARNING



Dorner cannot control the physical installation and application of conveyors. Taking protective measures is the responsibility of the user.

When conveyors are used in conjunction with other equipment or as part of a multiple conveyor system, **CHECK FOR POTENTIAL PINCH POINTS** and other mechanical hazards before system start-up.

Product Description

Refer to **Figure 1** for typical stand components.

1	Pivot Plate
2	Support Stand
3	Foot Pad

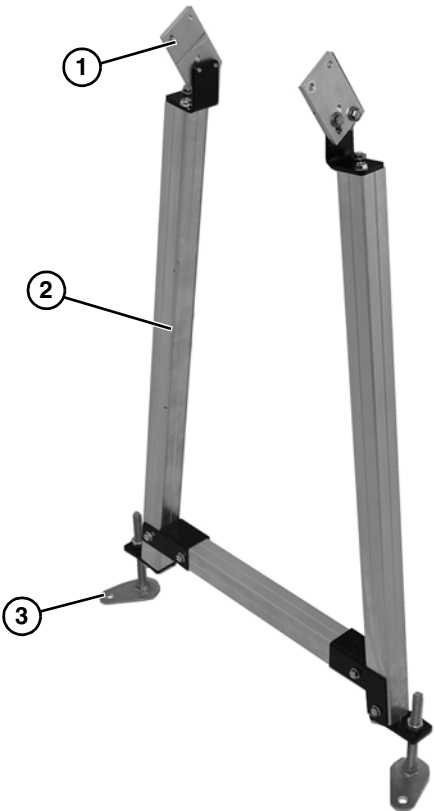
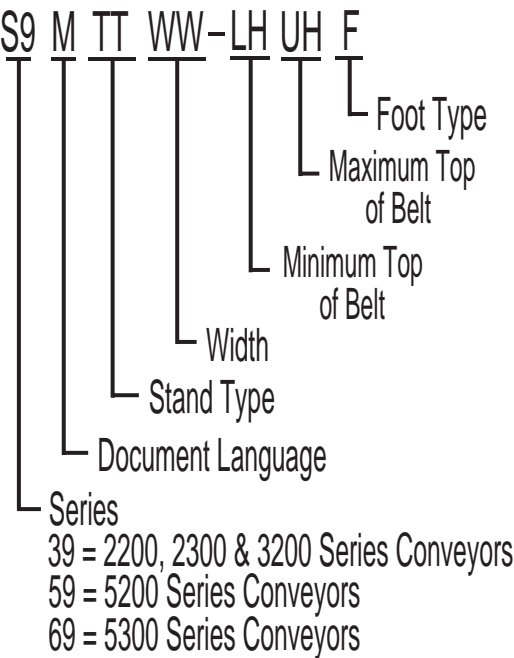

Figure 1

Specifications

A-Frame Support Stand



Required Tools

- Level
- 17 mm wrench
- 24 mm wrench
- 30 mm wrench

Recommended Installation Sequence

- Attach the stand(s) to the conveyor.
- Attach the diagonal bracing, if applicable.
- Adjust the stand height and level.

Stand Attachment to the Conveyor

⚠ WARNING

<p>Exposed moving parts can cause severe injury.</p> <p>LOCK OUT POWER before removing guards or performing maintenance.</p>

Horizontal Mount

1. Properly support the conveyor or place the conveyor upside down on a flat surface.

⚠ WARNING

<p>Failure to secure screws (Figure 2, item 3) may cause conveyor sections to drop down causing severe injury.</p> <p>TIGHTEN SCREWS (Figure 2, item 3) AFTER ADJUSTMENT.</p>

2. Attach the stand (**Figure 2, item 1**) to the conveyor (**Figure 2, item 2**) and tighten the four bolts (**Figure 2, item 3**). For 2300 and 5300 series conveyors see “Proper Methods of Attachment to Side Rails” on page 6.

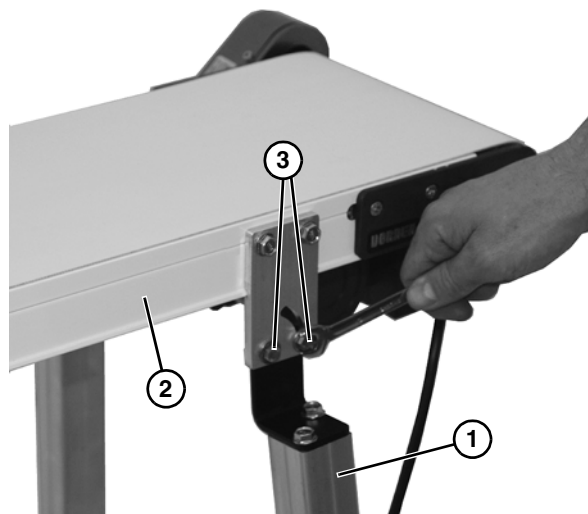

Figure 2

3. Repeat for other stands.
4. Adjust the stand height. Refer to “Stand Height Adjustment” on page 8.

Angle Mount

1. Properly support the conveyor or place the conveyor upside down on a flat surface.
2. For slotted brackets, loosen the two bracket bolts (**Figure 3, item 1**) and adjust the bracket (**Figure 3, item 2**) so that the top is at approximately the same angle as the conveyor. Do not tighten the bolts.

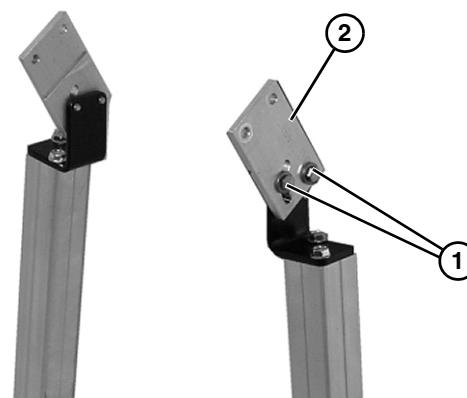

Figure 3

Installation

3. Attach the bracket (**Figure 4, item 1**) to the conveyor (**Figure 4, item 2**) and tighten the four bolts (**Figure 4, item 3**). For 2300 and 5300 series conveyors see “Proper Methods of Attachment to Side Rails” on page 6.

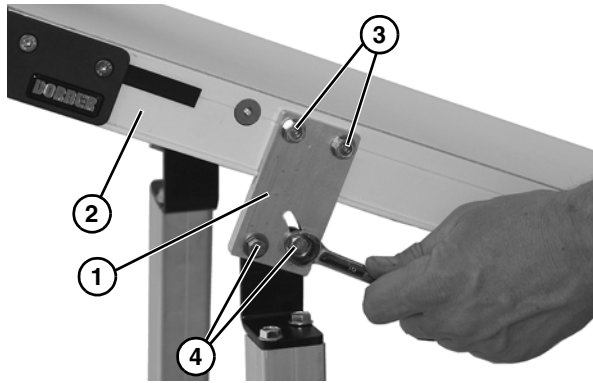

Figure 4

⚠ WARNING



Failure to secure screws (**Figure 4, item 4**) may cause conveyor sections to drop down causing severe injury.

TIGHTEN SCREWS (Figure 4, item 4**) AFTER ADJUSTMENT.**

4. Adjust the bracket angle on the slotted brackets (**Figure 4, item 1**) to match the conveyor angle until the legs are vertical and tighten the bolts (**Figure 4, item 4**).
5. Repeat steps 2 through 4 for the other stands.
6. Adjust the stand height. Refer to “Stand Height Adjustment” on page 8.

Diagonal Brace Attachment

1. Install the end of brace with non-threaded hole (**Figure 5, item 1**) onto the inside of the stand (**Figure 5, item 2**).

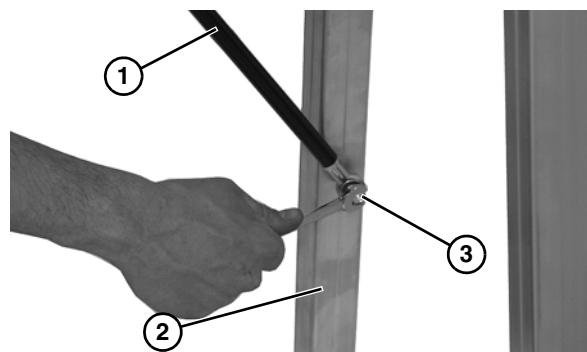

Figure 5

2. Secure the brace with a hex head bolt and nut (**Figure 5, item 3**).
3. Attach the end of brace with threaded hole (**Figure 6, item 1**) to the conveyor with hex head bolt (**Figure 6, item 2**). For 2300 and 5300 series conveyors see “Proper Methods of Attachment to Side Rails” on page 6.

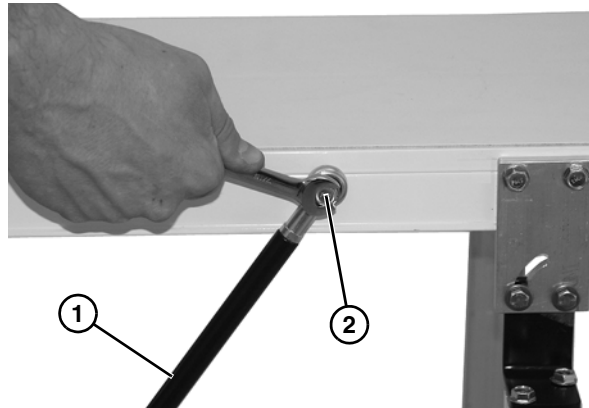

Figure 6

4. Repeat steps 1 through 3 for opposite leg.
5. Tighten all hardware.

Proper Methods of Attachment to Side Rails

⚠ WARNING

Installing self-drilling screws into the dustpruf side rail requires substantial force. Failure to properly support the conveyor while installing self-drilling screws may cause the operator or conveyor to slip, causing severe injury.

SUPPORT CONVEYOR FRAMES WHILE INSTALLING SELF-DRILLING SCREWS.

The 2300 and 5300 DustPruf side rail is designed for self-drilling attachment of brackets and accessories. This can be done in two methods: self-drilling screws or pre-drill for standard screws.

Self-Drilling Screws

All Dorner accessories are provided with 1/4-20 self-drilling screws.

1. Locate and hold bracket (**Figure 7, item 1**) to side rail. Hole should line up with notch (**Figure 7, item 2**) in side rail.

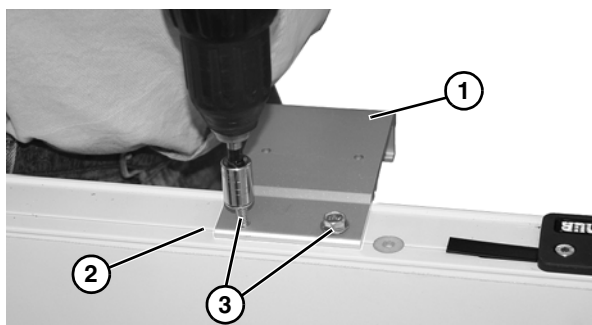

Figure 7

2. With a cordless drill or equivalent install self-drilling screws (**Figure 7, item 3**). Use high speed setting to drill through side wall. Once the tap portion is started switch drill power to a lower speed. Do not fully tighten with drill.
3. Hand tighten the screws to secure (Figure 8). Recommended torque is 150 in.lbs (17 Nm).

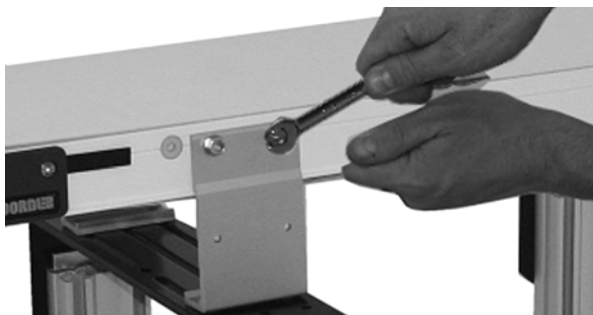

Figure 8

Pre-Drill for Standard Screws

The DustPruf side rail will also accept standard screws. M6-1.0 and 1/4-20 are acceptable. Strength grade 8 is recommended.

1. Locate and hold bracket (Figure 9, item 1) to side rail. Hole should line up with notch (Figure 9, item 2) in side rail. Mark the hole locations with a center punch (Figure 9, item 3) and remove the bracket.

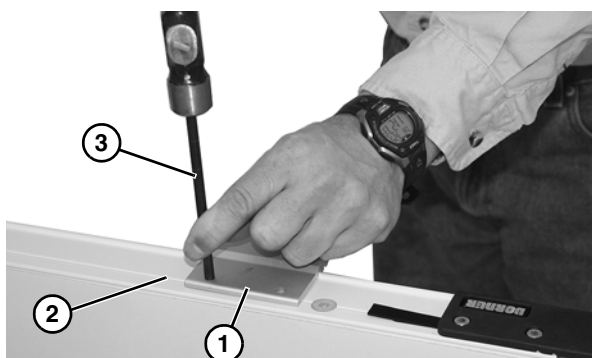

Figure 9

2. Drill the hole locations (**Figure 10, item 1**) with a 3/16" drill bit (**Figure 10, item 2**).

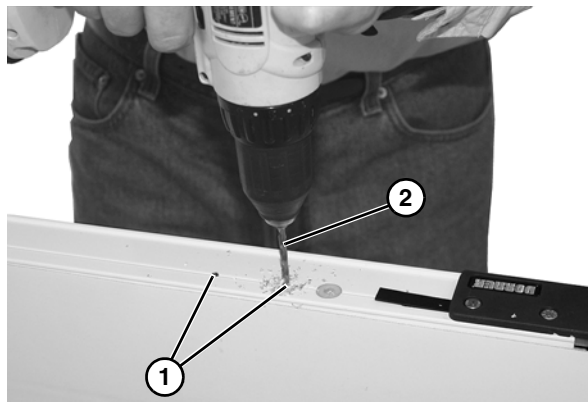

Figure 10

3. Position and hold bracket (**Figure 11, item 1**) to side rail. With a standard M6-1.0 or 1/4-20 screw, install screws (**Figure 11, item 2**) with cordless drill or equivalent. Do not fully tighten with drill.

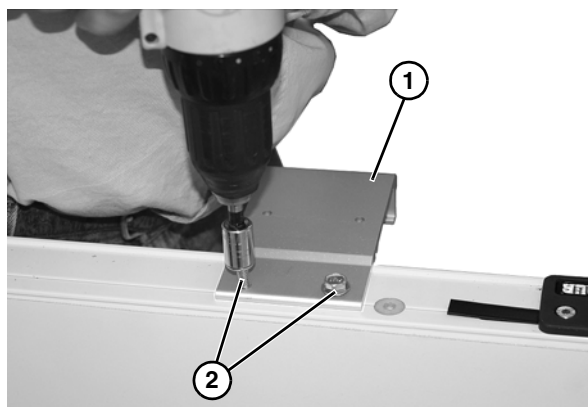

Figure 11

4. Hand tighten the screws to secure (Figure 12). Recommended torque is 150 in.lbs (17 Nm).



Figure 12

Preventive Maintenance and Adjustment

Stand Height Adjustment

Required Tools

- Level
- 17 mm wrench
- 24 mm wrench
- 30 mm wrench

Stands With Feet

⚠ WARNING



SEVERE HAZARD!

LOCK OUT POWER before removing guards or performing maintenance. Exposed moving parts can cause serious injury.

1. To adjust stand height, loosen the upper nut (**Figure 13, item 1**) on the foot stem. Rotate the lower nut (**Figure 13, item 2**) up or down to raise or lower the stand (**Figure 13, item 3**) to desired height.

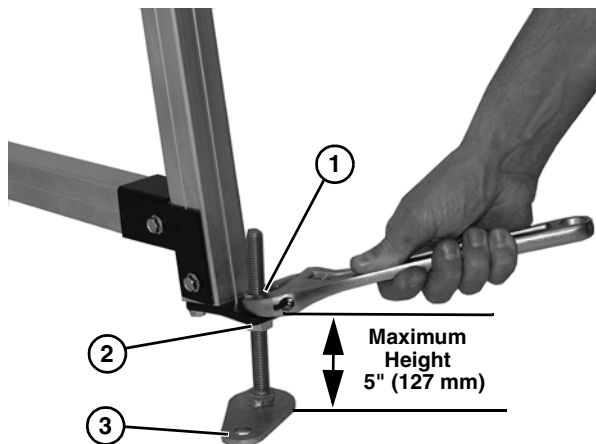

Figure 13

2. Repeat steps on the opposite stand leg.
3. Use a level (**Figure 14, item 1**) to verify that both stand legs are the same height.

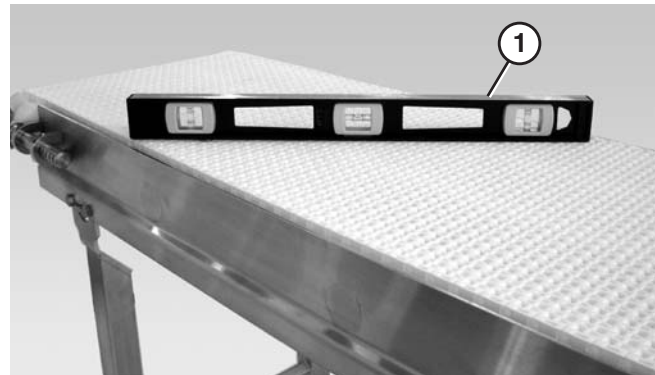

Figure 14

4. Tighten the upper nut (**Figure 13, item 1**) on the foot stem to secure each foot assembly.

Stands With Casters

⚠ WARNING



SEVERE HAZARD!

LOCK OUT POWER before removing guards or performing maintenance. Exposed moving parts can cause serious injury.

1. Loosen the upper nut (**Figure 15, item 1**) on the caster stem (**Figure 15, item 2**).

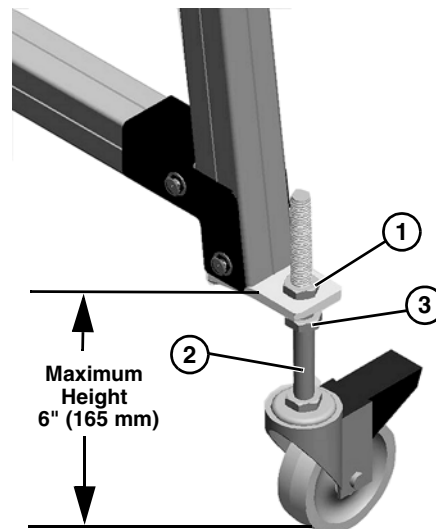

Figure 15

Preventive Maintenance and Adjustment

WARNING



SEVERE HAZARD!

DO NOT EXCEED THE MAXIMUM HEIGHT OF 10-1/2" (267 mm) from the floor to the bottom of the stand.

Exceeding the maximum height will allow parts to separate and may cause serious injury.

2. Rotate the lower nut up or down (**Figure 15, item 3**) to raise or lower the stand to the desired height.
3. Repeat steps 1 and 2 on the opposite stand leg.

4. Use a level (**Figure 16, item 1**) to verify that both stand legs are the same height.

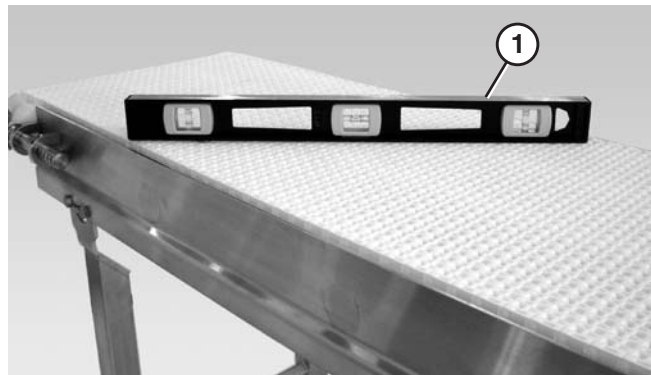



Figure 16

5. Tighten the upper nut (**Figure 15, item 1**) on the caster stem (**Figure 15, item 2**) to secure each foot assembly.

Service Parts

NOTE

For replacement parts other than those shown in this section, contact an authorized Dorner Service Center or the factory. Key Service Parts and Kits are identified by the Performance Parts Kits logo . Dorner recommends keeping these parts on hand.

A-Frame Stand for 2200 and 3200 Series Conveyors

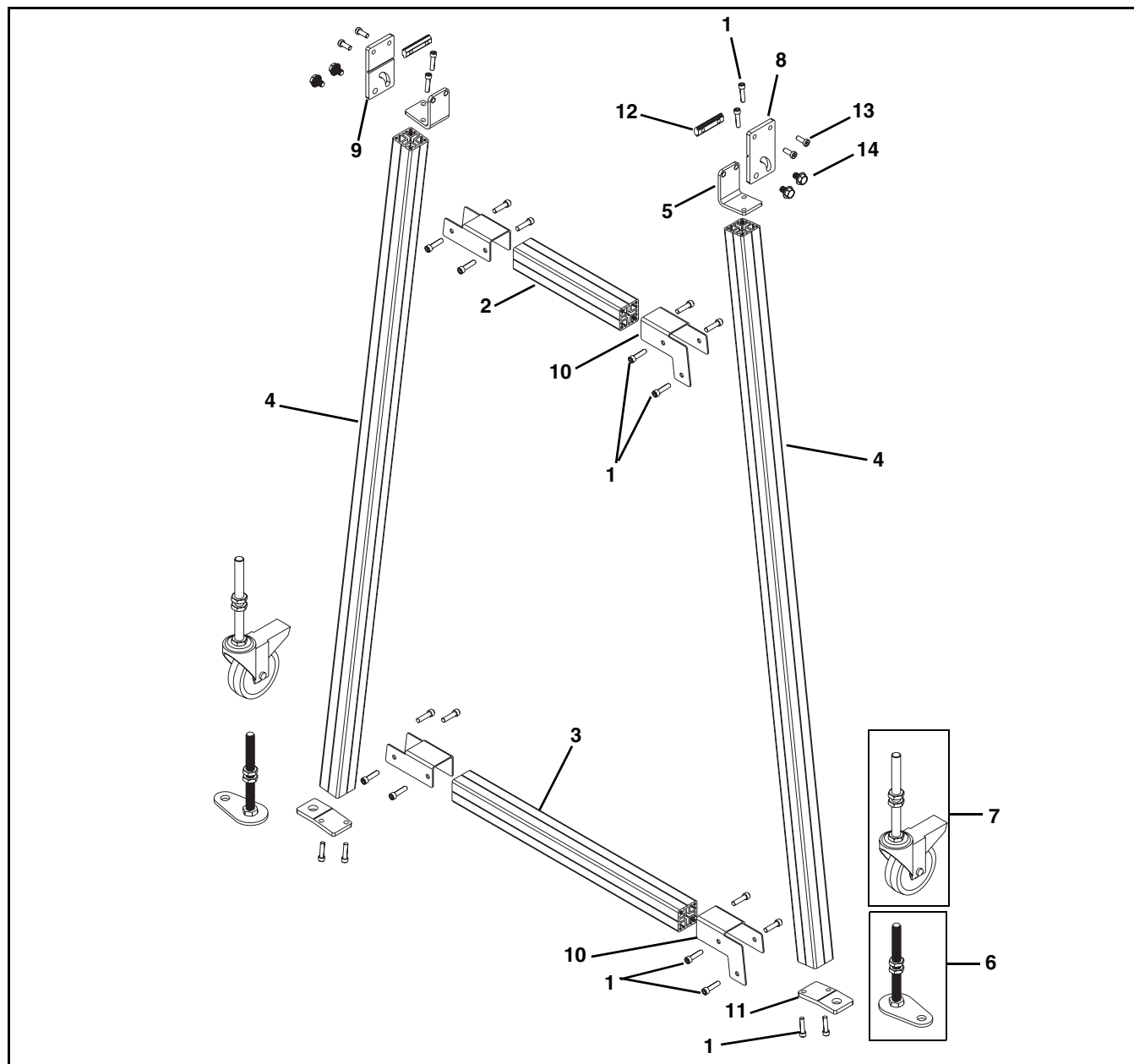

Item	Part Number	Description
1	708180P	Tri Lobe Screw, M6-1.0 x 25 mm
2	712041- <u>LLLLL</u>	Upper Crossmember
3	712041- <u>LLLLL</u>	Lower Crossmember
4	712041- <u>LLLLL</u>	Leg
5	712043	Ear Bracket
6	712049	Foot Assembly
7	712048	Caster Assembly
8	712045-L	Angled Mount Plate Left Hand

Item	Part Number	Description
9	712045-R	Angled Mount Plate Right Hand
10	712055	Joint Bracket
11	712056	Foot Plate
12	639717M	Drop-In Tee-Bar
13	920693M	Low Head Cap Screw, M6-1.00 x 16 mm
14	960812M	Hex Head Cap Screw, M8-1.25 x 12 mm
		<u>LLLLL</u> - Length in inches with 2 decimal places.
		Length Example: Length = 95.25" <u>LLLLL</u> = 09525

A-Frame Support Stands

A-Frame Stand Mounted Under Bottom Drives for 2200 Series Conveyors

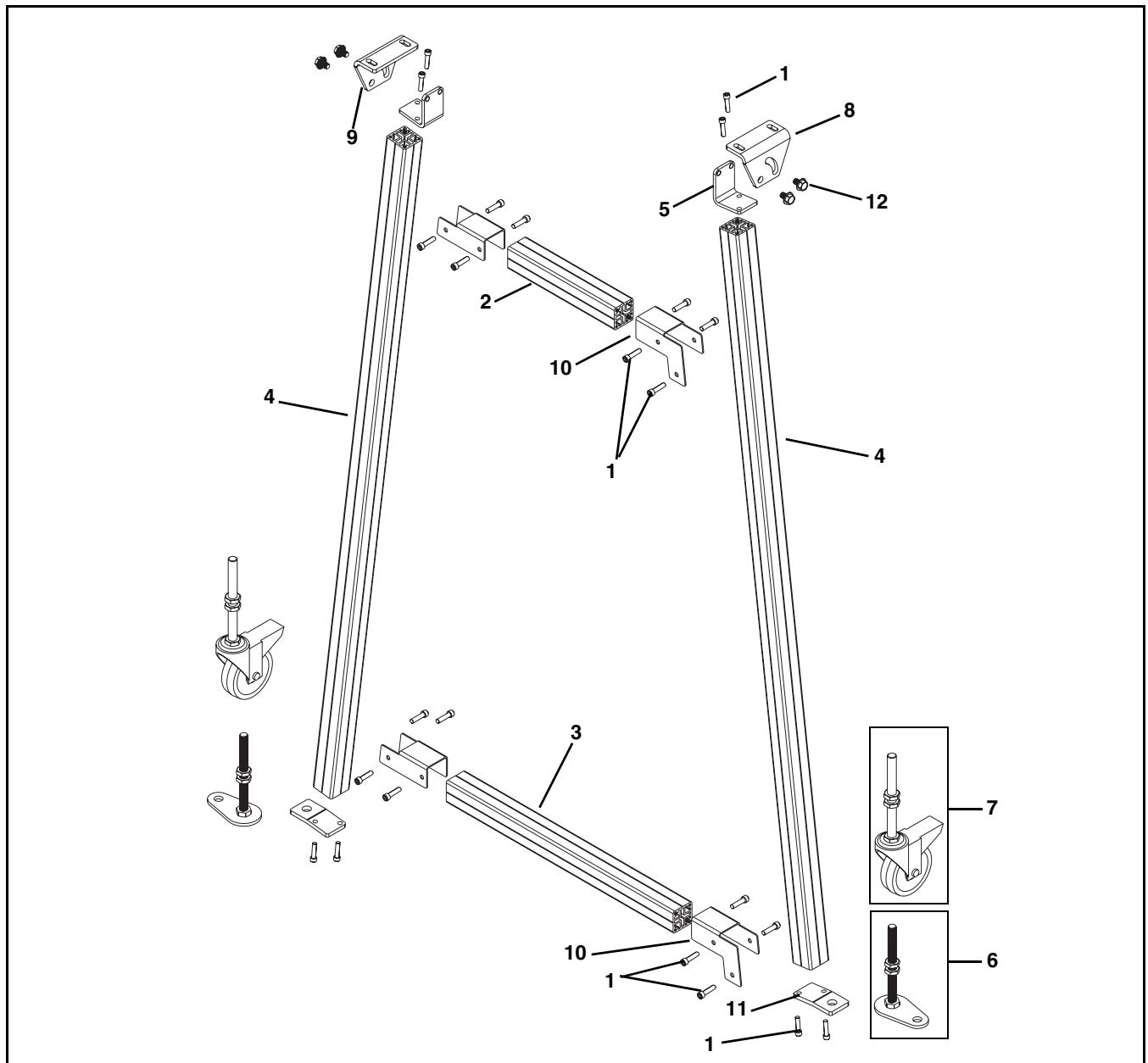

Item	Part Number	Description
1	708180P	Tri Lobe Screw, M6-1.0 x 25 mm
2	712041- <u>LLLL</u>	Upper Crossmember
3	712041- <u>LLLL</u>	Lower Crossmember
4	712041- <u>LLLL</u>	Leg
5	712043	Ear Bracket
6	712049	Foot Assembly
7	712048	Caster Assembly
8	712051-L	Angled Mount Plate Left Hand
9	712051-R	Angled Mount Plate Right Hand
10	712055	Joint Bracket
11	712056	Foot Plate
12	960812M	Hex Head Cap Screw, M8-1.25 x 12 mm
<u>LLLL</u> - Length in inches with 2 decimal places.		
Length Example: Length = 95.25" <u>LLLL</u> = 09525		

Service Parts

A-Frame Stand for 2300 Series DustPruf Conveyors

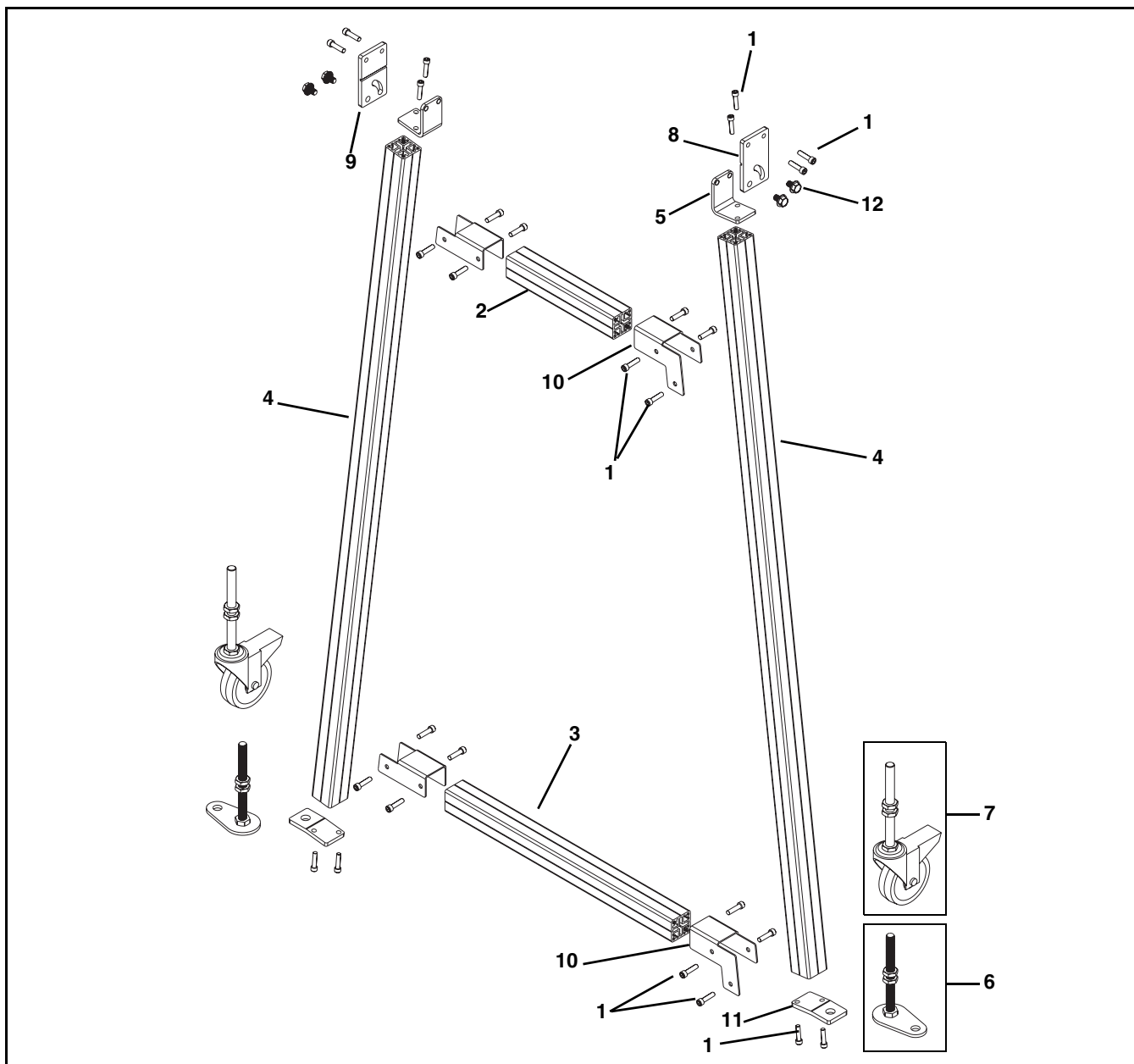

Item	Part Number	Description
1	708180P	Tri Lobe Screw, M6-1.0 x 25 mm
2	712041- <u>LLLLL</u>	Upper Crossmember
3	712041- <u>LLLLL</u>	Lower Crossmember
4	712041- <u>LLLLL</u>	Leg
5	712043	Ear Bracket
6	712049	Foot Assembly
7	712048	Caster Assembly
8	712045-L	Angled Mount Plate Left Hand
9	712045-R	Angled Mount Plate Right Hand
10	712055	Joint Bracket
11	712056	Foot Plate
12	960812M	Hex Head Cap Screw, M8-1.25 x 12 mm
<u>LLLLL</u> - Length in inches with 2 decimal places.		
Length Example: Length = 95.25" <u>LLLLL</u> = 09525		

A-Frame Stand for 5200 and 5300 Series Conveyors

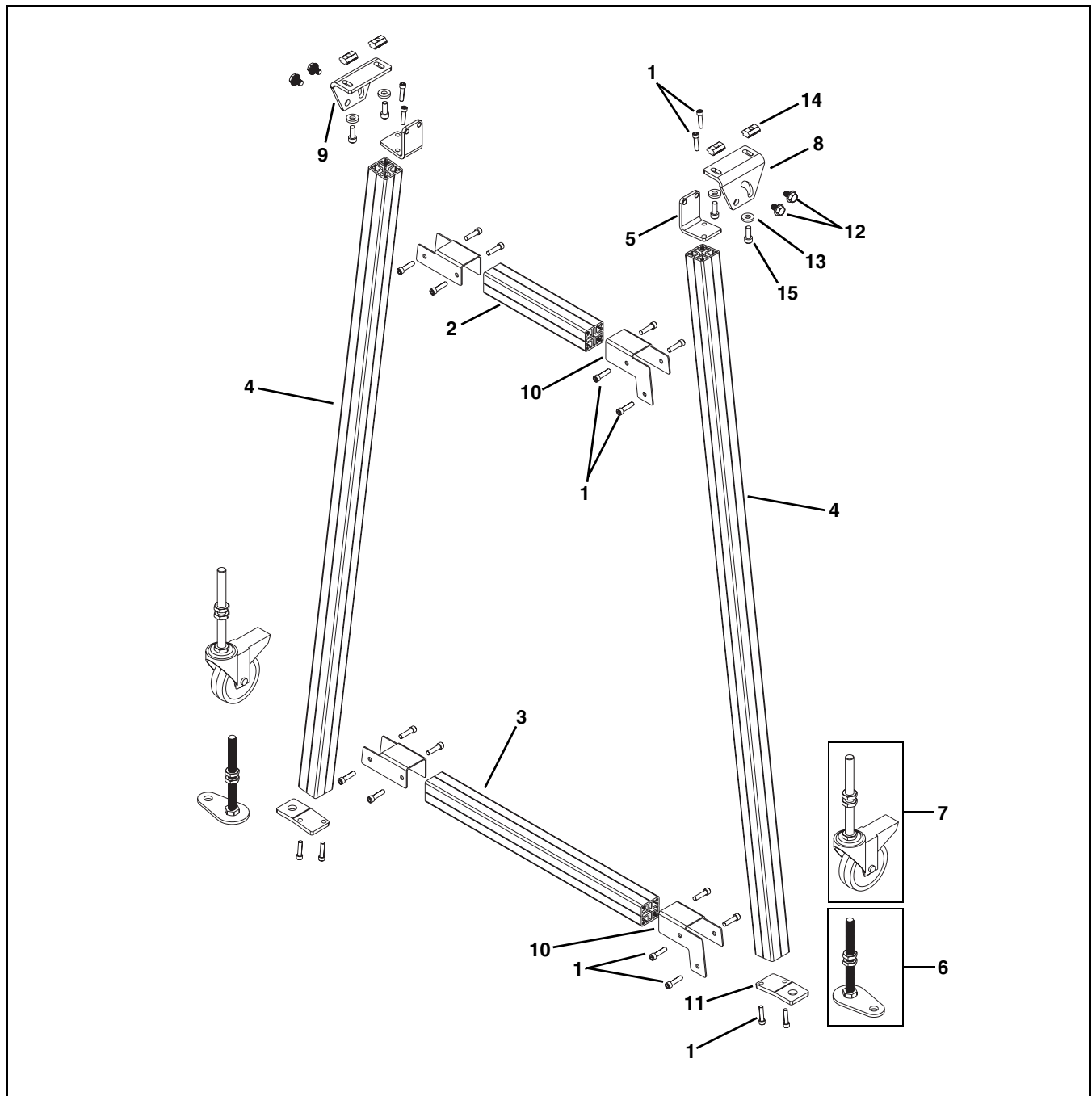

Item	Part Number	Description
1	708180P	Tri Lobe Screw, M6-1.0 x 25 mm
2	712041- <u>LLLLL</u>	Upper Crossmember
3	712041- <u>LLLLL</u>	Lower Crossmember
4	712041- <u>LLLLL</u>	Leg
5	712043	Ear Bracket
6	712049	Foot Assembly
7	712048	Caster Assembly
8	712051-L	Angled Mount Plate Left Hand
9	712051-R	Angled Mount Plate Right Hand
10	712055	Joint Bracket
11	712056	Foot Plate

Item	Part Number	Description
12	960812M	Hex Head Cap Screw, M8-1.25 x 12 mm
13	639974M	Washer
14	639717M	Drop-In Tee-Bar
15	920693M	Socket Head Cap Screw, M6-1.00 x 16 mm
<u>LLLLL</u> - Length in inches with 2 decimal places.		
Length Example: Length = 95.25" <u>LLLLL</u> = 09525		

Return Policy

Returns must have prior written factory authorization or they will not be accepted. Items that are returned to Dorner without authorization will not be credited nor returned to the original sender. When calling for authorization, please have the following information ready for the Dorner factory representative or your local distributor:

1. Name and address of customer.
2. Dorner part number(s) of item(s) being returned.
3. Reason for return.
4. Customer's original order number used when ordering the item(s).
5. Dorner or distributor invoice number (if available, part serial number).

A representative will discuss action to be taken on the returned items and provide a Returned Goods Authorization (RMA) number for reference. RMA will automatically close 30 days after being issued. To get credit, items must be new and undamaged. There will be a return charge on all items returned for credit, where Dorner was not at fault. It is the customer's responsibility to prevent damage during return shipping. Damaged or modified items will not be accepted. The customer is responsible for return freight.

Conveyors and conveyor accessories

Standard catalog conveyors	30%
MPB, 7200, 7300 Series, cleated and specialty belt	50%
AquaGard & AquaPruf Series conveyors	non-returnable items
Engineered special products	case by case
Drives and accessories	30%
Sanitary stand supports	non-returnable items

Parts

Standard stock parts	30%
Plastic chain, cleated and specialty belts	non-returnable items

Returns will not be accepted after 60 days from original invoice date. The return charge covers inspection, cleaning, disassembly, disposal and reissuing of components to inventory. If a replacement is needed prior to evaluation of returned item, a purchase order must be issued. Credit (if any) is issued only after return and evaluation is complete.

Dorner has representatives throughout the world. Contact Dorner for the name of your local representative. Our Customer Service Teams will gladly help with your questions on Dorner products.

For a copy of Dorner's Warranty, contact factory, distributor, service center or visit our website at www.dorner.com.

For replacement parts, contact an authorized Dorner Service Center or the factory.



Dorner Mfg. Corp. reserves the right to change or discontinue products without notice. All products and services are covered in accordance with our standard warranty. All rights reserved. © Dorner Mfg. Corp. 2010

DORNER MFG. CORP.

975 Cottonwood Ave., PO Box 20
Hartland, WI 53029-0020 USA
TEL 1-800-397-8664 (USA)
FAX 1-800-369-2440 (USA)
Internet: www.dorner.com

Outside the USA:
TEL 1-262-367-7600
FAX 1-262-367-5827