



WARNING



To prevent injury, make sure all electrical power sources have been disconnected and locked-out before starting any component replacement. NEVER operate equipment without guards or other protective devices properly secured in place. In addition, keyways on motor and gear reducer drive shafts may be sharp! Exercise caution when removing or re-installing shaft connections.

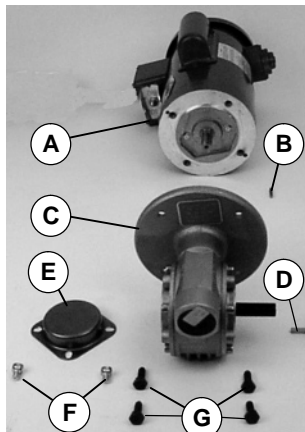

Figure 1

Illustration References

A	Electric Motor
B	Motor Output Shaft Key
C	Gear Reducer
D	Gear Reducer Output Shaft Key
E	Output Shaft Cover
F	Cover Mounting Screws (2)
G	Motor Mounting Screws (4)
H	Retaining Ring(s)
I	Drive Shaft
J	Shaft Key
K	Package of Anti-seize (829-011)

1. Disconnect and lockout all electrical power sources.
2. Remove and retain all drive guarding.
3. Remove and retain coupling or timing belt and pulley and attaching hardware.
4. Detach the gearmotor from conveyor.
5. Refer to Figure 1 and detach the following:

- a. Remove the four screws (G). Detach the motor (A) from the gear reducer (C). Be sure to retain motor output shaft key (B).
- b. Remove the two screws (F) and detach the output shaft cover (E).
- c. Remove and retain the gear reducer output shaft key (D).

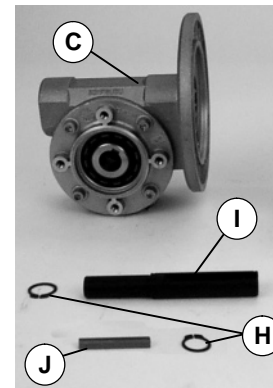

Figure 2

6. Remove and retain the retaining ring(s) (H). Remove drive shaft (I) and key (J).

NOTE: Some gear reducer shafts are secured with a flat washer and a single retaining ring. Be sure to note where washer is located and replace it in the same position onto the new gear reducer.

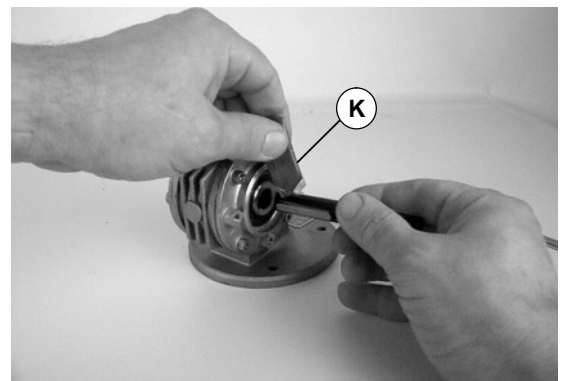

Figure 3

7. Apply anti-seize (K) to input shaft as shown.

<continued on next page>

8. Replace the original shaft components into the new gear reducer.

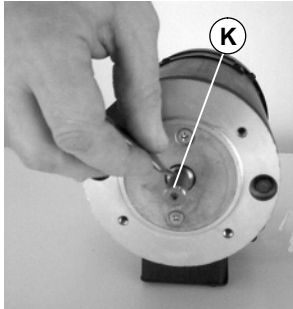

Figure 4

9. Apply anti-seize (K) to motor shaft as shown.

IMPORTANT: Be extremely careful when coupling motor to gear reducer. Avoid misalignment and forcing the connection causing possible permanent gear reducer seal damage.

10. With key (B) in keyway of motor shaft, align motor shaft with gear reducer input coupling and slide motor and gear reducer together as shown. Tightly secure motor mounting screws (G).

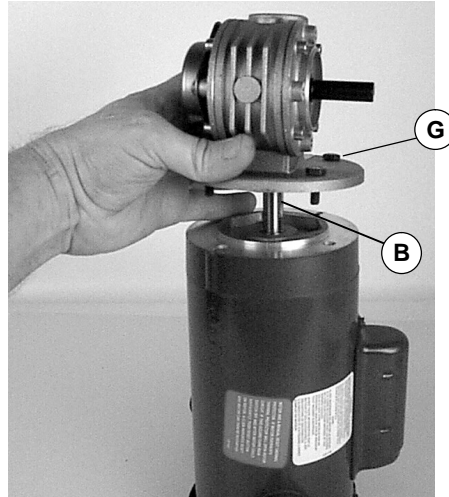

Figure 5

11. Install replacement gearmotor into original drive brackets. Replace drive coupling or timing belt and pulley. Refer to the assembly instruction originally shipped with the mounting package.

**For replacement parts, contact an authorized
Dorner Service Center or the factory.**

DORNER[®]

Dorner Mfg. Corp. reserves the right to change or discontinue products without notice. All products and services are covered in accordance with our standard warranty. All rights reserved. ©Dorner Mfg. Corp. 1999

DORNER MFG. CORP.

580 Industrial Drive, PO Box 20
Hartland, WI 53029-0020 USA
USA

TEL 1-800-397-8664 (USA)

FAX 1-800-369-2440 (USA)

Outside the USA:

TEL 1-414-367-7600, FAX 1-414-367-5827

DORNER

Arnold-Sommerfeld-Ring 2
D-52499 Baesweiler

Germany

TEL (02401) 80 52 90

FAX (02401) 80 52 93

Internet: www.dorner.com