



# **2100/2200/4100/6200 & MPB Series Bottom Mount Drive Pack. for Standard Load Parallel Shaft 60 Hz Gearmotors**

**Installation, Maintenance & Parts Manual**



DORNER MFG. CORP.  
P.O. Box 20 • 975 Cottonwood Ave.  
Hartland, WI 53029-0020 USA

INSIDE THE USA  
TEL: 1-800-397-8664  
FAX: 1-800-369-2440

OUTSIDE THE USA  
TEL: 262-367-7600  
FAX: 262-367-5827

For other service manuals visit our website at:  
[www.dorner.com/service\\_manuals.asp](http://www.dorner.com/service_manuals.asp)

---

# Table of Contents

---

Introduction .....	2	Drive or Driven Pulley Replacement .....	13
Warnings – General Safety .....	3	Gear Motor Replacement .....	13
Product Description .....	4	Service Parts.....	15
Specifications .....	4	2100, 2200, 4100, 6200 Series and MPB Series	
Installation .....	9	Flat Belt Bottom Mount Drive Package .....	15
Required Tools.....	9	MPB Series Cleated Belt Bottom Mount	
Mounting.....	9	Drive Package.....	16
Preventive Maintenance and Adjustment .....	12	4100 Series Adapter Package .....	17
Required Tools.....	12	Gear Motor .....	17
Timing Belt Tensioning .....	12	Return Policy.....	18
Timing Belt Replacement .....	12		

---

## Introduction

---

<b>IMPORTANT</b>
------------------

<i>Some illustrations may show guards removed. Do NOT operate equipment without guards.</i>
---

Upon receipt of shipment:

- Compare shipment with packing slip. Contact factory regarding discrepancies.
- Inspect packages for shipping damage. Contact carrier regarding damage.
- Accessories may be shipped loose. See accessory instructions for installation.

Dorner 2100 Series conveyors are covered by the following patent numbers: 5131529, 5174435, and corresponding patents and patent applications in other countries.

Dorner 2200 and MPB Series conveyors are covered by patent number 5174435 and corresponding patents and patent in other. countries.

Dorner 2200 and MPB Series conveyors are covered by patent number 5174435 and corresponding patents and patent applications in other countries.

Dorner 4100 Series conveyors are covered by patent number 3923148 and corresponding patents and patent applications in other countries.

Dorner 6200 Series conveyors are covered by patent numbers: 6685009, 5174435, 6109427 and corresponding patents and patent applications in other countries.

Dorner's Limited Warranty applies.

Dorner reserves the right to make changes at any time without notice or obligation.

Dorner has convenient, pre-configured kits of Key Service Parts for all conveyor products. These time saving kits are easy to order, designed for fast installation, and guarantee you will have what you need when you need it. Key Parts and Kits are marked in the Service Parts section of this manual with the Performance Parts Kits logo .

## Warnings – General Safety

### WARNING

The safety alert symbol, black triangle with white exclamation, is used to alert you to potential personal injury hazards.

### DANGER



Climbing, sitting, walking or riding on conveyor will cause severe injury.  
**KEEP OFF CONVEYORS.**

### DANGER



**Do NOT OPERATE CONVEYORS IN AN EXPLOSIVE ENVIRONMENT.**

### WARNING



Exposed moving parts can cause severe injury.  
**LOCK OUT POWER** before removing guards or performing maintenance.

### WARNING



Gearmotors may be **HOT**.  
**DO NOT TOUCH** Gearmotors.

### WARNING



Exposed moving parts can cause severe injury.  
**REPLACE ALL GUARDS BEFORE RUNNING CONVEYOR.**

### WARNING



Dorner cannot control the physical installation and application of conveyors. Taking protective measures is the responsibility of the user.  
When conveyors are used in conjunction with other equipment or as part of a multiple conveyor system, **CHECK FOR POTENTIAL PINCH POINTS** and other mechanical hazards before system start-up.

### WARNING



MPB Series Conveyors are not reversible. Reversing creates pinch points which can cause severe injury.  
**DO NOT REVERSE MPB SERIES CONVEYORS.**

# Product Description

Refer to Figure 1 for typical conveyor components.

A	Conveyor
B	Mounting Bracket
C	Gearmotor
D	Timing Belt Tensioner
E	Cover
F	Timing Belt
G	Drive Pulley
H	Driven Pulley

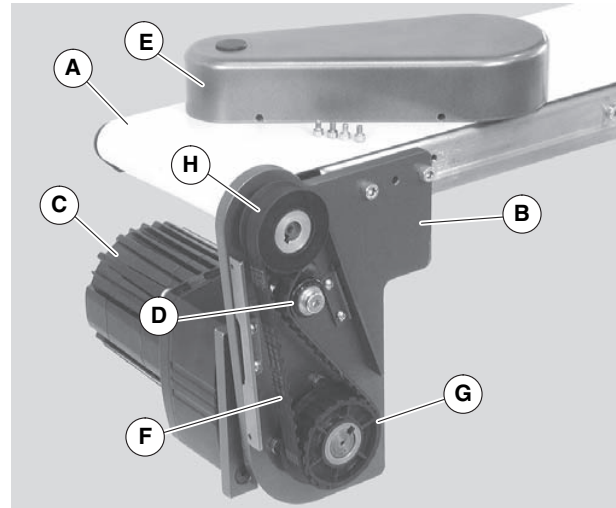

Figure 1

## Specifications

### Gearmotor Mounting Package Models:

Example:

**2 M B P S W W A - 32 32**

- Driven Pulley (see Table 2 & 3)
- Drive Pulley (see Table 2 & 3)
- Belt Type ( - = flat belt, A through J = cleated belt )
- Mount Position = A, B, C or D (see detail to the right)
- Conveyor Width Reference\*
- Gearmotor Type = Standard Load, Industrial
- Output Shaft Type = Parallel Shaft
- Mount Style
  - B = Bottom Mount
  - F = Flush Mount (2200 Series Only)
- Language Code = U.S. English

2 = 2100 Series Conveyor  
 22 = 2200 Series Conveyor  
 4 = 4100 Series Conveyor  
 6 = 6200 Series Conveyor  
 2P = MPB Series Conveyor

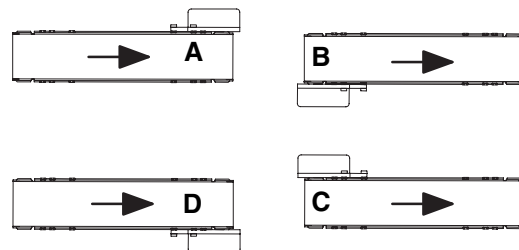

\* See Ordering and Specifications Catalog for details.

### Table 1: Gearmotor Specifications

	Single Phase	Three Phase	DC Variable Speed
Output Power	0.17 hp (0.13 kw)		0.25 hp (0.19 kw)
Input Voltage	115 Volts A.C.	230 Volts A.C.	130 Volts D.C.
Input Frequency	60 Hz		N/A
Input Current	1.9 Amperes	1.2 Amperes	1.8 Amperes
Motor RPM	1725		2500
Gearmotor Ratios	5:1, 10:1, 20:1, 30:1, 60:1, 180:1		
Motor Type	Totally enclosed, Fan-cooled		Totally enclosed, Non-ventilated

2100/2200/4100/6200 & MPB Series Bottom Mount Drive Pack. for Standard Load Parallel Shaft 60 Hz Gearmotors

# Specifications

**Table 2: Belt Speeds for Standard Load Fixed Speed Parallel Shaft 60 Hz Gearmotors on 2100, 2200 Gang Drive, 4100 and 6200 Series Conveyors**

Gearmotors					Belt Speed		Drive Pulley	Driven Pulley
Part Number	Ratio	RPM	In-lb	N-m	Ft/min	M/min		
62M180PS4(vp)F(n)	180:1	10	341	38.5	2	0.6	22	32
62M180PS4(vp)F(n)	180:1	10	341	38.5	3	0.9	32	32
62M180PS4(vp)F(n)	180:1	10	341	38.5	4	1.2	48	32
62M060PS4(vp)F(n)	60:1	29	270	30.5	6	1.7	22	32
62M060PS4(vp)F(n)	60:1	29	270	30.5	8	2.4	32	32
62M060PS4(vp)F(n)	60:1	29	270	30.5	12	3.7	48	32
62M030PS4(vp)F(n)	30:1	58	135	15.3	16	4.9	32	32
62M020PS4(vp)F(n)	20:1	86	90	10.2	25	7.6	32	32
62M020PS4(vp)F(n)	20:1	86	90	10.2	37	11.3	48	32
62M010PS4(vp)F(n)	10:1	173	45	5.1	49	14.9	32	32
62M010PS4(vp)F(n)	10:1	173	45	5.1	74	22.6	48	32
62M005PS4(vp)F(n)	5:1	345	25	2.8	99	30.2	32	32
62M005PS4(vp)F(n)	5:1	345	25	2.8	148	45.1	48	32
62M005PS4(vp)F(n)	5:1	345	25	2.8	169	51.5	48	28
62M005PS4(vp)F(n)	5:1	345	25	2.8	197	60.0	44	22
62M005PS4(vp)F(n)	5:1	345	25	2.8	215	65.5	48	22
62M005PS4(vp)F(n)	5:1	345	25	2.8	249	75.9	48	19

(vp) = voltage and phase

(n) = reversing capability

11 = 115V, 1-phase

N = no reversing switch

23 = 230V, 3-phase

R = with reversing switch (115V, 1 phase only)

**Table 3: Belt Speeds for Standard Load Fixed Speed Parallel Shaft 60 Hz Gearmotors on 2200 Series Conveyors (Excluding Gang Drive)**

Gearmotors*					Belt Speed		Drive Pulley	Driven Pulley
Part Number	Ratio	RPM	In-lb	N-m	Ft/min	M/min		
62M180PS4(vp)F(n)	180:1	10	341	38.5	3	0.9	28	28
62M180PS4(vp)F(n)	180:1	10	341	38.5	5	1.5	44	22
62M060PS4(vp)F(n)	60:1	29	270	30.5	6	1.7	19	32
62M060PS4(vp)F(n)	60:1	29	270	30.5	10	3.0	28	28
62M060PS4(vp)F(n)	60:1	29	270	30.5	16	4.9	44	28
62M020PS4(vp)F(n)	20:1	86	90	10.2	30	9.1	28	28
62M020PS4(vp)F(n)	20:1	86	90	10.2	48	14.6	44	28
62M010PS4(vp)F(n)	10:1	173	45	5.1	61	18.6	28	28
62M010PS4(vp)F(n)	10:1	173	45	5.1	95	29.0	44	28
62M010PS4(vp)F(n)	10:1	173	45	5.1	104	31.7	48	28
62M005PS4(vp)F(n)	5:1	345	25	2.8	121	36.9	28	28
62M005PS4(vp)F(n)	5:1	345	25	2.8	138	42.1	32	28
62M005PS4(vp)F(n)	5:1	345	25	2.8	176	53.6	32	22
62M005PS4(vp)F(n)	5:1	345	25	2.8	208	63.4	48	28
62M005PS4(vp)F(n)	5:1	345	25	2.8	242	73.8	44	22
62M005PS4(vp)F(n)	5:1	345	25	2.8	264	80.5	48	22

(vp) = voltage and phase

(n) = reversing capability

11 = 115 V, 1-phase

N = no reversing switch

23 = 230V, 3-phase

R = with reversing switch (115V, 1 phase only)

# Specifications

**Table 4: Belt Speeds for Standard Load Fixed Speed Parallel Shaft 60 Hz Gearmotors on MPD Series Conveyors**

Gearmotors					Belt Speed		Drive Pulley	Driven Pulley
Part Number	Gear Ratio	RPM	In-lb	N-m	Ft/min	M/min		
62M180PS4(vp)F(n)	180:1	10	341	38.5	4.5	1.4	22	32
62M060PS4(vp)F(n)	60:1	29	270	30.5	6	1.7	19	32
62M180PS4(vp)F(n)	180:1	10	341	38.5	6.5	2	28	28
62M060PS4(vp)F(n)	60:1	29	270	30.5	13	4.0	22	32
62M060PS4(vp)F(n)	60:1	29	270	30.5	20	6.0	28	28
62M030PS4(vp)F(n)	30:1	58	135	15.3	39	11.9	28	28
62M020PS4(vp)F(n)	20:1	86	90	10.2	59	17.9	28	28

(vp) = voltage and phase

(n) = reversing capability

11 = 115V, 1-phase

N = no reversing switch

23 = 230V, 3-phase

R = with reversing switch (115V, 1 phase only)

**Table 5: Belt Speeds for Standard Load Variable Speed Parallel Shaft VFD Gearmotors on 2100, 4100 and 6200 Series Conveyors**

Gearmotors					Belt Speed		Drive Pulley	Driven Pulley
Part Number	Gear Ratio	RPM*	In-lb*	N-m*	Ft/min	M/min		
62M060PS423EN	60:1	29	270	30.5	.6–5.6	.2–1.7	22	32
62M060PS423EN	60:1	29	270	30.5	.8–8.2	.3–2.5	32	32
62M020PS423EN	20:1	86	167	18.9	2.5–25	.8–7.5	32	32
62M010PS423EN	10:1	173	115	13	4.9–49	1.5–15	32	32
62M005PS423EN	5:1	345	58	6.5	9.9–99	3–30	32	32
62M005PS423EN	5:1	345	58	6.5	14–148	4.5–45	48	32
62M005PS423EN	5:1	345	58	6.5	19–197	6–60	44	22
62M005PS423EN	5:1	345	58	6.5	24–249	7.6–76	48	19

\* At 60 Hz

**Table 6: Belt Speeds for Standard Load Variable Speed Parallel Shaft VFD Gearmotors on 2200 Series Conveyors (Excluding Gang Drive)**

Gearmotors*					Belt Speed		Drive Pulley	Driven Pulley
Part Number	Gear Ratio	RPM*	In-lb*	N-m*	Ft/min	M/min		
62M060PS423EN	60:1	29	270	30.5	.6–6	.2–1.8	19	32
62M060PS423EN	60:1	29	270	30.5	1–10	.3–3.1	28	28
62M020PS423EN	20:1	86	167	18.9	3–30	.9–9.2	28	28
62M010PS423EN	10:1	173	115	13	6–60	1.8–18	28	28
62M010PS423EN	10:1	173	115	13	10–104	3.2–32	48	28
62M005PS423EN	5:1	345	58	6.5	12–121	3.7–37	28	28
62M005PS423EN	5:1	345	58	6.5	26–264	8.1–81	48	22

\* At 60 Hz

# Specifications

**Table 7: Belt Speeds for Standard Load Variable Speed Parallel Shaft VFD Gearmotors on MPD Series Conveyors**

Gearmotors					Belt Speed		Drive Pulley	Driven Pulley
Part Number	Gear Ratio	RPM*	In-lb*	N-m*	Ft/min	M/min		
62M060PS423EN	60:1	29	270	30.5	1.3–13.	.4–4.1	22	32
62M060PS423EN	60:1	29	270	30.5	4.2–19	.9–5.9	28	28
62M020PS423EN	20:1	86	167	18.9	5.9–59	1.8–18	28	28
62M010PS423EN	10:1	173	115	13	11–117	3.6–36	28	28
62M010PS423EN	10:1	173	115	13	17–175	5.4–54	48	32
62M005PS423EN	5:1	345	58	6.5	23–234	7.1–71	28	28

\* At 60 Hz

**Table 8: Belt Speeds for Standard Load Variable Speed Parallel Shaft DC Gearmotors on 2100, 4100 and 6200 Series Conveyors**

Gearmotors					Belt Speed		Drive Pulley	Driven Pulley
Part Number	Gear Ratio	RPM	In-lb	N-m	Ft/min	M/min		
62M180PSD3DEN	180:1	14	341	38.5	.3–2.7	.1–.8	22	32
62M180PSD3DEN	180:1	14	341	38.5	.5–4	.1–1.2	32	32
62M060PSD3DEN	60:1	42	270	30.5	1.0–8.2	.3–2.5	22	32
62M060PSD3DEN	60:1	42	270	30.5	1.4–12	.4–3.6	32	32
62M030PSD3DEN	30:1	83	135	15.3	2.9–24	.9–7.3	32	32
62M020PSD3DEN	20:1	125	90	10.2	4.3–36	1.3–11	32	32
62M010PSD3DEN	10:1	250	72	8.1	9–71	2.6–22	32	32
62M005PSD3DEN	5:1	500	25	2.8	17–143	5.2–43	32	32
62M005PSD3DEN	5:1	500	25	2.8	26–214	7.8–65	48	32
62M005PSD3DEN	5:1	500	25	2.8	29–245	9.0–75	48	28

**Table 9: Belt Speeds for Standard Load Variable Speed Parallel Shaft DC Gearmotors on 2200 Series Conveyors (Excluding Gang Drive)**

Gearmotors					Belt Speed		Drive Pulley	Driven Pulley
Part Number	Gear Ratio	RPM	In-lb	N-m	Ft/min	M/min		
62M180PSD3DEN	180:1	14	341	38.5	.4–3.4	.1–1.0	22	32
62M180PSD3DEN	180:1	14	341	38.5	.6–5	.2–1.5	28	28
62M060PSD3DEN	60:1	42	270	30.5	1.8–14	.5–4.5	28	28
62M060PSD3DEN	60:1	42	270	30.5	2.8–23	.8–7	44	28
62M030PSD3DEN	30:1	83	135	15.3	3.5–29	1.1–9	28	28
62M020PSD3DEN	20:1	125	90	10.2	5.3–44	1.6–13	28	28
62M010PSD3DEN	10:1	250	72	8.1	10–88	3.2–27	28	28
62M005PSD3DEN	5:1	500	25	2.8	17–138	5–42	44	28
62M005PSD3DEN	5:1	500	25	2.8	21–176	6.4–54	28	28
62M005PSD3DEN	5:1	500	25	2.8	33–276	10–84	44	28

# Specifications

**Table 10: Belt Speeds for Standard Load Variable Speed Parallel Shaft DC Gearmotors on MPB Series Conveyors**

Gearmotors					Belt Speed		Drive Pulley	Driven Pulley
Part Number	Gear Ratio	RPM	In-lb	N-m	Ft/min	M/min		
62M180PSD3DEN	180:1	14	341	38.5	1.1–9	.3–2.9	28	28
62M060PSD3DEN	60:1	42	270	30.5	2.3–19	.7–5.9	22	32
62M060PSD3DEN	60:1	42	270	30.5	3.4–28	1–8.6	28	28
62M060PSD3DEN	60:1	42	270	30.5	5.3–44	1.6–13	44	28
62M030PSD3DEN	30:1	83	135	15.3	6.8–57	2.1–17	28	28
62M020PSD3DEN	20:1	125	90	10.2	10–85	3–26	28	28
62M020PSD3DEN	20:1	125	90	10.2	15–127	4.7–39	48	32
62M010PSD3DEN	10:1	250	72	8.1	20–170	6–52	28	28
62M010PSD3DEN	10:1	250	72	8.1	31–255	9–77	48	32

\* = Cleated and Sidewall Cleated belts operate at a maximum of 150 Ft/min (45.7 m/min)

## NOTE

*For belt speed other than those listed, contact factory for details.*



## Required Tools

- Hex key wrenches:  
2 mm, 2.5 mm, 3 mm, 5 mm
- Torque wrench

## Mounting

### ⚠ WARNING



**Exposed moving parts can cause severe injury.**  
**LOCK OUT POWER** before removing guards or performing maintenance.

### ⚠ WARNING



**MPB Series Conveyors are not reversible.**  
**Reversing creates pinch points which can cause severe injury.**  
**DO NOT REVERSE MPB SERIES CONVEYORS.**

### ⚠ WARNING



**For MPB Series and Cleated Belt Conveyors Gearmotors must be mounted as shown in Figure 2.**  
**Failure to do so creates pinch points which can cause severe injury.**

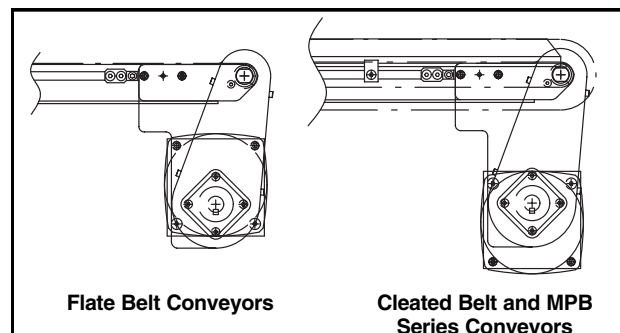

**Figure 2**

### NOTE

*Gearmotor position on Flat Belt conveyor shown at left (Figure 2). Gearmotor position on Cleated Belt or MPB Series conveyor shown at right (Figure 2).*

1. Typical components (Figure 3)

### Installation Component List:

I	Bottom Mount Assembly
J	Drive Pulley
K	Cover
L	M4 Socket Head Screws (4x)
M	Driven Pulley
N	Key
O	M6 Socket Head Screws (2x)
P	Timing Belt

### NOTE

*Flat belt mounting package shown below (Figure 3), cleated belt mounting package similar.*

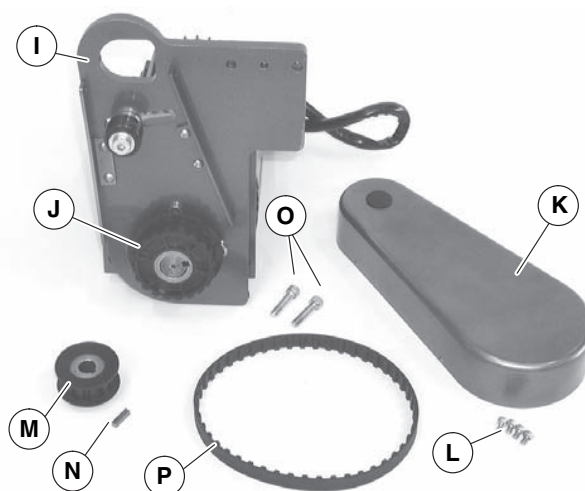

**Figure 3**

# Installation

2. For your reference, the following figures show the attachment area of complete mounting packages for the various conveyor series.

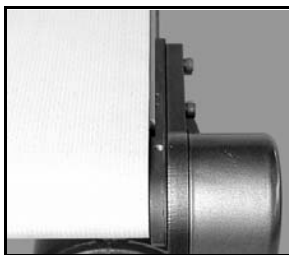

**2200 Series**

**Figure 4**



**6200 Series**

**Figure 5**

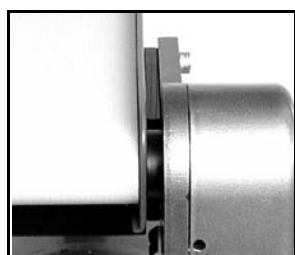

**4100 Series**

**Figure 6**

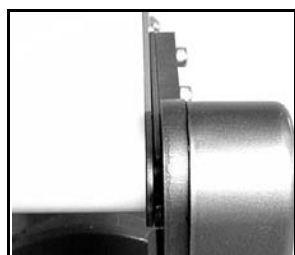

**2100 Series**

**Figure 7**

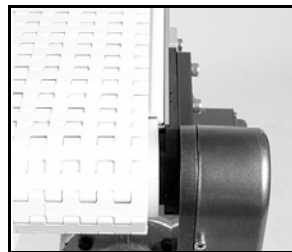

**MPB Series**

**Figure 8**

## NOTE

*6200 conveyor shown, other Series similar.*

3. Locate drive output shaft (Figure 9, item R) and remove two screws (S).

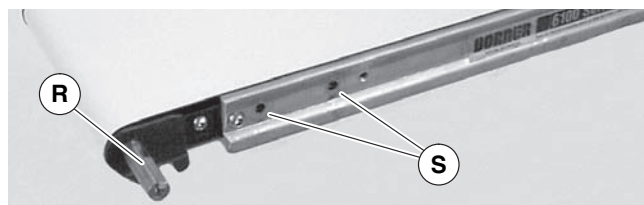

**Figure 9**

4. Attach mounting assembly (Figure 10, item I) with screws (O). Tighten to 80 in-lb (9 Nm).

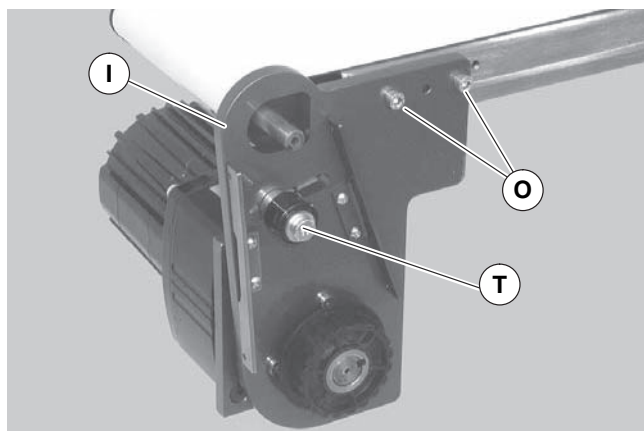

**Figure 10**

## ⚠ WARNING



**Drive shaft keyway may be sharp.  
HANDLE WITH CARE.**

5. Install key (Figure 11, item N).

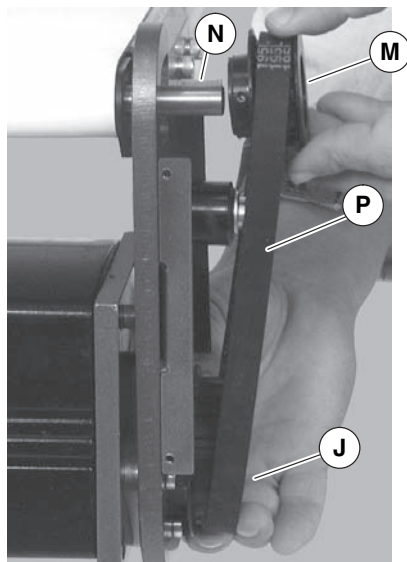

**Figure 11**

6. Wrap timing belt (P) around driven pulley (M) and drive pulley (J). Install driven pulley (M) onto conveyor shaft.
7. Remove cam bearing and spacer (Figure 10, item T). Place the cam bearing and spacer (Figure 12, item T) next to the driven pulley (M). Ensure the flanges of the driven pulley are aligned with the cam bearing. Tighten driven pulley set screws (U). This will allow for proper belt alignment while conveyor is in use. Replace cam bearing and spacer (T).

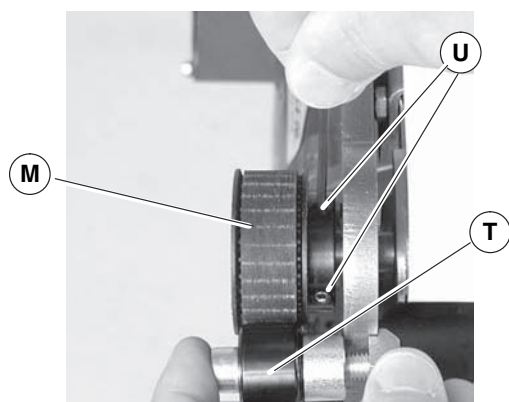

**Figure 12**

8. Depending on direction of conveyor belt travel (1 or 2 of Figure 13), position belt tensioner (V) as shown. Tension belt to obtain 0.125" (3 mm) deflection for 1.0 lb (456 grams) of force at belt mid-point (W). Tighten tensioner screw to 103 in-lb (12 Nm).

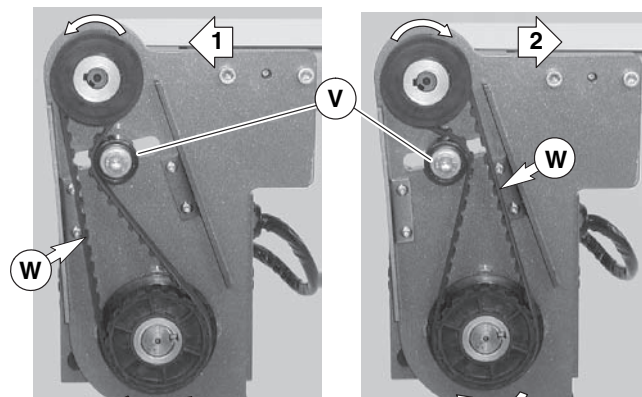

**Figure 13**

9. Install cover (Figure 14, item K) with four (4) screws (L). Tighten to 35 in-lb (4 Nm).

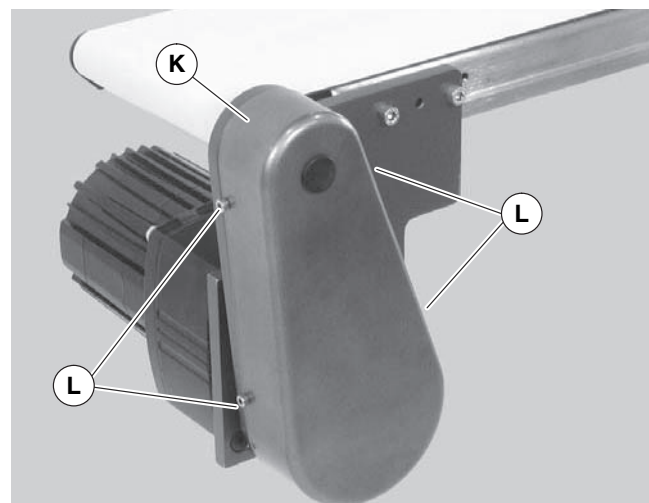

**Figure 14**

# Preventive Maintenance and Adjustment

## Required Tools

- Hex key wrenches:  
2 mm, 2.5 mm, 3 mm, 5 mm
- Adjustable wrench (for hexagon head screws)
- Straight edge
- Torque wrench

## Timing Belt Tensioning

### ⚠ WARNING



**Exposed moving parts can cause severe injury.**  
**LOCK OUT POWER** before removing guards or performing maintenance.

1. Remove four (4) screws (Figure 14, item L) and remove cover (K).
2. Loosen tensioner (Figure 15, item V).

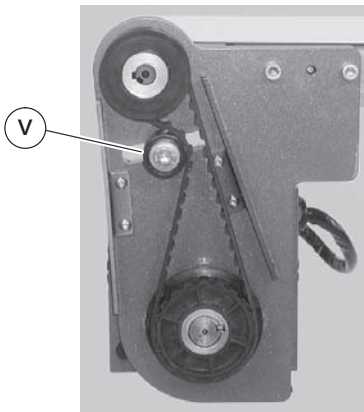

**Figure 15**

3. Depending on direction of conveyor belt travel (1 or 2 of Figure 13), position belt tensioner (V) as shown. Tension belt to obtain 0.125" (3 mm) deflection for 1.0 lb (456 grams) of force at belt mid-point (W). Tighten tensioner screw to 103 in-lb (12 Nm).
4. Install cover (Figure 14, item K) with four (4) screws (L). Tighten to 35 in-lb (4 Nm).

## Timing Belt Replacement

### ⚠ WARNING



**Exposed moving parts can cause severe injury.**  
**LOCK OUT POWER** before removing guards or performing maintenance.

1. Remove four (4) screws (Figure 14, item L) and remove cover (K).
2. Loosen tensioner (Figure 15, item V).
3. Remove timing belt (Figure 16, item P).

### NOTE

*If timing belt does not slide over pulley flange, loosen driven pulley set screws (Figure 16, item U) and remove pulley with belt (P). For re-installation, see steps 6 and Figure 11 on page 11.*

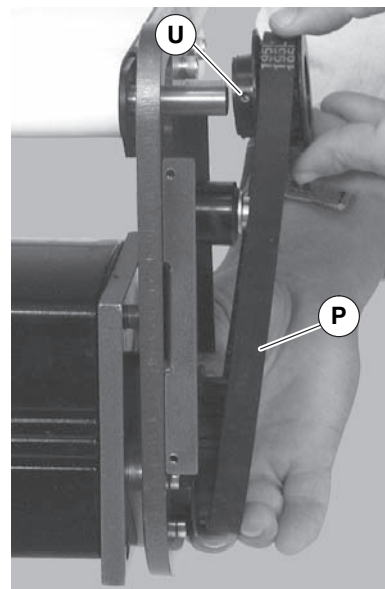

**Figure 16**

4. Install new timing belt.
5. Depending on direction of conveyor belt travel (1 or 2 of Figure 11), position belt tensioner (V) as shown. Tension belt to obtain 0.125" (3 mm) deflection for 1.0 lb (456 grams) of force at belt mid-point (W). Tighten tensioner screw to 103 in-lb (12 Nm).
6. Install cover (Figure 14, item K) with four (4) screws (L). Tighten to 35 in-lb (4 Nm).

# Preventive Maintenance and Adjustment

## Drive or Driven Pulley Replacement

### ⚠ WARNING



Exposed moving parts can cause severe injury.

**LOCK OUT POWER** before removing guards or performing maintenance.

1. Complete steps 1 through 3 of “Timing Belt Replacement” section on page 12.
2. Loosen set screws and remove drive or driven pulley.

### NOTE

*If drive pulley (Figure 19, item J) is replaced, wrap timing belt around drive pulley and complete step 3.*

3. Complete steps 6 through 9 of “Installation” section on page 11.

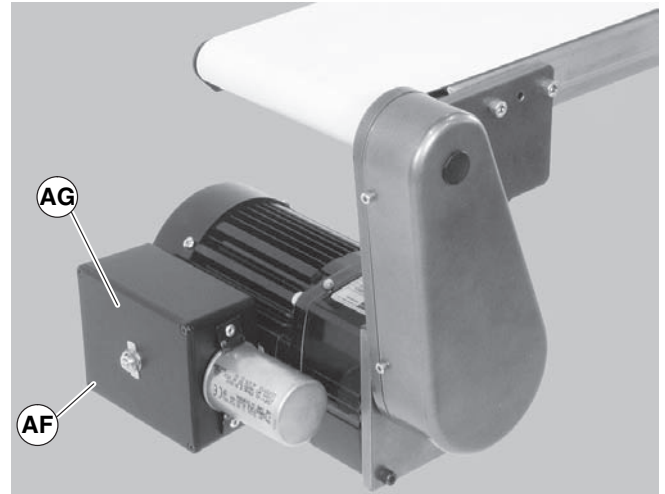

**Figure 17**

- a. Record incoming wire colors on red, black and blue leads. Loosen wire nuts and remove incoming wires.
  - c. Loosen cord grip and remove cord.
3. For DC variable speed motor, unplug motor cord at disconnect (Figure 18, item AH).

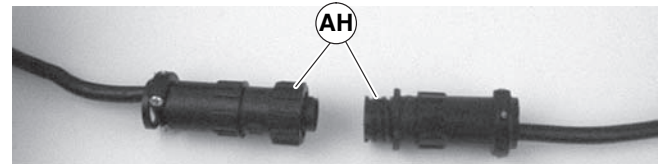

**Figure 18**

## Gear Motor Replacement

### ⚠ WARNING



Exposed moving parts can cause severe injury.

**LOCK OUT POWER** before removing guards or performing maintenance.

### ⚠ DANGER



Hazardous voltage will cause severe injury or death.

**LOCKOUT POWER BEFORE** before wiring.

1. For single phase motor, unplug power cord from outlet.
2. For three phase motor:
  - a. Loosen terminal box screws (Figure 17, item AF) and remove cover (AG).

4. Remove four (4) screws (Figure 14, item L) and remove cover (K).
5. Loosen tensioner (Figure 15, item V).
6. Loosen drive pulley set screws (Figure 19, item X). Remove drive pulley (J) and timing belt (P).

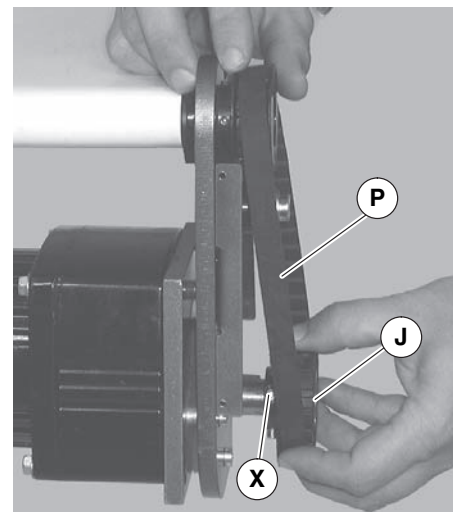
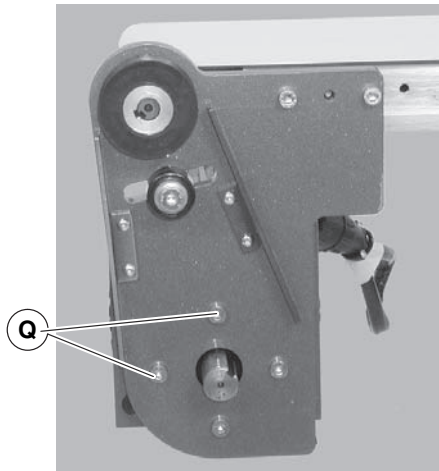

**Figure 19**



# Preventive Maintenance and Adjustment

7. Remove four (4) gearmotor mounting screws (Figure 20, item Q). Remove gearmotor with adapter plate.



**Figure 20**

8. Remove four (4) adapter plate screws (Figure 21, item AI). Remove adapter plate.

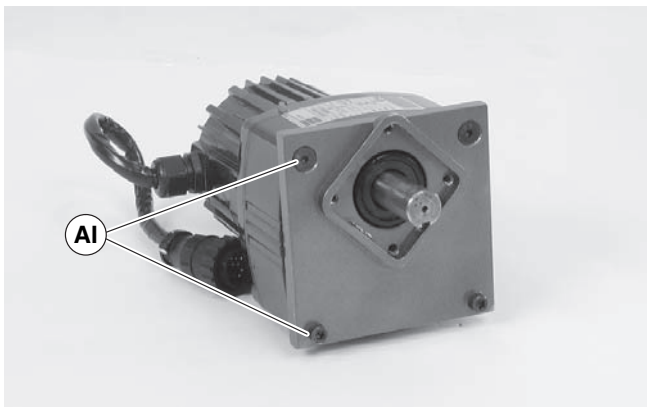

**Figure 21**

## NOTE

*Gearmotor position on Flat Belt conveyor shown at left (Figure 22). Gearmotor position on Cleated Belt or MPB Series conveyor shown at right (Figure 22).*

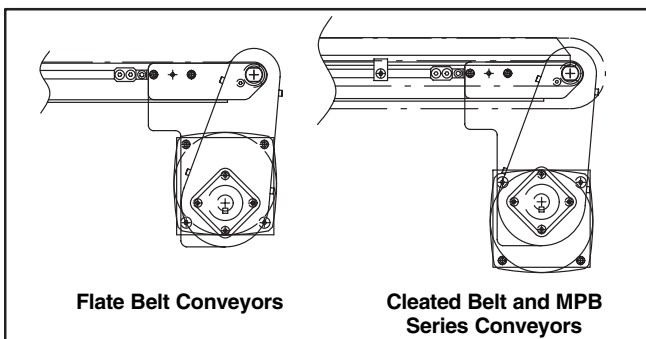

**Figure 22**

9. Install new gearmotor to adapter plate and mounting bracket. Tighten screws (Figure 20, item Q) to 103 in-lb (12 Nm).

## NOTE

*Drive pulley (Figure 19, item J) is removed. Wrap timing belt around drive pulley and complete step 10.*

10. Complete steps 6 through 9 of “Installation” section on page 11.
11. Replace wiring:
- For a single phase motor, reverse step 1 on page 13.
  - For a three phase motor, reverse step 2, on page 13.
  - For a DC variable speed motor, reverse step 3 on page 13.

## NOTE

*For replacement parts other than those shown in this section, contact an authorized Dorner Service Center or the factory. Key Service Parts and Kits are identified by the Performance Parts Kits logo . Dorner recommends keeping these parts on hand.*

## 2100, 2200, 4100, 6200 Series and MPB Series Flat Belt Bottom Mount Drive Package

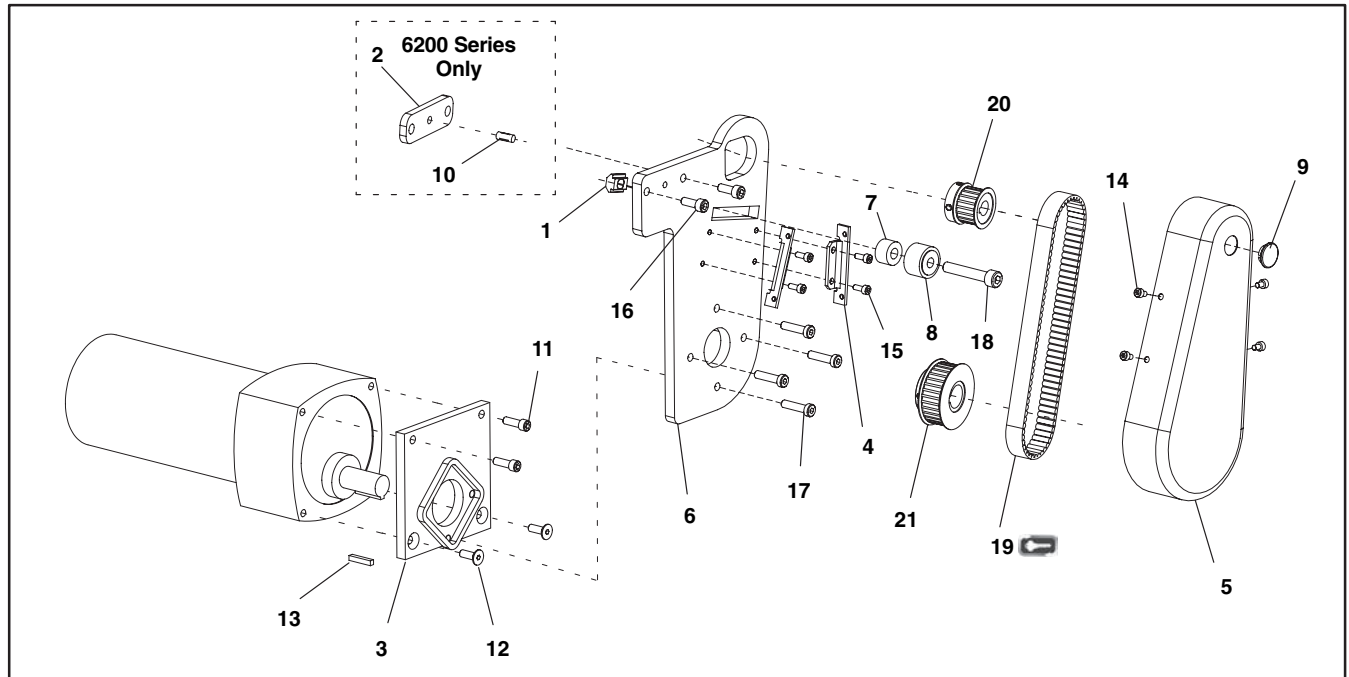

Item	Part Number	Description
1	202390M	Nut, Cam Follower
2	450027M	Adaptor Plate Assembly (6200 Only)
3	450029M	Adaptor Plate Assembly
4	450375M	Cover Mounting Bracket
5	450376M	Drive Guard
6	450443M	Grove Mounting Plate
	242532	Flush Mounting Plate (Flush Drive Only)
7	450445	Spacer, Cam Follower
8	802-046	Bearing
9	807-226	Snap-out Plastic Plug
10	807-952	Groove Pin (6200 Only)
11	902-157	Socket Head Screw, 1/4-28 x 0.75"
12	903-161	Flat Head Screw, 1/4-28 x 0.75"
13	912-084	Square Key, 0.188 x 1.5"
14	920406M	Socket Head Screw, M4 x 6mm
15	920410M	Socket Head Screw, M4 x 10mm
	920408M	Socket Head Screw, M8 x 10mm (Flush Drive Only)
16	920625M	Socket Head Screw, M6 x 25mm
	920616M	Socket Head Screw, M6 x 16mm (4100 Conveyors)
	920630M	Socket Head Screw, M6 x 30mm (6200 Conveyors)
	920622M	Socket Head Screw, M6 x 22mm (Flush Drive Only)

Item	Part Number	Description
17	920695M	Socket Low Head Screw M6 x 20mm
18	920845M	Socket Head Screw, M8 x 45mm
	920840M	Socket Head Screw, M8 x 40mm (Flush Drive Only)
19	814-104	Timing Belt, 15mm W x 450mm L
	814-105	Timing Belt, 15mm W x 460mm L
	814-065	Timing Belt, 15mm W x 475mm L
	814-112	Timing Belt, 15mm W x 495mm L
	814-101	Timing Belt, 15mm W x 500mm L
	814-108	Timing Belt, 15mm W x 520mm L
	814-064	Timing Belt, 15mm W x 535mm L
	814-099	Timing Belt, 15mm W x 565mm L
20	450365MP	Driven Pulley, 19Tooth, 12mm bore
	450366MP	Driven Pulley, 22Tooth, 12mm bore
	450367MP	Driven Pulley, 28Tooth, 12mm bore
	450368MP	Driven Pulley, 32Tooth, 12mm bore
	243325	Driven Pulley, 16Tooth, 12mm bore (Flush Drive Only)
21	450434	Drive Pulley, 22Tooth, 0.75" bore
	450435	Drive Pulley, 28Tooth, 0.75" bore
	450436	Drive Pulley, 32Tooth, 0.75" bore
	450437	Drive Pulley, 44Tooth, 0.75" bore
	450438	Drive Pulley, 48Tooth, 0.75" bore

## MPB Series Cleated Belt Bottom Mount Drive Package

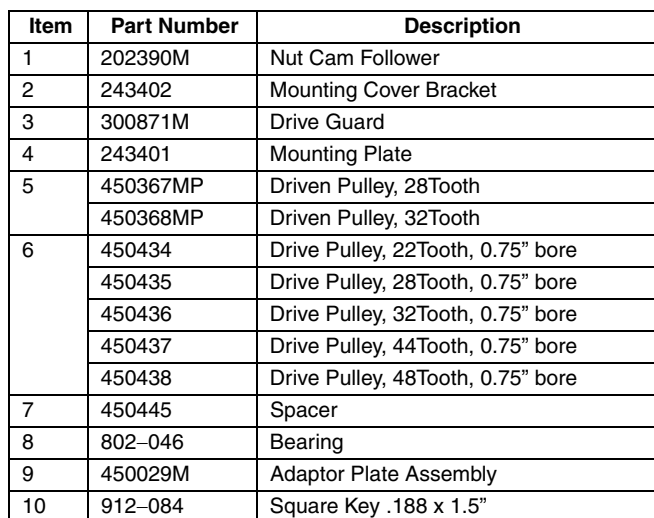

2100/2200/4100/6200 & MPB Series Bottom Mount Drive Pack. for Standard Load Parallel Shaft 60 Hz Gearmotors  
Dorner Mfg. Corp. 16 851-254 Rev. K



## 4100 Series Adapter Package

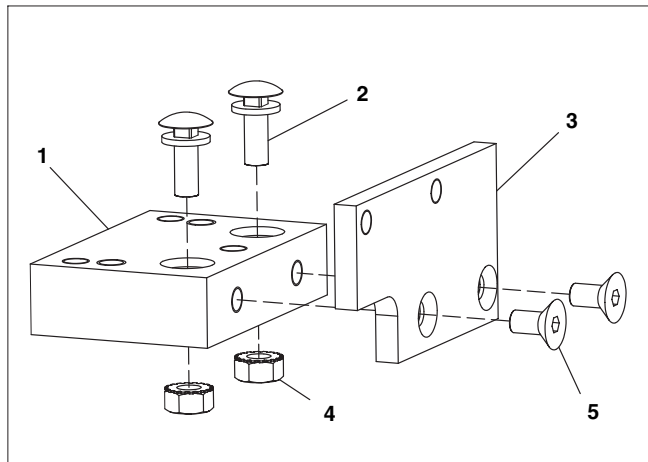

Item	Part No.	Part Description
1	609486	Mounting Block 1" (25mm)
	609487	Mounting Block 2" (51mm)
	609488	Mounting Block 3" (76mm)
	609479	Mounting Block 4" (102mm)
	609480	Mounting Block 5" (127mm)
	609481	Mounting Block 6" (152mm)
	609482	Mounting Block 7" (178mm)
	609483	Mounting Block 8" (203mm)
	609484	Mounting Block 10" (254mm)
	609485	Mounting Block 12" (305mm)
2	613602P	Bolt & Flat Washer Assembly
3	450374	Drive Adapter Plate
4	910-126	Hex Nut with Lock Washer
5	930612M	Flat Head Screw M6 x 12mm

## Gear Motor

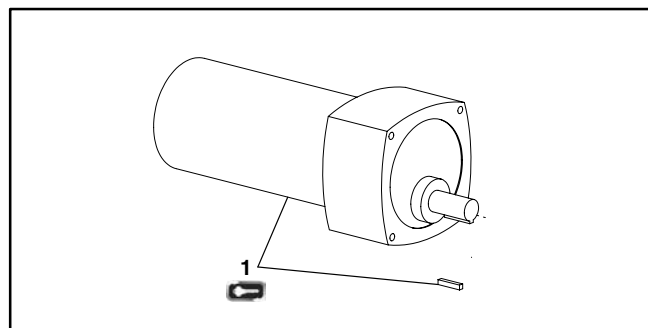

Item	Part No.	Part Description
1	62M180PS411FN	Motor, 0.08hp (0.06Kw), 10 RPM, 115VAC, 60Hz, 1-Phase
	62M180PS411FR	Motor, 0.08hp (0.06Kw), 10 RPM, 115VAC, 60Hz, 1-Phase w/ reversing switch
	62M060PS411FN	Motor, 0.17hp (0.13Kw), 29 RPM, 115VAC, 60Hz, 1-Phase
	62M060PS411FR	Motor, 0.17hp (0.13Kw), 29 RPM, 115VAC, 60Hz, 1-Phase w/ reversing switch
	62M060PS423FN	Motor, 0.25hp (0.19Kw), 29 RPM, 230VAC, 60Hz, 3-Phase
	62M030PS411FN	Motor, 0.17hp (0.13Kw), 58 RPM, 115VAC, 60Hz, 1-Phase
	62M030PS411FR	Motor, 0.17hp (0.13Kw), 58 RPM, 115VAC, 60Hz, 1-Phase w/ reversing switch
	62M030PS423FN	Motor, 0.25hp (0.19Kw), 58 RPM, 230VAC, 60Hz, 3-Phase
	62M020PS411FN	Motor, 0.17hp (0.13Kw), 86 RPM, 230VAC, 60Hz, 1-Phase
	62M020PS411FR	Motor, 0.17hp (0.13Kw), 86 RPM, 115VAC, 60Hz, 1-Phase w/ reversing switch
	62M010PS411FN	Motor, 0.17hp (0.13Kw), 173 RPM, 115VAC, 60Hz, 1-Phase
	62M010PS411FR	Motor, 0.17hp (0.13Kw), 173 RPM, 115VAC, 60Hz, 1-Phase w/ reversing switch
	62M010PS423FN	Motor, 0.25hp (0.19Kw), 173 RPM, 230VAC, 60Hz, 3-Phase
	62M005PS411FN	Motor, 0.17hp (0.13Kw), 345 RPM, 230VAC, 60Hz, 1-Phase
	62M005PS411FR	Motor, 0.17hp (0.13Kw), 345 RPM, 115VAC, 60Hz, 1-Phase w/ reversing switch
	62M180PSD3DEN	Motor, 0.12hp (0.09Kw), 14 RPM, 130VDC
	62M060PSD3DEN	Motor, 0.25hp (0.19Kw), 42 RPM, 130VDC
	62M030PSD3DEN	Motor, 0.25hp (0.19Kw), 83 RPM, 130VDC
	62M020PSD3DEN	Motor, 0.25hp (0.19Kw), 125 RPM, 130VDC
	62M010PSD3DEN	Motor, 0.25hp (0.19Kw), 250 RPM, 130VDC
	62M005PSD3DEN	Motor, 0.25hp (0.19Kw), 500 RPM, 130VDC

# Return Policy

Returns must have prior written factory authorization or they will not be accepted. Items that are returned to Dorner without authorization will not be credited nor returned to the original sender. When calling for authorization, please have the following information ready for the Dorner factory representative or your local distributor:

1. Name and address of customer.
2. Dorner part number(s) of item(s) being returned.
3. Reason for return.
4. Customer's original order number used when ordering the item(s).
5. Dorner or distributor invoice number (if available, part serial number).

A representative will discuss action to be taken on the returned items and provide a Returned Goods Authorization (RMA) number for reference. RMA will automatically close 30 days after being issued. To get credit, items must be new and undamaged. There will be a return charge on all items returned for credit, where Dorner was not at fault. It is the customer's responsibility to prevent damage during return shipping. Damaged or modified items will not be accepted. The customer is responsible for return freight.

## Conveyors and conveyor accessories

Standard catalog conveyors	30%
MPB, 7200, 7300 Series, cleated and specialty belt	50%
AquaGard & AquaPruf Series conveyors	non-returnable items
Engineered to order products	case by case
Drives and accessories	30%
Sanitary stand supports	non-returnable items

## Parts

Standard stock parts	30%
Plastic chain, cleated and specialty belts	non-returnable items

Returns will not be accepted after 60 days from original invoice date. The return charge covers inspection, cleaning, disassembly, disposal and reissuing of components to inventory. If a replacement is needed prior to evaluation of returned item, a purchase order must be issued. Credit (if any) is issued only after return and evaluation is complete.

Dorner has representatives throughout the world. Contact Dorner for the name of your local representative. Our Customer Service Team will gladly help with your questions on Dorner products.

For a copy of Dorner's Warranty, contact factory, distributor, service center or visit our website at [www.dorner.com](http://www.dorner.com).

For replacement parts, contact an authorized Dorner Service Center or the factory.



Dorner Mfg. Corp. reserves the right to change or discontinue products without notice. All products and services are covered in accordance with our standard warranty. All rights reserved. © Dorner Mfg. Corp. 2010

## DORNER MFG. CORP.

975 Cottonwood Ave., PO Box 20  
Hartland, WI 53029-0020 USA  
TEL 1-800-397-8664 (USA)  
FAX 1-800-369-2440 (USA)  
Internet: [www.dorner.com](http://www.dorner.com)

Outside the USA:  
TEL 1-262-367-7600  
FAX 1-262-367-5827