

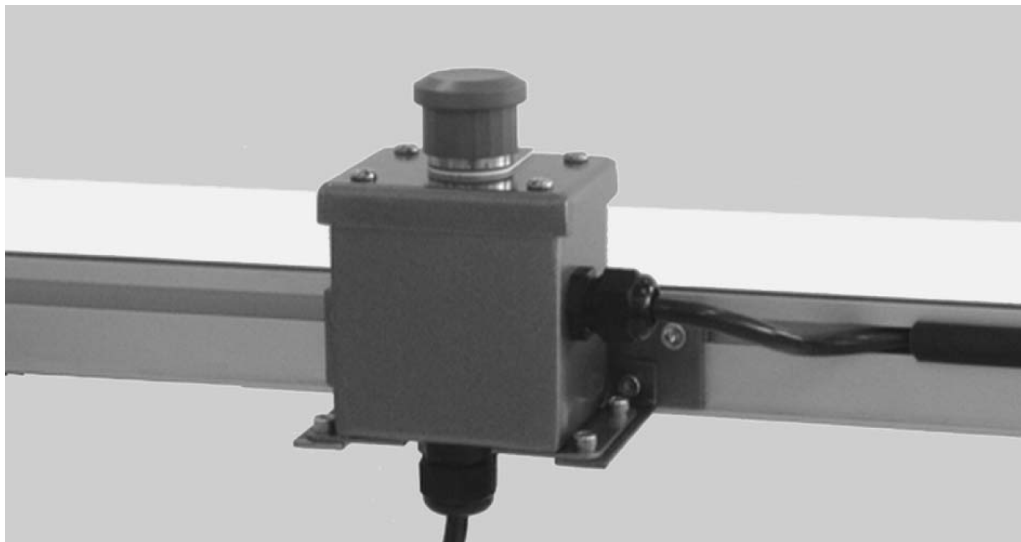

70–40 and 70–41 Emergency Stop Kit

Setup, Operation & Maintenance Manual



DORNER MFG. CORP.
P.O. Box 20 • 975 Cottonwood Ave.
Hartland, WI 53029-0020 USA

INSIDE THE USA
TEL: 1-800-397-8664
FAX: 1-800-369-2440

OUTSIDE THE USA
TEL: 262-367-7600
FAX: 262-367-5827

For other service manuals visit our website at:
www.dorner.com/service_manuals.asp

Table of Contents

Introduction	2	Vertical Mounting to Aluminum Stand Leg.....	6
Warnings – General Safety	3	Horizontal Mounting to Aluminum Stand Leg	6
Specifications	4	Vertical Mounting to Steel Stand Leg.....	6
Installation	4	Horizontal Mounting to Steel Stand Leg.....	6
Vertical Mounting to 2100, 2200 & 3100 Conveyor.....	4	Cable Routing	7
Vertical Mounting to 6100 Conveyor.....	5	Service Parts.....	7
Horizontal Mounting to 2100, 2200 & 3100 Conveyor...	5	Return Policy.....	8
Horizontal Mounting to 6100 Conveyor.....	5		

Introduction

IMPORTANT
<i>Some illustrations may show guards removed. Do NOT operate equipment without guards.</i>

Upon receipt of shipment:

- Compare shipment with packing slip. Contact factory regarding discrepancies.
- Inspect packages for shipping damage. Contact carrier regarding damage.
- Accessories may be shipped loose. See accessory instructions for installation.

Dorner conveyors are covered by the following patent numbers: 5131529, 5156260, 5156261, 5174435, 5203447, 5265714, 5875883, and corresponding patents and patent applications in other countries.

Dorner’s Limited Warranty applies.

Dorner reserves the right to make changes at any time without notice or obligation.

Warnings – General Safety

WARNING

The safety alert symbol, black triangle with white exclamation, is used to alert you to potential personal injury hazards.

DANGER



Climbing, sitting, walking or riding on conveyor will cause severe injury. **KEEP OFF CONVEYORS.**

DANGER



Do NOT OPERATE CONVEYORS IN AN EXPLOSIVE ENVIRONMENT.

WARNING

Controller must be properly grounded. Failure to properly ground controller may cause injury to personn

DANGER



Hazardous voltage will cause severe injury or death. **LOCKOUT POWER BEFORE wiring.**

WARNING



Exposed moving parts can cause severe injury.
DO NOT ATTEMPT ADJUSTMENTS WITH CONVEYOR RUNNING.

WARNING



Dorner cannot control the physical installation and application of conveyors. Taking protective measures is the responsibility of the user.

When conveyors are used in conjunction with other equipment or as part of a multiple conveyor system, **CHECK FOR POTENTIAL PINCH POINTS** and other mechanical hazards before system start-up.

Specifications

E-Stop Specifications

Supply Voltage	115 VAC
Output Configuration	1 Normally Closed Contact
Contact Type	Maintained
Contact Rating	1 HP, 13 Amperes Max.
Housing	NEMA 12/IP55

Installation

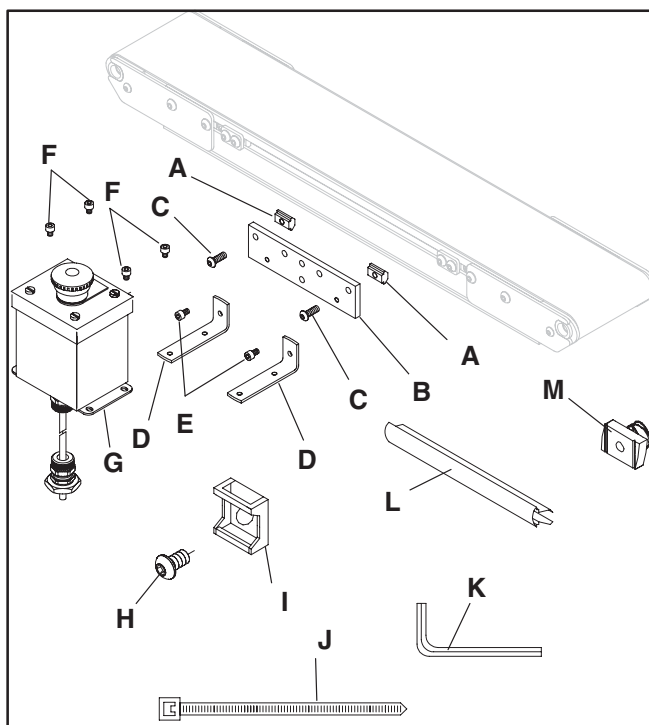

Figure 1

Installation Component List:

A	Single Drop-In T-bar (4x)
B	Stop Mounting Plate (1x)
C	M6 x 16 mm Button Head Screw (2x)
D	Stop Mounting Bracket (2x)
E	M5 x 8 mm Socket Head Cap Screw (2x)
F	M5 x 6 mm Socket Head Cap Screw (4x)
G	Pushbutton Box (1x)
H	M6 x 10 mm Button Head Screw (2x)
I	Zip Tie Mount (2x)
J	Zip Tie (2x)
K	4 mm Hex Key Wrench (1x)
L	T-slot Cover Strip (5x)
M	M6 Spring Nut (2x)
N	6100 Mounting Clip (2x)

Vertical Mounting to 2100, 2200 & 3100 Conveyor

NOTE

For shipping, T-bars (A), Mounting Plate (B), Mounting Brackets (D) and Pushbutton Box (G) are pre-assembled. Detach T-bars before proceeding.

1. Insert two Single Drop-in T-bars (Figure 2, item A) into conveyor T-slot.

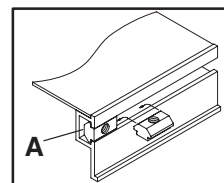

Figure 2

2. Attach the Pushbutton Box assembly (Figure 3, item G) to two T-bars (A) with screws (C).

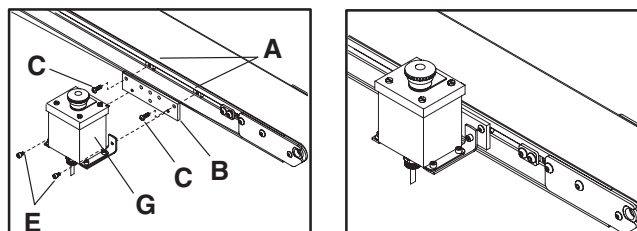

Figure 3

Vertical Mounting to 6100 Conveyor

NOTE

For shipping, T-bars (A), Mounting Plate (B), Mounting Brackets (D) and Pushbutton Box (G) are pre-assembled. Detach T-bars before proceeding.

1. Install mounting clips (Figure 4, item N) on conveyor.

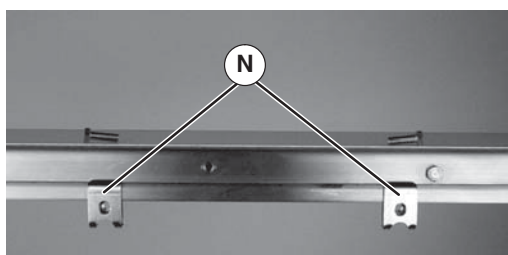

Figure 4

2. Attach Pushbutton Box assembly (Figure 5, item G) with screws (C).

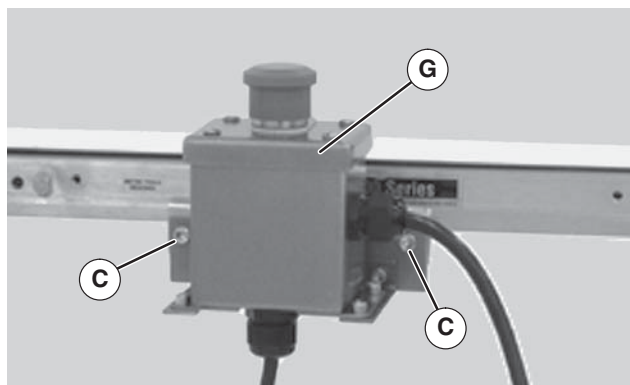

Figure 5

Horizontal Mounting to 2100, 2200 & 3100 Conveyor

NOTE

For shipping, T-bars (A), Mounting Plate (B), Mounting Brackets (D) and Pushbutton Box (G) are pre-assembled. Detach all before proceeding.

1. Attach Pushbutton Box (Figure 6, item G) to mounting plate (B) with screws (E).

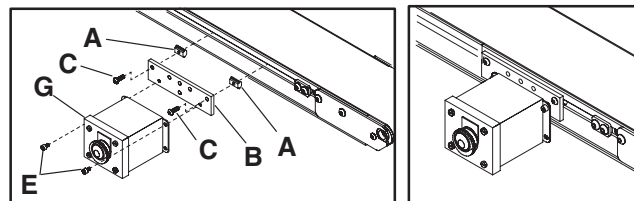

Figure 6

2. Insert two Single Drop-in T-bars (Figure 6, item A) into conveyor T-slot.
3. Attach Pushbutton Box assembly to T-bars (A) with screws (C).

Horizontal Mounting to 6100 Conveyor

NOTE

For shipping, T-bars (A), Mounting Plate (B), Mounting Brackets (D) and Pushbutton Box (G) are pre-assembled. Detach all before proceeding.

1. Install mounting clips (Figure 7, item N) on conveyor.

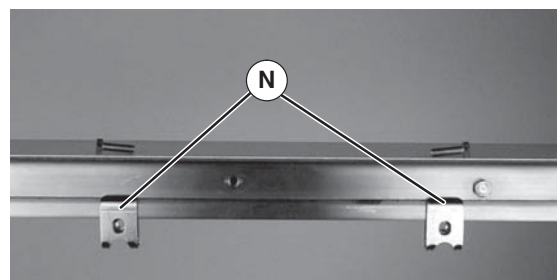

Figure 7

2. Attach Pushbutton Box (Figure 8, item G) to mounting plate (B) with screws (E).
3. Attach Pushbutton Box assembly (Figure 8, item G) with screws (C).

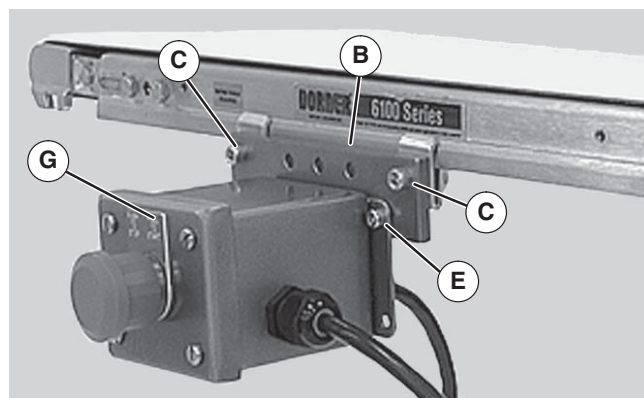

Figure 8

Installation

Vertical Mounting to Aluminum Stand Leg

NOTE

For shipping, T-bars (A), Mounting Plate (B), Mounting Brackets (D) and Pushbutton Box (G) are pre-assembled. Detach T-bars and mounting plate before proceeding.

1. Insert two Single Drop-in T-bars (Figure 9, item A) into Leg slot.

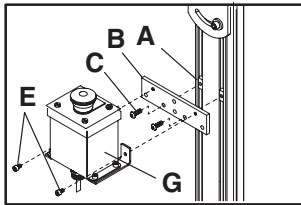

Figure 9

2. Attach mounting plate (B) to T-bars (A) with screws (C).
3. Attach Pushbutton Box assembly (Figure 9, item G) to mounting plate (B) with screws (E).

Horizontal Mounting to Aluminum Stand Leg

NOTE

For shipping, T-bars (A), Mounting Plate (B), Mounting Brackets (D) and Pushbutton Box (G) are pre-assembled. Detach all before proceeding.

1. Attach Pushbutton Box (Figure 10, item G) to mounting plate (B) with screws (E).
2. Insert two Single Drop-in T-bars (A) into Leg slot.

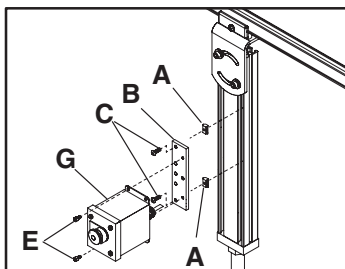

Figure 10

3. Attach Pushbutton Box assembly (G) to T-bars (A) with screws (C).

Vertical Mounting to Steel Stand Leg

NOTE

For shipping, T-bars (A), Mounting Plate (B), Mounting Brackets (D) and Pushbutton Box (G) are pre-assembled. Detach T-bars and mounting plate before proceeding.

1. Install two Spring Nuts (Figure 11, item N) into Leg slot.

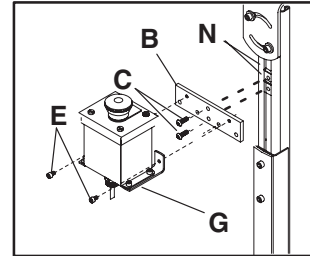

Figure 11

2. Attach mounting plate (B) to Spring Nuts (N) with screws (C).
3. Attach Pushbutton Box assembly (G) to mounting plate (B) with screws (E).

Horizontal Mounting to Steel Stand Leg

NOTE

For shipping, T-bars (A), Mounting Plate (B), Mounting Brackets (D) and Pushbutton Box (G) are pre-assembled. Detach all before proceeding.

1. Install two Spring Nuts (Figure 12, item N) into Leg slot.

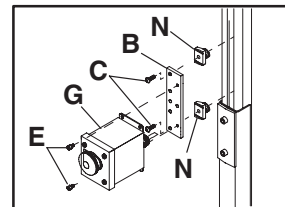

Figure 12

2. Attach Pushbutton Box (G) to mounting plate (B) with screws (E).
3. Attach Pushbutton Box assembly to Spring Nuts (N) with screws (C).

Cable Routing

NOTE

Cable routing should not run near any moving Conveyor parts, where it could possibly be damaged or cause damage to the Conveyor.

1. The Conveyor T-Slot channel or optional 6 ft (1829 mm) or 12.5-ft (3810 mm) Wire Troughs (Dorner #75-85-6 or #75-85-12) can be used to route wire.
2. To contain a long run of wiring cable in the conveyor T-slot channel, use several short lengths of T-slot Cover Strips (Figure 13, item M). Or, to completely contain a long run of cable, purchase T-slot Cover Strip (645656P) at length required.

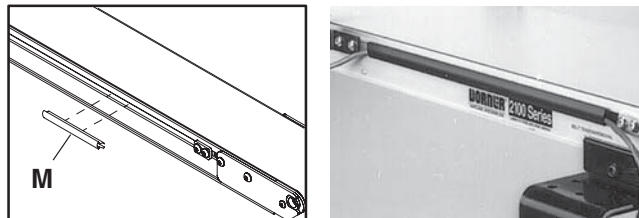

Figure 13

3. To route Cable over a previously mounted component or to anchor the Cable, use the Zip Tie Mounts (Figure 14, item I) and Single Drop-in T-bars (A). Secure each Zip Tie Mount with M6 screw (H).

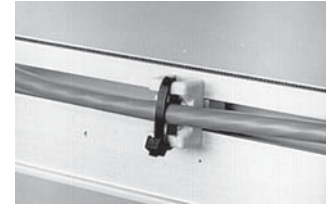
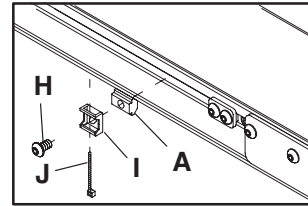

Figure 14

4. Figure 15 shows a typical wire routing of an E-Stop connection to the Conveyor motor using the Conveyor's T-slot with both T-Slot Closure Strips and Zip Ties (J).

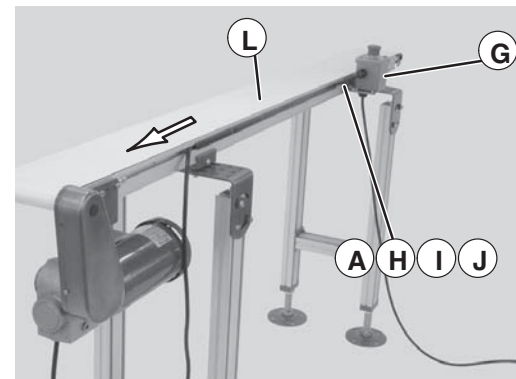

Figure 15

Service Parts

Item	Part Number	Part Description
1	830-142	Push Button, Illuminated
	830-141	Push Button, Non-illuminated
2	699727	Enclosure
3	830-190	Power Module (For Illuminated Only)
4	830-145	Contact Block (for Illuminated only)
	830-146	Contact Block (for Both Models)
5	805-655	Relay
6	805-053	Power Cord
7	805-805	Motor Cord

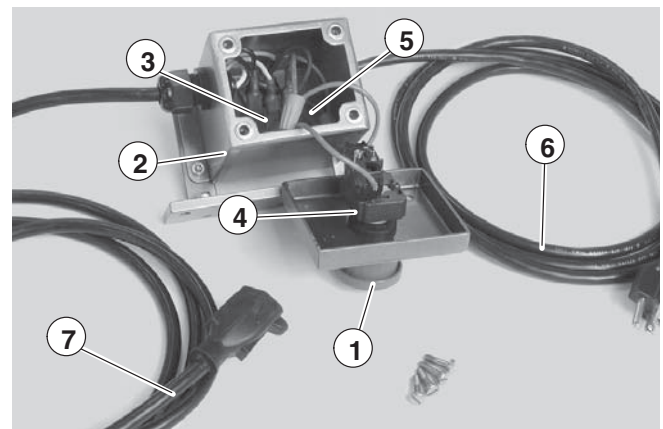

Figure 16

Return Policy

Returns must have prior written factory authorization or they will not be accepted. Items that are returned to Dorner without authorization will not be credited nor returned to the original sender. When calling for authorization, please have the following information ready for the Dorner factory representative or your local distributor:

1. Name and address of customer.
2. Dorner part number(s) of item(s) being returned.
3. Reason for return.
4. Customer's original order number used when ordering the item(s).
5. Dorner or distributor invoice number.

A representative will discuss action to be taken on the returned items and provide a Returned Goods Authorization number for reference.

There will be a return charge on all new undamaged items returned for credit where Dorner was not at fault. Dorner is not responsible for return freight on such items.

Conveyors and conveyor accessories	
Standard catalog conveyors	30%
MPB Series, cleated and specialty belt conveyors	50%
7400 & 7600 Series conveyors	non-returnable items
Engineered special products	case by case
Drives and accessories	30%
Sanitary stand supports	non-returnable items

Parts	
Standard stock parts	30%
MPB, cleated and specialty belts	non-returnable items

Returns will not be accepted after 60 days from original invoice date.

The return charge covers inspection, cleaning, disassembly, disposal and reissuing of components to inventory.

If a replacement is needed prior to evaluation of returned item, a purchase order must be issued. Credit (if any) is issued only after return and evaluation is complete.

Dorner has representatives throughout the world. Contact Dorner for the name of your local representative. Our Technical Sales, Catalog Sales and Service Teams will gladly help with your questions on Dorner products.

For a copy of Dorner's Warranty, contact factory, distributor, service center or visit our website at www.dorner.com.

For replacement parts, contact an authorized Dorner Service Center or the factory.



Dorner Mfg. Corp. reserves the right to change or discontinue products without notice. All products and services are covered in accordance with our standard warranty. All rights reserved. © Dorner Mfg. Corp. 2006

DORNER MFG. CORP.

975 Cottonwood Ave., PO Box 20
Hartland, WI 53029-0020 USA
USA
TEL 1-800-397-8664 (USA)
FAX 1-800-369-2440 (USA)
Internet: www.dorner.com

Outside the USA:
TEL 1-262-367-7600
FAX 1-262-367-5827