

FlexMove

NEW

FV
260mm
Conveyor
System

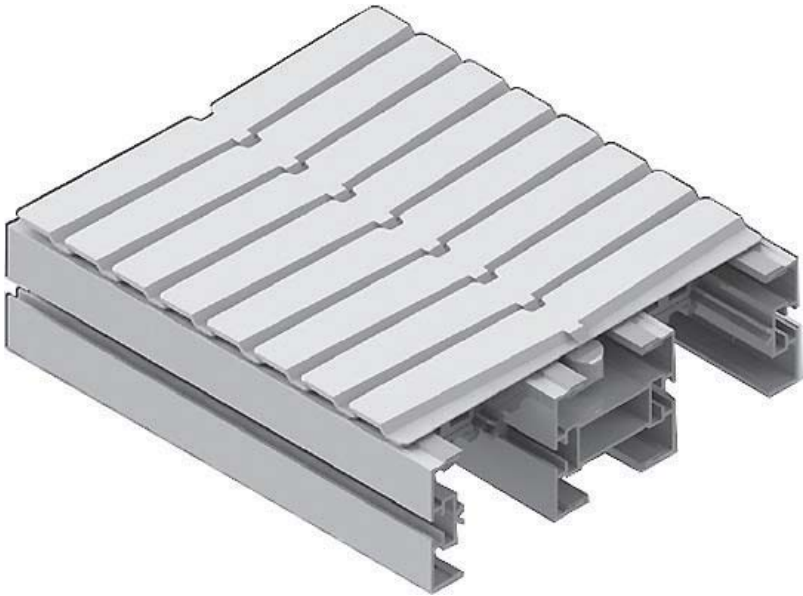

FV

FV SERIES

Variety of chain type suitable for wide range of applications either horizontal or vertically product transportation. The maximum product width to be conveyed can be referred to guide rail assembly pages.

Series Characteristic

Beam Width: 260mm

Product Width: Refer to Guide Rail Assembly

Accessories Needed

Slide Rail Required: FASR-25 , FASR-25U , FASR-25X

Slide Rail Colour: White Or Natural Colour

Slide Rail Material: HDPE , UHMW OR SPECIAL PE

Slide Rail Rivet & Screw: FASLR-4X6 or FASLS-M5

Connecting strip is used to connect 2 beams.

Connecting Strip: FACS-25x140A

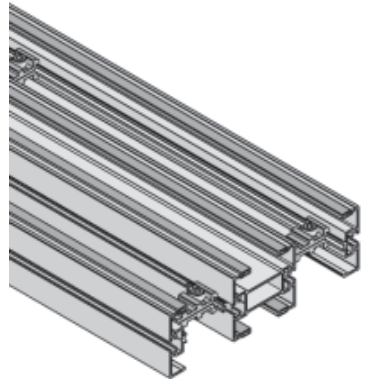
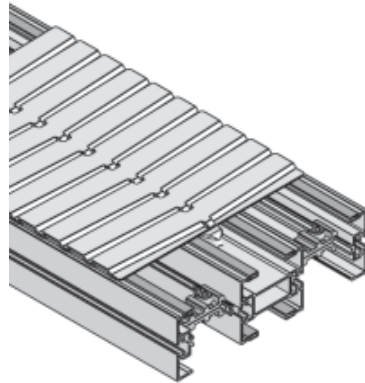
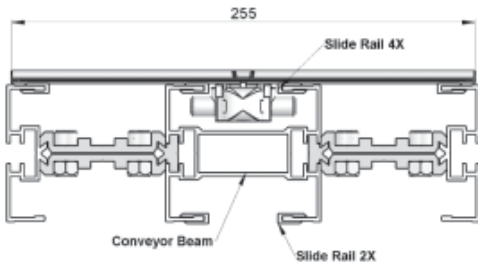

Conveyor Beam **FVCB-3**

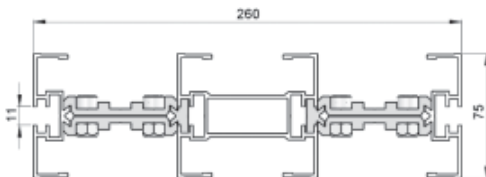

UOM : 3 Meter / Length

Chain Common Date

Packaging: 5m per box

Pitch: 33.5mm

Width: 255mm

Tensile Strength at 20°C: 6000N

Colour: White & Black (Conductive)

Plain Chain PVPC-5

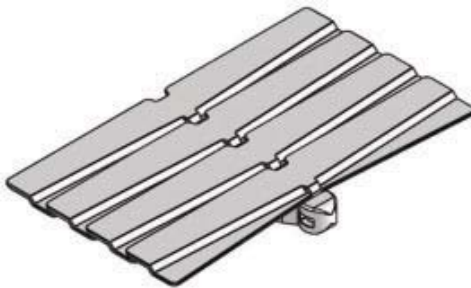

Friction Reducing Roller Chain
PATENT PENDING

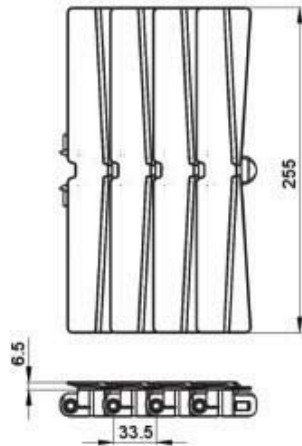

UOM : 5 Meter / box

Application: Suitable for horizontal and slope <math>< 5^\circ</math> transport of products with accumulation.

Roller Plain Chain FVPC-5R

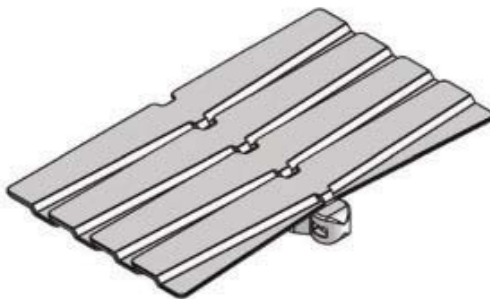

Friction Reducing Roller Chain
PATENT PENDING

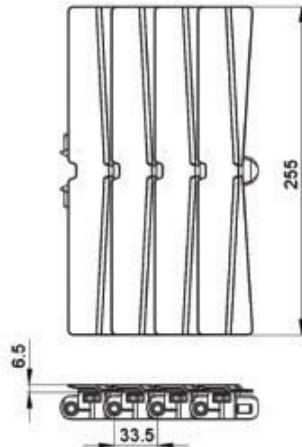

UOM : 5 Meter / box

Application: Suitable for horizontal and slope <math>< 5^\circ</math> transport of products with accumulation.

FV

FV SERIES

Friction Top Chain **FVFT-5**

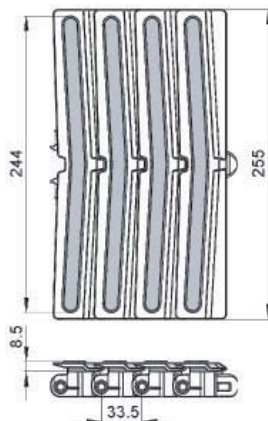
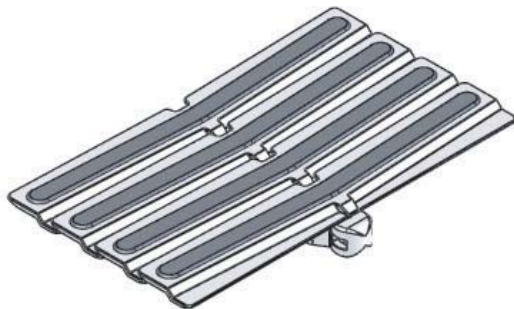

UOM : 5 Meter / box Application: Suitable for horizontal and slope $< 5^\circ$ transport of products with accumulation.

Roller Friction Top Chain **FVFT-5R**

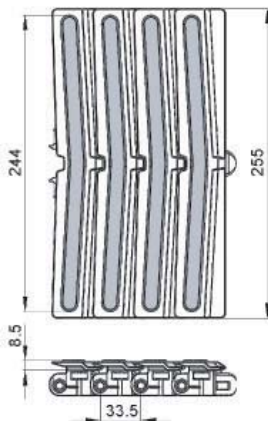
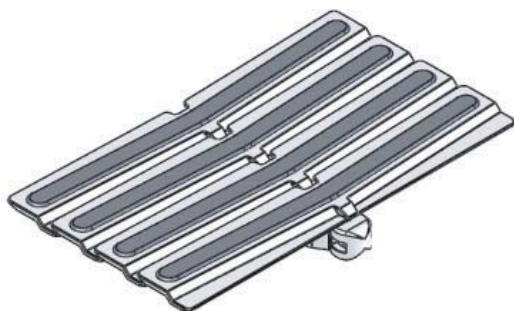

Friction Reducing Roller Chain **PATENT PENDING**

UOM : 5 Meter / box Application: Suitable for horizontal and slope $< 5^\circ$ transport of products with accumulation.

FV Direct End Drive with Motor (LEFT)

FVDD-A260-0.25L, 0.37L, 0.55L

FVDD-A260-0L

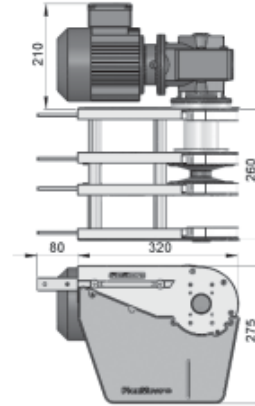
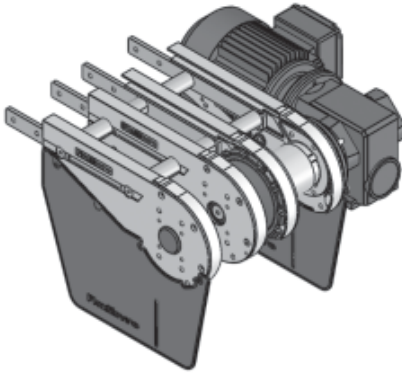

Max Traction Force : 1250N

The Direct End Drive Unit is without torque limiter. Standard attached gear motors are with SEW motor size 0.25kW, 0.37kW & 0.55kW. FVDD-A260-0L represents direct drive without gear motor. Multi channel drives are available upon request.

UOM : pc Chain required 2-way : 0.8 meter Slide rail required 2-way: 0 meter

FV Direct End Drive with Motor (RIGHT)

FVDD-A260-0.25R, 0.37R, 0.55R

FVDD-A260-0R

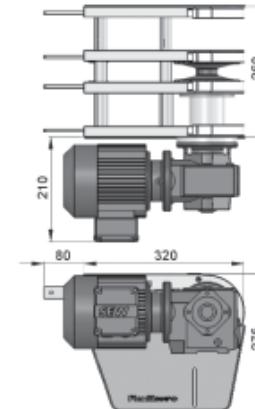
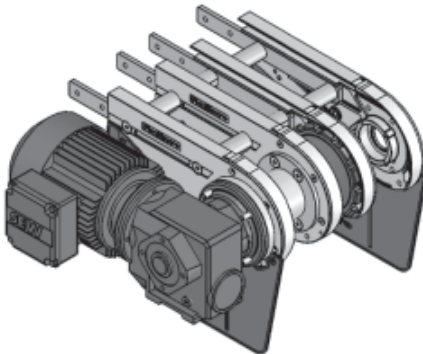

Max Traction Force : 1250N

The Direct End Drive Unit is without torque limiter. Standard attached gear motors are with SEW motor size 0.25kW, 0.37kW & 0.55kW. FVDD-A260-0R represents direct drive without gear motor. Multi channel drives are available upon request.

UOM : pc Chain required 2-way : 0.8 meter Slide rail required 2-way: 0 meter

FV

SEW gear motors are products of SEW Eurodrive

FV SERIES

FV Direct End Drive with Motor (LEFT)

FVSD-A260-0.25L, 0.37L, 0.55L

FVSD-A260-0L

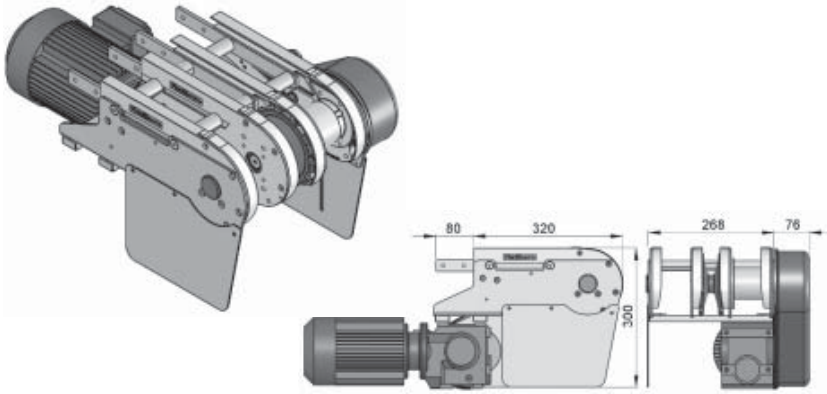

Max Traction Force : 1250N

The Direct End Drive Unit is without torque limiter. Standard attached gear motors are with SEW motor size 0.25kW, 0.37kW & 0.55kW. FVSD-A260-0L represents direct drive without gear motor. Multi channel drives are available upon request.

UOM : pc Chain required 2-way : 0.8 meter Slide rail required 2-way: 0 meter

FV Direct End Drive with Motor (RIGHT)

FVSD-A260-0.25R, 0.37R, 0.55R

FVSD-A260-0R

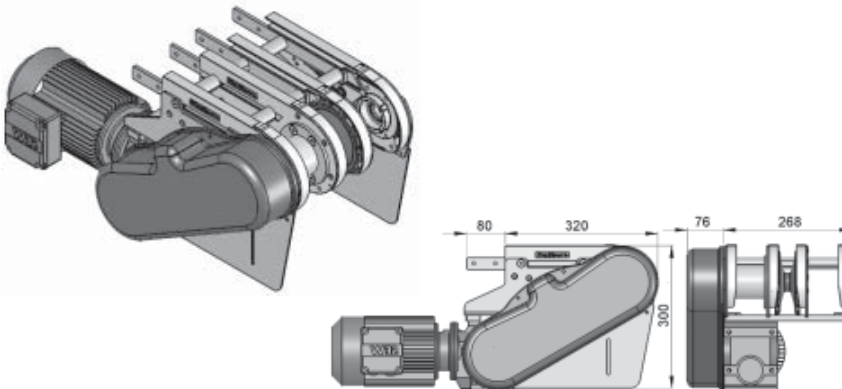

Max Traction Force : 1250N

The Direct End Drive Unit is without torque limiter. Standard attached gear motors are with SEW motor size 0.25kW, 0.37kW & 0.55kW. FVSD-A260-0R represents direct drive without gear motor. Multi channel drives are available upon request.

UOM : pc Chain required 2-way : 0.8 meter Slide rail required 2-way: 0 meter

FV Idler End 260 **FVIE-A260**

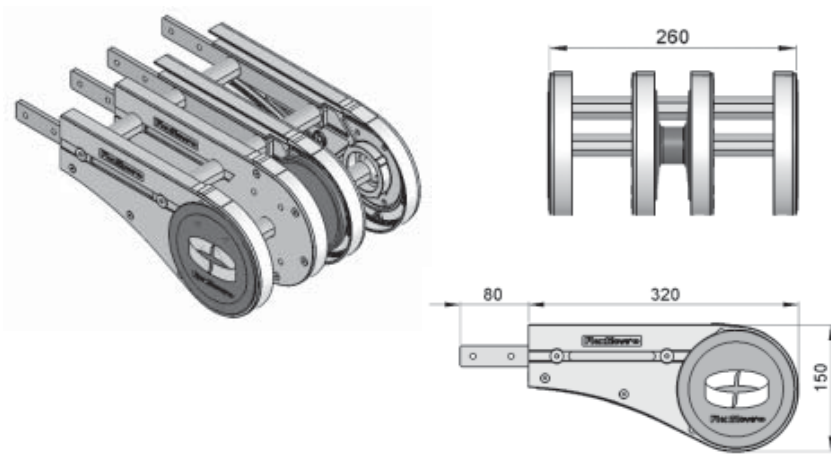

UOM : pc Chain required 2-way : 0.8 meter Slide rail required 2-way: 0.5 meter

Chain Connecting Module **FVCC-300**

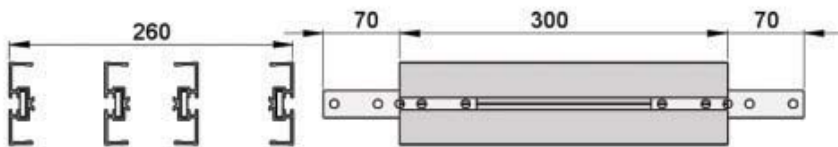

Beam section for chain installation.

UOM : pc

SEW gear motors are products of SEW Eurodrive

FV SERIES

FV Horizontal Plain Bend 30°



UOM : pc

Chain required 2-way (700, 1000) : 1.6, 1.9 meter
 Slide rail required 2-way(700, 1000): 6.3, 7.5 meter

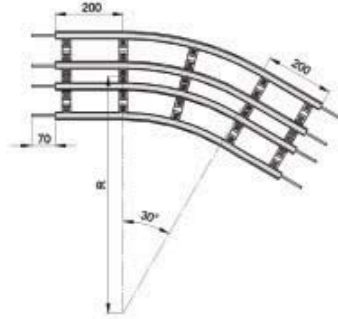

Horizontal plain bend, 30° ± 1°

R = 700 ± 10mm **FVHB-30R700**
 R = 1000 ± 10mm **FVHB-30R1000**

FV Horizontal Plain Bend 45°



UOM : pc

Chain required 2-way (700, 1000) : 1.9, 2.4 meter
 Slide rail required 2-way(700, 1000): 7.7 , 9.6 meter

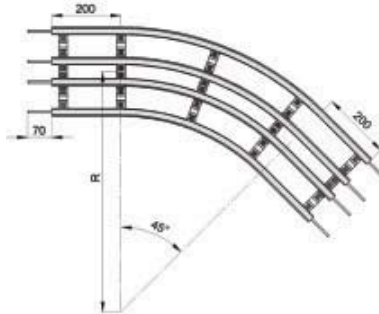

Horizontal plain bend, 45° ± 1°

R = 700 ± 10mm **FVHB-45R700**
 R = 1000 ± 10mm **FVHB-45R1000**

FV Horizontal Plain Bend 60°



UOM : pc

Chain required 2-way (700, 1000) : 2.3, 2.9 meter
 Slide rail required 2-way(700, 1000): 9.2, 12.0 meter

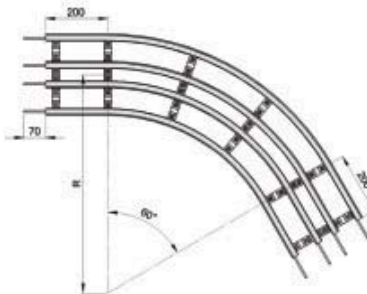

Horizontal plain bend, 60° ± 1°

R = 700 ± 10mm **FVHB-60R700**
 R = 1000 ± 10mm **FVHB-60R1000**

FV Horizontal Plain Bend 90°

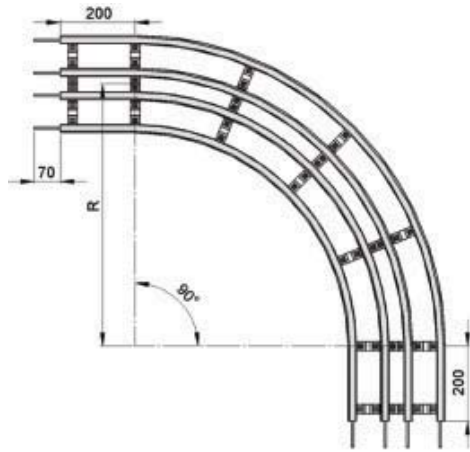

UOM : pc

Chain required 2-way (700, 1000) : 3.0, 4.0 meter
 Slide rail required 2-way(700, 1000): 12.1 , 16.0 meter

Horizontal plain bend, 90° ± 1°

R = 700 ± 10mm **FVHB-90R700**
 R = 1000 ± 10mm **FVHB-90R1000**

FV Horizontal Plain Bend 5° - 180°

Example for FV Horizontal Plain Bend Ordering

Horizontal plain bend, θ° ± 1°

R = 700 ± 10mm **FVHB - θ°R700**
 R = 1000 ± 10mm **FVHB - θ°R1000**

If an angle of 120° is needed for radius R700 horizontal plain bend, so the ordering part number is

FVHB - 120R700

UOM : pc

Chain required 2-way (700, 1000) : meter (variable to angle)
 Slide rail required 2-way(700, 1000): meter (variable to angle)

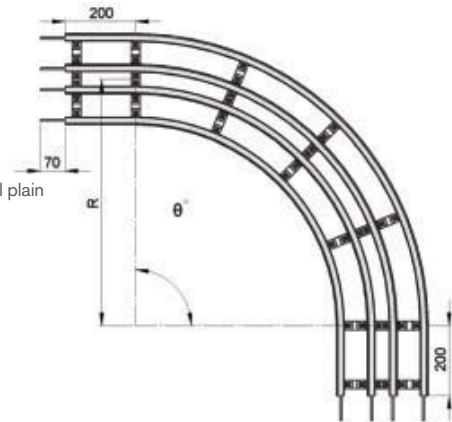

FV SERIES

FV Vertical Bend 5° FVVB-5R400

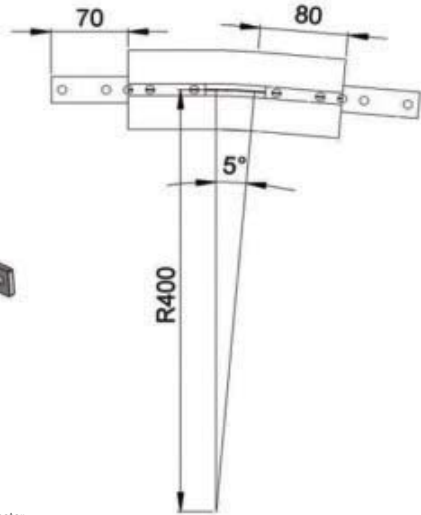
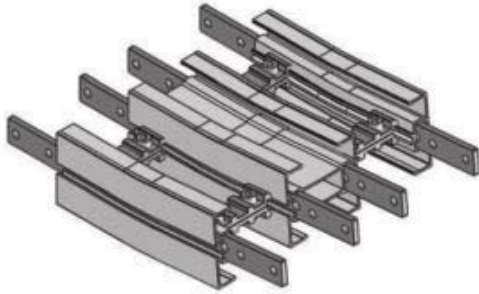

UOM : pc Chain required 2-way: 0.4 meter Slide rail required 2-way: 1.6 meter

FV Vertical Bend 10° FVVB-10R400

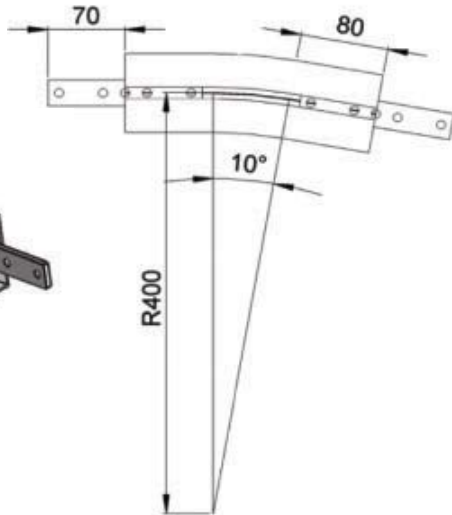
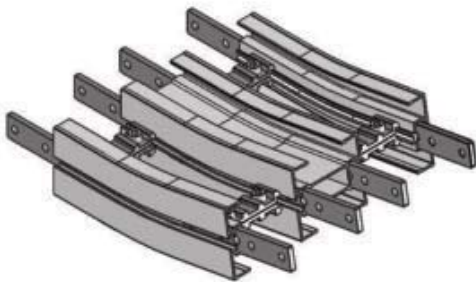

UOM : pc Chain required 2-way: 0.5 meter Slide rail required 2-way: 1.9 meter

FV Vertical Bend 15°

FVVB-15R400

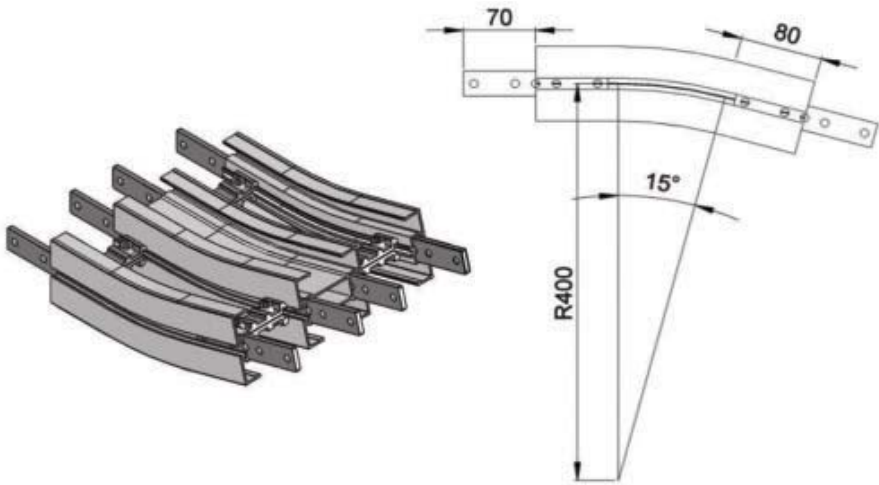

UOM : pc Chain required 2-way: 0.6 meter Slide rail required 2-way: 2.2 meter

FV Vertical Bend 20°

FVVB-20R400

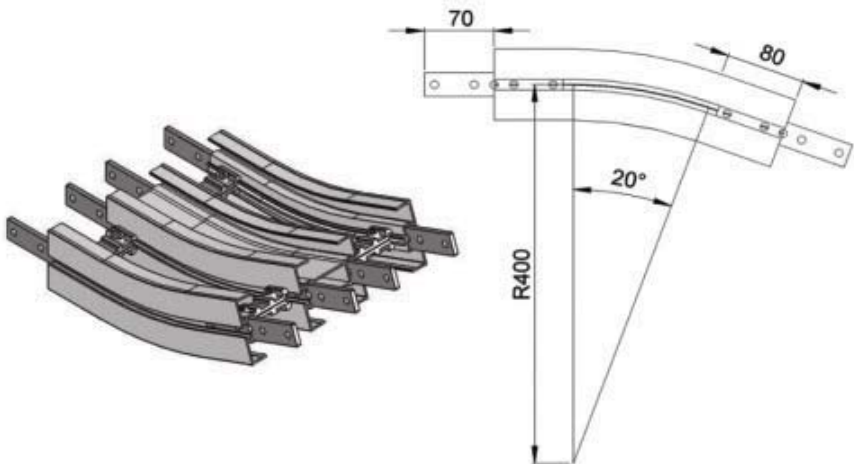

UOM : pc Chain required 2-way: 0.6 meter Slide rail required 2-way: 2.5 meter

FV SERIES

FV Vertical Bend 30°

FVVB-30R400

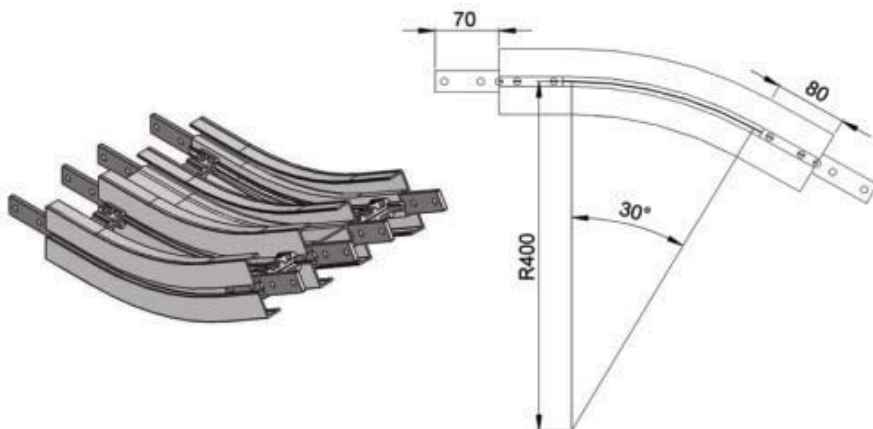

UOM : pc Chain required 2-way: 0.8 meter Slide rail required 2-way: 3.0 meter

FV Vertical Bend 45°

FVVB-45R400

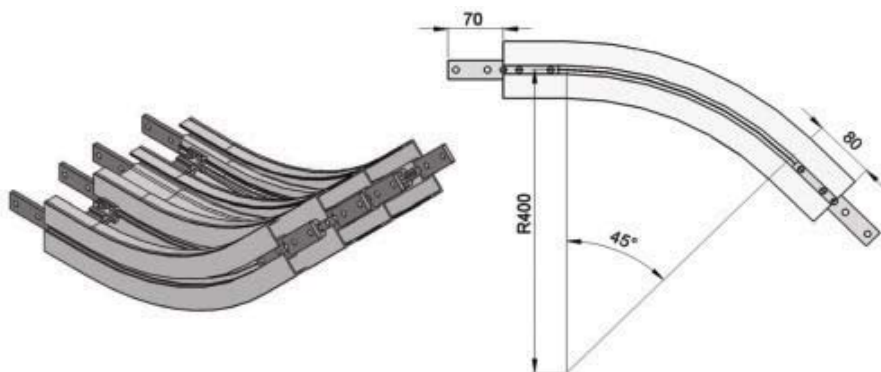

UOM : pc Chain required 2-way: 1.0 meter Slide rail required 2-way: 3.9 meter

FV Vertical Bend 60°

FVVB-60R400

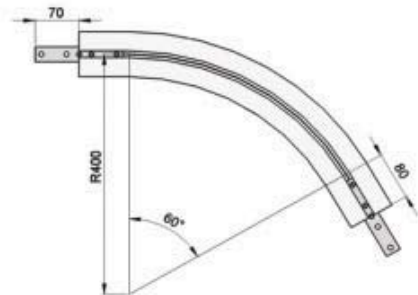

UOM : pc Chain required 2-way: 1.2 meter Slide rail required 2-way: 4.7 meter

FV Vertical Bend 90°

FVVB-90R400

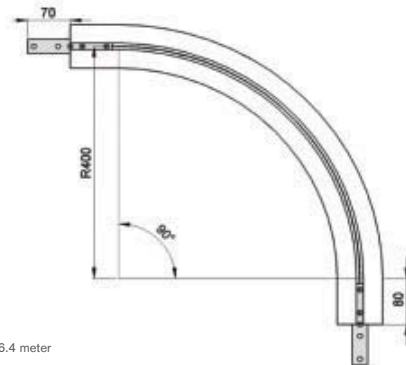
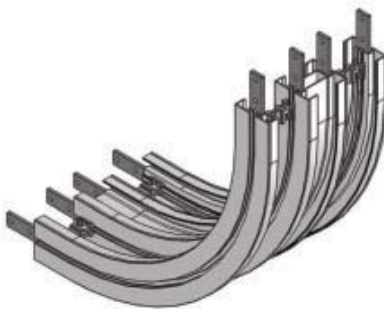

UOM : pc Chain required 2-way: 1.6 meter Slide rail required 2-way: 6.4 meter

FV Vertical Bend 5° - 90°

Example for FV Vertical Bend Ordering

- Vertical bend, $\varnothing^\circ \pm 1^\circ$
- FVVB- \varnothing° R400

If an angle of 65° is needed for vertical bend, so the ordering part number is

FVVB-65R400

*The outer bend is assembled using connecting strip (FACS-25x140A).
Angle of "∅" must be indicated when ordering.*

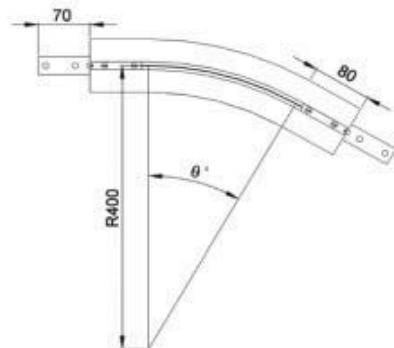

FV