



64-02-00, 64-02-01, 64-02-02 & 64-02-03 Motion Sensor Switches

Assembly Instructions



DORNER MFG. CORP.
P.O. Box 20 • 975 Cottonwood Ave.
Hartland, WI 53029-0020 USA

INSIDE THE USA
TEL: 1-800-397-8664
FAX: 1-800-369-2440

OUTSIDE THE USA
TEL: 262-367-7600
FAX: 262-367-5827

For other service manuals visit our website at:
www.dorner.com/service_manuals.asp

Table of Contents

Warnings – General Safety.....	2	Notes	5
Electrical Characteristics.....	2	Return Policy.....	6
Mounting to Conveyor	3		
Wiring.....	4		

Warnings – General Safety

⚠ WARNING

<p>Exposed moving parts can cause severe injury.</p> <p>LOCK OUT POWER before removing guards or performing maintenance.</p>

Electrical Characteristics

Dry Contact Switch:	Provides One (1) Pulse per Revolution or Approximate 3.5, (90 mm) of Belt Movement
Voltage (Switching):	200 volts D.C. Maximum 140 volts A.C. (RMS) Maximum
Current (Switching):	1.0 Amperes Maximum
Current (Carrying):	2.5 Amperes Maximum
Wattage:	15 Watts Maximum
Resistance (Initial Contact):	0.100 Ohms Maximum (Insulation): 10 ⁴ Megohms
Operating Temperature:	-55 to +125°C
Operate Time (including bounce):	0.5 Milliseconds
Maximum Switch Speed:	1.0 KHz

Mounting to Conveyor

Illustration References:

A	Magnet (built into pulley)
B	Belt tension locking screw
C	Sensor (809-251)
D	Sensor Wire Lead Assembly (450334)



Motion Sensor Installed in 6100 Series Industrial Conveyor Tension End Tail Plate

Figure 1

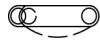
1. Locate tension end of conveyor identified with  label.
2. Locate side on which magnet (A) is installed. Conveyor is shipped with pulley magnet (A) on same side as belt tension locking (gold-colored) screw (B).

NOTE

Magnet and sensor may be re-located to the opposite side of tension end by re-orienting the pulley. Refer to "Pulley & Tail Assembly Replacement" topic, in your conveyor Set-up, Operation and Maintenance Manual.

3. Install sensor (C). Hand tighten only.

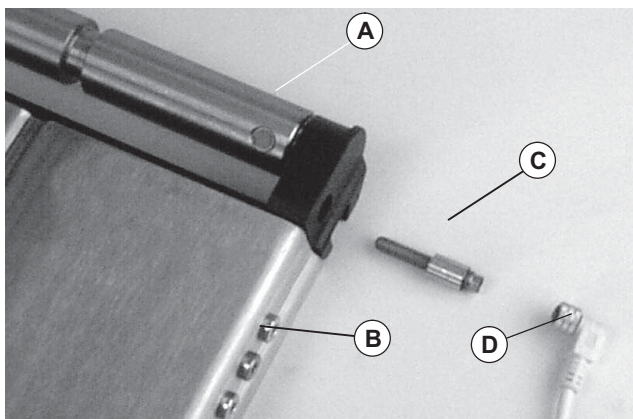

Figure 2

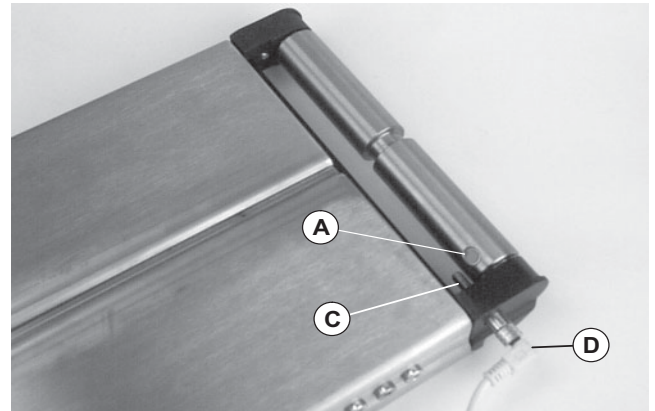

Figure 3

4. Install sensor wire lead assembly (D). Hand tighten only.

Wiring

Sensor kits are provided in four lead configurations. Refer to (Figure 4) for your configuration and connect sensor to a Dorner Motion Monitor or your own machine control or PLC.

IMPORTANT

Always follow local electrical codes.

Illustration References

- D Sensor Wire Lead Assembly (450334)
- E Banana Plug, Black (805-858)
- F Banana Plug, Red (805-858)
- G Lumberg Connector (805-860)
- H Amphenol Connector (44-04-02)

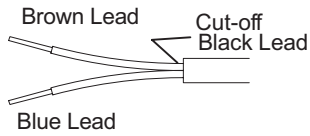

Leads (D)

64-02-00 Kit

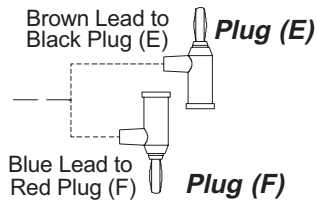

Plug (E)
Plug (F)

64-02-01 Kit

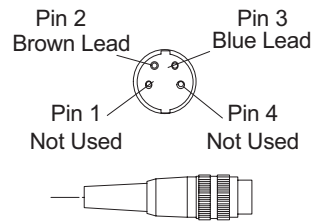

Plug (G)

64-02-02 Kit

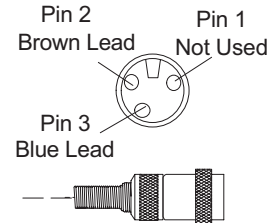

Plug (H)

64-02-03 Kit

Wiring Details

Figure 4

Return Policy

Returns must have prior written factory authorization or they will not be accepted. Items that are returned to Dorner without authorization will not be credited nor returned to the original sender. When calling for authorization, please have the following information ready for the Dorner factory representative or your local distributor:

1. Name and address of customer.
2. Dorner part number(s) of item(s) being returned.
3. Reason for return.
4. Customer's original order number used when ordering the item(s).
5. Dorner or distributor invoice number.

A representative will discuss action to be taken on the returned items and provide a Returned Goods Authorization number for reference.

There will be a return charge on all new undamaged items returned for credit where Dorner was not at fault. Dorner is not responsible for return freight on such items.

Conveyors and conveyor accessories	
Standard catalog conveyors	30%
MPB Series, cleated and specialty belt conveyors	50%
7400 & 7600 Series conveyors	non-returnable items
Engineered special products	case by case
Drives and accessories	30%
Sanitary stand supports	non-returnable items

Parts	
Standard stock parts	30%
MPB, cleated and specialty belts	non-returnable items

Returns will not be accepted after 60 days from original invoice date.

The return charge covers inspection, cleaning, disassembly, disposal and reissuing of components to inventory.

If a replacement is needed prior to evaluation of returned item, a purchase order must be issued. Credit (if any) is issued only after return and evaluation is complete.

Dorner has representatives throughout the world. Contact Dorner for the name of your local representative. Our Technical Sales, Catalog Sales and Service Teams will gladly help with your questions on Dorner products.

For a copy of Dorner's Warranty, contact factory, distributor, service center or visit our website at www.dorner.com.

For replacement parts, contact an authorized Dorner Service Center or the factory.



Dorner Mfg. Corp. reserves the right to change or discontinue products without notice. All products and services are covered in accordance with our standard warranty. All rights reserved. © Dorner Mfg. Corp. 2006

DORNER MFG. CORP.

975 Cottonwood Ave., PO Box 20
Hartland, WI 53029-0020 USA
USA
TEL 1-800-397-8664 (USA)
FAX 1-800-369-2440 (USA)
Internet: www.dorner.com

Outside the USA:
TEL 1-262-367-7600
FAX 1-262-367-5827