

## **Metric Support Stands & Conveyor Mountings**

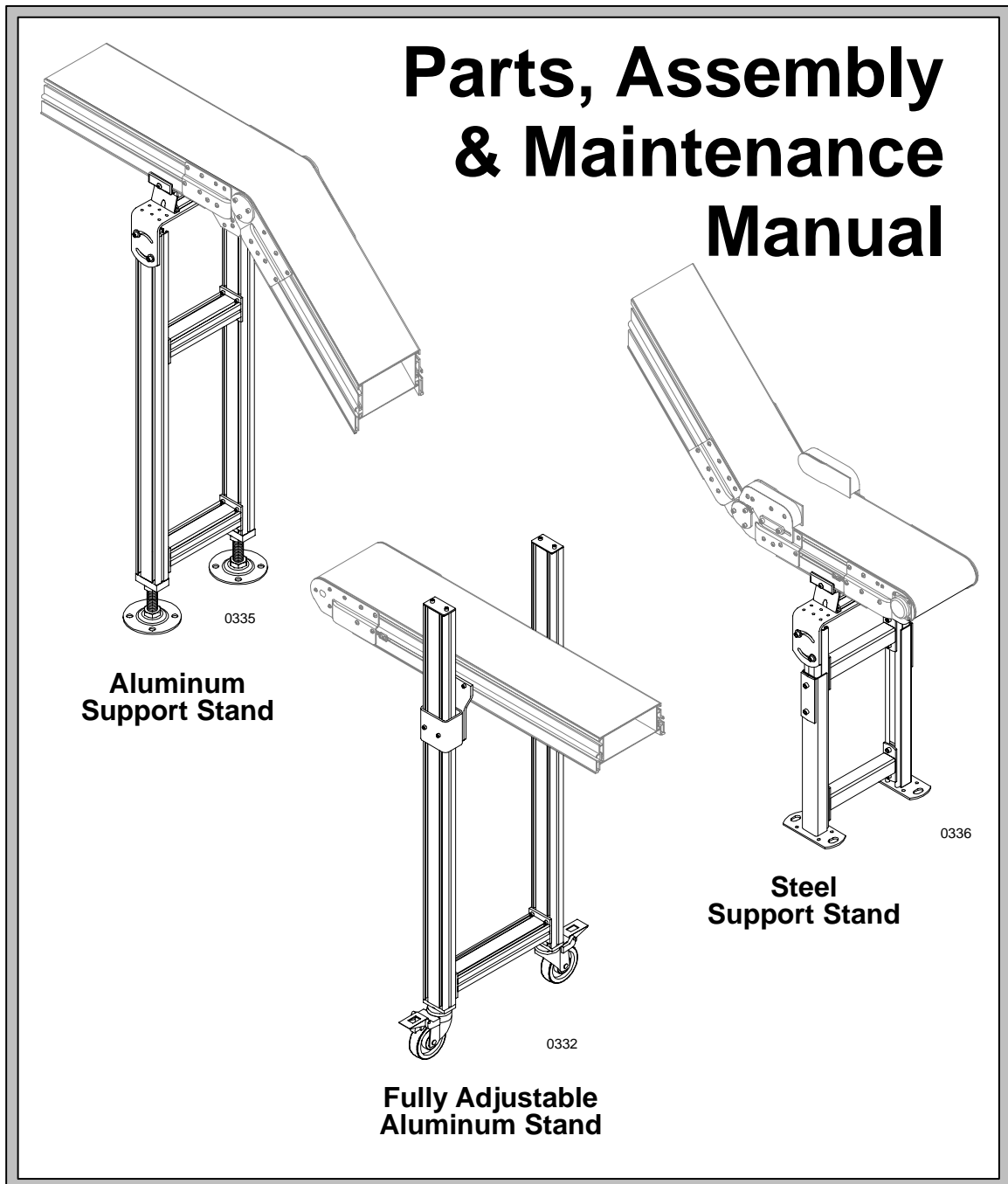

---



# Table of Contents

---

<b>Safe Practices</b> .....	3	Mounting Bracket, with Return Belt Roller Assembly, to LPZ Cleated Belt Conveyor ...	12
<b>Foreword</b> .....	3	Mounting Bracket, with Return Belt Roller Assembly, to 2100 Cleated Belt Conveyor ...	13
<b>Installation Instructions</b>		Aluminum or Steel Stand to Flat Belt Conveyor & Stand Mounting Components	
General Instructions .....	4	Mounting Bracket, with Return Belt Roller Assembly, & Conveyor Joining Components to 2100 Flat Belt Conveyor .....	14
Aluminum Support Stands .....	4	Mounting Bracket, with Return Belt Roller Assembly, & Conveyor Joining Components to 3100 Flat Belt Conveyor .....	15
Steel Support Stands .....	5	Roller Conveyors & Stand Mounting Components	
Fully Adjustable Aluminum Stands .....	6	Stand Mounting to 2100 Roller Conveyor & Conveyor Joining Components .....	16
Joining Conveyor Sections .....	6	Stand Mounting to 3100 Roller Conveyor & Conveyor Joining Components .....	16
<b>Replacement Parts</b>		Diagonal Braces .....	17
Aluminum Stands & Related Components .....	7	<b>Part Number Index</b> .....	18
Steel Stands & Related Components .....	8		
Fully Adjustable Aluminum Stand .....	10		
Floor Mount Casters .....	11		
Floor/Ceiling Mounting Assembly .....	11		
Aluminum or Steel Stand to Cleated Belt Conveyor Mounting Assemblies			
Mounting Bracket, with Return Belt Roller Assembly, to 3100 Cleated Belt Conveyor ..	12		

 **WARNING** 

The safety alert symbol, black triangle with white exclamation, is used to alert you to potential personal injury hazards.

 **WARNING** 



When conveyors are used in conjunction with other equipment or as part of a multiple conveyor system, check for potential pinch points and other mechanical hazards before system start-up. Because Dorner Mfg. Corp. cannot control the physical installation and applications of multiple conveyor systems, taking protective measures is the responsibility of the user.

 **WARNING** 



Operating Dorner conveyors in an explosive environment is prohibited.

 **WARNING** 

Standing on a conveyor or transporting people is prohibited.

 **WARNING** 

Before proceeding to loosen hardware that locks-in the selected stand height, be sure that all related Conveyor sections are securely supported to prevent them from moving suddenly and dropping-down which may pinch or strike you, causing serious personal injury.

 **WARNING** 

**NEVER** operate equipment without guards or other protective devices properly secured in place. In addition, to prevent injury, make sure all electrical power sources have been disconnected and locked-out before you perform any maintenance, make any adjustments or replace any components.

---

## Foreword

---

For pictorial clarity, some illustrations in this manual may show guards or other protective devices open or removed. Under no circumstances should the conveyor be operated without these devices securely in place.

---

### NOTE:

All technical data in this publication is based on the product information available at time of printing. Dorner reserves the right to make changes at any time without notice or obligation to install those changes on units previously delivered.

---

---

# Installation Instructions

## General Instructions

Dorner stands and compatible mounting hardware are designed to be used to squarely, straightly and securely support your Dorner conveyor. All stands and adapting components feature metric mounting hardware.

Dorner provides three (3) different types of support stands. Refer to the following subtopics for appropriate details on each type of stand.

## Aluminum Support Stands (Figure 1)

The aluminum support stand is available with permanent floor mounting pads (A of Figure 1) or optional pivoting and dual lockable, 4" (102 mm) diameter casters (B). Both the floor mounting pads or caster assemblies have nut-locked threaded shafts that provide  $\pm 2"$  (51 mm) of stand height adjustment. Activation of the caster wheel dual lock prevents the caster from both pivoting and rolling. Locks are activated and de-activated with foot pressure.

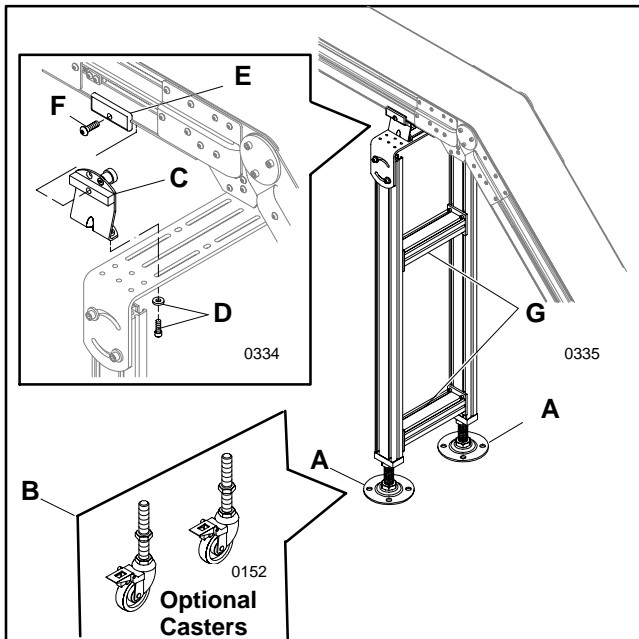

**Figure 1: Standard Aluminum Support Stand and Adapting Components for a Cleated-Belt Conveyor**

Standard aluminum support stands are available in compatible widths to match the respective conveyor widths and heights from 18 to 48" (457 to 1219 mm). Depending on the height of the stand, one or two re-positionable, stabilizing cross members (G) are also provided.

The upper portion of the stand has a single stand/conveyor mounting bracket (K of Figure 2) or two (2) "L" mounting brackets (L of Figure 3), depending on the width of the conveyor. Slotted holes, in either style bracket, enable angling these parts to adapt to the conveyor section angle, when necessary.

## Cleated Belt Support Stand Adaptation (Figure 1)

The stand/conveyor mounting bracket is linked to the cleated conveyor section, on each side, by a mounting bracket with return belt roller assembly (C) which is secured with (2 each) M6 x 18 mm socket head cap screws and hard washers (D). The upper part of the bracket and belt guide bearing assembly is secured to the bottom edge of the conveyor side rail with a clamp plate (E) that is secured with an M8 x 18 mm button head cap screw (F).

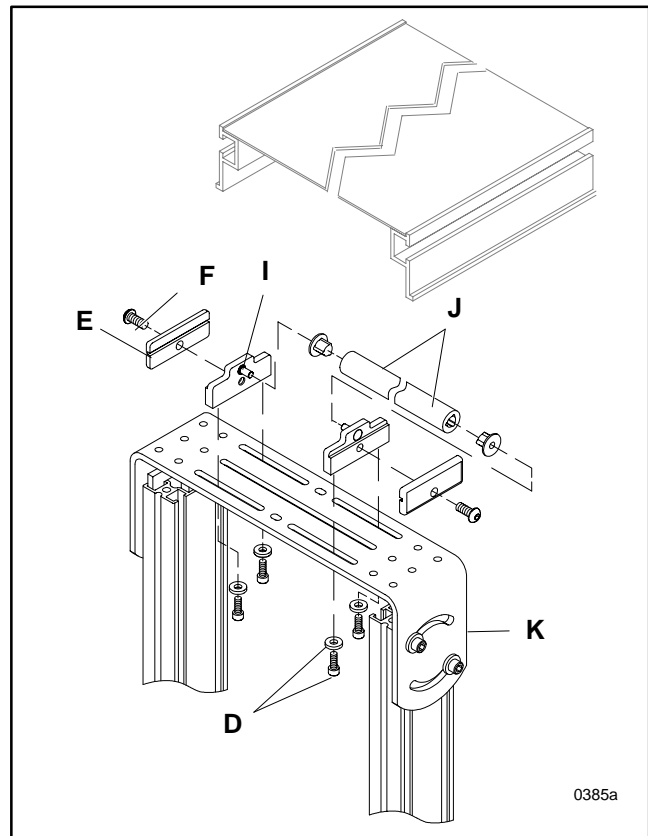

**Figure 2: Stand and Adapting Components used with a Flat-Belt Conveyor that is 24" (610 mm) and Narrower**

# Installation Instructions

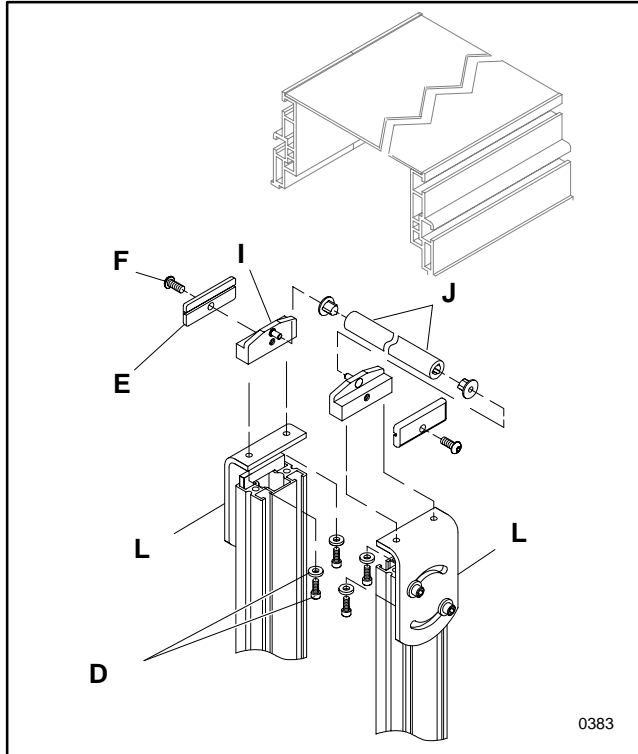

**Figure 3: Stand and Adapting Components used with a Flat-Belt Conveyor Wider than 24" (610 mm)**

## Flat Belt Support Stand Adaptations (Figures 2 & 3)

The stand/conveyor mounting bracket or "L" mounting bracket is linked to the conveyor, on each side, by a stand mounting block (I of Figures 2 & 3) which is secured with (2 each) M6 x 18 mm socket head cap screws and hard washers (D). The bottom edge of the conveyor side rail, on each side, is attached by the stand mounting block and clamp plate (E) which is secured with an M8 x 16 mm button head cap screw (F).

## Steel Support Stands

! **WARNING** !

**Before proceeding to loosen hardware that locks-in the selected stand height, make sure that all related Conveyor sections are securely supported to prevent them from suddenly moving and dropping-down which could cause serious personal injury.**

The steel stand is available with permanent floor mounting feet (M of Figure 4) or with fixed position or rotationally lockable, pivoting casters (N). The steel stand assemblies consists of several different combinations of differing length legs, differing length boots and stabilizing cross members that

match the respective conveyor widths. Variations in elevation can be achieved by unlocking the clamping plates and telescoping the leg and boot assembly. Be sure that the attaching hardware is always kept tightly secured at all times.

The upper portion of the steel stand has the same single stand/conveyor mounting bracket (K of Figure 2) or two (2) "L" mounting brackets (L of Figure 3), depending on the width of the conveyor. Slotted holes, in either style bracket, enable angling these parts to adapt to the conveyor section angle, when necessary.

## Flat Belt Support Stand Adaptations (Figures 2 & 3)

The stand/conveyor mounting bracket or "L" mounting bracket is linked to the conveyor, on each side, by a stand mounting block (I of Figures 2 & 3) which is secured with (2 each) M6 x 18 mm socket head cap screws and hard washers (D). The bottom edge of the conveyor side rail, on each side, is attached by the stand mounting block and clamp plate (E) which is secured with an M8 x 16 mm button head cap screw (F).

## Cleated Belt Support Stand Adaptation (Figure 4)

The stand/conveyor mounting bracket is linked to the conveyor section, on each side, by a mounting bracket with return belt roller assembly (C) which is secured with (2 each) M6 x 18 mm socket head cap screws and hard washers (D). The upper part of the bracket and belt guide bearing assembly is secured to the bottom edge of the conveyor side rail with a clamp plate (E) that is secured with an M8 x 18 mm button head cap screw.

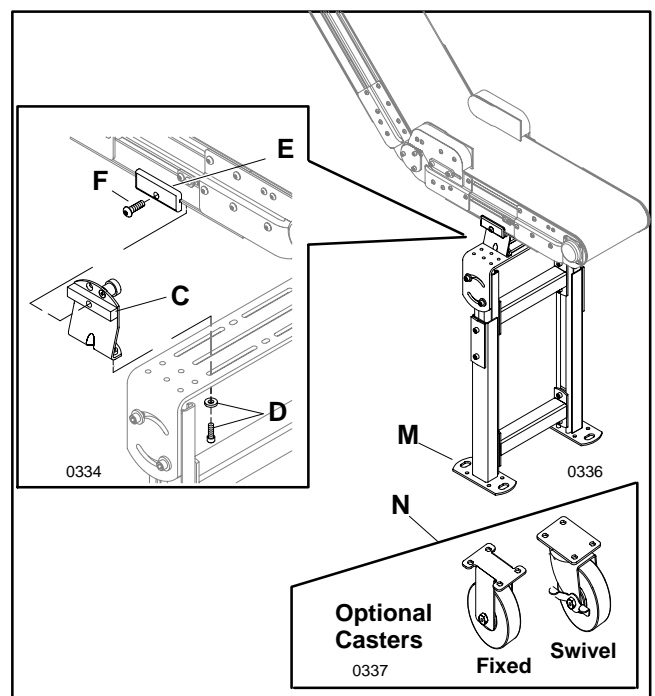

**Figure 4: Steel Support Stand and Adapting Components for a Cleated-Belt Conveyor**

# Installation Instructions

## Fully Adjustable Aluminum Support Stands (Figure 5)



**WARNING**



**Before proceeding to loosen hardware that locks-in the selected stand height, make sure that all related Conveyor sections are securely supported to prevent them from suddenly moving and dropping-down which could cause serious personal injury.**

The fully adjustable aluminum support stand is a moveable support that has two (2) pivoting and dual lockable, 4" (102 mm) diameter casters. Activating this type of lock prevents the caster from both pivoting and rolling. Locks are activated and de-activated with foot pressure.

This stand style is composed of two slotted aluminum vertical supports (O of Figure 5) and two adjustable steel conveyor mounting assemblies (P). Both adjustable assemblies can be slid up or down their respective vertical support. The adjusted vertical position can be locked by securing two (2) outboard mounting screws (Q). A single re-positionable, stabilizing cross member (R) is also provided, except on a short stand. The adjustable steel conveyor mounting assembly also has a pivot angle adjustment (S) to coincide with the required conveyor section angle. The adjusted angle can be locked by securing two (2) inboard mounting screws.

The adjustable steel conveyor mounting assembly is attached to the conveyor section by a drop-in T-bar (T) which is secured in the conveyor's lower T-slot with two (2) M6 x 16 mm socket head cap screws (U).

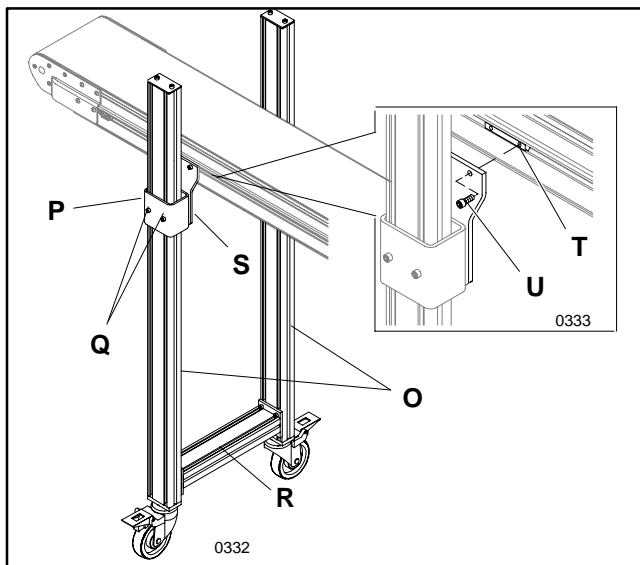

**Figure 5: Fully Adjustable Aluminum Stand and Adapting Components for an LPZ style Conveyor**

## Joining Conveyor Sections (Figure 6)

2100 Series, 3100 Series or LPZ conveyor sections can be joined together to form one long conveyor assembly. The junctions of conveyor sections must always be supported by a stand. The joining components, on either side of the conveyor, are an intermediate clamp (V), an intermediate T-bar (W) and four (4) M6 x 12 mm button head screws (X).

### NOTE:

Flat belt conveyor also have a return roller assembly (J of Figures 2 & 3) installed between the stand mounting blocks.

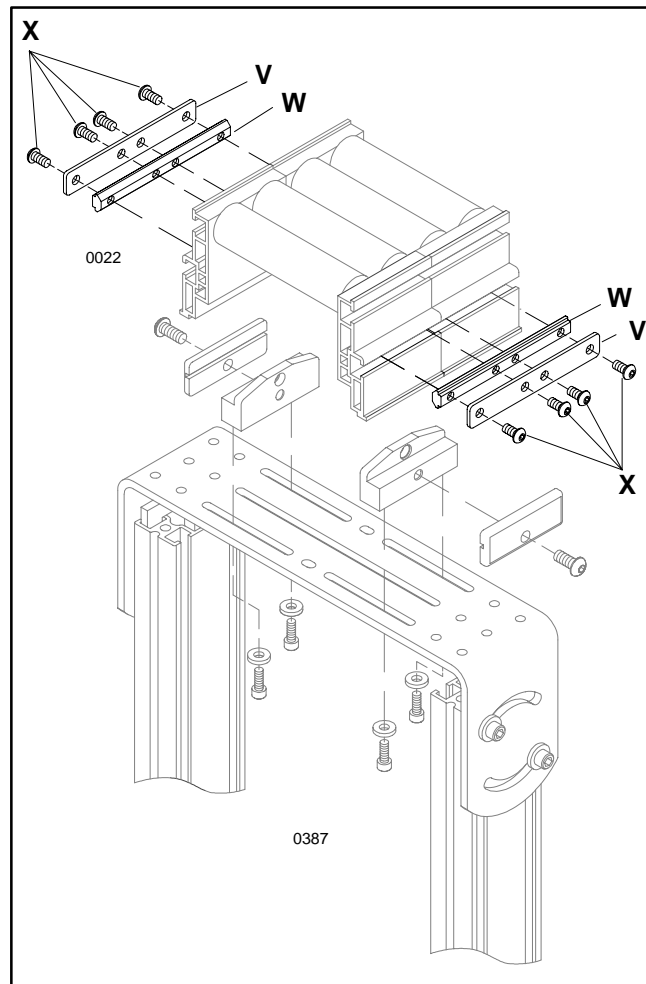

**Figure 6: Conveyor Section Connection Detail**

## Aluminum Stands & Related Components

Item	Part No.	Part Description
1	291800M	Stand/Conveyor Mounting Bracket, 18" (457 mm)
	292400M	Stand/Conveyor Mounting Bracket, 24" (610 mm)
2	202148M	Stand/Conveyor Mounting Bracket, 12" (305 mm)
3	200697M	Conveyor/Stand "L" Mounting Bracket
4	605280	Flat Washer
5	920818M	Socket Head Cap Screw, M8-1.25 x 18 mm
6	200801M	Quad Nut, M8
7	205018	L= Extrusion 11.50" (292.1 mm) Long
	205021	L= Extrusion 14.50" (368.3 mm) Long
	205024	L= Extrusion 17.50" (444.5 mm) Long
	205027	L= Extrusion 20.50" (520.7 mm) Long
	205030	L= Extrusion 23.50" (596.9 mm) Long
	205033	L= Extrusion 26.50" (673.1 mm) Long
	205036	L= Extrusion 29.50" (749.3 mm) Long
	205039	L= Extrusion 32.50" (825.5 mm) Long
	205042	L= Extrusion 35.50" (901.7 mm) Long
	205045	L= Extrusion 38.50" (977.9 mm) Long
	205048	L= Extrusion 41.50" (1054.1 mm) Long
	8	930820M
9	200799M	Mounting Tube End Plate
10	390012M	W = Extrusion 9.35" (237.5 mm) Long
	390015M	W = Extrusion 12.35" (313.7 mm) Long
	390018M	W = Extrusion 15.35" (389.9 mm) Long
	390021M	W = Extrusion 18.35" (466.1 mm) Long
	390024M	W = Extrusion 21.35" (542.3 mm) Long
	390030M	W = Extrusion 27.35" (694.7 mm) Long
	390036M	W = Extrusion 33.35" (847.1 mm) Long
	390040M	W = Extrusion 37.35" (948.7 mm) Long
11	920616M	Socket Head Cap Screw, M6-1.0 x 16 mm
12	300150M	Drop-In T-bar
13	200800M	Swivel Foot Mounting Block
14	906-998	Hex. Hd. Thread Forming Screw, 5/16-18 x 1.25" Long
15	200797M	Swivel Foot Ass'y
16	910-098	Hex. Jam Nut, 1-14
17	662150	Tube Mounting Swivel Caster Ass'y

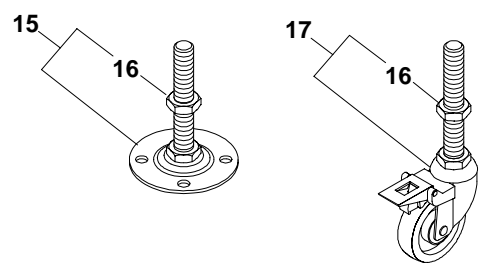
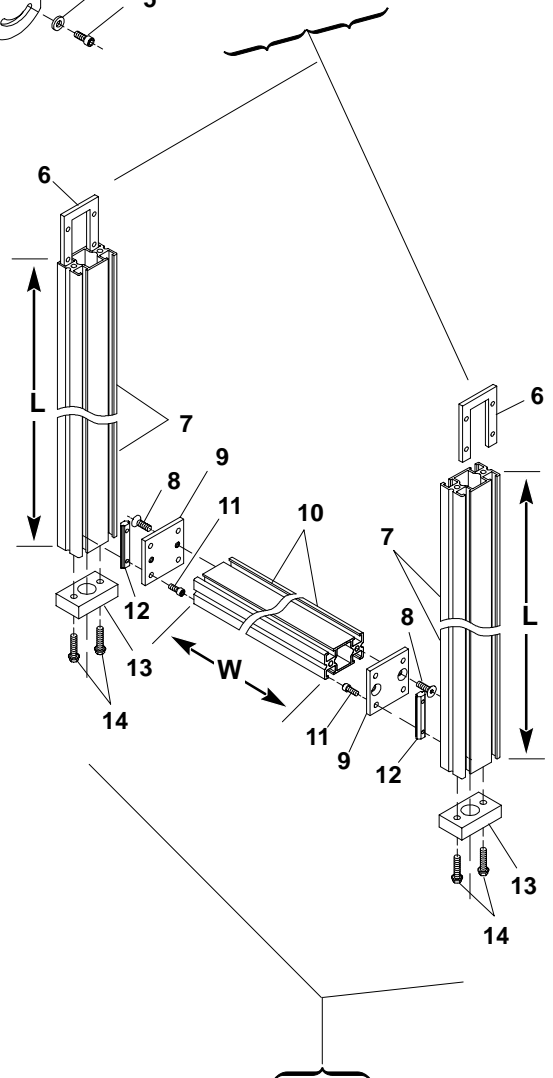
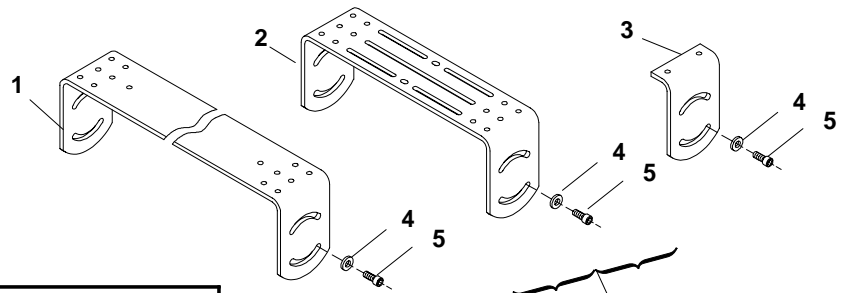

0394

## Steel Stands & Related Components

Item	Part No.	Part Description
1	202148M	Stand/Conveyor Mounting Bracket, 12" (305 mm)
2	291800M	Stand/Conveyor Mounting Bracket, 18" (457 mm)
	292400M	Stand/Conveyor Mounting Bracket, 24" (610 mm)
3	200697M	Conveyor/Stand "L" Mounting Bracket
4	920818M	Socket Head Cap Screw, M8-1.25 x 18 mm
5	605280	Flat Washer
6	290306M	L = Leg, Gray 5.75" (146.1 mm) Long
	290308M	L = Leg, Gray 7.75" (196.9 mm) Long
	290312M	L = Leg, Gray 10" (254 mm) Long
7	990805M	Spring Nut, M8-1.25
8	634698M	Swivel Plate
9	930820M	Flat Head Cap Screw, M8-1.25 x 20 mm
10	202323M	Boot, 6" (152.4 mm) Long
	202324M	Boot, 7.63" (193.8 mm) Long
	202325M	Boot, 9.25" (235 mm) Long

Item	Part No.	Part Description
11	920825M	Socket Head Cap Screw, M8-1.25 x 25 mm
12	632147M	Double Washer Plate
13	632149M	Double Nut
14	807-324	Caster, Rigid
15	807-325	Caster, Swivel
16	990801M	Nut, M8-1.25
17	290212M	W = Cross Member, 12" (305 mm) Long
	290218M	W = Cross Member, 18" (457 mm) Long
	290224M	W = Cross Member, 24" (610 mm) Long
	290230M	W = Cross Member, 30" (762 mm) Long
	290236M	W = Cross Member, 36" (915 mm) Long
	290240M	W = Cross Member, 40" (1016 mm) Long

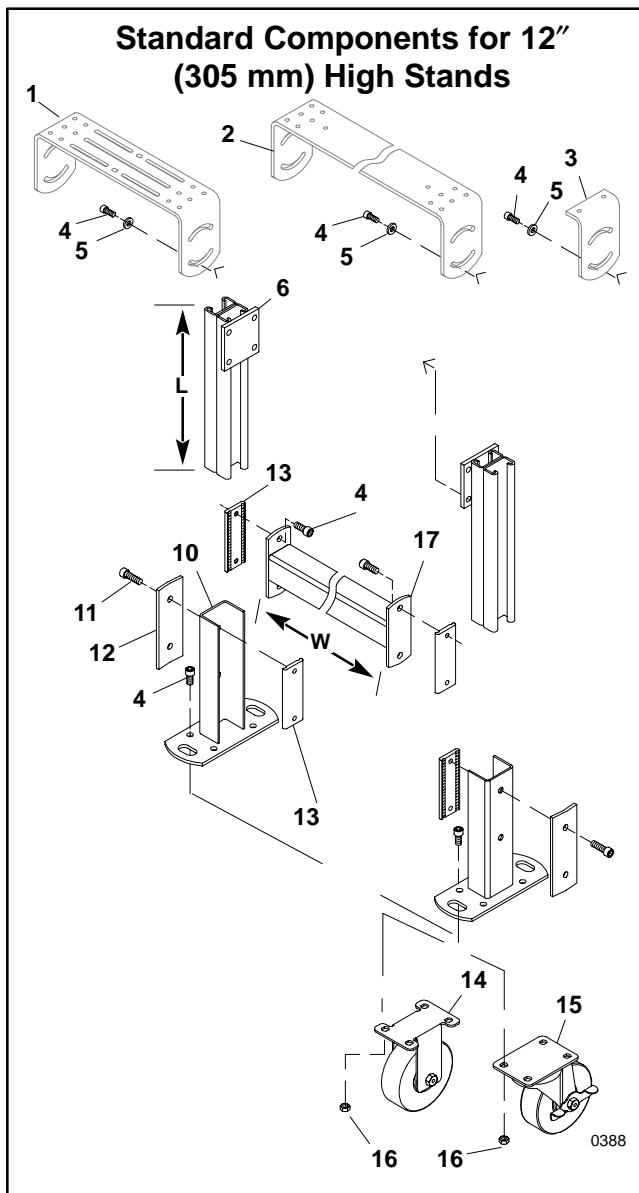
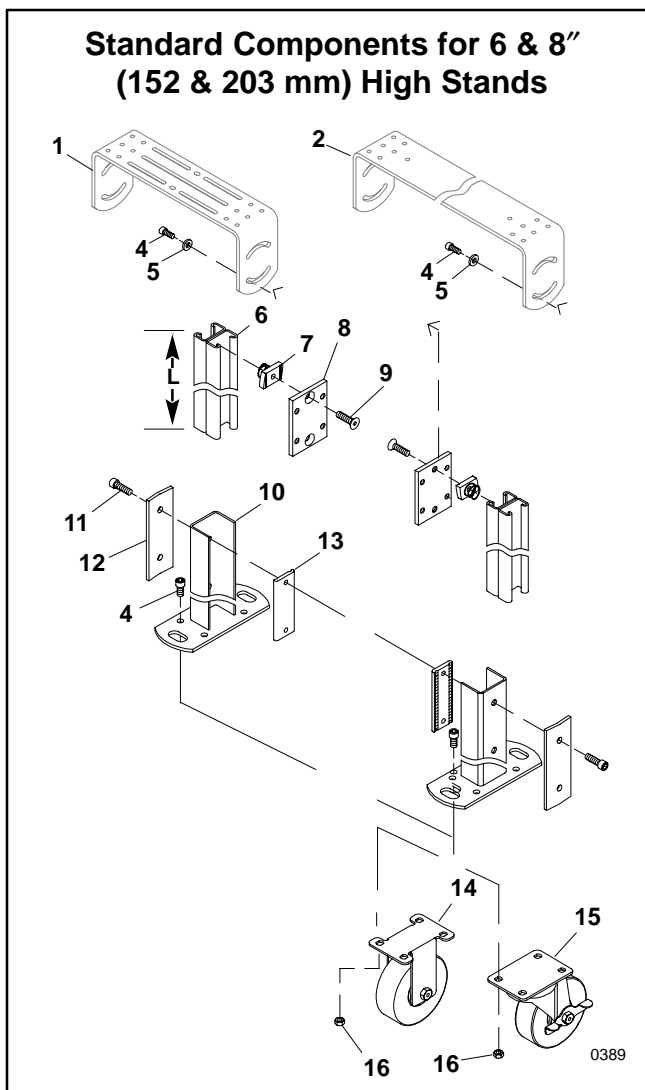



Standard Components for Taller Than 12" (305 mm) High Stands

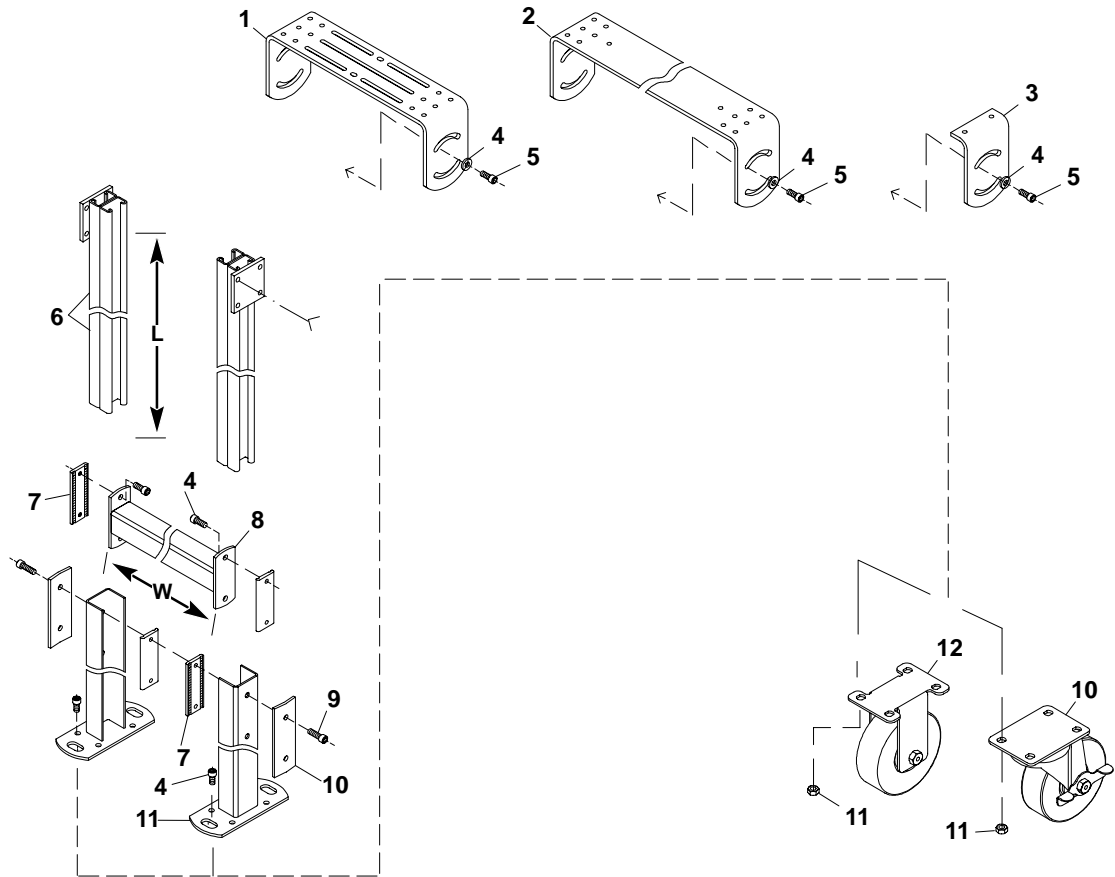

0392

Item	Part No.	Part Description
1	202148M	Stand/Conveyor Mounting Bracket, 12" (305 mm)
2	291800M	Stand/Conveyor Mounting Bracket, 18" (457 mm)
	292400M	Stand/Conveyor Mounting Bracket, 24" (610 mm)
3	200697M	Conveyor/Stand "L" Mounting Bracket
4	605280	Flat Washer
5	920818M	Socket Head Cap Screw, M8-1.25 x 18 mm
6	290314M	L = Leg, Gray 12" (305 mm) Long
	290316M	L = Leg, Gray 14" (356 mm) Long
	290319M	L = Leg, Gray 17" (432 mm) Long
	290325M	L = Leg, Gray 23" (584 mm) Long
	290337M	L = Leg, Gray 35" (889 mm) Long
	290352M	L = Leg, Gray 50" (1270 mm) Long
7	632149M	Double Nut

Item	Part No.	Part Description
8	290012M	W = Cross Member, Gray 12" (304.8 mm) Long
	290018M	W = Cross Member, Gray 18" (457.2 mm) Long
	290024M	W = Cross Member, Gray 24" (609.6 mm) Long
	290030M	W = Cross Member, Gray 30" (762 mm) Long
	290036M	W = Cross Member, Gray 36" (914.4 mm) Long
	290040M	W = Cross Member, Gray 40" (1016 mm) Long
9	920825M	Socket Head Cap Screw, M8-1.25 x 25 mm
10	632147M	Double Washer Plate
11	202324M	Boot, 7.63" (193.8 mm) Long
	202325M	Boot, 9.25" (235 mm) Long
	202326M	Boot, 12.25" (311.2 mm) Long
	202328M	Boot, 18.25" (463.6 mm) Long
	202330M	Boot, 30.25" (768.4 mm) Long
12	807-324	Caster, Rigid
10	807-325	Caster, Swivel
11	990801M	Nut, M8-1.25

## Adjustable Aluminum Support Stand

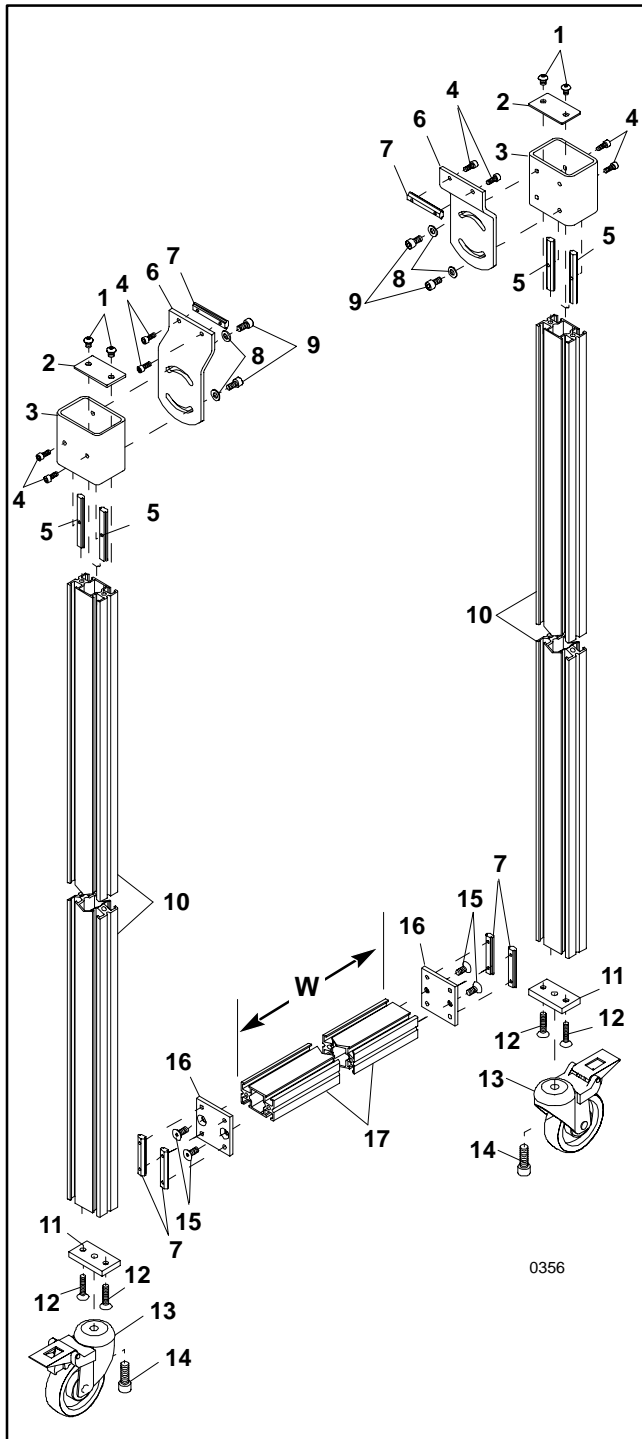

Item	Part No.	Part Description
1	910810M	Button Head Cap Screw, M8-1.25 x 10 mm
2	635133M	Tube End Cap
3	300826M	Leg Support Bracket
4	920616M	Socket Head Cap Screw, M6-1.0 x 16 mm
5	300690M	Single Drop-In T-bar
6	300825M	Stand Mounting Pivot Bracket
7	300150M	Drop-In T-bar
8	911-008	SAE Flat Washer 5/16"
9	920816M	Socket Head Cap Screw, M8-1.25 x 16 mm
10	390012M	Extrusion 9.35" (237.5 mm) Long
	390024M	Extrusion 21.35" (542.3 mm) Long
	390036M	Extrusion 33.35" (847.1 mm) Long
	390048M	Extrusion 45.35" (1152 mm) Long
	390060M	Extrusion 57.35" (1457 mm) Long
11	300827M	Tube Caster Mounting End Block
12	930830M	Flat Head Cap Screw, M8-1.25 x 30 mm
13	807-640	Swivel Caster, 4" Diameter
14	921235M	Socket Head Cap Screw, M12-1.75 x 35 mm
15	930820M	Flat Head Cap Screw, M8-1.25 x 20 mm
16	200799M	Mounting Tube End Plate
17	300688M	W = Extrusion, 16.25" (412.8 mm) Long
	300692M	W = Extrusion, 12.25" (311.2 mm) Long
	300693M	W = Extrusion, 22.25" (412.8 mm) Long
	300694M	W = Extrusion, 28.25" (717.9 mm) Long

Floor Mount Caster Assembly

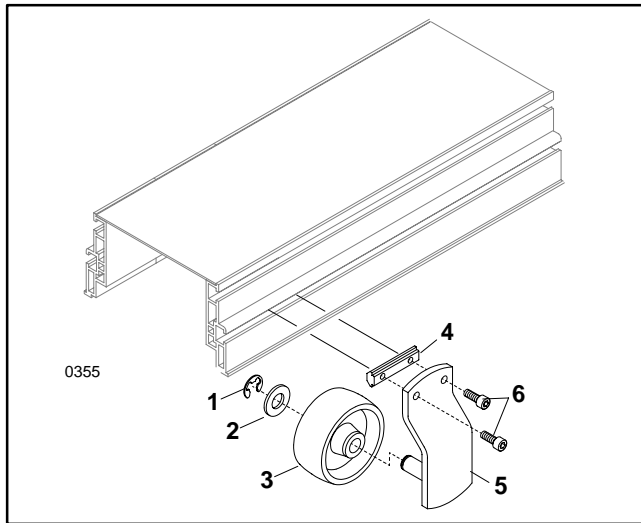

Item	Part No.	Part Description
1	915-218	Retaining Ring, 1/2
2	911-011	Flat Washer, 1/2
3	807-849	Wheel, 3 (mm) Diameter
4	639717M	Drop-in T-bar
5	300749M	Wheel Mounting Bracket Ass'y
6	920616M	Socket Head Cap Screw, M6-1.0 x 16 mm

Fixed Floor Mounting Assembly

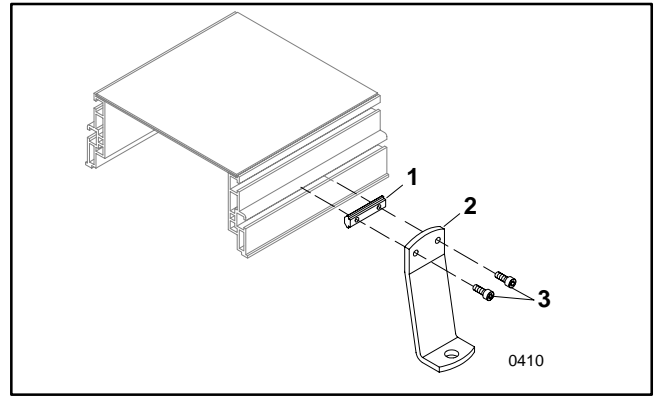

Item	Part No.	Part Description
1	639717M	Drop-in T-bar
2	300751M	Floor Mounting Plate
3	920616M	Socket Head Cap Screw, M6-1.0 x 16 mm

## Aluminum or Steel Stand to Cleated Belt Conveyor Mounting Assemblies

Item	Part No.	Part Description
1	200022M	Clamp Plate
2	910830M	Button Head Cap Screw, M8-1.25 x 30 mm
3	300368M	Bracket, 3100 Series
4	639249M	Roller Hub
5	802-027	Sealed Ball Bearings
6	911-007	Washer
7	930510M	Flat Head Cap Screw, M5-0.80 x 10 mm
8	605279	Hard Washer
9	920618M	Socket Head Cap Screw, M6-1.0 x 18 mm

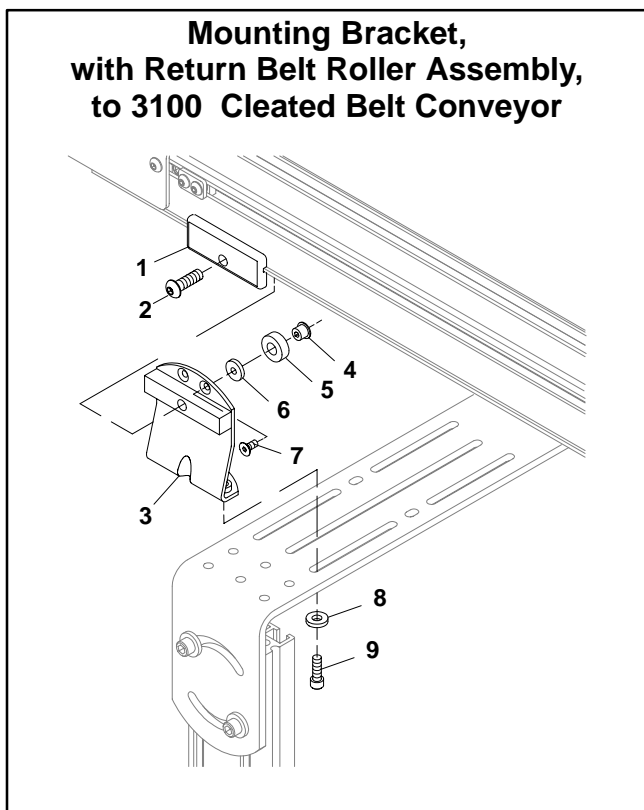
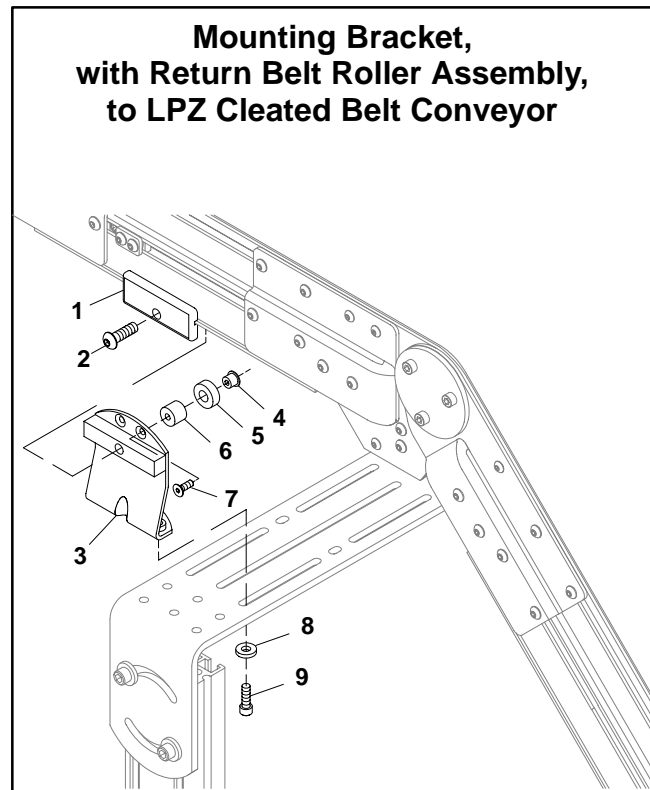

Item	Part No.	Part Description
1	200022M	Clamp Plate
2	910830M	Button Head Cap Screw, M8-1.25 x 30 mm
3	300368M	Bracket, 3100 Series
4	639249M	Roller Hub
5	802-027	Sealed Ball Bearings
6	300633M	Return Roller Bearing Spacer
7	930520M	Flat Head Cap Screw, M5-0.80 x 20 mm
8	605279	Hard Washer
9	920618M	Socket Head Cap Screw, M6-1.0 x 18 mm

## Mounting Bracket, with Return Belt Roller Assembly, to 2100 Cleated Belt Conveyor

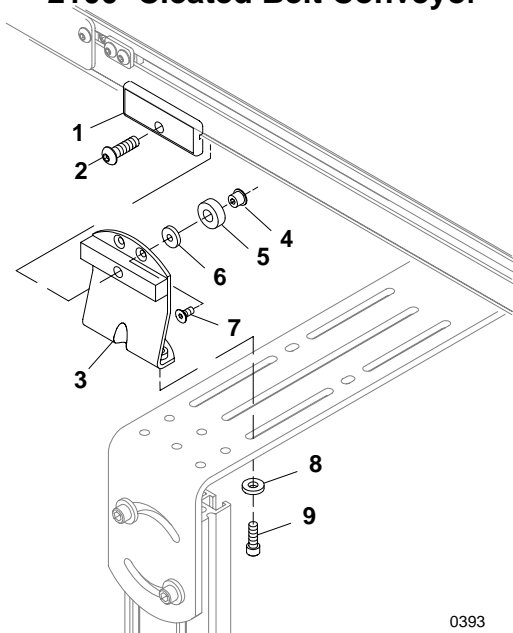

Item	Part No.	Part Description
1	200022M	Clamp Plate
2	910818M	Button Head Cap Screw, M8-1.25 x 18 mm
3	201911M	Bracket, 2100 Series
4	639249M	Roller Hub
5	802-027	Sealed Ball Bearings
6	911-007	Washer
7	930510M	Flat Head Cap Screw, M5-0.80 x 10 mm
8	605279	Hard Washer
9	920618M	Socket Head Cap Screw, M6-1.0 x 18 mm

## Aluminum or Steel Stand to Flat Belt Conveyor & Stand Mounting Components

Item	Part No.	Part Description
1	910612M	Button Head Cap Screw, M6-1.0 x 12 mm
2	300153M	Intermediate Clamp Plate
3	300151M	Intermediate T-bar
4	202311P	Return Roller Bearing
5	207702	Return Roller Tube, 2" (44 mm) Long
	207703	Return Roller Tube, 3" (70 mm) Long
	207704	Return Roller Tube, 4" (95 mm) Long
	207705	Return Roller Tube, 5" (127 mm) Long
	207706	Return Roller Tube, 6" (152 mm) Long
	207708	Return Roller Tube, 8" (203 mm) Long
	207710	Return Roller Tube, 10" (254 mm) Long
	207712	Return Roller Tube, 12" (305 mm) Long
	207718	Return Roller Tube, 18" (457 mm) Long
	207724	Return Roller Tube, 24" (610 mm) Long
6	910816M	Button Head Cap Screw, M8-1.25 x 16 mm
7	200022M	Clamp Plate
8	202348P	Bearing Pin
9	202351M	Mounting Block
10	605279	Hard Washer
11	920618M	Socket Head Cap Screw, M6-1.0 x 18 mm

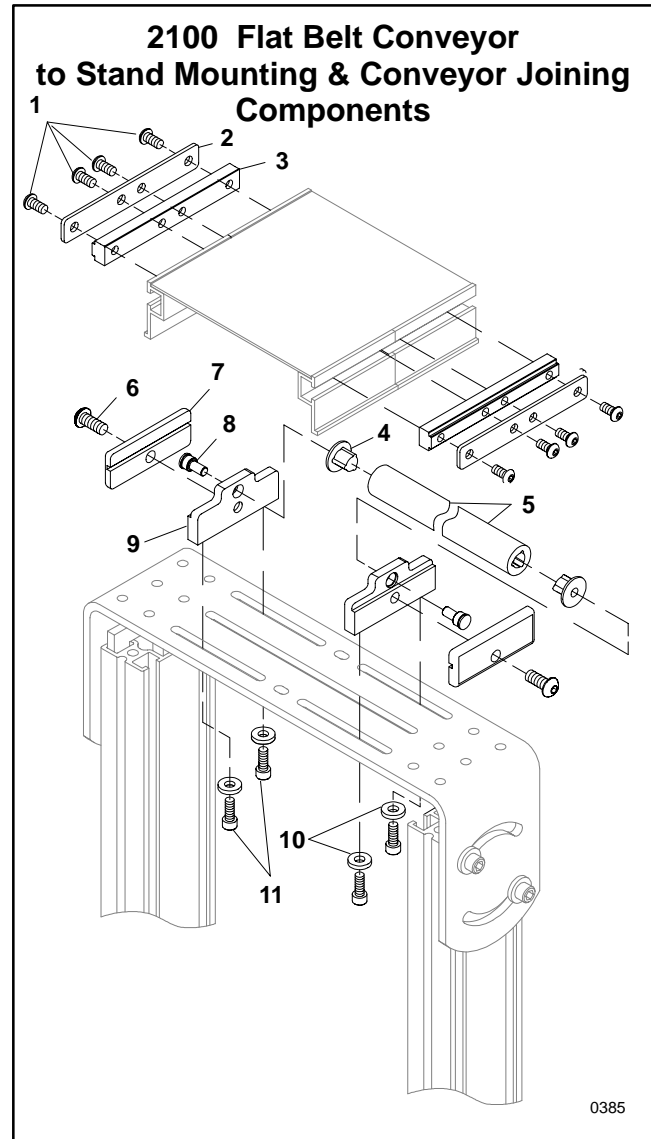

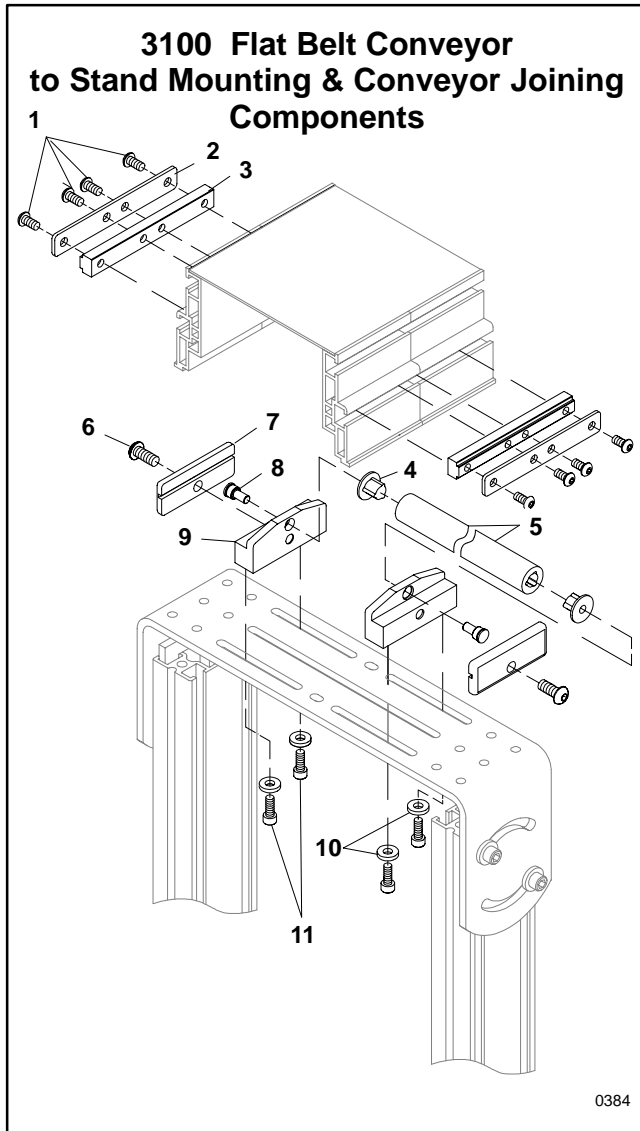

Item	Part No.	Part Description
1	910612M	Button Head Cap Screw, M6-1.0 x 12 mm
2	300153M	Intermediate Clamp Plate
3	300151M	Intermediate T-bar
4	202311P	Return Roller Bearing
5	207704	Return Roller Tube, 4" (95 mm) Long
	207705	Return Roller Tube, 5" (127 mm) Long
	207706	Return Roller Tube, 6" (152 mm) Long
	207708	Return Roller Tube, 8" (203 mm) Long
	207710	Return Roller Tube, 10" (254 mm) Long
	207712	Return Roller Tube, 12" (305 mm) Long
	207718	Return Roller Tube, 18" (457 mm) Long
	207724	Return Roller Tube, 24" (610 mm) Long
	207730	Return Roller Tube, 30" (762 mm) Long
	207736	Return Roller Tube, 36" (915 mm) Long
207740	Return Roller Tube, 40" (1016 mm) Long	
6	910820M	Button Head Cap Screw, M8-1.25 x 20 mm
7	200022M	Clamp Plate
8	202348P	Bearing Pin
9	300551M	Stand Mounting Block
10	605279	Hard Washer
11	920618M	Socket Head Cap Screw, M6-1.0 x 18 mm

## Roller Conveyors & Stand Mounting Components

Item	Part No.	Part Description
1	910612M	Button Head Cap Screw, M6-1.0 x 12 mm
2	300153M	Intermediate Clamp Plate
3	300429M	Intermediate T-bar
4	910816M	Button Head Cap Screw, M8-1.25 x 16 mm
5	200022M	Clamp Plate
6	210021M	Stand Mounting Block
7	605279	Hard Washer
8	920618M	Socket Head Cap Screw, M6-1.0 x 18 mm

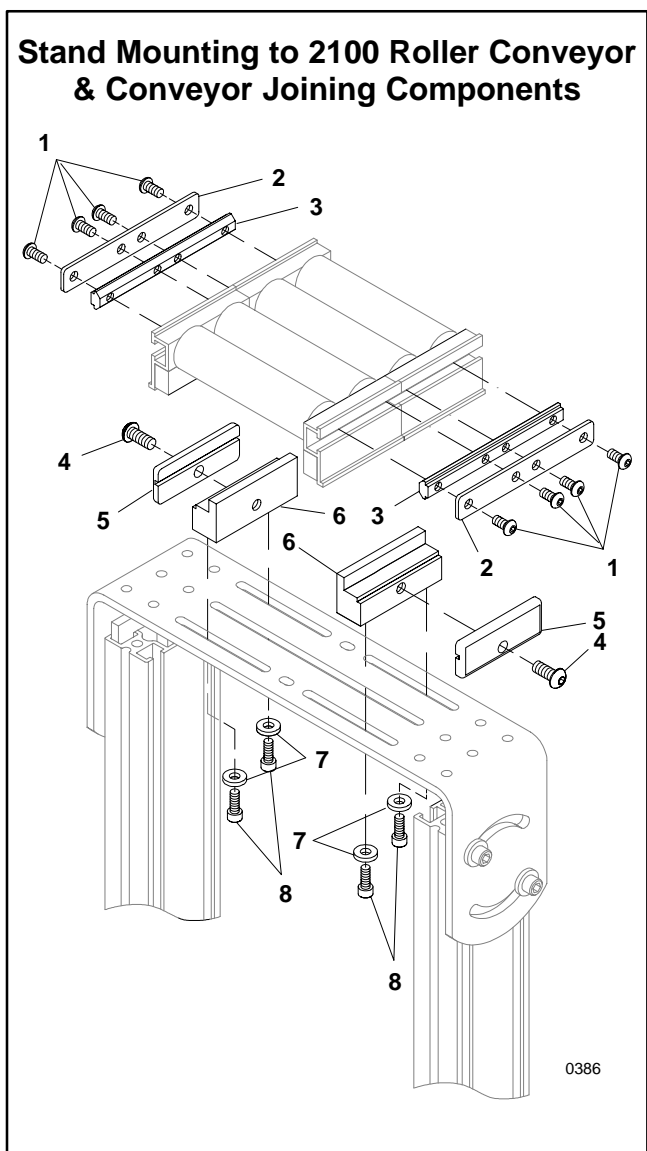
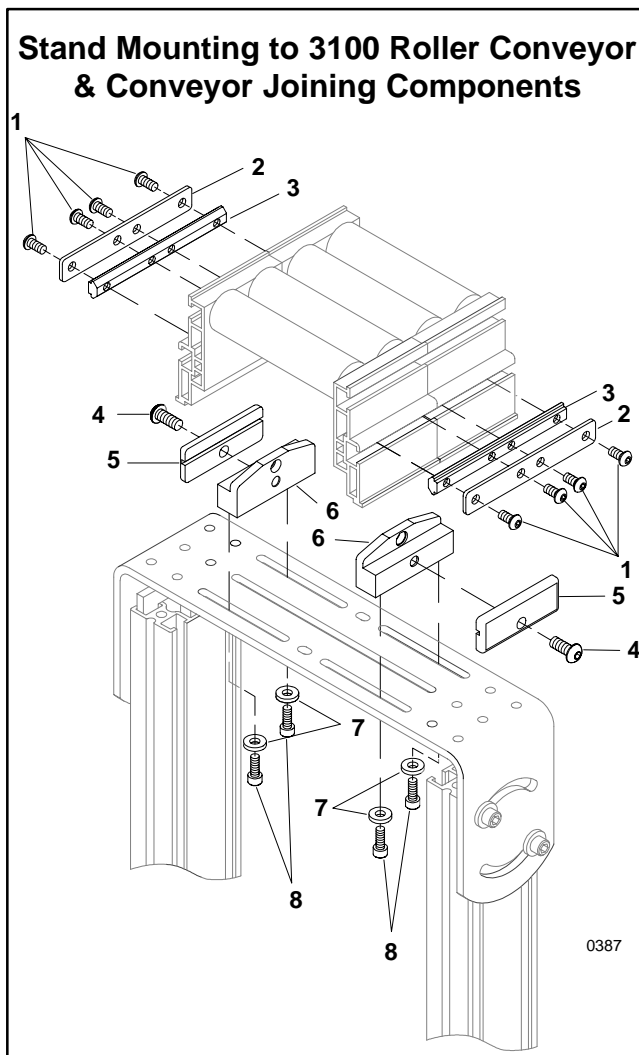

Item	Part No.	Part Description
1	910612M	Button Head Cap Screw, M6-1.0 x 12 mm
2	300153M	Intermediate Clamp Plate
3	300429M	Intermediate T-bar
4	910820M	Button Head Cap Screw, M8-1.25 x 20 mm
5	200022M	Clamp Plate
6	300551M	Stand Mounting Block
7	605279	Hard Washer
8	920618M	Socket Head Cap Screw, M6-1.0 x 18 mm



Diagonal Braces

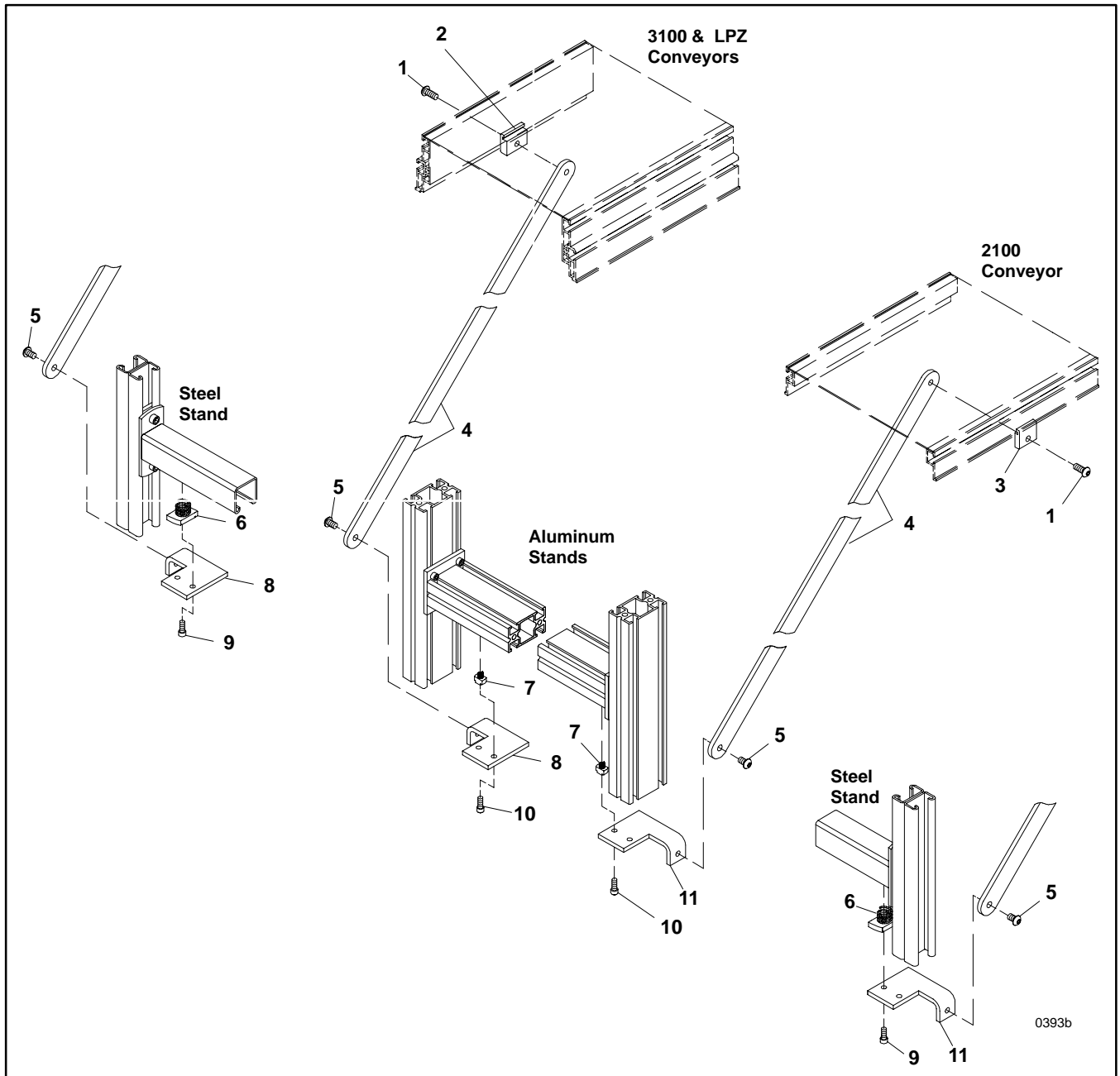

Item	Part No.	Part Description
1	910818M	Button Head Cap Screw, M8-1.25 x 18 mm
2	201410	Clip, 3100 Series & LPZ
3	201409	Clip, 2100 Series
4	300821M	Diagonal Brace Bar 13-1/4" (336 mm)
	201408M	Diagonal Brace Bar 23-1/4" (590 mm)
5	910812M	Button Head Cap Screw, M8-1.25 x 12 mm

Item	Part No.	Part Description
6	990607M	Spring Nut, M6 (for Steel Stand)
7	200124M	Spring Nut M6 (for Aluminum Stand)
8	201030M	Offset Plate, Right Hand
9	920625M	Socket Head Cap Screw, M6-1.0 x 25 mm
10	920618M	Socket Head Cap Screw, M6-1.0 x 18 mm
11	201031M	Offset Plate, Left Hand

# Replacement Parts

# Support Stands & Conveyor Mountings

Part #	Page	Part #	Page	Part #	Page
200022M	12, 13, 14, 15, 16	290316M	9	911-011	11
200148M	7, 8, 9	290319M	9	915-218	11
200697M	7, 8, 9	290325M	9	920616M	10, 11
200797M	7	290337M	9	920618M	13
200799M	7, 10	290352M	9	920620M	12, 14, 15, 16
200800M	7	291800M	7, 8, 9	920816M	10
200801M	7	292400M	7, 8, 9	920818M	7, 8, 9
201911M	13	300150M	7, 10	920825M	8, 9
202311P	14, 15	300151M	14, 15	921235M	10
202323M	8	300153M	14, 15, 16	930510M	12, 13
202324M	8, 9	300368M	12	930520M	12
202325M	9	300429M	16	930820M	7, 10
202326M	9	300551M	15, 16	930825M	8
202328M	9	300633M	12	930830M	10
202330M	9	300688M	10	200124M	17
202348M	14, 15	300690M	10	201030M	17
202351M	14	300692M	10	201031M	17
205018	7	300693M	10	201408M	17
205021	7	300694M	10	201409M	17
205024	7	300749M	11	201410M	17
205027	7	300751M	11	300821M	17
205030	7	300825M	10	910812M	17
205033	7	300826M	10	910818M	17
205036	7	300827M	10	920618M	17
205039	7	390012M	7, 10	920625M	17
205042	7	390015M	7	990607M	17
205045	7	390018M	7	990801M	8, 9
205048	7	390021M	7	990805M	8
207702	14	390024M	7, 10		
207703	14	390030M	7		
207704	14, 15	390036M	7, 10		
207705	14, 15	390040M	7		
207706	14, 15	390048M	10		
207708	14, 15	390060M	10		
207710	14, 15	605279	12, 13, 14, 15, 16		
207712	14, 15	605280	7, 8, 9		
207718	14, 15	632147M	8, 9		
207724	14, 15	632149M	8, 9		
207730	15	634698M	8		
207736	15	635133M	10		
207740	15	639249M	12, 13		
210021M	16	639717M	11		
290012M	9	662150	7		
290018M	9	807-027	12, 13		
290024M	9	807-324	8, 9		
290030M	9	807-325	8, 9		
290036M	9	807-640	10		
290040M	9	807-849	11		
290212M	8	906-998	7		
290218M	8	910-098	7		
290224M	8	910612M	14, 15, 16		
290230M	8	910810M	10		
290236M	8	910816M	14, 16		
290240M	8	910818M	13		
290306M	8	910820M	15, 16		
290308M	8	910830M	12		
290312M	8	911-007	12, 13		
290314M	9	911-008	10		

**Notes**

## RETURN POLICY

No returns will be accepted without prior written factory authorization. When calling for authorization, please have the following information ready for the Dornier Factory representative or your local distributor:

1. Name and address of customer.
2. Item(s) being returned.
3. Reason for return.
4. Customer's original order number used when ordering the item(s).
5. Dornier or distributor invoice number.

A representative will discuss action to be taken on the Returned items and provide a Returned Goods Authorization Number to reference.

There will be a 15% restocking charge on all new items returned for credit where Dornier was not at fault. These will not be accepted after 60 days from original invoice date. The restocking charge covers inspection, cleaning, disassembly, and reissuing to inventory.

If a replacement is needed prior to evaluation of returned item, a purchase order must be issued. Credit (if any) is issued only after return and evaluation is complete.

- Dornier has representatives throughout the world. Feel free to contact Dornier for the name of your local representative. Our technical sales and service staff will gladly help with your questions on Dornier products.

# **DORNER**<sup>®</sup>

Dornier Mfg. Corp. reserves the right to change or discontinue products without notice. All products and services are covered in accordance with our standard warranty. All rights reserved. ©Dornier Mfg. Corp. 1997

### **DORNER MFG. CORP.**

580 Industrial Drive, PO Box 20  
Hartland, WI 53029-0020 USA

#### **USA**

**TEL 1-800-397-8664 (USA)**  
**FAX 1-800-369-2440 (USA)**

Outside the USA:

TEL 1-414-367-7600, FAX 1-414-367-5827

### **DORNER**

Arnold-Sommerfeld-Ring 2  
D-52499 Baesweiler

#### **Germany**

**TEL (02401) 80 52 90**  
**FAX (02401) 80 52 93**