



# Sanitary Tall Support Stands, Low Height Support Stands and Ceiling Supports

## Installation, Maintenance & Parts Manual



Low Height Support Stands

Tall Support Stands

Ceiling Supports

DORNER MFG. CORP.  
P.O. Box 20 • 975 Cottonwood Ave.  
Hartland, WI 53029-0020 USA

INSIDE THE USA  
TEL: 1-800-397-8664  
FAX: 1-800-369-2440

OUTSIDE THE USA  
TEL: 262-367-7600  
FAX: 262-367-5827

For other service manuals visit our website at:  
[www.dorner.com/service\\_manuals.asp](http://www.dorner.com/service_manuals.asp)

---

# Table of Contents

---

Introduction .....	2	Ceiling Supports .....	8
Warnings - General Safety .....	3	Ceiling - Horizontal.....	8
Product Description .....	4	Ceiling - Angle .....	9
Specifications .....	4	Diagonal Brace Attachment.....	9
Support Stand Models.....	4	Preventive Maintenance and Adjustment .....	10
Tall Support Stands .....	4	Stand Height Adjustment .....	10
Low Height Support Stands .....	4	Required Tools.....	10
Ceiling Supports.....	4	Stands With Feet .....	10
Installation .....	5	Stands With Casters .....	11
Required Tools.....	5	Notes .....	12
Recommended Installation Sequence .....	5	Service Parts.....	13
Stand Attachment to the Conveyor .....	5	Tall Support Stands .....	13
Tall Stands - Horizontal Mount.....	5	Low Height Support Stands with Foot Pads .....	14
Tall Stands - Angle Mount .....	5	Low Height Support Stands with Casters.....	15
Low Height Support Stands .....	6	Ceiling Supports - Horizontal Mount.....	16
Stands with Foot Pads.....	6	Ceiling Supports - Angle Mount .....	17
Stands with Caster Wheels .....	7	Return Policy.....	18
Horizontal Mount Stand - Straight To Curve Section..	7		

---

## Introduction

---

<b>IMPORTANT</b>
------------------

<i>Some illustrations may show guards removed. DO NOT operate equipment without guards.</i>
---

Upon receipt of shipment:

- Compare shipment with packing slip. Contact factory regarding discrepancies.

- Inspect packages for shipping damage. Contact carrier regarding damage.
- Accessories may be shipped loose. See accessory instructions for installation.

Dorner's Limited Warranty applies.

Dorner reserves the right to make changes at any time without notice or obligation.

## Warnings - General Safety

### WARNING

The safety alert symbol, black triangle with white exclamation, is used to alert you to potential personal injury hazards.

### DANGER



Climbing, sitting, walking or riding on conveyor will cause severe injury.  
**KEEP OFF CONVEYORS.**

### DANGER



**DO NOT OPERATE CONVEYORS IN AN EXPLOSIVE ENVIRONMENT.**

### DANGER



Supports marked with this symbol must be anchored to the floor. Supports not anchored to floor will tip, causing severe injury or death.  
**SUPPORT MUST BE ANCHORED TO FLOOR.**

### WARNING



Exposed moving parts can cause severe injury.  
**LOCK OUT POWER** before removing guards or performing maintenance.

### WARNING



Loosening stand height or angle adjustment screws may cause conveyor sections to drop down, causing severe injury.  
**SUPPORT CONVEYOR SECTIONS PRIOR TO LOOSENING STAND HEIGHT OR ANGLE ADJUSTMENT SCREWS.**

### WARNING



Dorner cannot control the physical installation and application of conveyors. Taking protective measures is the responsibility of the user.

When conveyors are used in conjunction with other equipment or as part of a multiple conveyor system, **CHECK FOR POTENTIAL PINCH POINTS** and other mechanical hazards before system start-up.

# Product Description

Refer to **Figure 1** for typical stand components.

1	Pivot Plate
2	Support Stand
3	Foot Pad

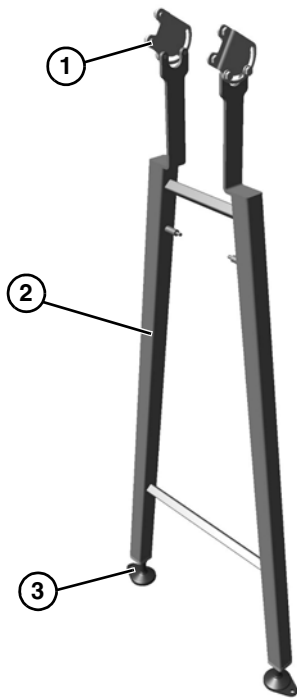
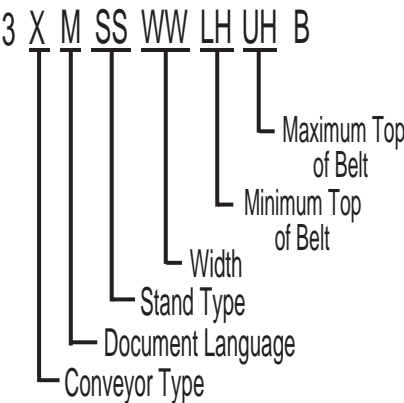

Figure 1

# Specifications

## Support Stand Models

### Tall Support Stands



### Low Height Support Stands

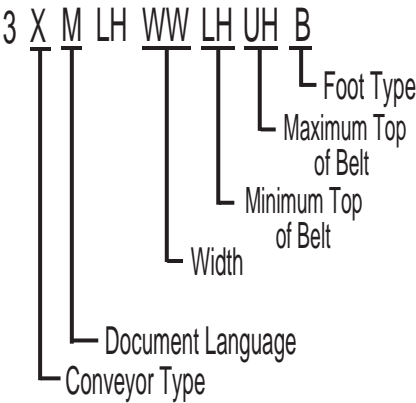

### Ceiling Supports

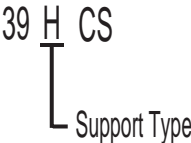

## Required Tools

- Level
- 17 mm wrench
- 24 mm wrench
- 30 mm wrench

## Recommended Installation Sequence

- Attach the stand(s) to the conveyor.
- Attach the diagonal bracing, if applicable.
- Adjust the stand height and level.

## Stand Attachment to the Conveyor

<b>⚠ WARNING</b>

<p><b>Exposed moving parts can cause severe injury.</b></p> <p><b>LOCK OUT POWER</b> before removing guards or performing maintenance.</p>

### Tall Stands - Horizontal Mount

1. Properly support the conveyor or place the conveyor upside down on a flat surface.

<b>⚠ WARNING</b>

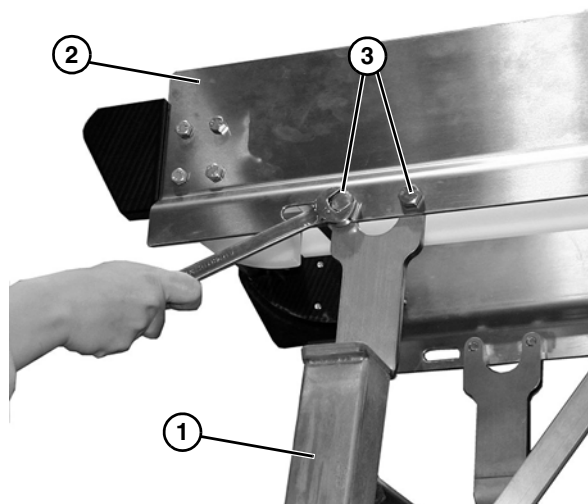
<p><b>Failure to secure screws (Figure 2, item 3) may cause conveyor sections to drop down causing severe injury.</b></p> <p><b>TIGHTEN SCREWS (Figure 2, item 3) AFTER ADJUSTMENT.</b></p>

2. Attach the stand (**Figure 2, item 1**) to the conveyor (**Figure 2, item 2**) and tighten the four bolts (**Figure 2, item 3**).

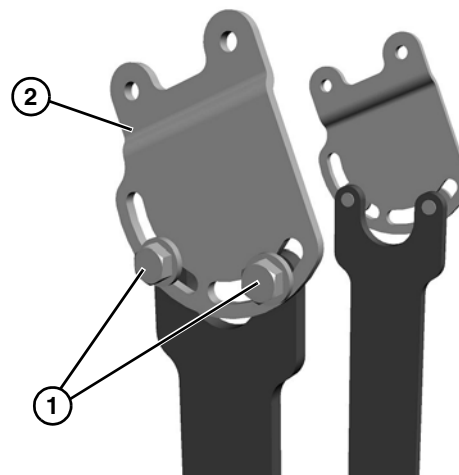

**Figure 2**

3. Repeat for other stands.
4. Adjust the stand height. Refer to “Stand Height Adjustment” on page 10.

### Tall Stands - Angle Mount

1. Properly support the conveyor or place the conveyor upside down on a flat surface.
2. For slotted brackets, loosen the two bracket bolts (**Figure 3, item 1**) and adjust the bracket (**Figure 3, item 2**) so that the top is at approximately the same angle as the conveyor. Do not tighten the bolts.



**Figure 3**

# Installation

3. Attach the bracket (**Figure 4, item 1**) to the conveyor (**Figure 4, item 2**) and tighten the four bolts (**Figure 4, item 3**).

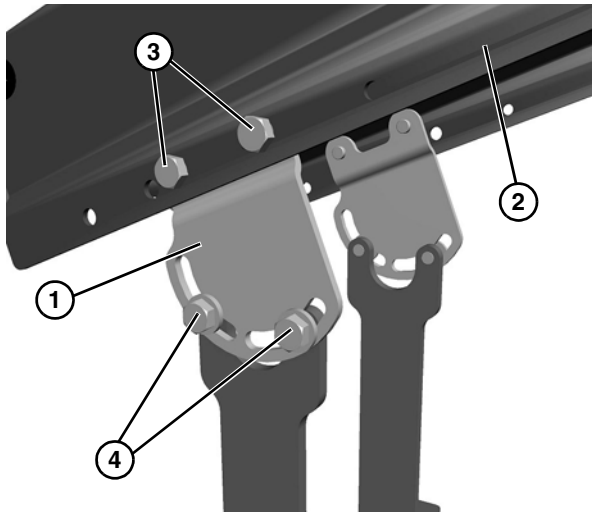

**Figure 4**

## ⚠ WARNING



Failure to secure screws (**Figure 4, item 4**) may cause conveyor sections to drop down causing severe injury.  
**TIGHTEN SCREWS (Figure 4, item 4) AFTER ADJUSTMENT.**

4. Adjust the bracket angle on the slotted brackets (**Figure 4, item 1**) to match the conveyor angle until the legs are vertical and tighten the bolts (**Figure 4, item 2**).
5. Repeat steps 2 through 4 for the other stands.
6. Adjust the stand height. Refer to “Stand Height Adjustment” on page 10.

## Low Height Support Stands

### Stands with Foot Pads

1. Properly support the conveyor or place the conveyor upside down on a flat surface.

## ⚠ WARNING



Failure to secure screws (**Figure 5, item 3**) may cause conveyor sections to drop down causing severe injury.  
**TIGHTEN SCREWS (Figure 5, item 3) AFTER ADJUSTMENT.**

2. Attach the foot pad stand (**Figure 5, item 1**) to the conveyor (**Figure 5, item 2**) and tighten the two bolts (**Figure 5, item 3**).

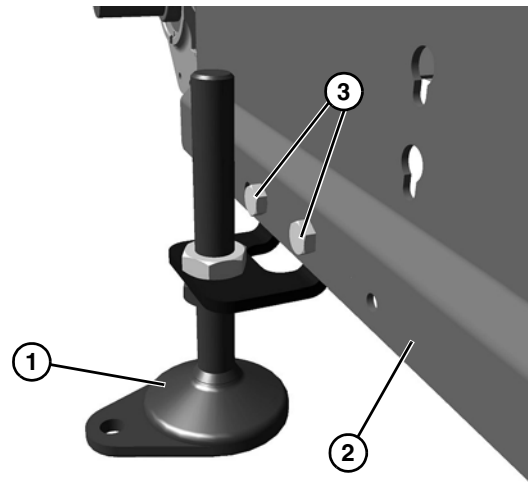

**Figure 5**

3. Repeat for other stands.
4. Adjust the stand height. Refer to “Stand Height Adjustment” on page 10.

## Stands with Caster Wheels

1. Properly support the conveyor or place the conveyor upside down on a flat surface.

<b>⚠ WARNING</b>

<p><b>Failure to secure screws (Figure 6, item 3) may cause conveyor sections to drop down causing severe injury.</b></p> <p><b>TIGHTEN SCREWS (Figure 6, item 3) AFTER ADJUSTMENT.</b></p>

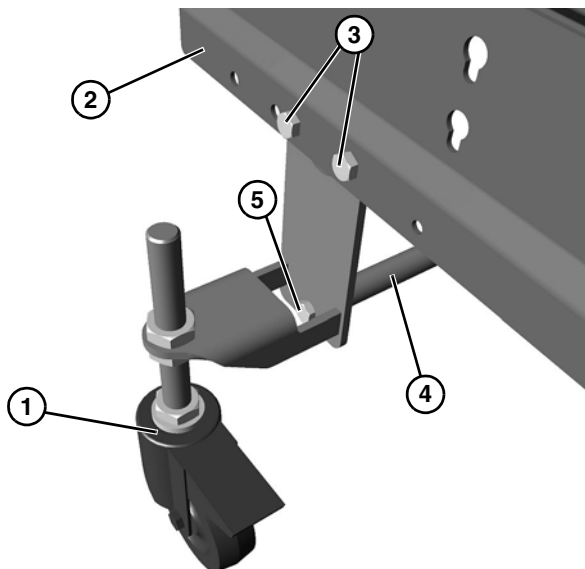
2. Attach the caster wheel stand (Figure 6, item 1) to the conveyor (Figure 6, item 2) and tighten the two bolts (Figure 6, item 3).



**Figure 6**

3. Repeat for opposite side.
4. Install brace (Figure 6, item 4) and secure with bolt (Figure 6, item 5) on each side.
5. Adjust the stand height. Refer to “Stand Height Adjustment” on page 10.

## Horizontal Mount Stand - Straight To Curve Section

1. Properly support the conveyor or place the conveyor upside down on a flat surface.

<b>⚠ WARNING</b>

<p><b>Failure to secure screws may cause conveyor sections to drop down causing severe injury.</b></p> <p><b>TIGHTEN SCREWS AFTER ADJUSTMENT.</b></p>

2. When attaching stand (Figure 7, item 1) to curved section on inside curve, make sure mounting hole on stand (Figure 7, item 2) is to the outside of curve section and head of bolt is on the inside of curve section.

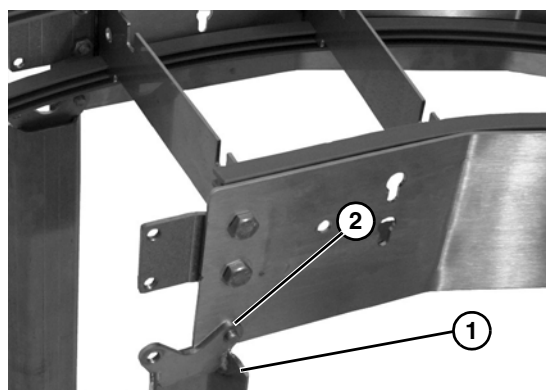

**Figure 7**

3. When attaching stand (Figure 8, item 1) to curved section on outside curve, make sure mounting hole on stand is to the inside of curve section and head of bolt is on the outside of curve section (Figure 8, item 2).

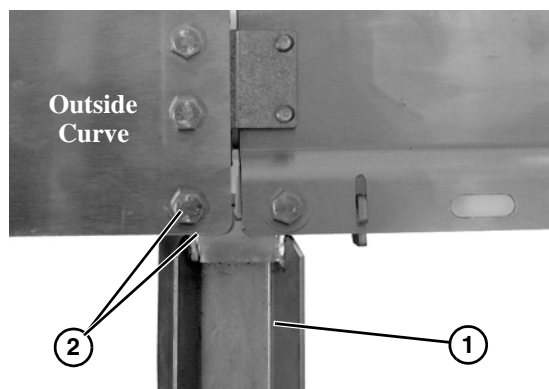

**Figure 8**

# Installation

4. Connect the straight section (**Figure 9, item 1**) making sure that the stand mounting hole (**Figure 9, item 2**) is to the inside of the straight section on both sides.

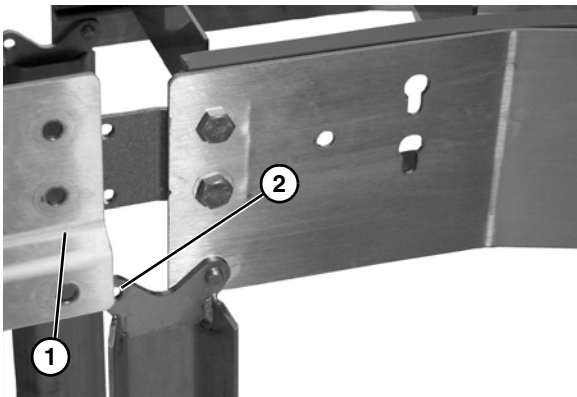

**Figure 9**

5. Tighten bolts on both sides of sections (**Figure 10, item 1**).

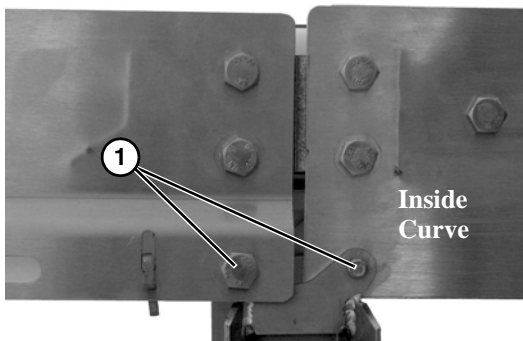

**Figure 10**

6. Repeat as needed for other stands.
7. Adjust the stand height. Refer to “Stand Height Adjustment” on page 10.

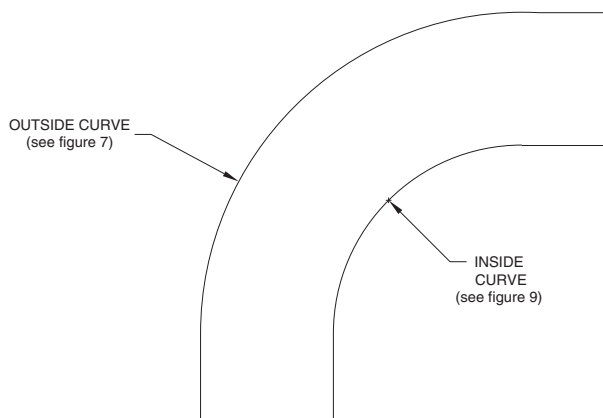

**Figure 11**

## Ceiling Supports

### Ceiling - Horizontal

1. Properly support the conveyor or place the conveyor upside down on a flat surface.

<b>⚠ WARNING</b>
<b>Failure to secure screws (Figure 12, item 3) may cause conveyor sections to drop down causing severe injury.</b>
<b>TIGHTEN SCREWS (Figure 12, item 3) AFTER ADJUSTMENT.</b>

2. Attach the horizontal ceiling support (**Figure 12, item 1**) to the conveyor (**Figure 12, item 2**) and tighten the two bolts (**Figure 12, item 3**).

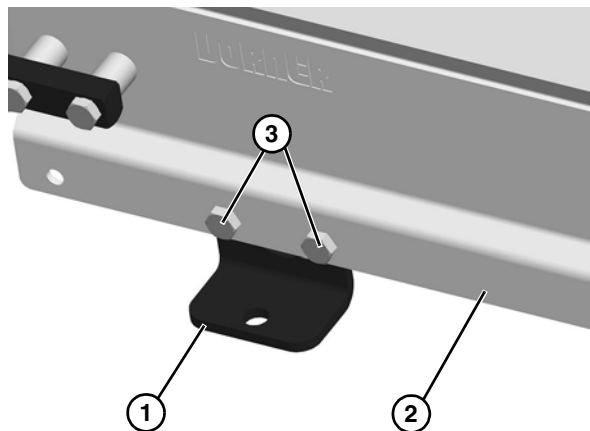

**Figure 12**

3. Repeat for other ceiling supports.

## Ceiling - Angle

1. Properly support the conveyor or place the conveyor upside down on a flat surface.

<b>⚠ WARNING</b>

<p><b>Failure to secure screws (Figure 13, item 3) may cause conveyor sections to drop down causing severe injury.</b></p> <p><b>TIGHTEN SCREWS (Figure 13, item 3) AFTER ADJUSTMENT.</b></p>

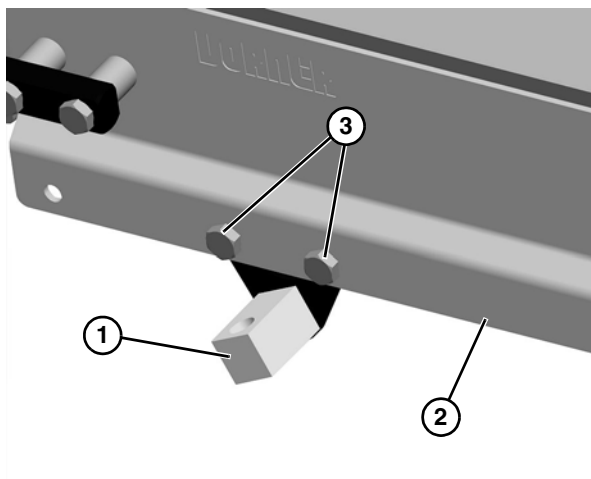
2. Attach the angle ceiling support (Figure 13, item 1) to the conveyor (Figure 13, item 2) and tighten the two bolts (Figure 13, item 3).

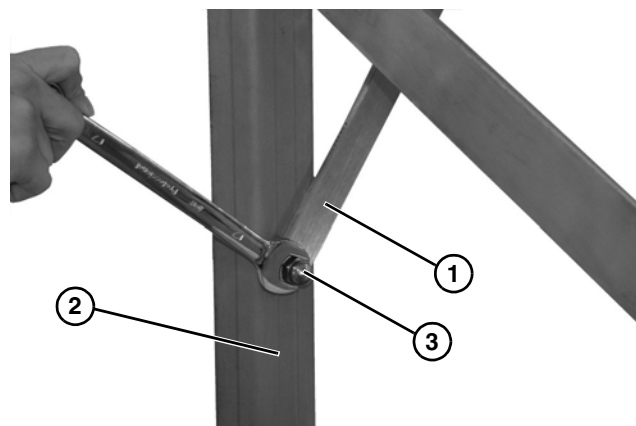

**Figure 13**

3. Repeat for other ceiling supports.

## Diagonal Brace Attachment

1. Install the end of brace with non-threaded hole (Figure 14, item 1) onto the inside of the stand (Figure 14, item 2).



**Figure 14**

2. Secure the brace with a hex head bolt and nut (Figure 14, item 3).
3. Attach the end of brace with threaded hole (Figure 15, item 1) to the conveyor with hex head bolt (Figure 15, item 2).

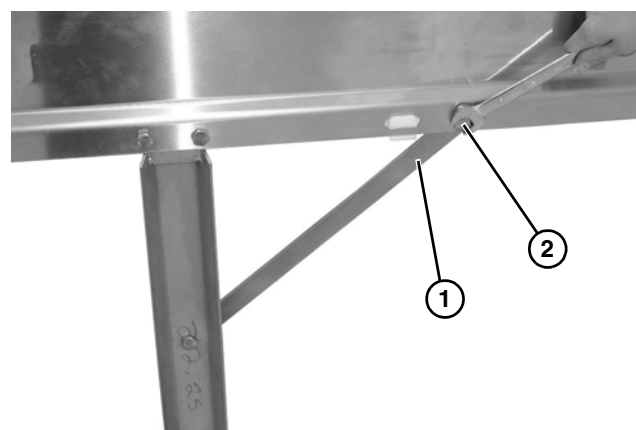

**Figure 15**

4. Repeat steps 1 through 3 for opposite leg.
5. Tighten all hardware.

# Preventive Maintenance and Adjustment

## Stand Height Adjustment

### Required Tools

- Level
- 17 mm wrench
- 24 mm wrench
- 30 mm wrench

### Stands With Feet

#### ⚠ WARNING



#### SEVERE HAZARD!

**LOCK OUT POWER** before removing guards or performing maintenance. Exposed moving parts can cause serious injury.

1. Adjust stand height:

- For a tall stand, loosen the nut (**Figure 16, item 1**) on the foot stem (**Figure 16, item 2**). Rotate foot stem to raise or lower the stand (**Figure 16, item 3**) to desired height.

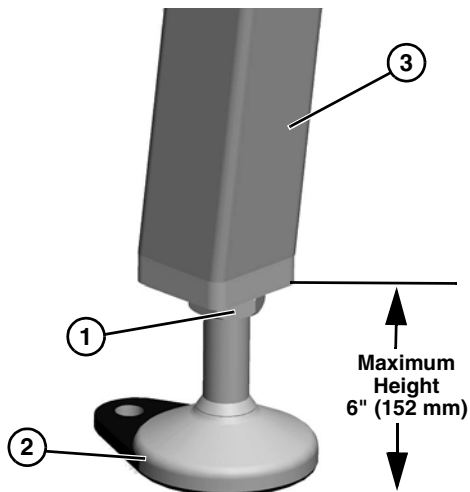

**Figure 16**

- For a short stand, loosen the upper nut (**Figure 17, item 1**) on the foot stem (**Figure 17, item 2**). Rotate the lower nut (**Figure 17, item 3**) up or down to raise or lower the stand to the desired height.

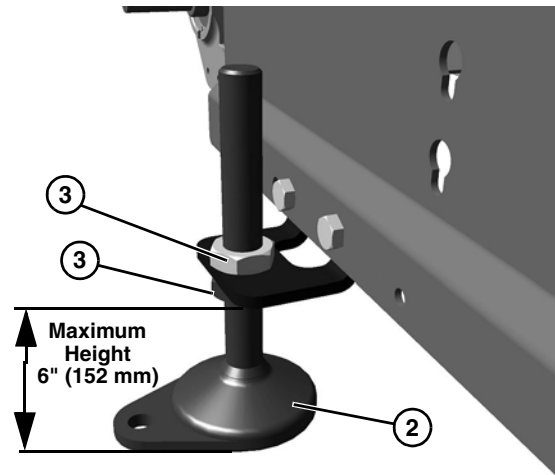

**Figure 17**

#### ⚠ WARNING



#### SEVERE HAZARD!

**DO NOT EXCEED THE MAXIMUM HEIGHT OF 6" (152 mm) from the floor to the bottom of the stand.**

**Exceeding the maximum height will allow parts to separate and may cause serious injury.**

2. Repeat steps on the opposite stand leg.
3. Use a level (**Figure 18, item 1**) to verify that both stand legs are the same height.

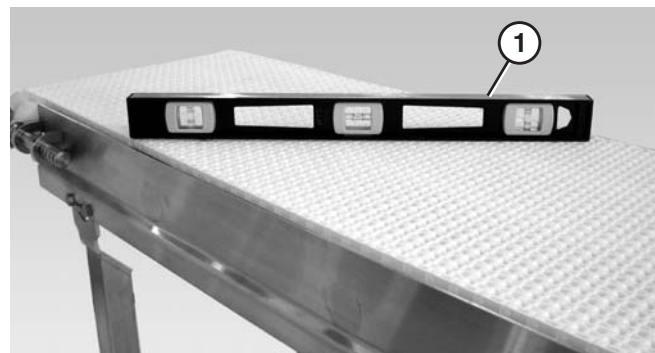

**Figure 18**

4. Tighten the upper nut (**Figure 17, item 3**) or (**Figure 16, item 1**) on the foot stem to secure each foot assembly.

# Preventive Maintenance and Adjustment

## Stands With Casters

<b>⚠ WARNING</b>

<b>SEVERE HAZARD!</b> <b>LOCK OUT POWER</b> before removing guards or performing maintenance. Exposed moving parts can cause serious injury.

1. Loosen the upper nut (**Figure 19, item 1**) on the caster stem (**Figure 19, item 2**).

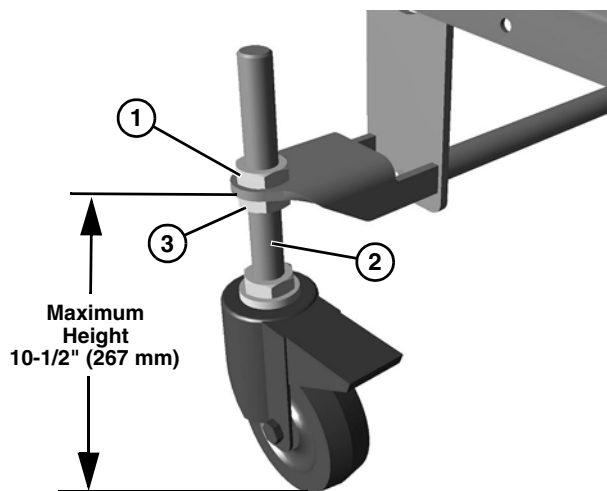

**Figure 19**

<b>⚠ WARNING</b>

<b>SEVERE HAZARD!</b> <b>DO NOT EXCEED THE MAXIMUM HEIGHT OF 10-1/2" (267 mm) from the floor to the bottom of the stand.</b> <b>Exceeding the maximum height will allow parts to separate and may cause serious injury.</b>

2. Rotate the lower nut up or down (**Figure 19, item 3**) to raise or lower the stand to the desired height.
3. Repeat steps 1 and 2 on the opposite stand leg.

4. Use a level (**Figure 20, item 1**) to verify that both stand legs are the same height.

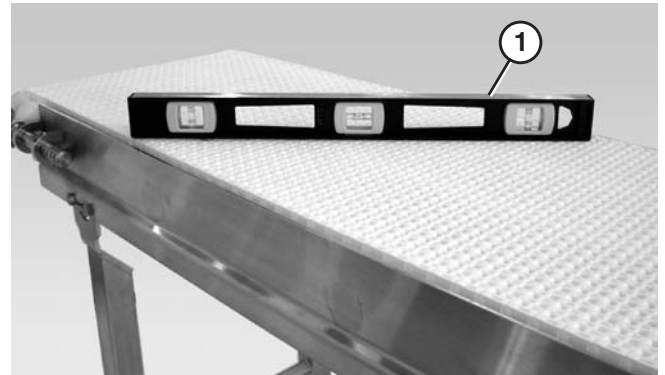

**Figure 20**

5. Tighten the upper nut (**Figure 19, item 1**) on the caster stem (**Figure 19, item 2**) to secure each foot assembly.

---

# Notes

---

NOTE

For replacement parts other than those shown in this section, contact an authorized Dorner Service Center or the factory. Key Service Parts and Kits are identified by the Performance Parts Kits logo . Dorner recommends keeping these parts on hand.

Tall Support Stands

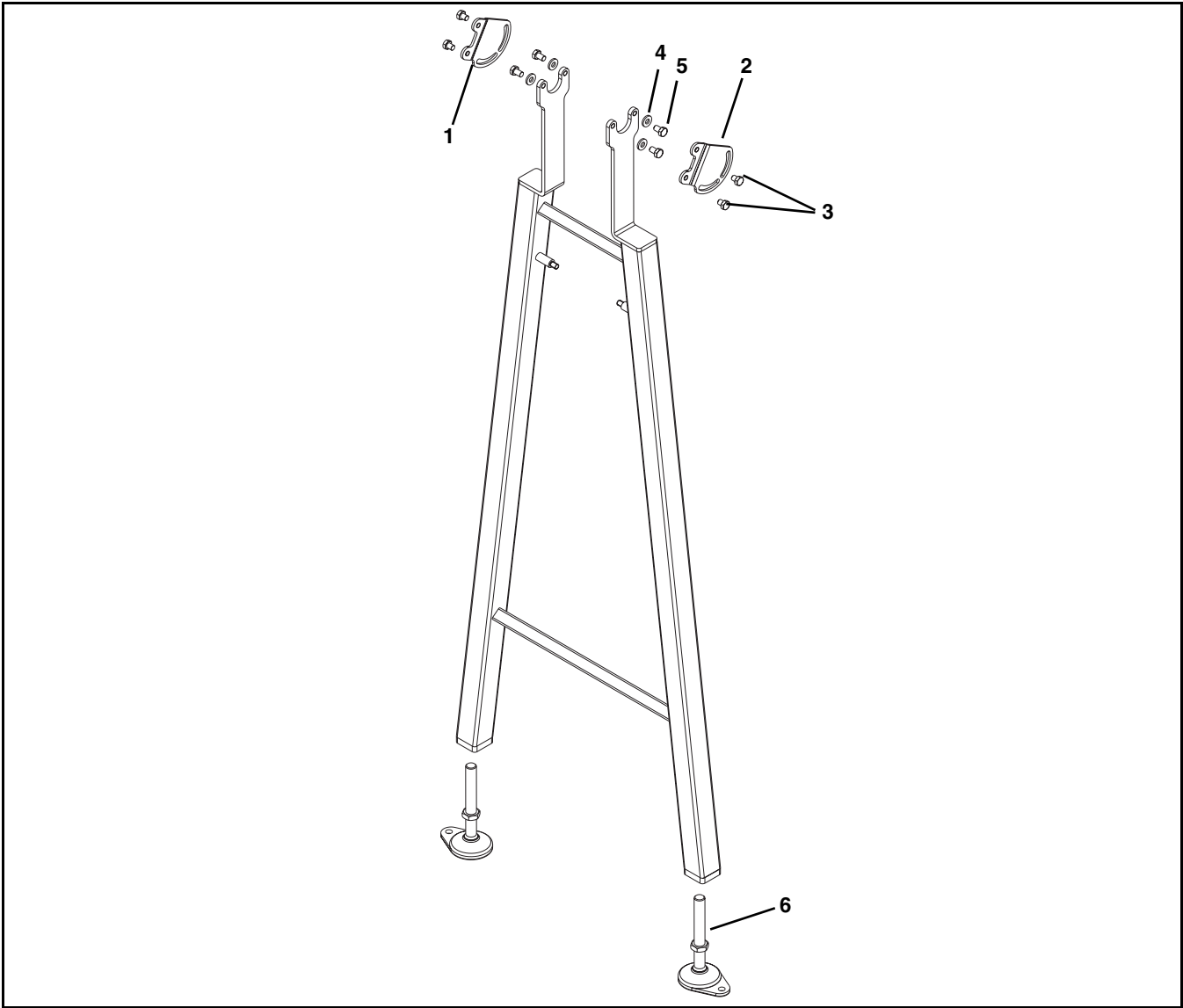

Item	Part Number	Description
1	532213	Pivot Plate Right Hand for 7350, 7360, 7400 & 7600 Series (for angled conveyors)
	532282	Pivot Plate Right Hand for 7400 & 7600 Ultimate Series (for angled conveyors)
2	532212	Pivot Plate Left Hand for 7350, 7360, 7400 & 7600 Series (for angled conveyors)
	532283S	Pivot Plate Left Hand for 7400 & 7600 Ultimate Series (for angled conveyors)
3	961012MSS	Hex Head Cap Screw, M10-1.5 x 12 mm
4	807-1821	Washer

Item	Part Number	Description
5	961016MSS	Hex Head Cap Screw M10-1.50 x 16 mm (for angled conveyors)
	961012MSS	Hex Head Cap Screw M10-1.50 x 12 mm (for horizontal conveyors)
6	807-1321	Foot Pad Assembly for 7350, 7360, 7400 & 7600 Series
	807-1608	Foot Pad Assembly for 7400 & 7600 Ultimate Series

# Service Parts

## Low Height Support Stands with Foot Pads

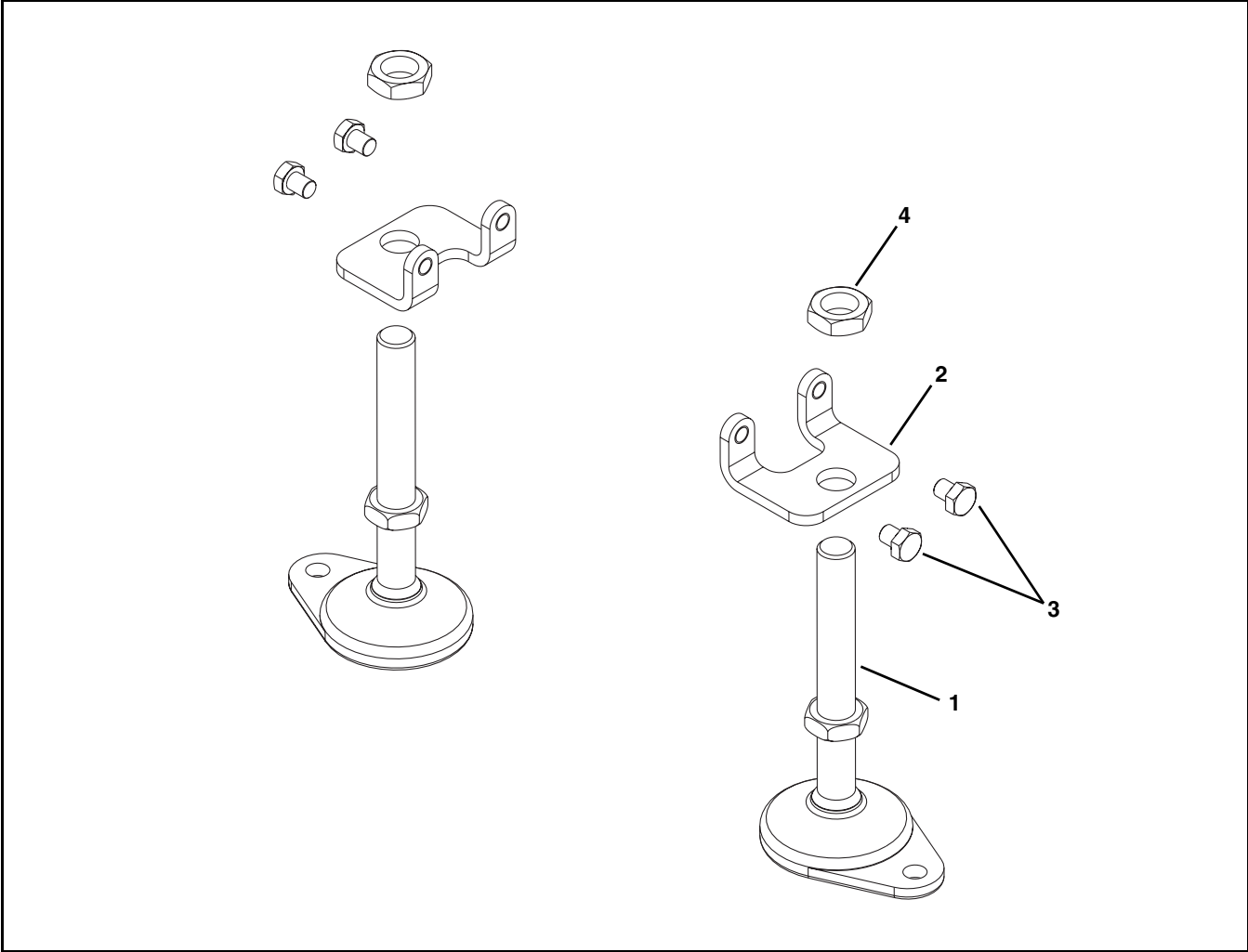

Item	Part Number	Description
1	807-1321	Foot Pad Assembly
2	532341	Bracket for 7350, 7360, 7400 & 7600 Series
	532342	Bracket for 7400 & 7600 Ultimate Series
3	961012MSS	Hex Head Cap Screw, M10-1.5 x 20 mm
4	992010MSS	Hex Jam Nut

## Low Height Support Stands with Casters

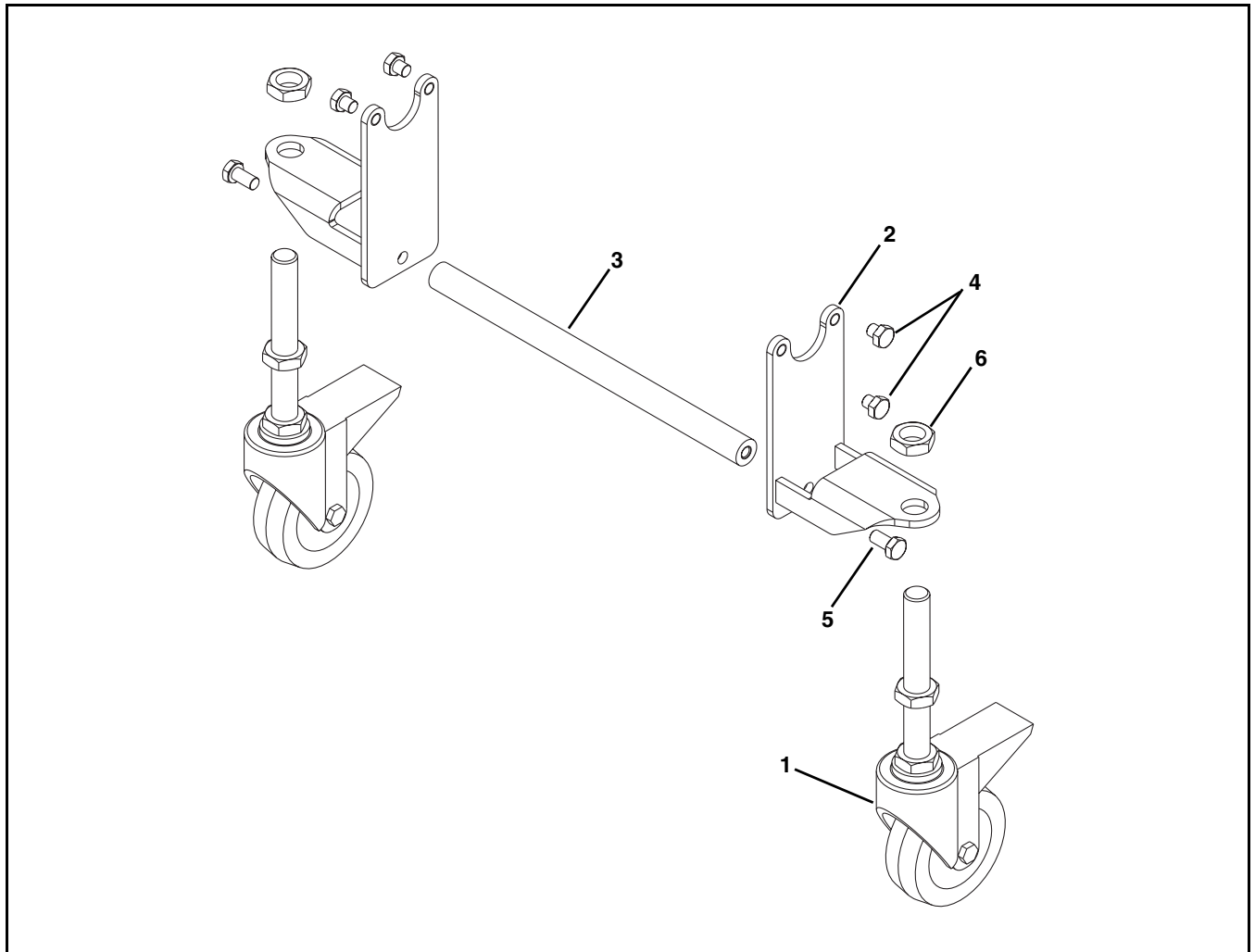

Item	Part Number	Description
1	458309	Caster Assembly
2	532073-LHUHC	Bracket for 7350, 7360, 7400 & 7600 Series
	532074-LHUHC	Bracket for 7400 & 7600 Ultimate Series
3	532339-WW	Cross Shaft for 7360, 7400 & 7600 Series
	532343-WW	Cross Shaft for 7350 Straight Conveyors
	532344-WW	Cross Shaft for 7350 Curve Conveyors
	532345-WW	Cross Shaft for 7400 & 7600 Ultimate Series
4	961010MSS	Hex Head Cap Screw, M10-1.50 x 10 mm
5	961020MSS	Hex Head Cap Screw, M10-1.50 x 20 mm
6	992001MSS	Hex Jam Nut
LHUH = Lower height and upper height from support stand part number. Example: 39XMLHWW-LHUHC		
WW = Stand width ref: 04 - 60 in 02 increments		

# Service Parts

## Ceiling Supports - Horizontal Mount

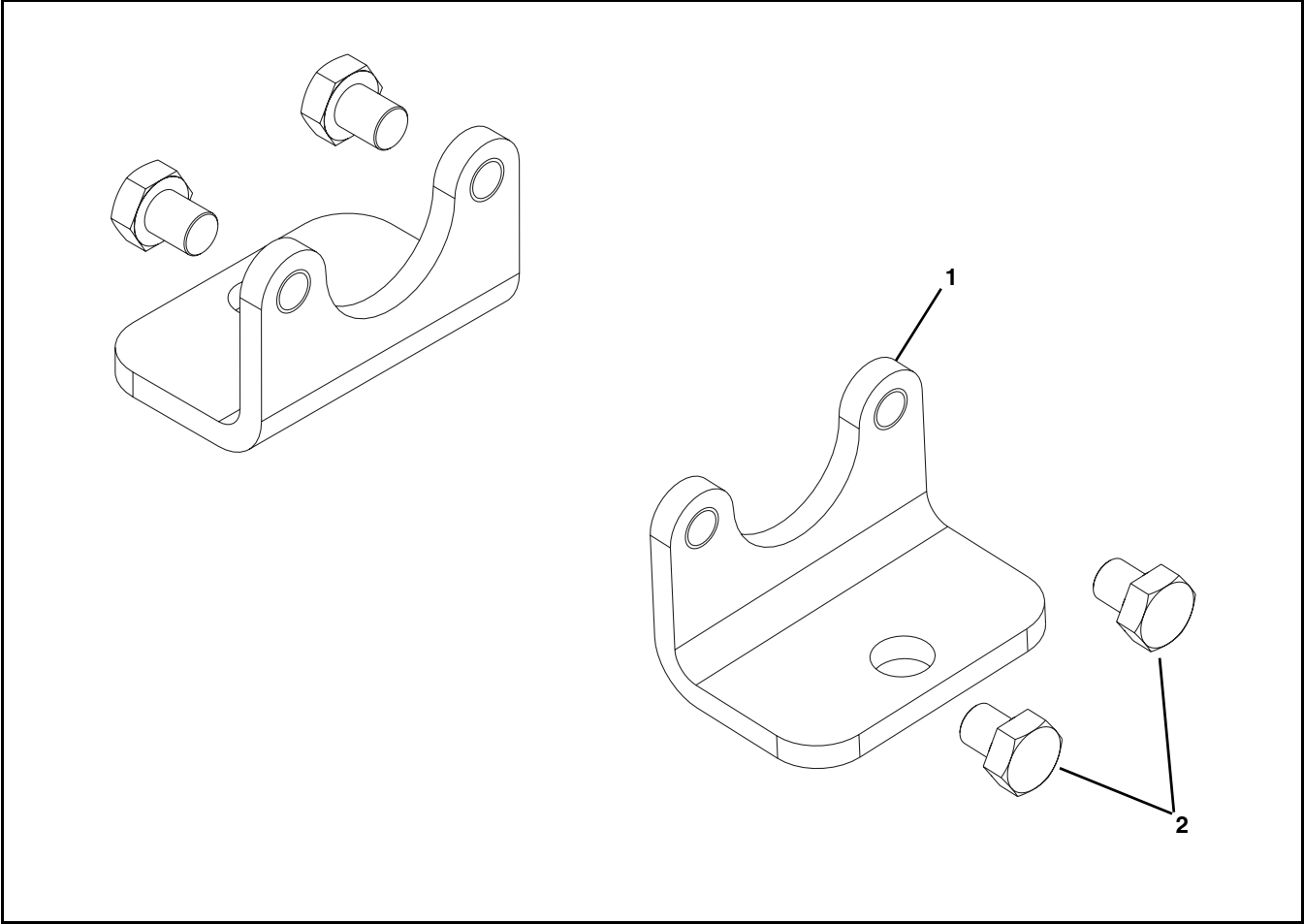

Item	Part Number	Description
1	532327	Ceiling Mount Plate for 7350, 7360, 7400 & 7600 Series
	532328	Ceiling Mount Plate for 7400 & 7600 Ultimate Series
2	961012MSS	Hex Head Cap Screw M10-1.50 x 12 mm for 7350, 7360, 7400 & 7600 Series
	961020MSS	Hex Head Cap Screw M10-1.50 x 20 mm for 7400 & 7600 Ultimate Series

## Ceiling Supports - Angle Mount

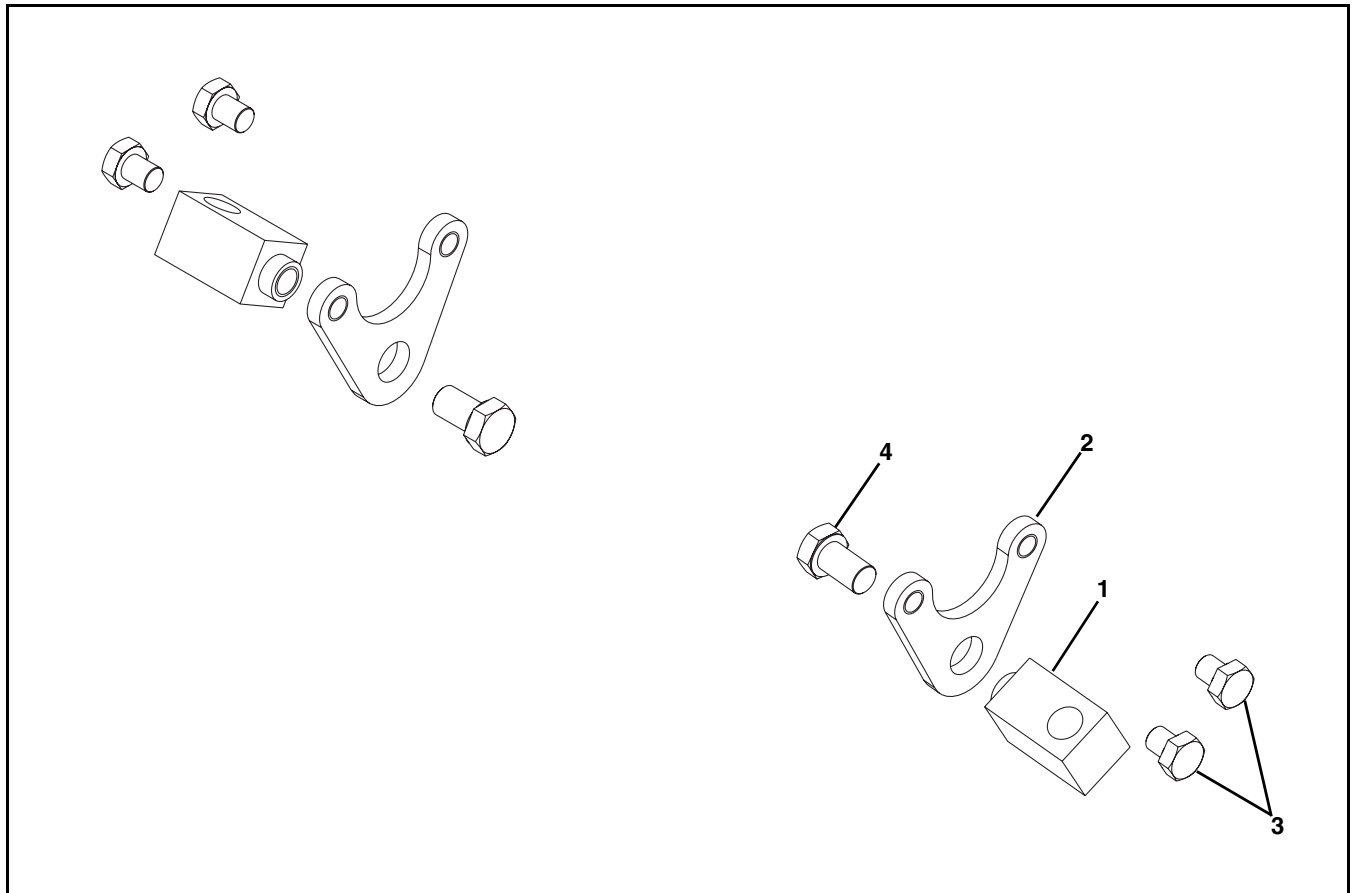

Item	Part Number	Description
1	532324	Ceiling Mount Block
2	532325	Ceiling Mount Plate for 7350, 7360, 7400 & 7600 Series
	532326	Ceiling Mount Plate for 7400 & 7600 Ultimate Series
3	961012MSS	Hex Head Cap Screw, M10-1.50 x 12 mm for 7350, 7360, 7400 & 7600 Series
	961020MSS	Hex Head Cap Screw, M10-1.50 x 20 mm for 7400 & 7600 Ultimate Series
4	961220MSS	Hex Head Cap Screw, M12-1.75 x 20 mm

# Return Policy

Returns must have prior written factory authorization or they will not be accepted. Items that are returned to Dorner without authorization will not be credited nor returned to the original sender. When calling for authorization, please have the following information ready for the Dorner factory representative or your local distributor:

1. Name and address of customer.
2. Dorner part number(s) of item(s) being returned.
3. Reason for return.
4. Customer's original order number used when ordering the item(s).
5. Dorner or distributor invoice number (if available, part serial number).

A representative will discuss action to be taken on the returned items and provide a Returned Goods Authorization (RMA) number for reference. RMA will automatically close 30 days after being issued. To get credit, items must be new and undamaged. There will be a return charge on all items returned for credit, where Dorner was not at fault. It is the customer's responsibility to prevent damage during return shipping. Damaged or modified items will not be accepted. The customer is responsible for return freight.

## Conveyors and conveyor accessories

Standard catalog conveyors	30%
MPB, 7200, 7300 Series, cleated and specialty belt	50%
AquaGard & AquaPruf Series conveyors	non-returnable items
Engineered special products	case by case
Drives and accessories	30%
Sanitary stand supports	non-returnable items

## Parts

Standard stock parts	30%
Plastic chain, cleated and specialty belts	non-returnable items

Returns will not be accepted after 60 days from original invoice date. The return charge covers inspection, cleaning, disassembly, disposal and reissuing of components to inventory. If a replacement is needed prior to evaluation of returned item, a purchase order must be issued. Credit (if any) is issued only after return and evaluation is complete.

Dorner has representatives throughout the world. Contact Dorner for the name of your local representative. Our Customer Service Teams will gladly help with your questions on Dorner products.

For a copy of Dorner's Warranty, contact factory, distributor, service center or visit our website at [www.dorner.com](http://www.dorner.com).

For replacement parts, contact an authorized Dorner Service Center or the factory.



Dorner Mfg. Corp. reserves the right to change or discontinue products without notice. All products and services are covered in accordance with our standard warranty. All rights reserved. © Dorner Mfg. Corp. 2009

## DORNER MFG. CORP.

975 Cottonwood Ave., PO Box 20  
Hartland, WI 53029-0020 USA  
TEL 1-800-397-8664 (USA)  
FAX 1-800-369-2440 (USA)  
Internet: [www.dorner.com](http://www.dorner.com)

Outside the USA:  
TEL 1-262-367-7600  
FAX 1-262-367-5827