

Using Cantilever

Cantilever mount assemblies are designed to allow for quick belt removal without stand removal.

1. Loosen screw (**Figure 1, item 1**) and rotate pivot plate (**Figure 1, item 2**).

NOTE

*The pivot plate (**Figure 1, item 2**) must be on the opposite side of conveyor as the gearmotor mounting package (**Figure 1, item 3**).*

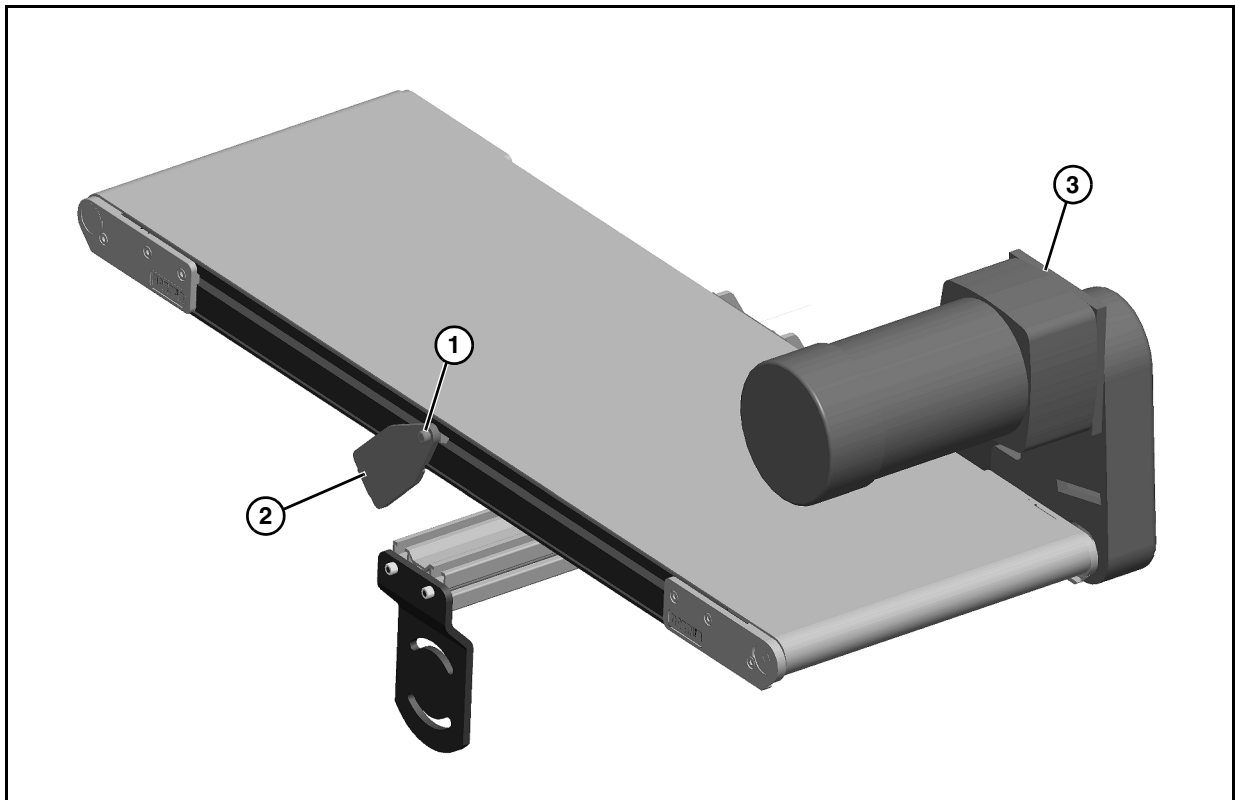
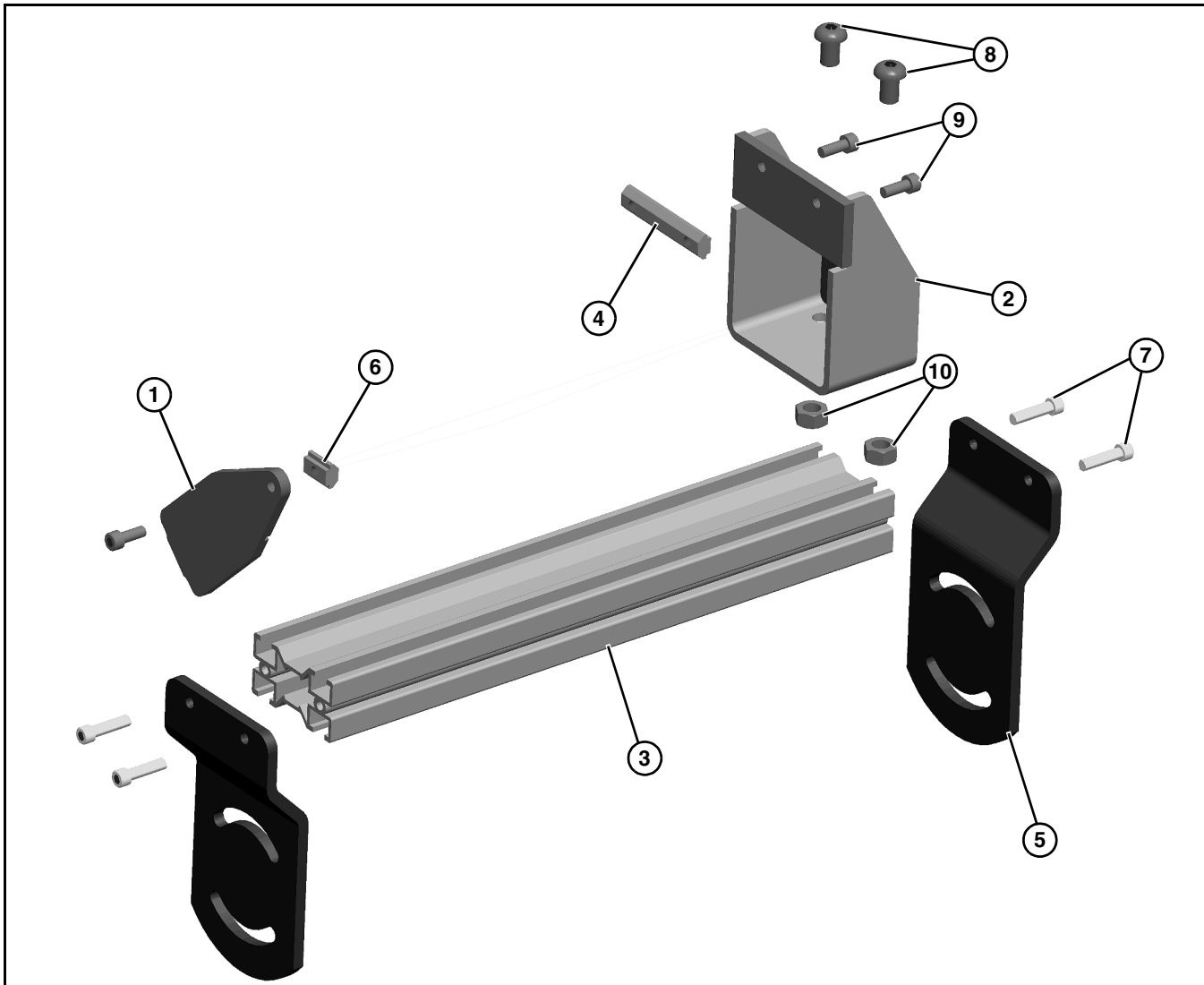

Figure 1

Service Parts



Item	Part Number	Description
1	201762	Pivot Plate (For Conveyors Over 6" Wide Only)
2	201872	Bracket
3	710210- <u>LLLLL</u>	Extrusion
4	300150M	Drop-In T Bar
5	300825M	Pivot Bracket (For Stand Top Only)
6	639971	Single Drop-In T Bar (For Conveyors Over 6" Wide Only)
7	708180P	Socket Head Screw, M6-1.00 x 25 mm (For Stand Top Only)
8	911016M	Socket Head Screw, M10-1.50 x 16 mm
9	920616M	Socket Head Screw, M6-1.0 x 16 mm
10	991001M	Hex Nut
<u>LLLLL</u> = Length in inches with 2 decimal places		
Length Example: Extrusion Length = 45.25" <u>LLLLL</u> = 04525		

DORNER®

Dorner Mfg. Corp. reserves the right to change or discontinue products without notice. All products and services are covered in accordance with our standard warranty. All rights reserved. © Dorner Mfg. Corp. 2011

DORNER MFG. CORP.

975 Cottonwood Ave., PO Box 20
Hartland, WI 53029-0020 USA
TEL 1-800-397-8664 (USA)
FAX 1-800-369-2440 (USA)
Internet: www.dorner.com

Outside the USA:
TEL 1-262-367-7600
FAX 1-262-367-5827