



# 7400 Ultimate Series Nose Bar Conveyors

## Installation, Maintenance and Parts Manual



DORNER MFG. CORP.  
P.O. Box 20 • 975 Cottonwood Ave.  
Hartland, WI 53029-0020 USA

INSIDE THE USA  
TEL: 1-800-397-8664  
FAX: 1-800-369-2440

OUTSIDE THE USA  
TEL: 262-367-7600  
FAX: 262-367-5827

For other service manuals visit our website at:  
[www.dorner.com/service\\_manuals.asp](http://www.dorner.com/service_manuals.asp)

# Table of Contents

|   |    |   |    |
|---|----|---|----|
| Introduction .....                          | 2  | Conveyor Belt Replacement.....            | 17 |
| Warnings – General Safety.....              | 3  | Conveyors with Guides.....                | 17 |
| Product Description .....                   | 4  | Standard Belts .....                      | 17 |
| Specifications .....                        | 4  | Replacing a Section of Belt.....          | 17 |
| Flat Belt 7400 Series Conveyor .....        | 4  | Replacing the Entire Belt .....           | 18 |
| Flat Belt 7400 Series LPZ Conveyor .....    | 4  | Specialty Intralox 1100 Series Belts..... | 18 |
| Conveyor Supports .....                     | 5  | Replacing a Section of Belt.....          | 18 |
| Specifications.....                         | 5  | Replacing the Entire Belt .....           | 19 |
| Installation.....                           | 6  | Conveyor Belt Tensioning.....             | 19 |
| Required Tools.....                         | 6  | Sprocket and Puck Removal.....            | 19 |
| Recommended Installation Sequence .....     | 6  | A - Drive Sprocket Removal .....          | 20 |
| Conveyors Longer than 10 ft (3048 mm) ..... | 6  | B - Nose Bar Puck Removal.....            | 22 |
| LPZ Conveyors .....                         | 7  | C - Idler Puck Removal .....              | 22 |
| Knuckles.....                               | 7  | Reassembling Tail Assembly .....          | 23 |
| Belt .....                                  | 7  | Nose Bar Drive Tail .....                 | 23 |
| Guides.....                                 | 8  | Nose Bar Assembly .....                   | 23 |
| All Conveyors .....                         | 8  | Drive Tail Assembly .....                 | 23 |
| Stand Installation.....                     | 8  | Nose Bar Idler and Tip Up Tail .....      | 24 |
| Tail Assembly Installation .....            | 9  | Idler Tail and Tip Up Tail.....           | 24 |
| Nose Bar Drive Tail.....                    | 9  | Bearing Replacement .....                 | 25 |
| Nose Bar Tip Up Tail .....                  | 9  | LPZ Knuckles.....                         | 25 |
| Tip Up Idler Tail.....                      | 10 | Wearstrips and Belt Returns .....         | 25 |
| Lifter Installation.....                    | 11 | Service Parts.....                        | 26 |
| Wear Strip Installation .....               | 12 | Nose Bar Drive End Components .....       | 26 |
| Belt Installation .....                     | 12 | Nose Bar Tip Up Tension End .....         | 28 |
| Belt Return Installation .....              | 13 | Tip Up Tension End .....                  | 29 |
| Preventive Maintenance and Adjustment.....  | 15 | Upper Knuckle for 5° - 15° .....          | 30 |
| Required Tools.....                         | 15 | Upper Knuckle for 30° .....               | 31 |
| Checklist .....                             | 15 | Lower Knuckle for 5° - 15° .....          | 32 |
| Cleaning .....                              | 15 | Lower Knuckle for 30° .....               | 33 |
| Routine Cleaning.....                       | 15 | Conveyor Frame and Extension .....        | 34 |
| Standard Conveyors.....                     | 15 | 3" (76 mm) High Sides.....                | 35 |
| Conveyors with Lifters .....                | 16 | Flat Belt Returns.....                    | 36 |
| Periodic Cleaning .....                     | 16 | Flat Belt Chain Repair Kit.....           | 36 |
| Lubrication.....                            | 16 | Belt Removal Tool .....                   | 36 |
| Conveyor Bearings.....                      | 16 | Ordering a Replacement Chain .....        | 36 |
| Wearstrips and Belt Returns .....           | 16 | Configuring a Conveyor Part Number .....  | 37 |
| Maintaining the Conveyor Belt.....          | 16 | Return Policy.....                        | 38 |
| Troubleshooting .....                       | 16 |   |    |

## Introduction



### CAUTION

Some illustrations may show guards removed. DO NOT operate equipment without guards.

Upon receipt of shipment:

- Compare shipment with packing slip. Contact factory regarding discrepancies.
- Inspect packages for shipping damage. Contact carrier regarding damage. Accessories may be shipped loose.
- See accessory instructions for installation.

The Dorner Limited Warranty applies.

Dorner 7400 Series conveyors have patents pending.

### NOTE

*Proper conveyor application, cleaning, and sanitation are the responsibility of the end user.*

Dorner reserves the right to make changes at any time without notice or obligation.

Dorner has convenient, pre-configured kits of Key Service Parts for all conveyor products. These time saving kits are easy to order, designed for fast installation, and guarantee you will have what you need when you need it. Key Parts and Kits are marked in the Service Parts section of this manual with the Performance Parts Kits logo .

Intralox is a registered trademark of Laitram L.L.C. in the United States and / or other countries.

## Warnings – General Safety

### **DANGER**



#### **SEVERE HAZARD!**

**KEEP OFF CONVEYORS.** Climbing, sitting, walking or riding on conveyor will result in death or serious injury.

### **DANGER**



#### **EXPLOSION HAZARD!**

- **DO NOT OPERATE CONVEYORS IN AN EXPLOSIVE ENVIRONMENT.** The electric gearmotor generates heat and could ignite combustible vapors.
- Failure to comply will result in death or serious injury.

### **WARNING**



#### **CRUSH HAZARD!**

- **DO NOT** place hands or fingers inside the conveyor while it is running.
- **DO NOT** wear loose garments while operating the conveyor. Loose garments can become caught up in the conveyor.
- Failure to comply could result in serious injury.

### **WARNING**



#### **CRUSH HAZARD!**

- **SUPPORT CONVEYOR SECTIONS PRIOR TO LOOSENING STAND HEIGHT OR ANGLE ADJUSTMENT SCREWS.**
- Loosening stand height or angle adjustment screws may cause conveyor sections to drop down, causing serious injury.

### **WARNING**



#### **SEVERE HAZARD!**

**LOCK OUT POWER** before removing guards or performing maintenance. Exposed moving parts can cause serious injury.

### **WARNING**



#### **BURN HAZARD!**

**DO NOT TOUCH** the motor while operating, or shortly after being turned off. Motors may be **HOT** and can cause serious burn injuries.

### **WARNING**



#### **PUNCTURE HAZARD!**

Handle drive shaft keyway with care. It may be sharp and could puncture the skin, causing serious injury.

### **WARNING**



#### **SEVERE HAZARD!**

- Dorner cannot control the physical installation and application of conveyors. Taking protective measures is the responsibility of the user.
- When conveyors are used in conjunction with other equipment or as part of a multiple conveyor system, **CHECK FOR POTENTIAL PINCH POINTS** and other mechanical hazards before system start-up.
- Failure to comply could result in serious injury.

# Product Description

Refer to (Figure 1) for typical conveyor components.

| Typical Components |                  |
|--------------------|------------------|
| 1                  | Conveyor         |
| 2                  | Gearmotor        |
| 3                  | Belt             |
| 4                  | Return           |
| 5                  | Support Stands   |
| 6                  | Motor Controller |
| 7                  | Drive End        |
| 8                  | Tension End      |

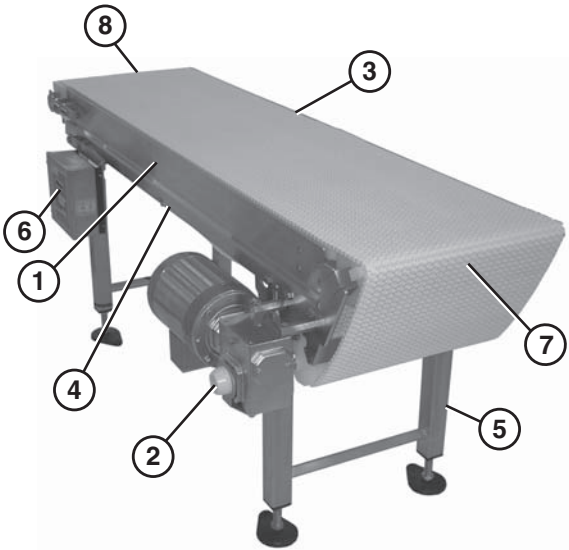
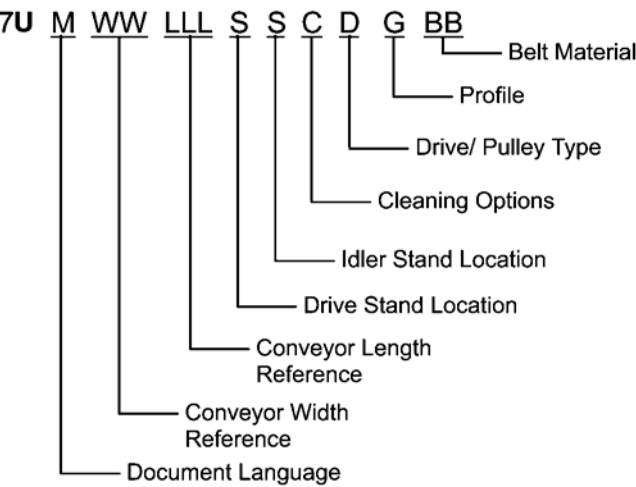

Figure 1

# Specifications

## Flat Belt 7400 Series Conveyor



## Flat Belt 7400 Series LPZ Conveyor

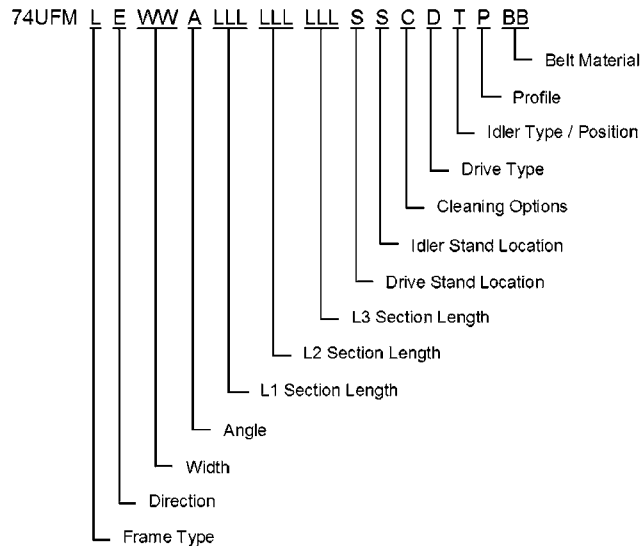

## Conveyor Supports

### Maximum Distances:

1 = 3 ft (914 mm)

2 = 8 ft (2438 mm)\*\*

3 = 3 ft (914 mm)

\*\* For conveyors longer than 10 ft (3.05 m), install support at frame joint.

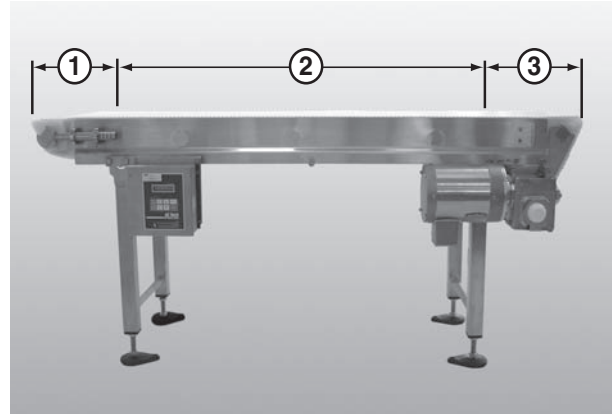

Figure 2

## Specifications

|  |   |
|--|---|
| Conveyor Width Reference ( <u>WW</u> ) | 06 – 36 in 02 increments  |
| Conveyor Belt Width                    | 6" (152 mm) – 36" (914 mm) in 2" (51 mm) increments   |
| Maximum Conveyor Load                  | 20 lb / ft <sup>2</sup> (97 kg / m <sup>2</sup> ) with a maximum of 1000 lb / ft <sup>2</sup> (4882 kg / m <sup>2</sup> ) |
| Belt Travel                            | 12" (305 mm) per revolution of pulley   |
| Maximum Belt Speed                     | 233 ft / minute (71 m / minute)   |
| Belt Take-up                           | 2" (51 mm)  |

|  |  |
|--|--|
| Conveyor Length Reference ( <u>LLL</u> ) | 036 – 999 in 001 increments                            |
| Conveyor Length                          | 36" (914 mm) – 999" (25.4 m) in 1" (25 mm) increments  |
| LPZ Section Lengths ( <u>LLL</u> )       | 024 – 252 in 001 increments                            |
| LPZ Section Length                       | 24" (610 mm) – 252" (6401 mm) in 1" (25 mm) increments |
| Total LPZ Conveyor Length                | (L1 + L2 + L3) = Maximum 38' (11.6 m) long conveyor    |

### IMPORTANT

Maximum conveyor loads are based on:

- Non-accumulating product
- Product moving toward gearmotor
- Conveyor being mounted horizontally
- Conveyor being located in a dry environment
- Conveyor equipped with standard belt only

# Installation

## ⚠ CAUTION

Dorner recommends cleaning all the “food zones” prior to placing conveyor into service. Ensure adequate access is provided for cleaning and servicing equipment so that the required level of hygiene can be maintained.

## NOTE

*Proper conveyor application, cleaning, and sanitation are the responsibility of the end user.*

## ⚠ CAUTION

Conveyor **MUST** be mounted straight, flat, and level within confines of conveyor. Use a level (Figure 3, item 1), during setup.

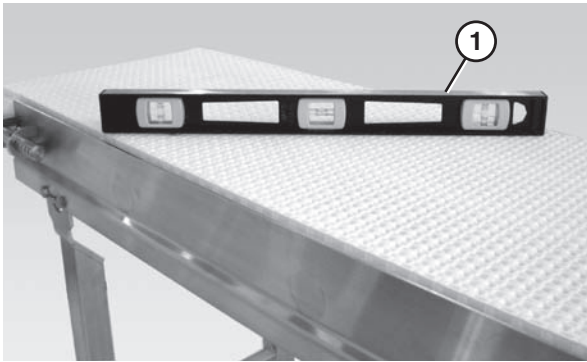

Figure 3

## Required Tools

- 17 mm wrench (for hexagonal head fasteners)
- 4 mm hex wrench (for bearing shaft assembly fasteners)
- Level
- Torque wrench

## Recommended Installation Sequence

1. Attach the stands to the conveyor. Refer to “Stand Installation” on page 8.
2. Attach the tail assemblies to the frame. Refer to “Tail Assembly Installation” on page 9.
3. Attach the lifters, if applicable. Refer to “Lifter Installation” on page 11.
4. Install the gearmotor, if applicable. Refer to the “7400 Series Drive Package Installation, Maintenance and Parts Manual.”
5. Attach the wearstrips. Refer to “Wear Strip Installation” on page 12.
6. Install the belt. Refer to “Belt Installation” on page 12.
7. Attach the belt returns. Refer to “Belt Return Installation” on page 13.
8. Attach any guides / accessories. Refer to the “Service Parts” section starting on page 26.

## Conveyors Longer than 10 ft (3048 mm)

Typical Connection Components (Figure 4)

- |   |                                       |
|---|---------------------------------------|
| 1 | M10 x 1.5 mm hex head cap screws (x4) |
| 2 | Connector hex rods (x2)               |
| 3 | Conveyor frames                       |
| 4 | O-rings (x8)                          |

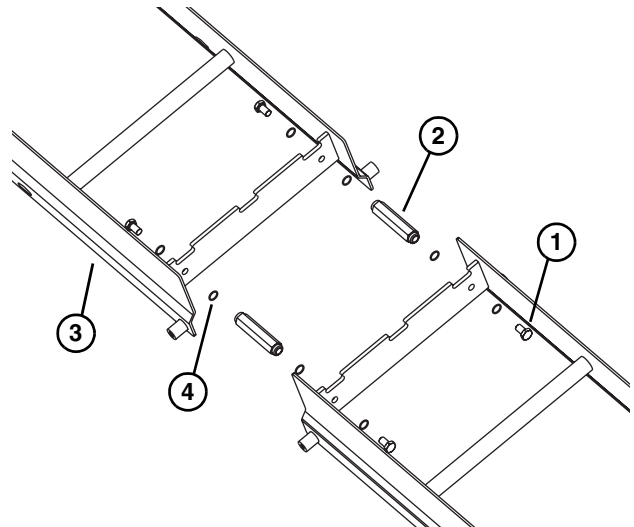
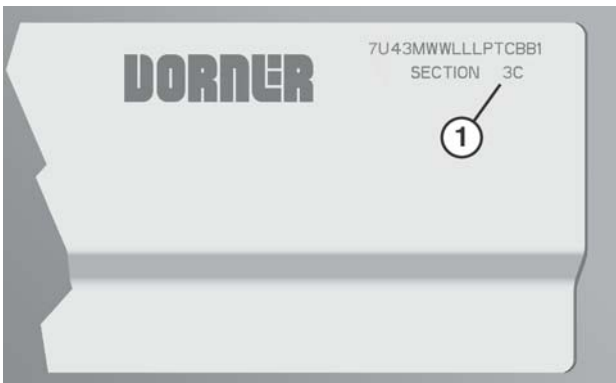

Figure 4



1. Locate the section number sequence etched on each section of frame (**Figure 5, item 1**)



**Figure 5**

2. Position the frame sections in the correct order.
3. Connect the frame sections by bolting the hex post connectors (**Figure 6, item 1**) the sections of frame.

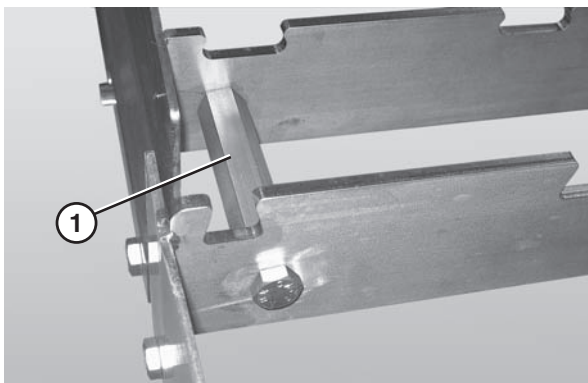
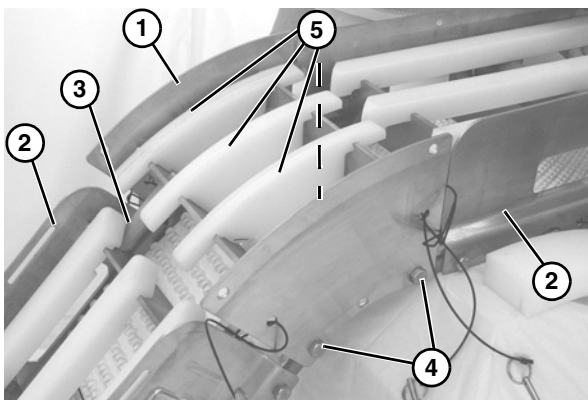

**Figure 6**

## LPZ Conveyors

### Knuckles

1. Attach upper knuckle (**Figure 7, item 1**) to frame (**Figure 7, item 2**) with hex rods (**Figure 7, item 3**) and bolts (**Figure 7, item 4**).



**Figure 7**

2. Install wear strips (**Figure 7, item 5**).
3. Attach lower knuckle (**Figure 8, item 1**) to frame (**Figure 8, item 2**) with hex rods (**Figure 8, item 3**) and bolts (**Figure 8, item 4**).

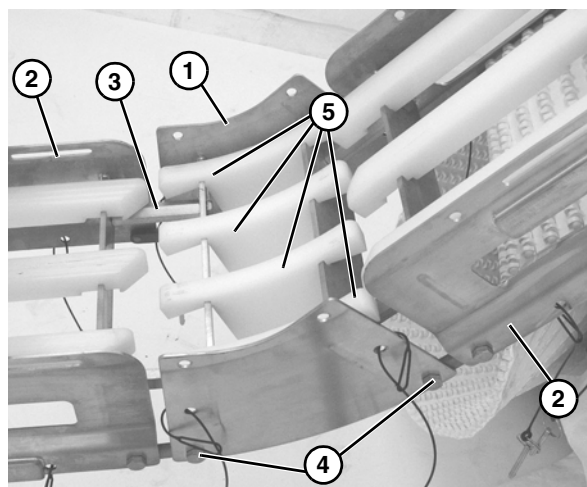

**Figure 8**

4. Install wear strips (**Figure 8, item 5**).

### Belt

1. Slide belt (**Figure 9, item 1**) over knuckles on top of the wear strips.

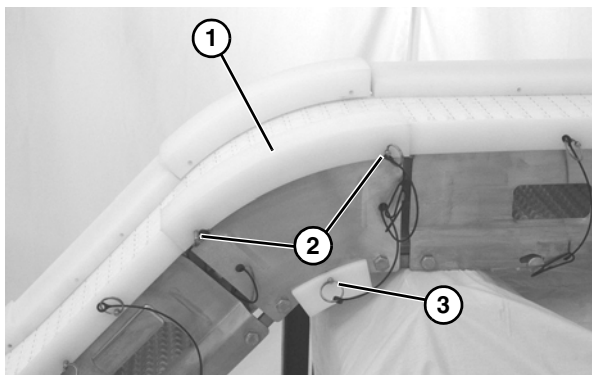

**Figure 9**

# Installation

## Guides

1. Slide guides (**Figure 10, item 1**) on to the knuckle frame, and secure with pull pins (**Figure 10, item 2**).



**Figure 10**

2. Install return guides and secure with pull pin (**Figure 10, item 3**).
3. Slide guides (**Figure 11, item 1**) onto lower knuckle frame, and secure with pull pins (**Figure 11, item 2**).

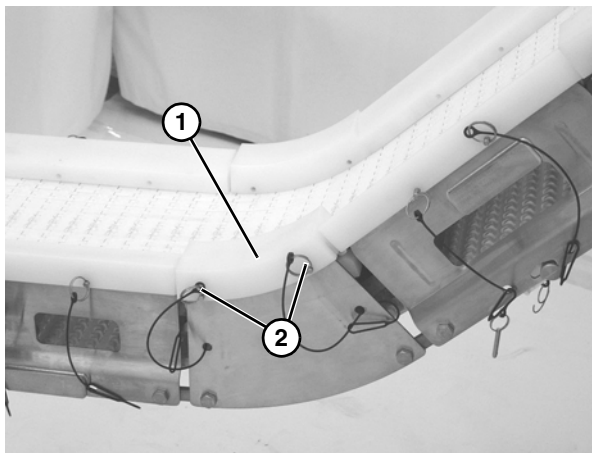

**Figure 11**

4. Install lower guides (**Figure 12, item 1**) onto lower end of knuckle and secure with pins (**Figure 12, item 2**).

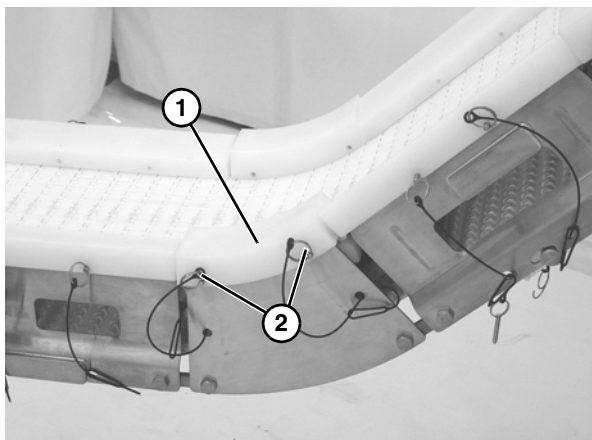

**Figure 12**

## All Conveyors

### Stand Installation

Typical Stand Components (**Figure 13**)

|   |  |
|---|--|
| 1 | Conveyor frame                             |
| 2 | Stand                                      |
| 3 | M10 - 1.5 x 16 mm hex head cap screws (x4) |

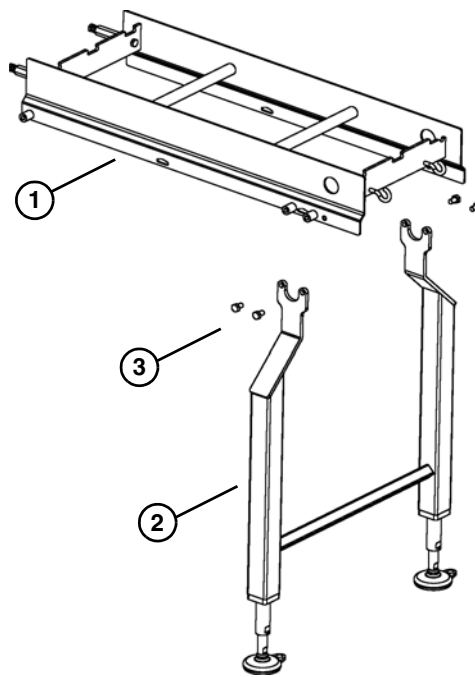

**Figure 13**

1. Position the stands on a flat, level surface.
2. Attach the stands to the frame (**Figure 14**).

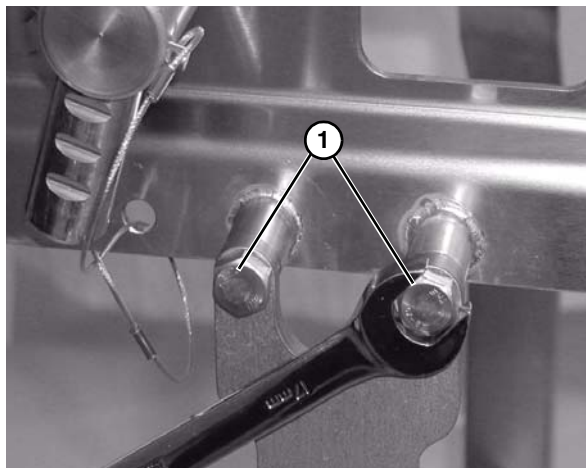

**Figure 14**

3. Tighten hex screws (**Figure 14, item 1**).



## Tail Assembly Installation

### Nose Bar Drive Tail

Typical Nose Bar Drive Tail Components (Figure 15)

|   |                              |
|---|------------------------------|
| 1 | Nose bar drive tail assembly |
| 2 | Conveyor frame               |

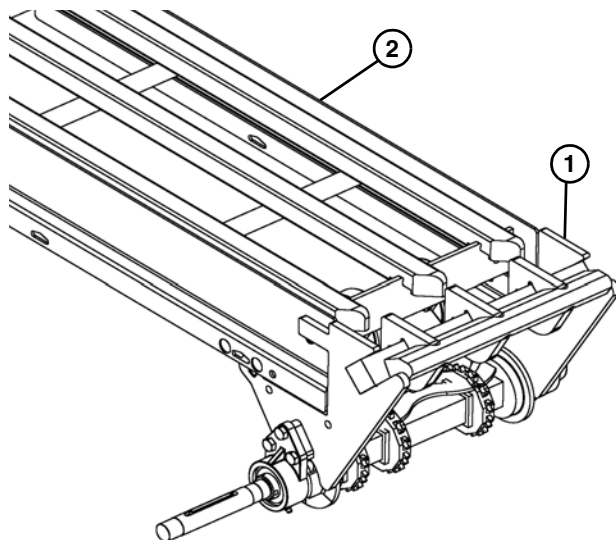

**Figure 15**

1. Install the drive package, if applicable. Refer to the “7400 Series Drive Package Installation, Maintenance and Parts Manual.”

### Nose Bar Tip Up Tail

Typical Nose Bar Tip Up Tail Components (Figure 16)

|   |                      |
|---|----------------------|
| 1 | Tip up tail assembly |
| 2 | Pull pin (x2)        |
| 3 | Tip up shaft         |
| 4 | Key stops (x2)       |

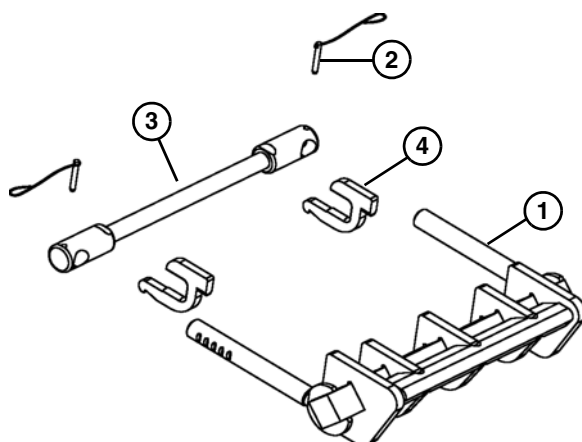

**Figure 16**

1. Slide the tip up shaft (Figure 17, item 1) through the designated slots in the frame.

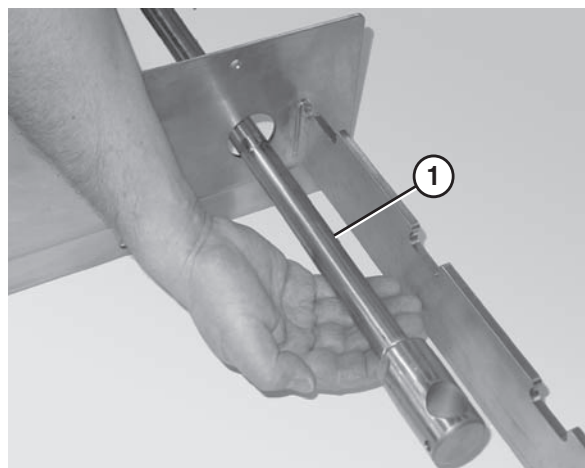

**Figure 17**

2. Attach the key stops (Figure 18, item 1) to the tip up shaft (Figure 18, item 2). The rounded end of the key stop should face the tail.

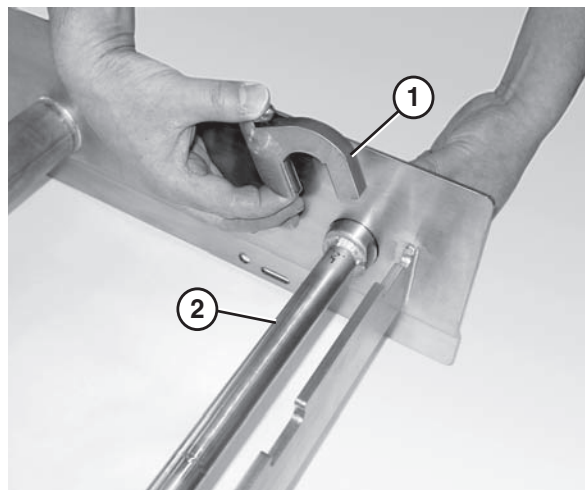

**Figure 18**

3. Attach the nose bar idler shaft hands (Figure 19, item 1) to the tip up shaft (Figure 19, item 2).

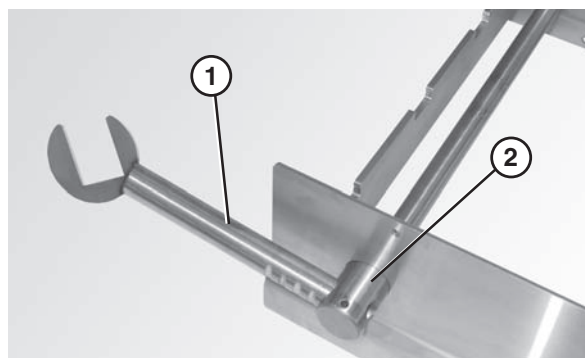

**Figure 19**

# Installation

4. Attach the nose bar transfer post (**Figure 20, item 1**) to the nose bar idler shaft hands (**Figure 20, item 2**).

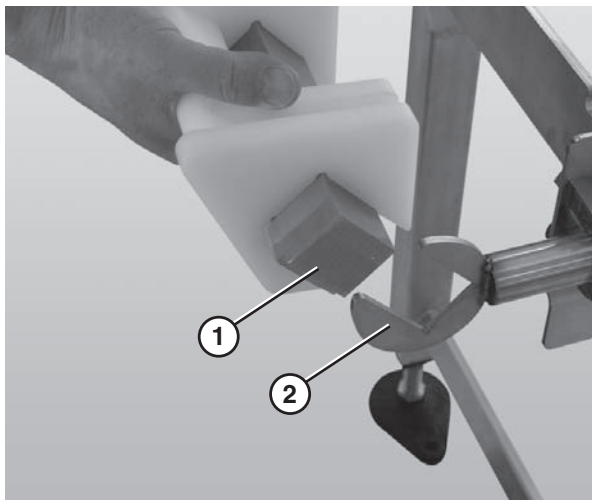

**Figure 20**

5. Ensure that the nose bar pucks (**Figure 21, item 1**) are in line with the conveyor frame (**Figure 21, item 2**).

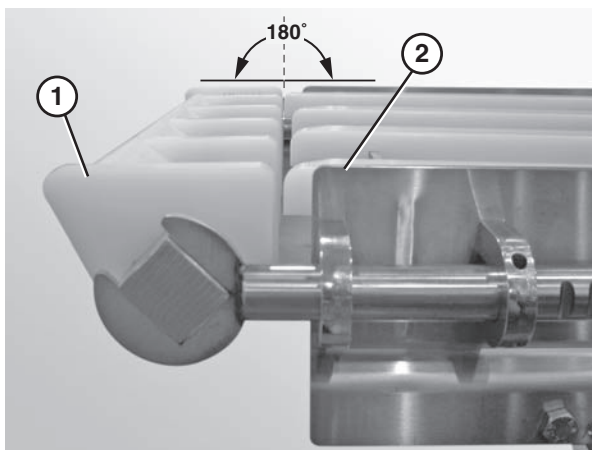

**Figure 21**

## NOTE

*Do not insert the pull pins on the tension end of the conveyor until the belt has been installed.*

## Tip Up Idler Tail

Typical Tip Up Idler Tail Components (**Figure 22**)

- |   |                      |
|---|----------------------|
| 1 | Tip up tail assembly |
| 2 | Pull pin (x2)        |
| 3 | Tip up shaft         |
| 4 | Key stops (x2)       |

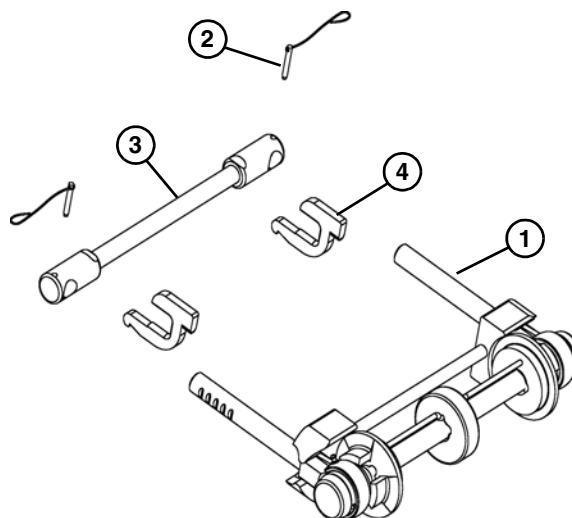

**Figure 22**

1. Slide the tip up shaft (**Figure 23, item 1**) through the designated slots in the frame.

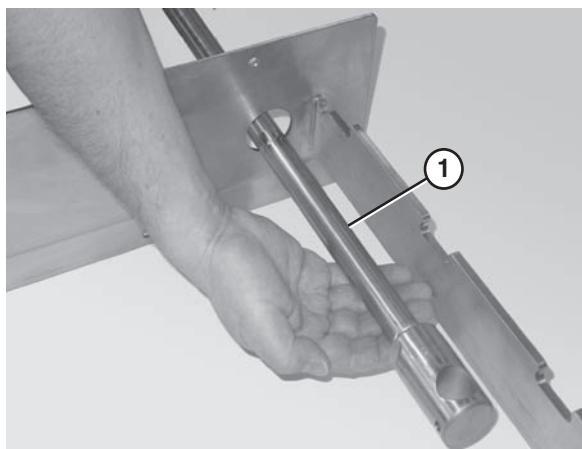

**Figure 23**

2. Attach the key stops (**Figure 24, item 1**) to the tip up shaft (**Figure 24, item 2**). The rounded end of the key stop should be facing the tail.

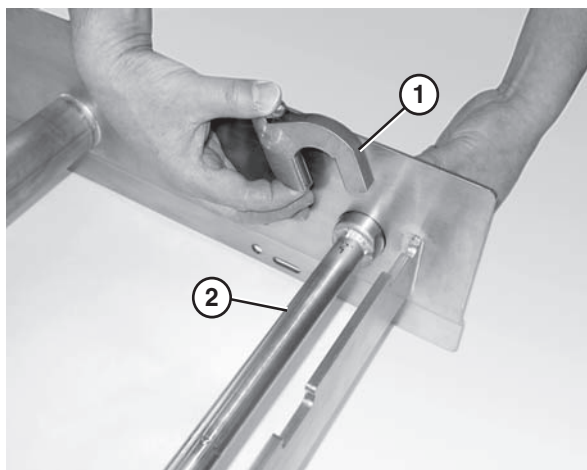

**Figure 24**

3. Slide the bearing shafts (**Figure 25, item 1**) into the holes in the tip up shaft (**Figure 25, item 2**).

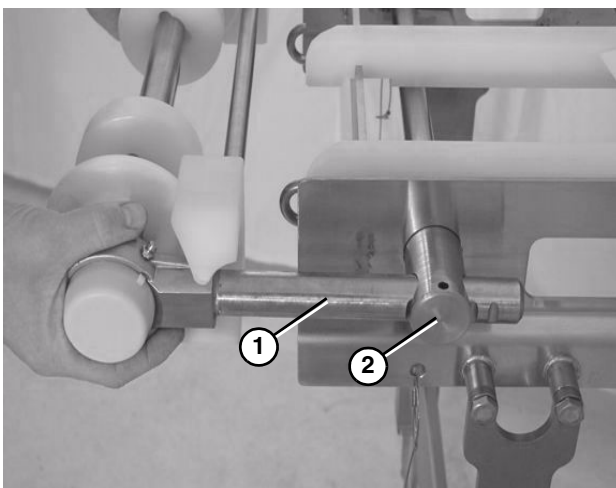

**Figure 25**

## NOTE

*Do not insert the pull pins on the tension end of the conveyor until the belt has been installed.*

## Lifter Installation

Typical Lifter Components (**Figure 26**)

- |   |                                      |
|---|--------------------------------------|
| 1 | Belt lift pivot bar                  |
| 2 | Lifter bars                          |
| 3 | Belt lift handle                     |
| 4 | M8 - 1.25 x 16 mm hex head cap screw |

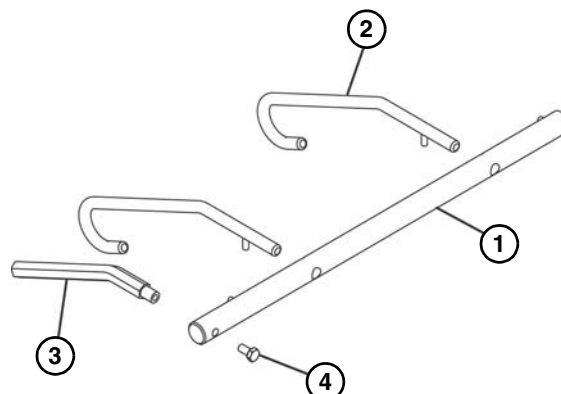

**Figure 26**

1. Slide the belt lift pivot bar (**Figure 27, item 1**) through the designated holes in the frame.

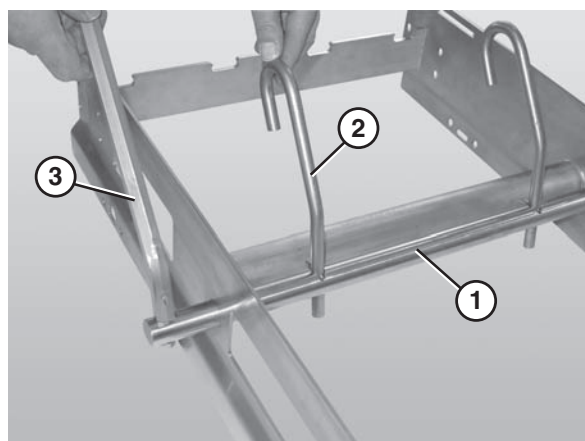

**Figure 27**

2. Attach the lifter bars (**Figure 27, item 2**) to the belt lift pivot bar (**Figure 27, item 1**). Make sure the hooked ends of the lifter bars are facing down when resting against the frame.
3. Attach the lifter handle (**Figure 27, item 3**) to the belt lift pivot rod.

# Installation

## Wear Strip Installation

Typical Wear Strip Components (**Figure 28**)

|   |            |
|---|------------|
| 1 | Wear strip |
|---|------------|

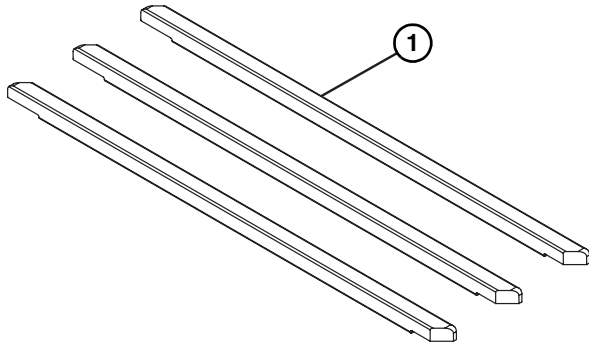

**Figure 28**

1. Position the wear strips (**Figure 29, item 1**) on the frame.

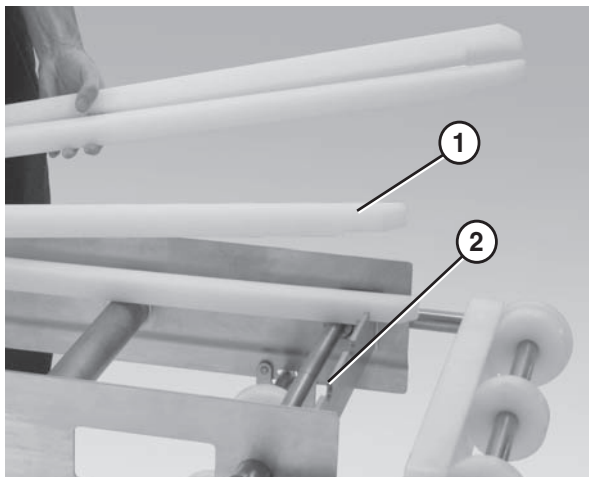

**Figure 29**

2. Make sure the wear strips are situated securely in the frame slots (**Figure 29, item 2**).

## Belt Installation

Typical Belt Components (**Figure 30**)

|   |            |
|---|------------|
| 1 | Chain belt |
| 2 | Belt rod   |

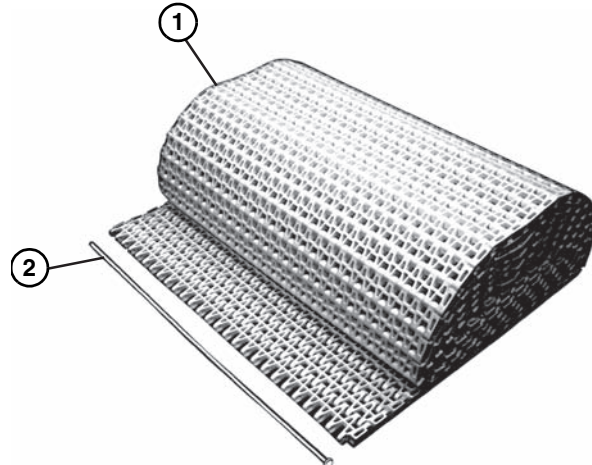

**Figure 30**

1. Position the belt on the conveyor frame (**Figure 31**).



**Figure 31**

2. Wrap the belt around the conveyor, making sure the sprocket teeth have engaged the belt.



3. Bring the ends of the belt together (**Figure 32**).



**Figure 32**

4. Insert the belt rod (**Figure 33, item 1**).

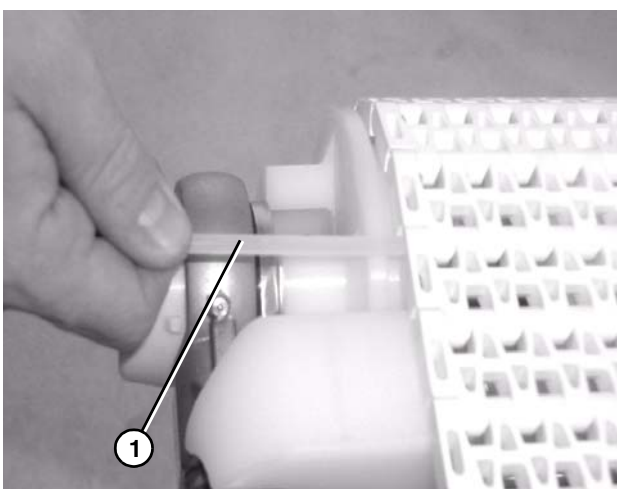

**Figure 33**

5. Push the belt rod in as far as possible.
6. Lightly tap the head of the rod with a hammer until it snaps into position.
7. Extend the tension end to remove excess slack in the belt (**Figure 34**).

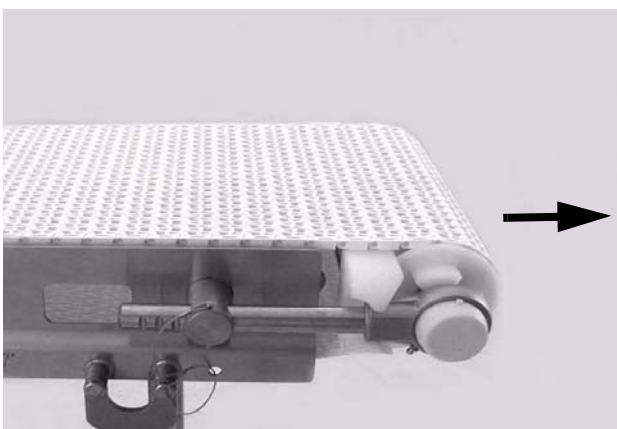

**Figure 34**

8. Insert the pull pins (**Figure 35, item 1**) on the tension end of the conveyor.

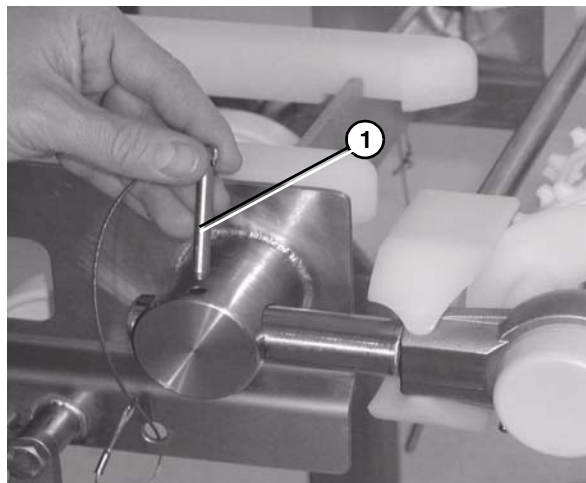

**Figure 35**

9. If no more travel is available, remove one or more belt links to take up the tension. Refer to “Standard Belts: Replacing a Section of Belt” on page 17.

## Belt Return Installation

Typical Belt Return Components (**Figure 36**)

- |   |                   |
|---|-------------------|
| 1 | Return shaft      |
| 2 | Chain return shoe |

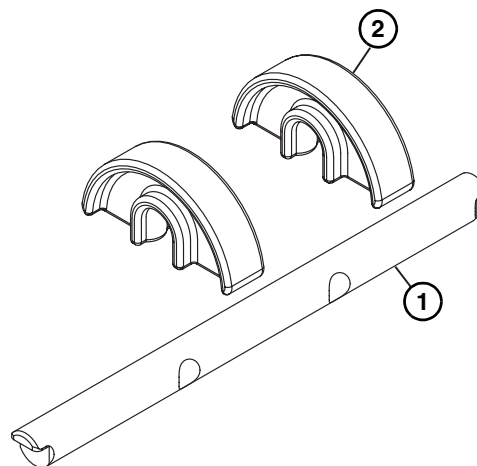

**Figure 36**

# Installation

1. Attach the chain return shoes (**Figure 37, item 1**) to the return shaft (**Figure 37, item 2**).

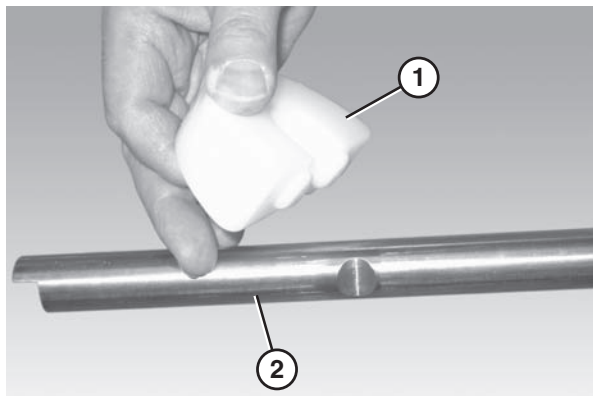

**Figure 37**

2. Slide the return shaft (**Figure 38, item 1**) up and through the large slot (**Figure 38, item 2**) in the frame (picture shown without the belt or wear strips).

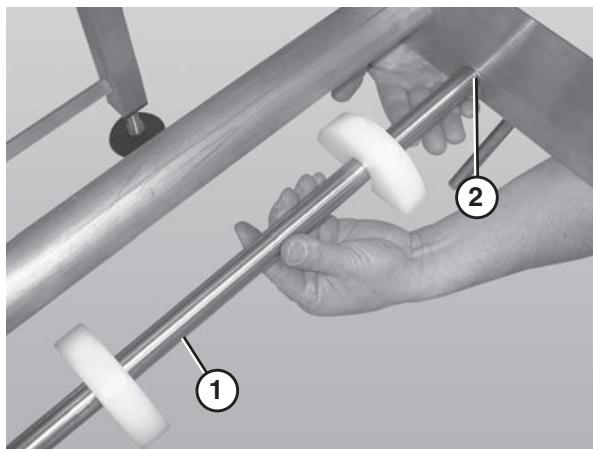

**Figure 38**

3. Push up on the return shaft (**Figure 38, item 1**) and slide the notched end of the shaft through the small slot on the opposite side of the frame.

4. Check belt sag by measuring from the top of the return (**Figure 39**). Belt sag should not exceed 4" (102 mm). Follow steps 7 – 9 in the "Belt Installation" section on page 12 to remove slack from the belt.

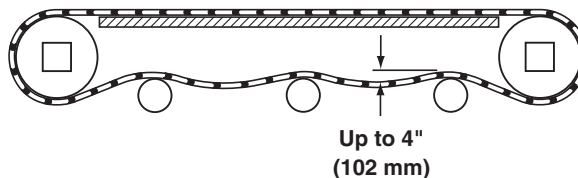

**Figure 39**

## **⚠ CAUTION**

**Belt sag should not exceed 4" (102 mm) from the top of the returns.**



# Preventive Maintenance and Adjustment

## Required Tools

- 17 mm wrench (or adjustable wrench)
- 4 mm hex wrench (for bearing shaft assembly fasteners)
- 3 mm hex wrench
- Punch and hammer (to remove belt rod)

## Checklist

- Keep service parts on hand. Refer to the "Service Parts" section starting on page 26 for recommendations.
- Replace any worn or damaged parts.

## Cleaning

### NOTE

*Proper conveyor application, cleaning, and sanitation are the responsibility of the end user.*

### ⚠ CAUTION

Dorner recommends cleaning all the "food zones" prior to placing conveyor into service. Ensure adequate access is provided for cleaning and servicing equipment so that the required level of hygiene can be maintained.

## Routine Cleaning

### ⚠ WARNING



### SEVERE HAZARD!

**LOCK OUT POWER** before removing guards or performing maintenance. Exposed moving parts can cause serious injury.

Dorner recommends cleaning the inside and the outside of the conveyor on a daily basis. Refer to the following steps to access the inside of the conveyor.

## Standard Conveyors

1. Remove the guides, if applicable, by removing the pull pins (**Figure 40, item 1**) that connect the guide (**Figure 40, item 2**) to the frame.

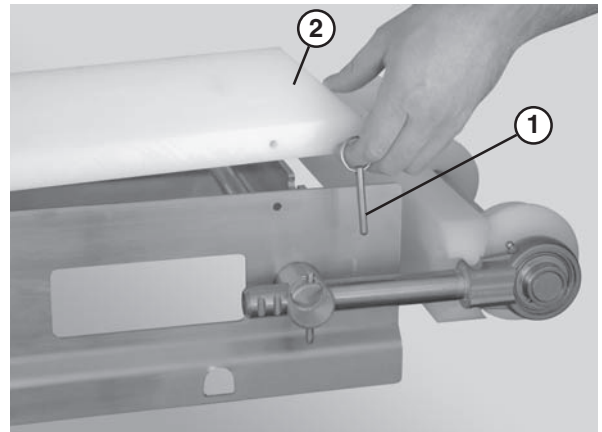

**Figure 40**

2. Remove the pull pin (**Figure 41, item 1**) on the tension end of the conveyor to release belt tension.

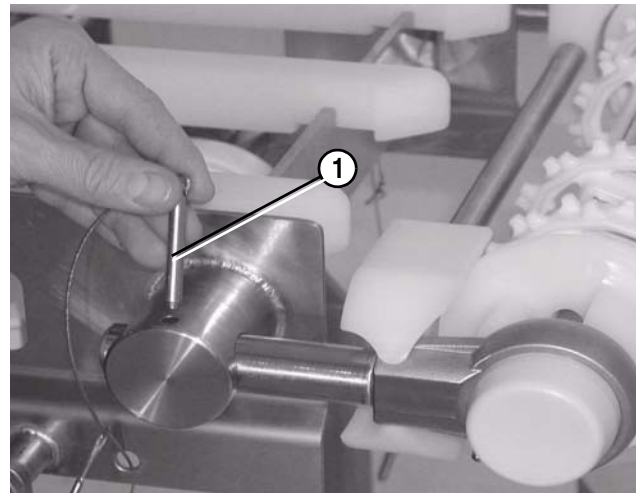

**Figure 41**

3. Lift up on the belt (**Figure 42**).



**Figure 42**

# Preventive Maintenance and Adjustment

## Conveyors with Lifters

1. Remove the guides, if applicable, by removing the pull pins (**Figure 40, item 1**) that connect the guide (**Figure 40, item 2**) to the frame.
2. Use the lifter handle (**Figure 43, item 1**) to raise the lifters (**Figure 43, item 2**) and raise the tip up tail (**Figure 43, item 3**).

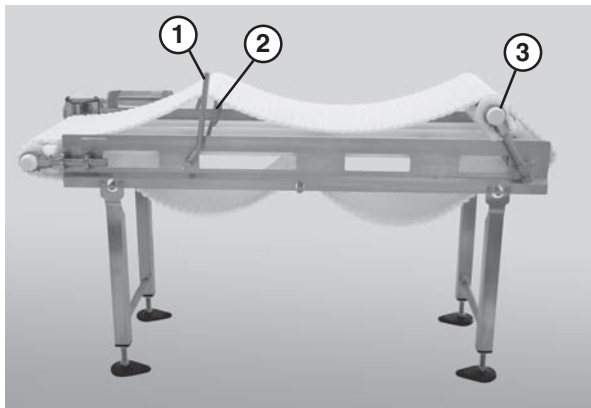

Figure 43



### CAUTION

**DO NOT submerge or soak bearing assemblies. This will reduce the life of the bearing.**

## Periodic Cleaning

Dorner recommends complete disassembly of the conveyor periodically for thorough cleaning.

For conveyor disassembly and reassembly instructions:

- Refer to “Conveyor Belt Replacement” on page 17.
- Refer to “Sprocket and Puck Removal” on page 19.
- Refer to “Reassembling Tail Assemblies” on page 22.

## Lubrication

### Conveyor Bearings

Conveyor bearing lubrication is required. Dorner recommends using an H-1 food grade grease.

### NOTE

*Although bearings are sealed, re-greasing is recommended to increase bearing life. An H-1 food grade grease is recommended. The frequency of bearing re-greasing is dependent upon the application in which the conveyor is being used. Frequency of re-greasing will increase with the frequency of conveyor washing.*

1. Add grease to the bearing using the zerk fitting (**Figure 44, item 1**) on the exterior of the bearing shaft assembly.

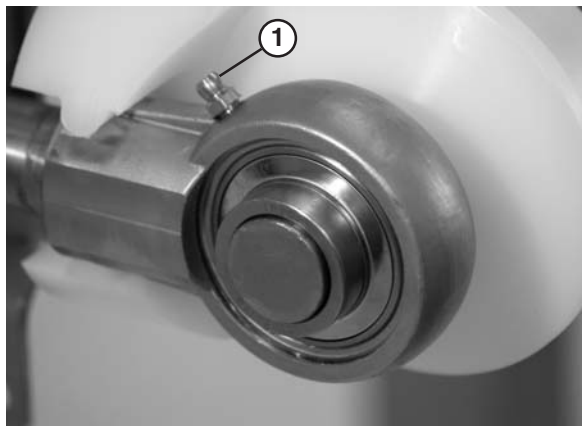

Figure 44

2. Replace the bearings if they become worn.

## Wearstrips and Belt Returns

Replace the wearstrips and belt returns if they become worn.

For wearstrip and belt return installation instructions:

- Refer to “Wear Strip Installation” on page 12.
- Refer to “Belt Return Installation” on page 13.

## Maintaining the Conveyor Belt

### Troubleshooting

### NOTE

*Visit [www.dorner.com](http://www.dorner.com) for complete list of troubleshooting solutions.*

Inspect conveyor belt for:

- Surface cuts or wear
- Skipping

Damage to belt links or rods, surface cuts and / or wear indicate:

- Sharp or heavy parts impacting belt
- Jammed parts
- Accumulated dirt
- Foreign material inside the conveyor
- Improperly positioned accessories

Skipping indicates:

- Excessive load on belt
- Worn sprockets or impacted dirt on drive pulley

# Preventive Maintenance and Adjustment

Damage to belt links or rods indicate:

- Excessive load on belt
- Dirt impacted on sprockets
- Excessive or improper side loading
- Improperly positioned accessories

## Conveyor Belt Replacement

|   |
|---|
|  <b>WARNING</b>  |
|    |
| <b>SEVERE HAZARD!</b><br><b>LOCK OUT POWER</b> before removing guards or performing maintenance. Exposed moving parts can cause serious injury. |

### Conveyors with Guides

1. Remove the pull pins (**Figure 45, item 1**) that connect the guide (**Figure 45, item 2**) to the frame.

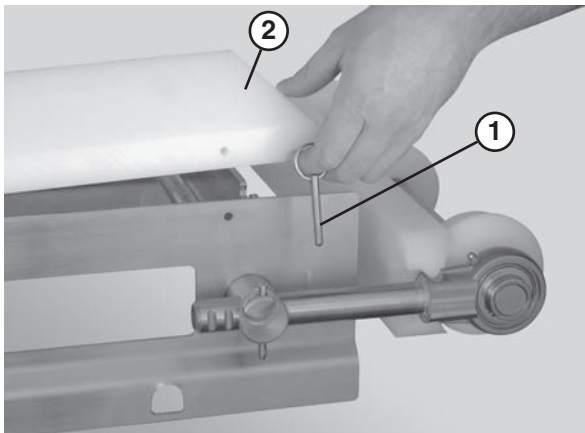

**Figure 45**

2. Remove the guide (**Figure 46, item 1**).

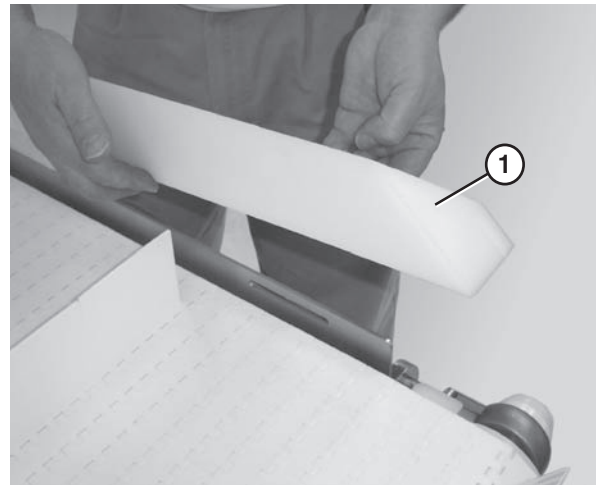

**Figure 46**

3. Follow the belt replacement procedures described in “Standard Belts” on page 17, “Specialty Intralox 1100 Series Belts” on page 18, or “Specialty Intralox 1600 Series Belts” on page 18.

### Standard Belts

#### Replacing a Section of Belt

1. Remove the pull pins (**Figure 47, item 1**) on the tension end of the conveyor to release tension on the belt.

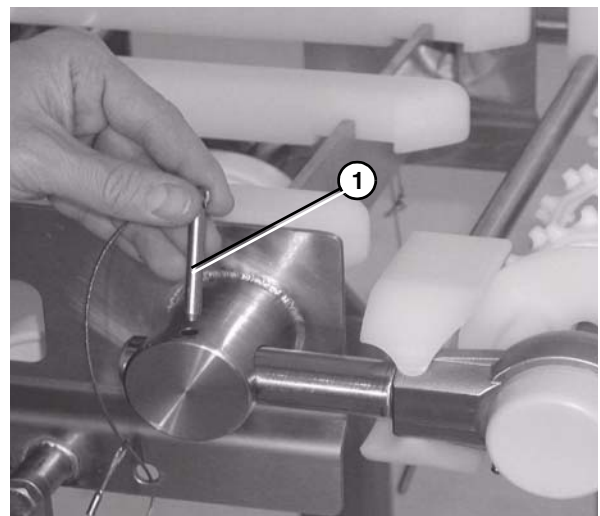

**Figure 47**

# Preventive Maintenance and Adjustment

## **⚠ CAUTION**

**Secure the retaining head side of the belt prior to removing a belt rod in order to prevent damaging the belt.**

2. Secure the retaining head side of the belt. Use the belt removal tool (3., item 1) for 1" pitch belts. For all other belts, position the section of belt so that it is braced by the flanged puck (3., item 2).

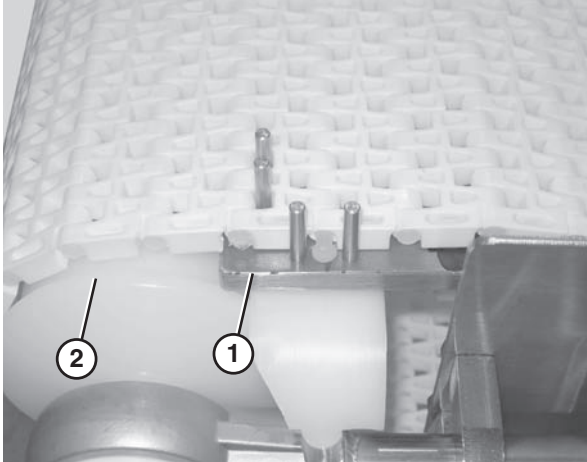

3. Use a punch and hammer to push the belt rod out by striking the rod end opposite the retaining head (Figure 48).



**Figure 48**

4. Remove the belt rods on both sides of the section of belt being replaced.
5. Replace the old section with a new section of belt.

## **⚠ CAUTION**

**DO NOT reuse belt rods that are damaged or show signs of wear.**

### Replacing the Entire Belt

1. Remove the belt returns by pushing up on the return shaft (Figure 49, item 1) and sliding it through the large hole (Figure 49, item 2) in the frame.

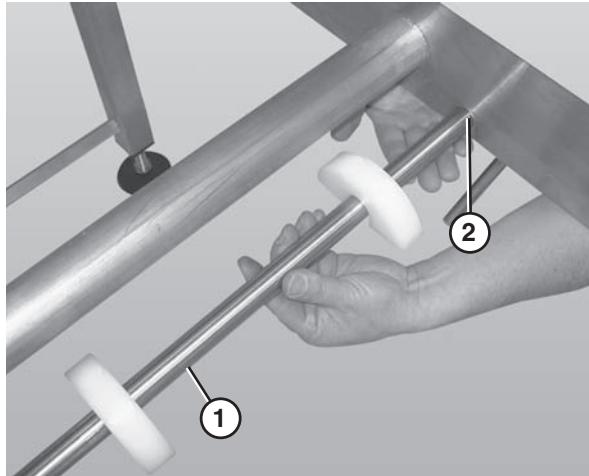

**Figure 49**

2. Lower the opposite end of the return shaft (Figure 49, item 1) and slide it out of the frame.
3. Follow steps 1 – 3 in "Standard Belts: Replacing a Section of Belt" on page 17.
4. Remove the belt.
5. Replace the damaged or worn belt. Refer to "Belt Installation" on page 12 and "Belt Return Installation" on page 13.

### Specialty Intralox 1100 Series Belts

#### Replacing a Section of Belt

1. Place the edge of a flat head screwdriver between the two belt links and turn clockwise (Figure 50).

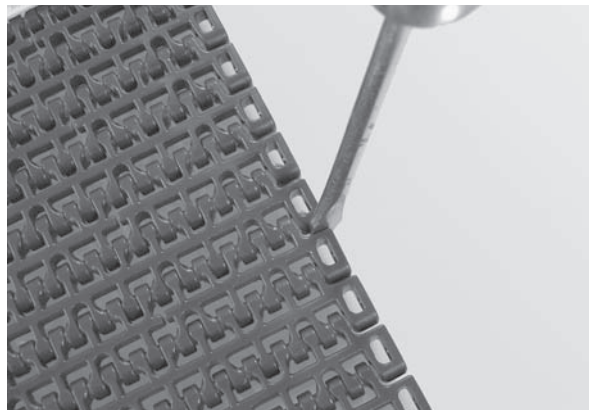

**Figure 50**



# Preventive Maintenance and Adjustment

2. Use a second belt rod of the same size to push on the opposite end of the belt rod. (Figure 51).

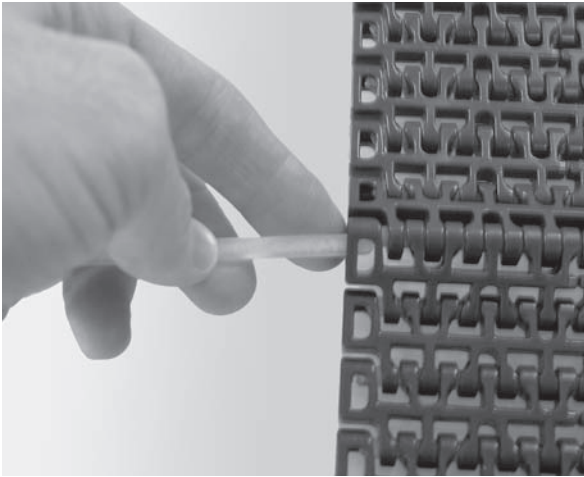

Figure 51

3. Remove the belt rods on both sides of the section of belt being replaced.
4. Replace the old section with a new section of belt.



## CAUTION

**DO NOT reuse belt rods that are damaged or show signs of wear.**

### Replacing the Entire Belt

1. Remove the belt returns.
2. Follow steps 1 – 2 in "Specialty Intralox 1100 Series Belts: Replacing a Section of Belt" on page 18.
3. Remove the belt.
4. Replace the damaged or worn belt. Refer to "Belt Installation" on page 12 and "Belt Return Installation" page 13.

### Conveyor Belt Tensioning



## WARNING



### SEVERE HAZARD!

**LOCK OUT POWER** before removing guards or performing maintenance. Exposed moving parts can cause serious injury.



## CAUTION

**Belt sag** should not exceed 4" (102 mm) from the top of the returns.

1. Remove both pull pins (Figure 52, item 1). Place tip up idler tail in the down position (Figure 52, item 2).

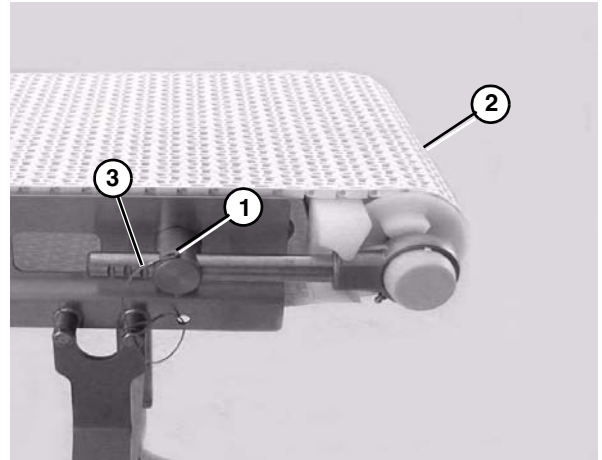

Figure 52

2. Extend the idler tail to the next groove (Figure 52, item 3) on the bearing shaft.
3. Continue extending the tension end until the belt is sufficiently tight (Figure 53).

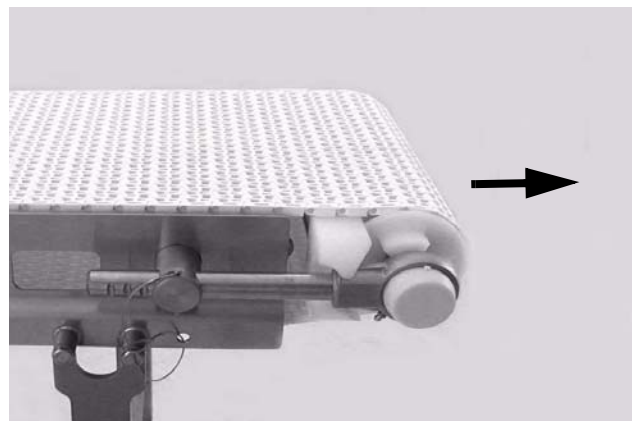

Figure 53

4. Reinsert the pull pins.
5. If no more travel is available, remove one or more belt links to take up the tension. Refer to "Replacing a Section of Belt" on page 17.

### Sprocket and Puck Removal



## WARNING



### SEVERE HAZARD!



**LOCK OUT POWER** before removing guards or performing maintenance. Exposed moving parts can cause serious injury.

# Preventive Maintenance and Adjustment

1. Remove the conveyor belt to access the sprockets / pucks. Refer to "Conveyor Belt Replacement" starting on page 17.
2. Remove the desired sprocket / puck by following these instructions:

- A - Drive Sprocket Removal
- B - Nose Bar Puck Removal
- C - Idler Puck Removal

## A - Drive Sprocket Removal

|  |
|--|
|  <b>WARNING</b>                                     |
|   |
| <b>PUNCTURE HAZARD!</b><br>Handle drive shaft keyway with care. It may be sharp and could puncture the skin, causing serious injury. |

1. Loosen the fasteners (**Figure 54, item 1**) that connect the gearmotor to the drive spindle using a hex wrench (**Figure 54, item 2**).

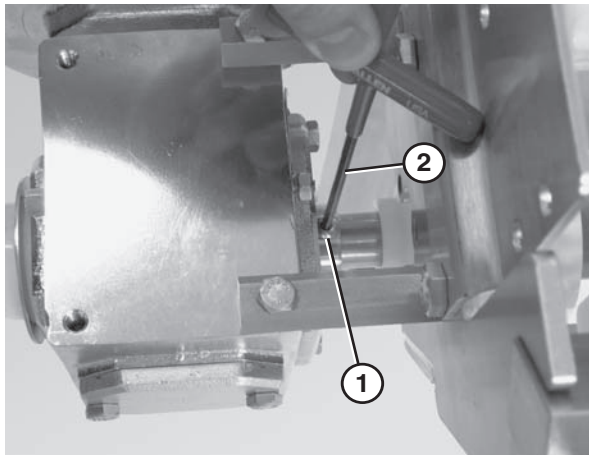

**Figure 54**

2. Remove the bolts that connect the motor to the drive assembly (**Figure 55**).
3. Remove the motor (**Figure 55, item 1**) from the drive assembly (**Figure 55, item 2**).

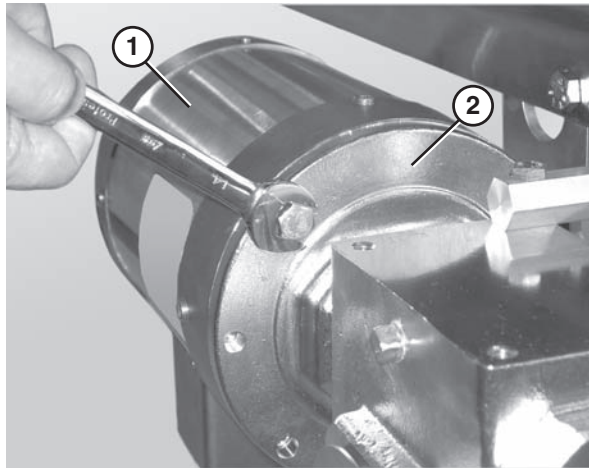

**Figure 55**

4. Unbolt the drive assembly and slide it off the bearing spindle (**Figure 56**).

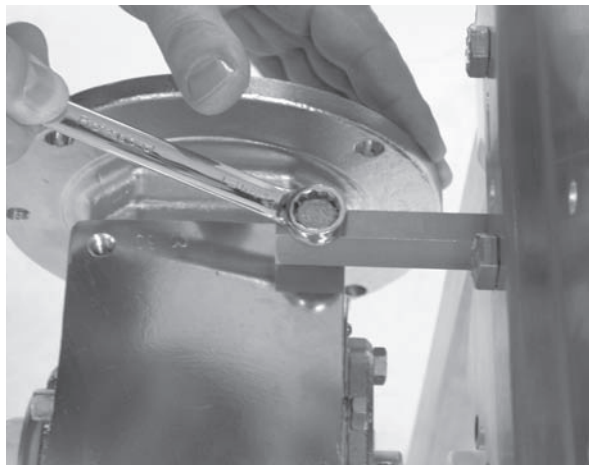

**Figure 56**

5. Remove the bearing cover.



---

# Preventive Maintenance and Adjustment

---

6. Loosen the 3 hole flange (**Figure 57, item 1**) with bearing fasteners using a hex wrench (**Figure 57, item 2**).

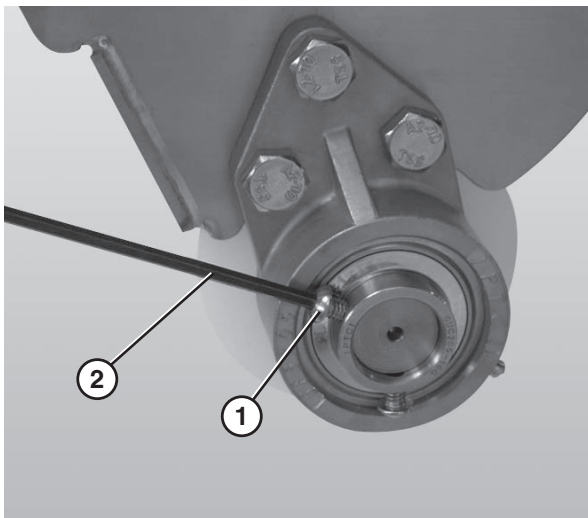

**Figure 57**

7. Disconnect the 3 hole flange bearing (**Figure 58, item 1**) from the nose bar drive weldment (**Figure 58, item 2**).

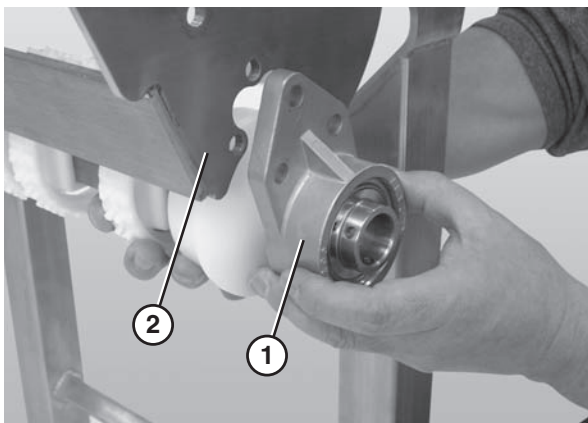

**Figure 58**

8. Lower the entire drive assembly.

9. Slide the 3 hole flange with bearing (**Figure 59, item 1**) and flanged puck (**Figure 59, item 2**) off the drive spindle.

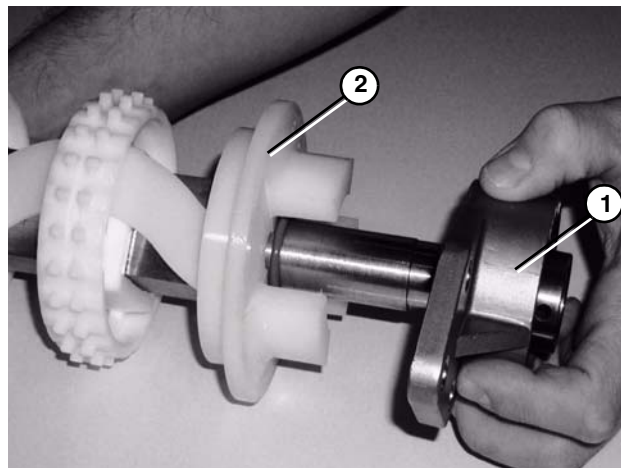

**Figure 59**

10. Slide the sprockets (**Figure 60, item 1**) and the sprocket alignment bar (**Figure 60, item 2**) off the drive spindle (**Figure 60, item 3**).

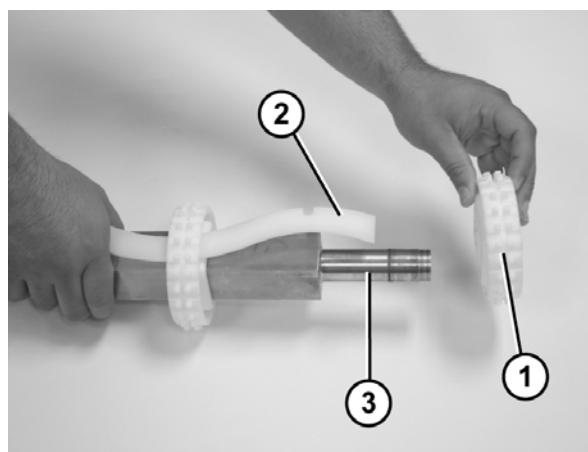
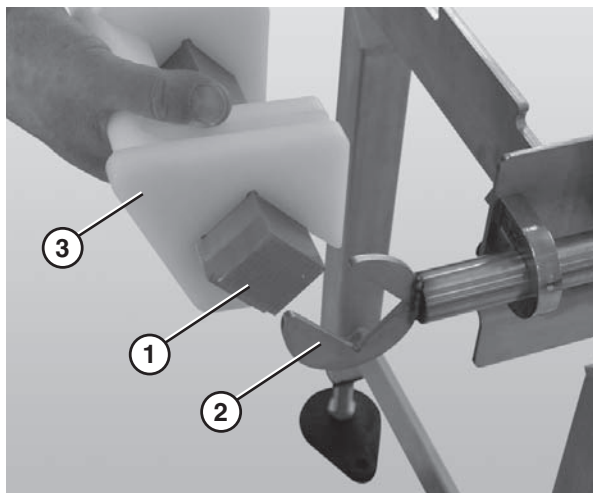

**Figure 60**

# Preventive Maintenance and Adjustment

## B - Nose Bar Puck Removal

1. Slide the nose bar drive or transfer post (**Figure 61, item 1**) out of the nose bar drive weldment or idler hands (**Figure 61, item 2**).



**Figure 61**

2. Remove the nose bar tracking pucks (**Figure 61, item 3**), if applicable.
3. Remove the nose bar wear strip (**Figure 62, item 3**).

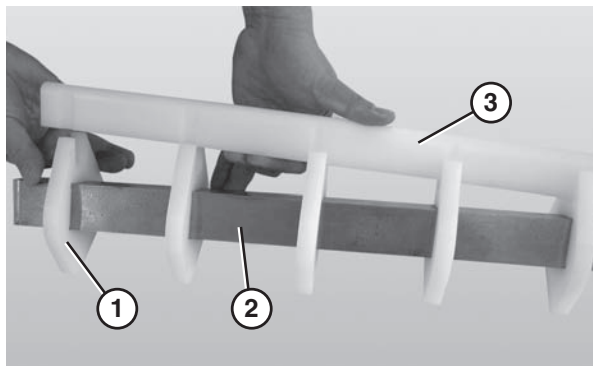
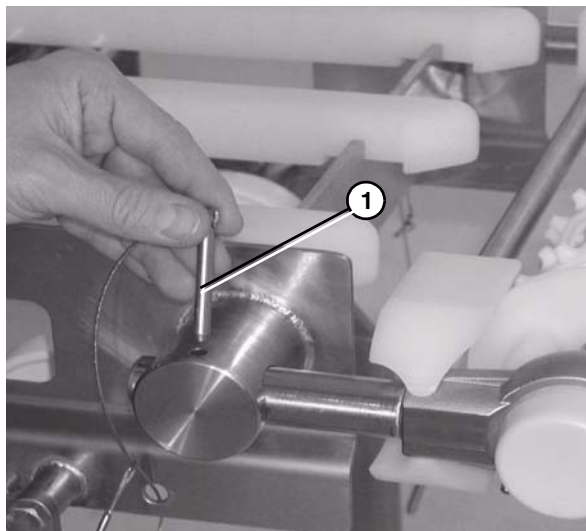

**Figure 62**

4. Slide the nose bar pucks (**Figure 62, item 1**) off the nose bar shaft (**Figure 62, item 2**).

## C - Idler Puck Removal

1. Remove the pull pins (**Figure 63, item 1**).



**Figure 63**

2. Slide the idler tail assembly (**Figure 64, item 1**) out of the take up blocks (**Figure 64, item 2**).

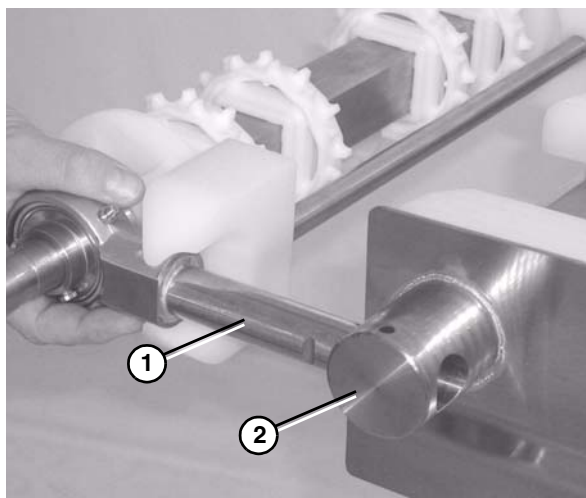

**Figure 64**

# Preventive Maintenance and Adjustment

3. Remove the bearing cover (Figure 65, item 1).

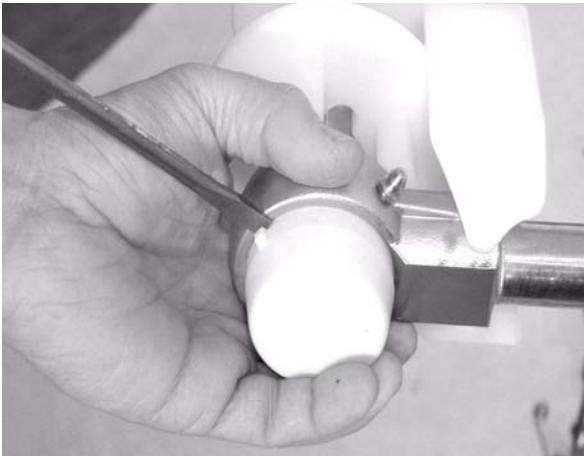

**Figure 65**

4. Use a hex wrench (Figure 66, item 1) to loosen the bearing shaft assembly fasteners (Figure 66, item 2).

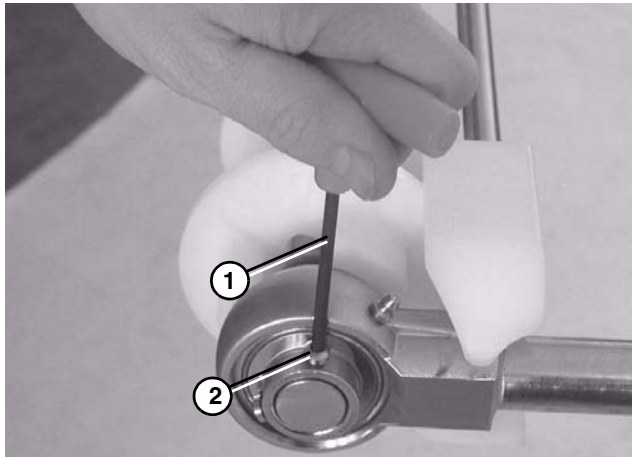

**Figure 66**

5. Slide the bearing shaft assembly (Figure 67, item 2) off the idler shaft.

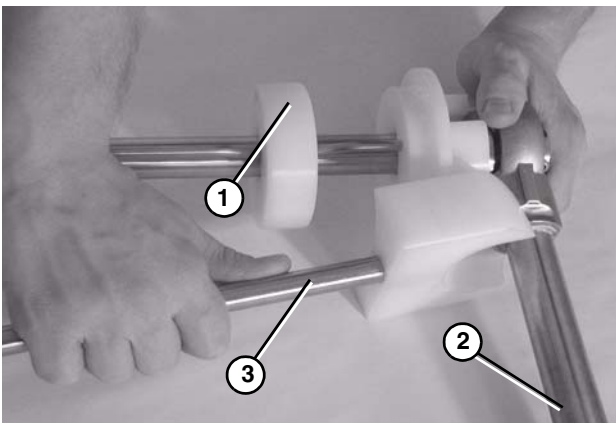

**Figure 67**

6. Remove the guard bar (Figure 67, item 3).
7. Slide the pucks (Figure 67, item 1) off the idler shaft.

## Reassembling Tail Assembly

Refer to the "Service Parts" section starting on page 26 for complete diagrams and lists of all tail assembly components.

### Nose Bar Drive Tail

#### Nose Bar Assembly

1. Slide the nose bar pucks (Figure 68, item 1) onto the nose bar drive post (Figure 68, item 2).

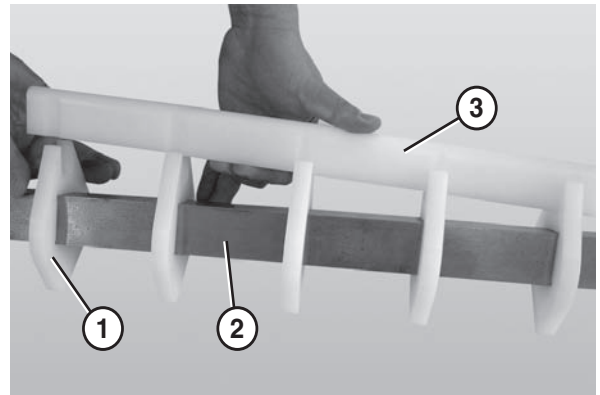
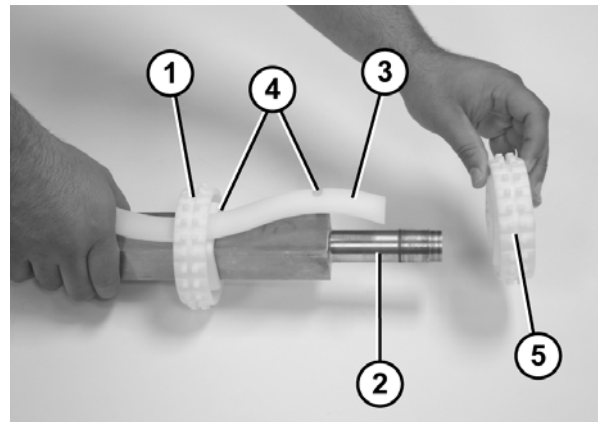

**Figure 68**

2. Attach the nose bar wear strip (Figure 68, item 3).

#### Drive Tail Assembly

1. Slide the first sprocket (Figure 69, item 1) onto the drive spindle (Figure 69, item 2).

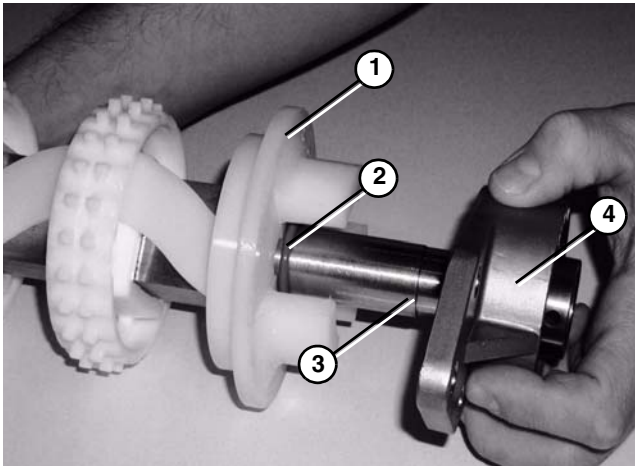

**Figure 69**

2. Insert the sprocket alignment bar (Figure 69, item 3) into the first sprocket and align the sprocket with the notch (Figure 69, item 4) in the sprocket alignment bar.
3. Slide the remaining sprockets (Figure 69, item 5) onto drive spindle and align each sprocket with the notches (Figure 69, item 4) in the sprocket alignment bar.

# Preventive Maintenance and Adjustment

4. Attach the flanged pucks (Figure 70, item 1), O-ring (Figure 70, item 2), washer (Figure 70, item 3), and the 3 hole flange with bearing (Figure 70, item 4) to the drive spindle.



**Figure 70**

5. Tighten the 3 hole flange with bearing fasteners (Figure 71, item 1) using a hex wrench (Figure 71, item 2) to 54 in•lbs (6 N•m). Check after 24 hours of conveyor use.

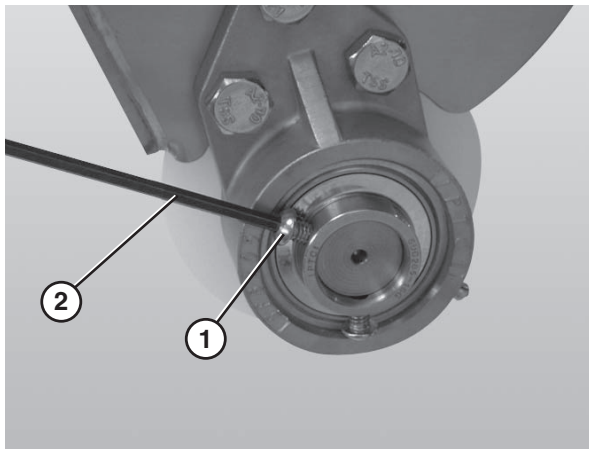

**Figure 71**

## Nose Bar Idler and Tip Up Tail

1. Slide the nose bar pucks (Figure 72, item 1) onto the nose bar drive post (Figure 72, item 2).

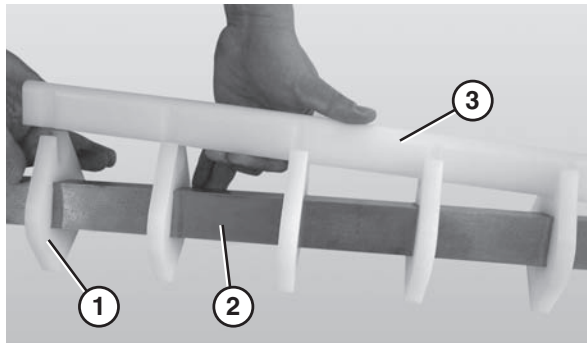

**Figure 72**

2. Attach the nose bar wear strip (Figure 72, item 3).
3. Attach the nose bar tracking pucks (Figure 73, item 1) to the nose bar drive post (Figure 73, item 2).

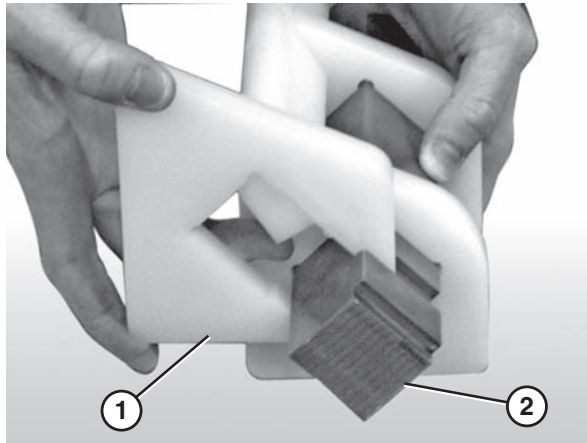

**Figure 73**

## Idler Tail and Tip Up Tail

1. Place the idler puck (Figure 74, item 1) at the center of the bent retaining bar (Figure 74, item 2).
2. Slide the idler puck onto the idler shaft (Figure 74, item 3). Make sure to center the idler puck.

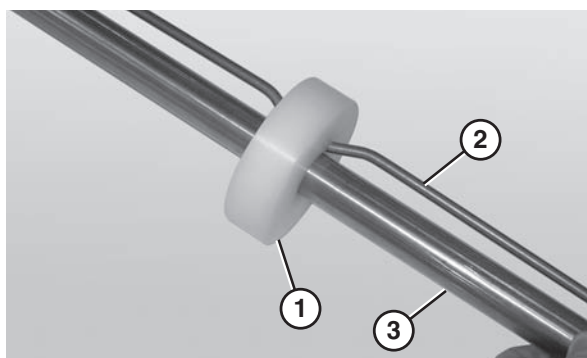

**Figure 74**



# Preventive Maintenance and Adjustment

3. Attach the flanged pucks (Figure 75, item 2) and bearing shaft assemblies to the idler shaft.
4. Attach the guard bar (Figure 75, item 1).

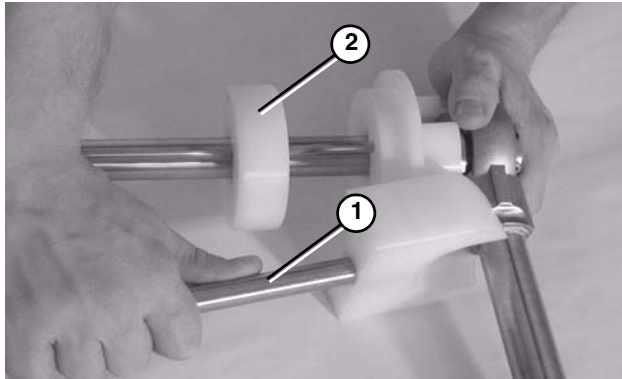

Figure 75

5. Use a hex wrench (Figure 76, item 1) to tighten the bearing shaft fasteners (Figure 76, item 2) to 54 in•lbs (6 N•m). Check after 24 hours of conveyor use.

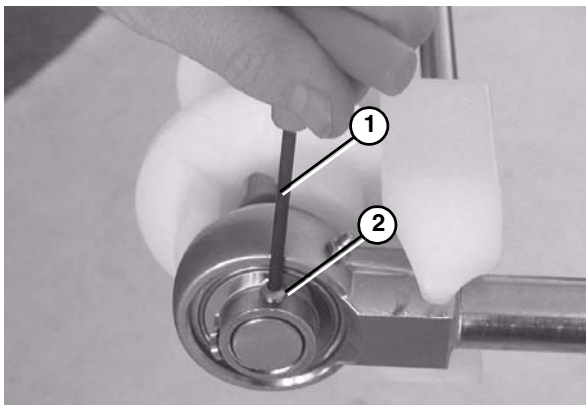

Figure 76

6. Attach the bearing covers. Reference Figure 60.

## Bearing Replacement

1. Secure the bearing shaft in the take up blocks.
2. Insert the rod end of a second bearing shaft through the bearing (Figure 77).

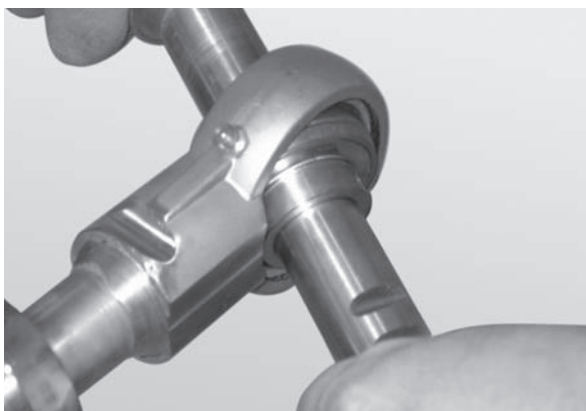

Figure 77

3. Apply lateral pressure to the rod until the bearing comes loose.
4. Remove the worn or damaged bearing (Figure 78).

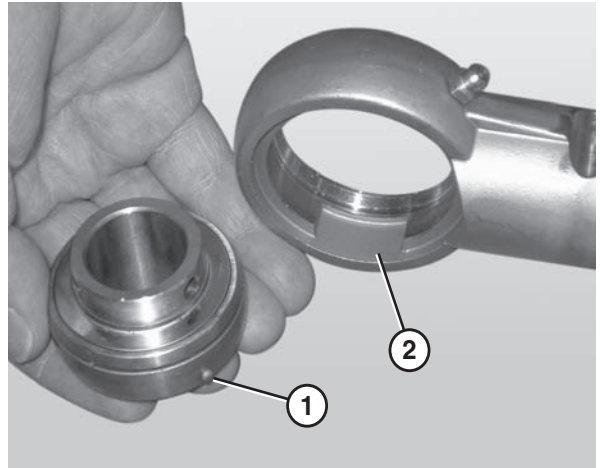

Figure 78

5. Replace the bearing.

### NOTE

*When inserting the new bearing, make sure the anti-rotation notch (Figure 78, item 1) on the bearing lines up with the groove inside the housing (Figure 78, item 2).*

## LPZ Knuckles

### Wearstrips and Belt Returns

Replace the wearstrips and belt returns if they become worn.

For wearstrip and belt return installation instructions:

- For wearstrips, replace as needed, making sure wear strips are situated securely in the frame slots.
- For belt returns, Refer to “Belt Return Installation” on page 13.

# Service Parts

## NOTE

For replacement parts other than those shown in this section, contact an authorized Dorner Service Center or the factory. Key Service Parts and Kits are identified by the Performance Parts Kits logo . Dorner recommends keeping these parts on hand.

## Nose Bar Drive End Components

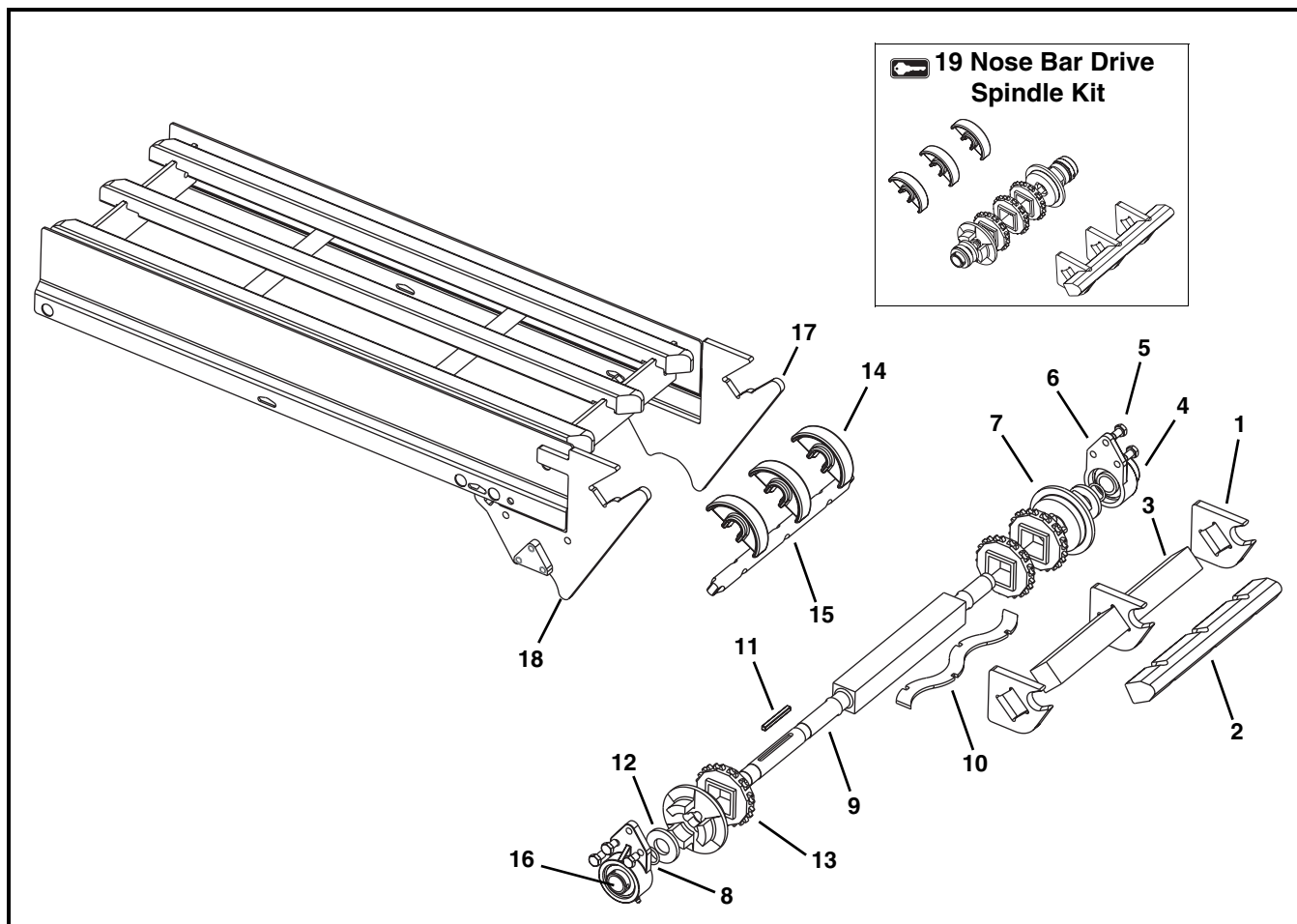

| Item | Part Number | Description                               |
|------|-------------|---|
| 1    | 500278      | Nose Bar Puck                             |
| 2    | 5055WW      | .5" Pitch Nose Bar Wear Strip             |
|      | 5057WW      | 1" Pitch Nose Bar Wear Strip              |
| 3    | 5178WW      | Nose Bar Drive Post                       |
| 4    | 807-1454    | Cover                                     |
| 5    | 961016MSS   | Hex Head Cap Screw M10-1.5x16mm           |
| 6    | 500288      | 3 Hole Flange with Bearing                |
| 7    | 517201      | Flange Puck                               |
| 8    | 807-1588    | O-Ring                                    |
| 9    | 5179WW      | Drive Spindle for Standard Belt           |
|      | 5180WW      | Drive Spindle for Specialty Intralox Belt |

| Item | Part Number | Description   |
|------|-------------|---|
| 10   | 5162WW      | Sprocket Alignment Bar for Standard .50" Pitch Belt           |
|      | 5163WW      | Sprocket Alignment Bar for Specialty Intralox .60" Pitch Belt |
| 11   | 912-111SS   | Square Key .25" x 2.50"                                       |
| 12   | 501381      | Washer, Puck Standoff   |
| 13   | 807-1443    | Sprocket for Standard .50" Pitch Belt                         |
|      | 807-1446    | Sprocket for Specialty Intralox .60" Pitch Belt               |
| 14   | 500075      | Belt Return   |
| 15   | 5039WW      | Return Shaft  |
| 16   | 802-162     | Bearing   |
| 17   | 501490      | Nose Bar Side Plate Assembly (D Mount Position Only)          |



| Item  | Part Number          | Description  |
|---|----------------------|--|
| 18  | 501389               | Nose Bar Side Plate Assembly (A Mount Position Only)   |
|    | 74UNBDD12- <u>WW</u> | Nose Bar Drive Spindle Kit when Conveyor is ordered with a Dorner Gearmotor Mounting Package for Standard .50" Pitch Belt (Includes Items 1, 2, 4, 7, 13, 14, and 16)              |
|   | 74UNBDD11- <u>WW</u> | Nose Bar Drive Spindle Kit when Conveyor is ordered with a Dorner Gearmotor Mounting Package for Specialty Intralox .60" Pitch Belt (Includes Items 1, 2, 4, 7, 13, 14, and 16)    |
|   | 74UNBDC12- <u>WW</u> | Nose Bar Drive Spindle Kit when Conveyor is ordered without a Dorner Gearmotor Mounting Package for Standard .50" Pitch Belt (Includes Items 1, 2, 4, 7, 13, 14, and 16)           |
|   | 74UNBDC11- <u>WW</u> | Nose Bar Drive Spindle Kit when Conveyor is ordered without a Dorner Gearmotor Mounting Package for Specialty Intralox .60" Pitch Belt (Includes Items 1, 2, 4, 7, 13, 14, and 16) |
| <u>WW</u> = Conveyor width ref: 06 - 36 in 02 increments  |                      |  |
| * When the conveyor is ordered with a Dorner gearmotor mounting package the shaft assembly is replaced with a gearmotor mounting bracket. |                      |  |

| Sprocket Quantity (Item 4) |                   |
|----------------------------|-------------------|
| Width                      | Sprocket Quantity |
| 6" (152mm)                 | 2                 |
| 8" (203mm)                 | 2                 |
| 10" (254mm)                | 3                 |
| 12" (305mm)                | 3                 |
| 14" (356mm)                | 4                 |
| 16" (406mm)                | 4                 |
| 18" (457mm)                | 5                 |
| 20" (508mm)                | 5                 |
| 22" (559mm)                | 6                 |
| 24" (610mm)                | 6                 |
| 26" (660mm)                | 7                 |
| 28" (711mm)                | 7                 |
| 30" (762mm)                | 8                 |
| 32" (813mm)                | 8                 |
| 34" (864mm)                | 9                 |
| 36" (914mm)                | 9                 |

# Service Parts

## Nose Bar Tip Up Tension End

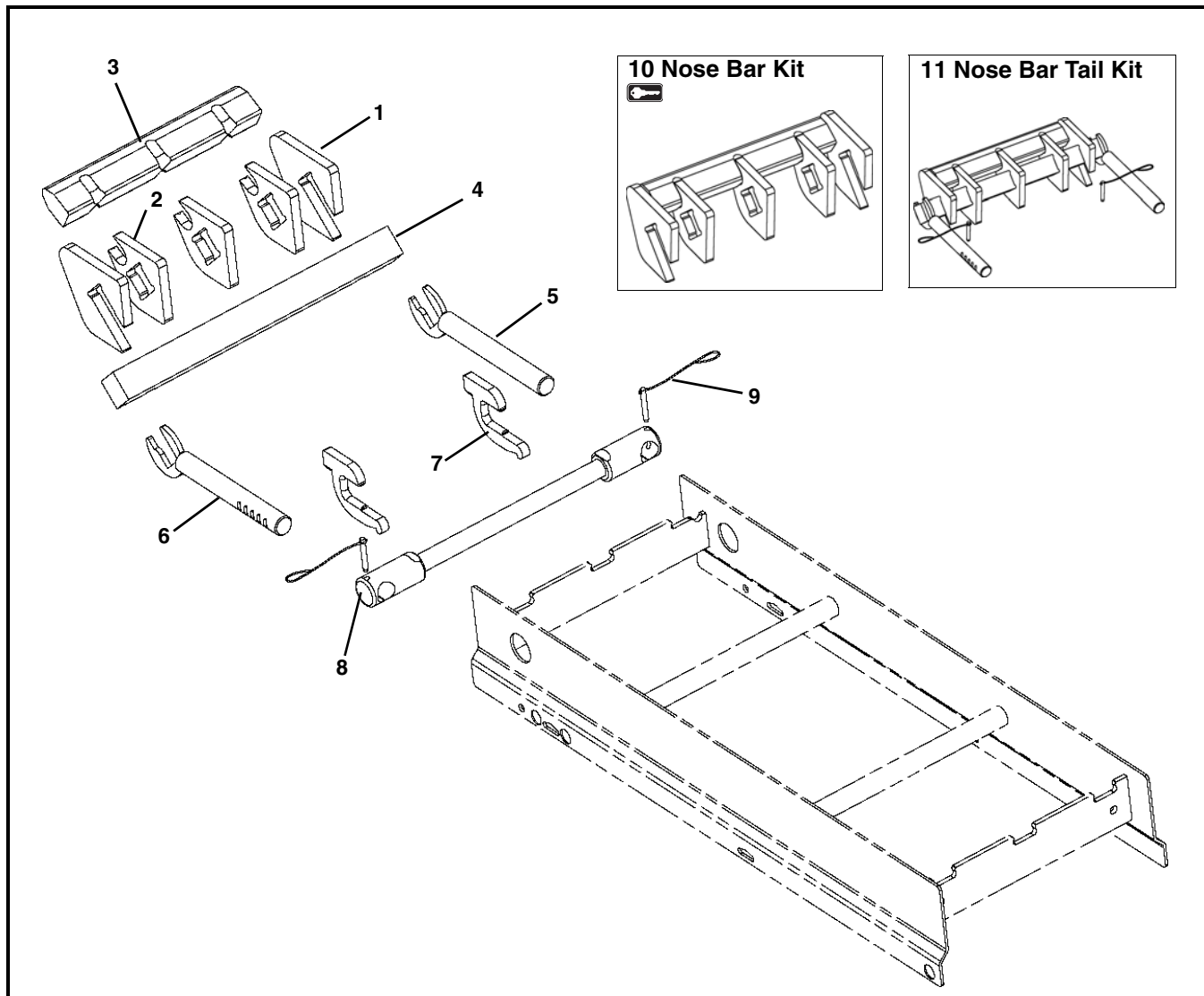

| Item | Part Number | Description  |
|------|-------------|--|
| 1    | 500490      | Nose Bar Tracking Puck                             |
| 2    | 500278      | Nose Bar Puck                                      |
| 3    | 5056WW      | .5" Pitch Nose Bar Wear Strip                      |
|      | 5058WW      | 1" Pitch Nose Bar Wear Strip                       |
| 4    | 5176WW      | Nose Bar Transfer Post for Standard Belt           |
|      | 5177WW      | Nose Bar Transfer Post for Specialty Intralox Belt |
| 5    | 500487      | Nose Bar Idler Shaft Left Hand                     |
| 6    | 500488      | Nose Bar Idler Shaft Right Hand                    |
| 7    | 501184      | Key Stop   |
| 8    | 5182WW      | Tip Up Shaft Assembly                              |

| Item | Part Number | Description  |
|------|-------------|--|
| 9    | 501676      | Pin Assembly   |
| 10   | 74UNB5-WW   | .5" Nose Bar Kit for Standard Belt (Includes Items 1 through 3)                      |
|      | 74UNB1-WW   | 1" Nose Bar Kit for Specialty Intralox Belt (Includes Items 1 through 3)             |
| 11   | 74UNBT5-WW  | .5" Nose Bar Tail Kit for Standard Belt (Includes Items 1 through 6 and 9)           |
|      | 74UNBT1-WW  | 1" Nose Bar Tail Kit for Standard Belt (Includes Items 1 through 6 and 9)            |
|      | 74UNBT5S-WW | .5" Nose Bar Tail Kit for Specialty Intralox Belt (Includes Items 1 through 6 and 9) |
|      | 74UNBT1S-WW | 1" Nose Bar Tail Kit for Specialty Intralox Belt (Includes Items 1 through 6 and 9)  |

WW = Conveyor width ref: 06 - 36 in 02 increments

## Tip Up Tension End

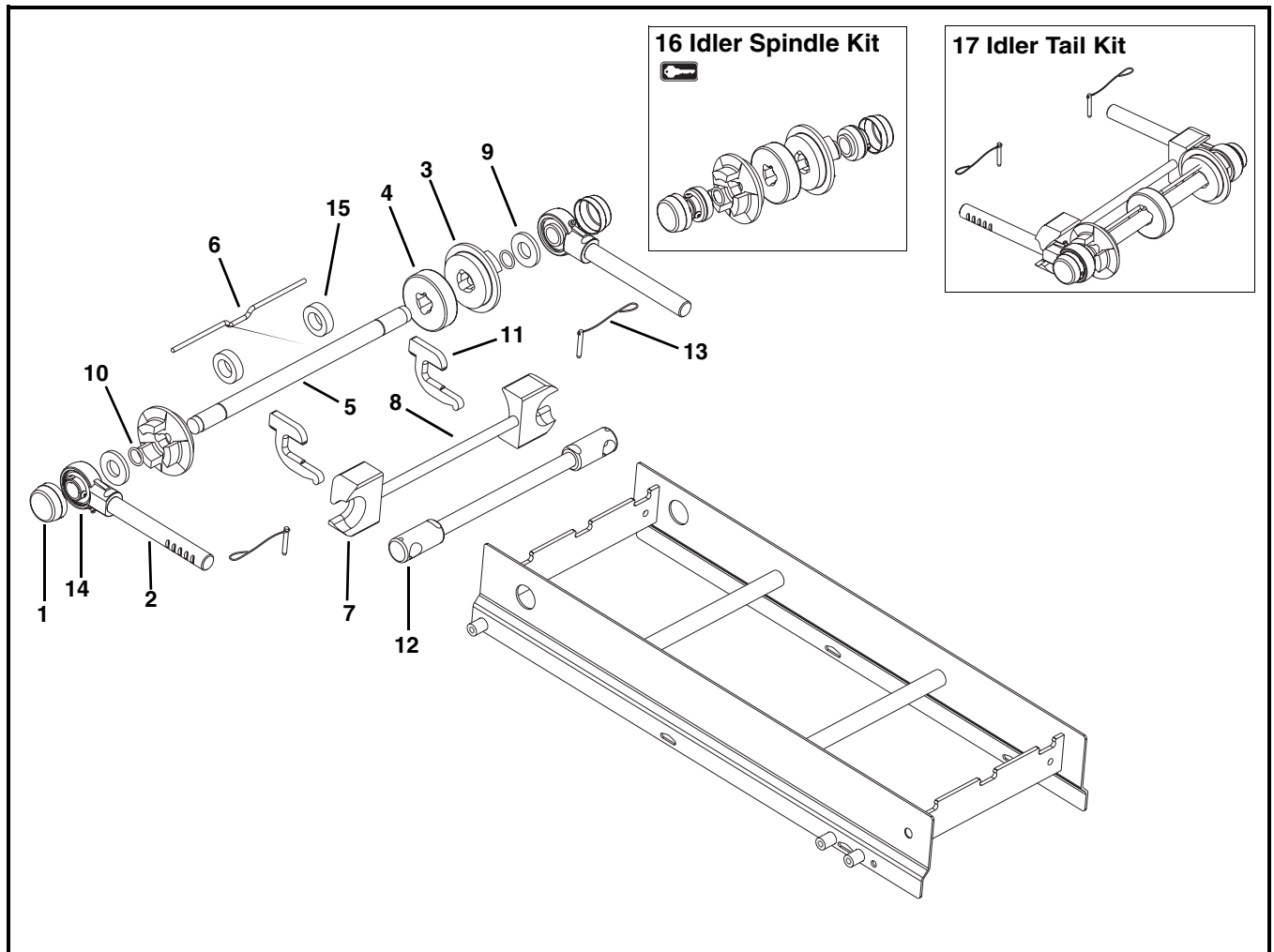

| Item | Part Number | Description  |
|------|-------------|--|
| 1    | 807-1454    | Bearing Cover  |
| 2    | 500079      | Shaft Assembly with Bearing                          |
| 3    | 5172WW      | Flanged Puck, Idler Tail for Standard Belt           |
|      | 5173WW      | Flanged Puck, Idler Tail for Specialty Intralox Belt |
| 4    | 501189      | Idler Puck   |
| 5    | 5156WW      | Idler Shaft  |
| 6    | 5157WW      | Bent Retaining Bar for Standard Belt                 |
|      | 5167WW      | Bent Retaining Bar for Specialty Intralox Belt       |
| 7    | 501188      | Guard Bar  |
| 8    | 5154WW      | Guard Bar Shaft                                      |
| 9    | 501381      | Washer   |
| 10   | 807-1588    | O-Ring   |

| Item | Part Number | Description   |
|------|-------------|---|
| 11   | 501184      | Key Stop  |
| 12   | 5182WW      | Tip Up Shaft Assembly   |
| 13   | 501676      | Pin Assembly  |
| 14   | 802-162     | Bearing   |
| 15   | 501681      | Idler Shaft Sleeve  |
| 16   | 74UI-WW     | Idler Spindle Kit for Standard Belt (Includes Items 1, 3, 4, 10 and 14)             |
|      | 74UIS-WW    | Idler Spindle Kit for Specialty Intralox Belt (Includes Items 1, 3, 4, 10 and 14)   |
| 17   | 74UIT-WW    | Idler Tail Kit for Standard Belt (Includes Items 1 through 10, 13 and 14)           |
|      | 74UIT-S-WW  | Idler Tail Kit for Specialty Intralox Belt (Includes Items 1 through 10, 13 and 14) |

WW = Conveyor width ref: 06 - 36 in 02 increments

# Service Parts

## Upper Knuckle for 5° - 15°

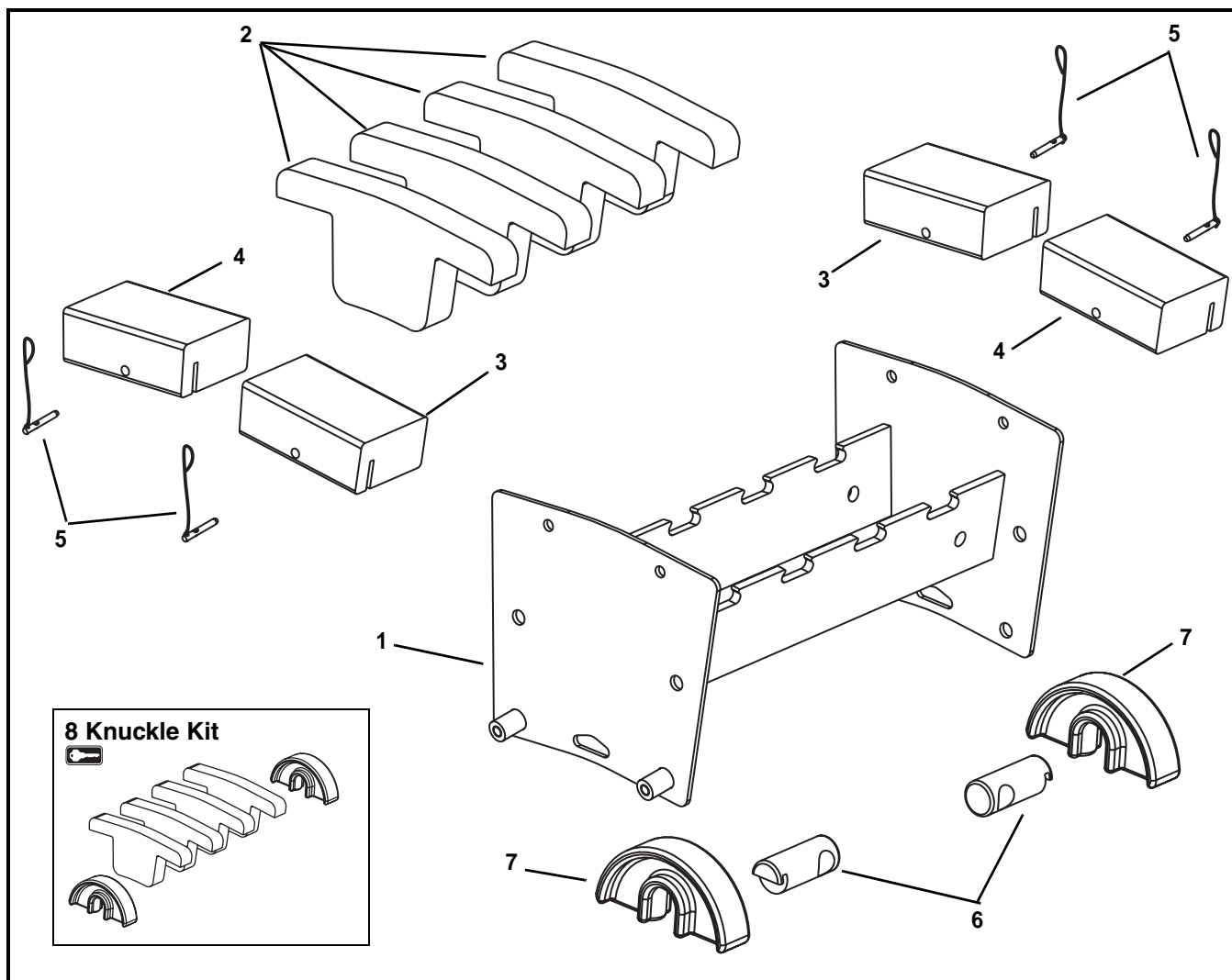

| Item | Part Number       | Description   |
|------|-------------------|---|
| 1    | 5236 <u>WW</u>    | Frame Assembly for 5° Knuckle                                     |
|      | 5237 <u>WW</u>    | Frame Assembly for 10° Knuckle                                    |
|      | 5238 <u>WW</u>    | Frame Assembly for 15° Knuckle                                    |
| 2    | 501695- <u>AA</u> | Wear Strips for 5° - 15° Knuckle                                  |
| 3    | 501893- <u>AA</u> | 1.5" Hold Down Guide for 5° - 15° Knuckle Right Hand 6"-16" wide  |
|      | 501685- <u>AA</u> | 1.5" Hold Down Guide for 5° - 15° Knuckle Right Hand 18"-24" wide |
|      | 501883- <u>AA</u> | 3" Hold Down Guide for 5° - 15° Knuckle Right Hand 6"-16" wide    |
|      | 501684- <u>AA</u> | 3" Hold Down Guide for 5° - 15° Knuckle Right Hand 18"-24" wide   |

| Item | Part Number                  | Description  |
|------|------------------------------|--|
| 4    | 501699- <u>AA</u>            | 1.5" Hold Down Guide for 5° - 15° Knuckle Left Hand 6"-16" wide  |
|      | 501687- <u>AA</u>            | 1.5" Hold Down Guide for 5° - 15° Knuckle Left Hand 18"-24" wide |
|      | 501698- <u>AA</u>            | 3" Hold Down Guide for 5° - 15° Knuckle Left Hand 6"-16" wide    |
|      | 501686- <u>AA</u>            | 3" Hold Down Guide for 5° - 15° Knuckle Left Hand 18"-24" wide   |
| 5    | 501676                       | Pull Pin   |
| 6    | 500196                       | Return Shaft   |
| 7    | 500075                       | Return Shoe  |
| 8    | 74UKL- <u>WW</u> - <u>AA</u> | Upper Knuckle Kit (Includes Items 2 and 7)                       |
|      |                              | <u>WW</u> = Conveyor width ref: 06 - 24 in 02 increments         |
|      |                              | <u>AA</u> = Angle 05, 10 or 15                                   |

Upper Knuckle for 30°

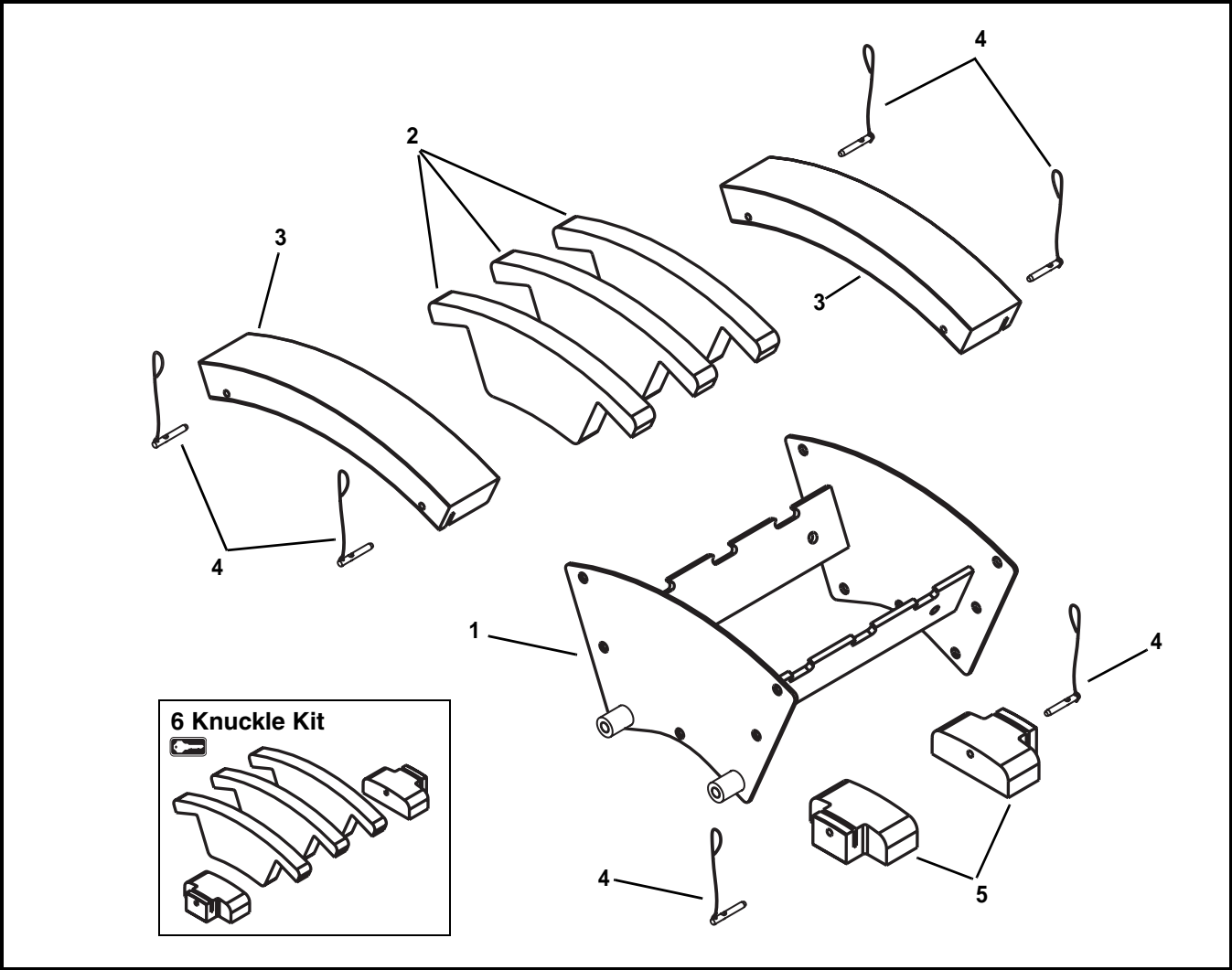

| Item | Part Number | Description                          |
|------|-------------|--------------------------------------|
| 1    | 5239WW      | Frame Assembly for 30° Knuckle       |
| 2    | 501693-30   | Wear Strips for 30° Knuckle          |
| 3    | 501697-30   | 1.5" Hold Down Guide for 30° Knuckle |
|      | 501879-30   | 3" Hold Down Guide for 30° Knuckle   |

| Item  | Part Number | Description                                |
|---|-------------|--|
| 4   | 807-1553    | Pull Pin                                   |
| 5   | 501683      | Return Guide                               |
| 6   | 74UKH-WW-30 | Upper Knuckle Kit (Includes Items 2 and 5) |
| WW = Conveyor width ref: 06 - 24 in 02 increments |             |  |

# Service Parts

## Lower Knuckle for 5° - 15°

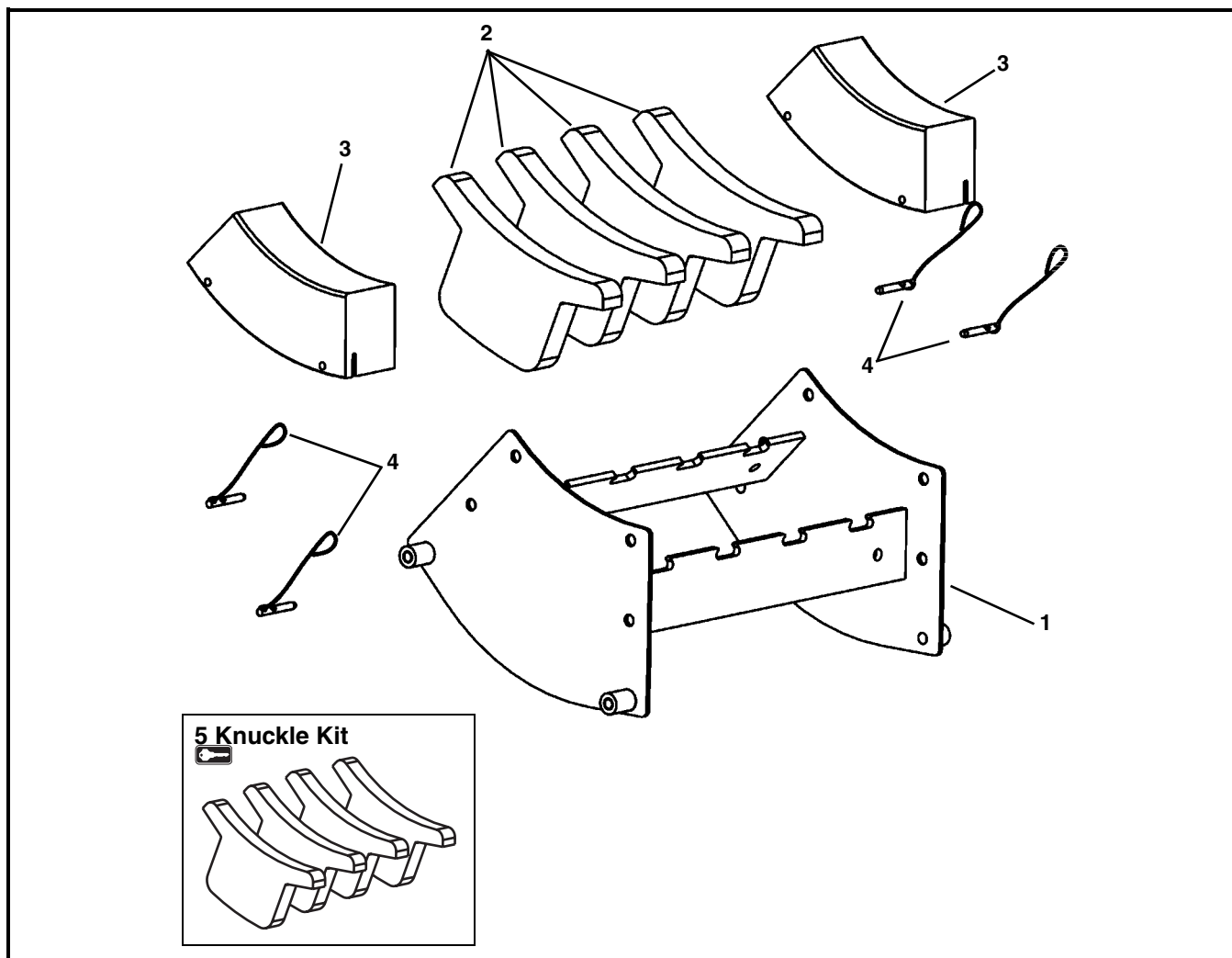

| Item | Part Number       | Description  |
|------|-------------------|--|
| 1    | 5230 <u>WW</u>    | Frame Assembly for 5° Knuckle                          |
|      | 5231 <u>WW</u>    | Frame Assembly for 10° Knuckle                         |
|      | 5232 <u>WW</u>    | Frame Assembly for 15° Knuckle                         |
| 2    | 501694- <u>AA</u> | Wear Strips for 5° - 15° Knuckle                       |
| 3    | 501692- <u>AA</u> | 1.5" Hold Down Guide for 5° - 15° Knuckle 6"-16" wide  |
|      | 501974- <u>AA</u> | 1.5" Hold Down Guide for 5° - 15° Knuckle 18"-24" wide |
|      | 501878- <u>AA</u> | 3" Hold Down Guide for 5° - 15° Knuckle 6"-16" wide    |
|      | 501973- <u>AA</u> | 3" Hold Down Guide for 5° - 15° Knuckle 18"-24" wide   |

| Item   | Part Number                  | Description                         |
|--|------------------------------|-------------------------------------|
| 4  | 501676                       | Pull Pin                            |
| 5  | 74LKL- <u>WW</u> - <u>AA</u> | Lower Knuckle Kit (Includes Item 2) |
| <u>WW</u> = Conveyor width ref: 06 - 24 in 02 increments |                              |                                     |
| <u>AA</u> = Angle 05, 10 or 15                           |                              |                                     |



Lower Knuckle for 30°

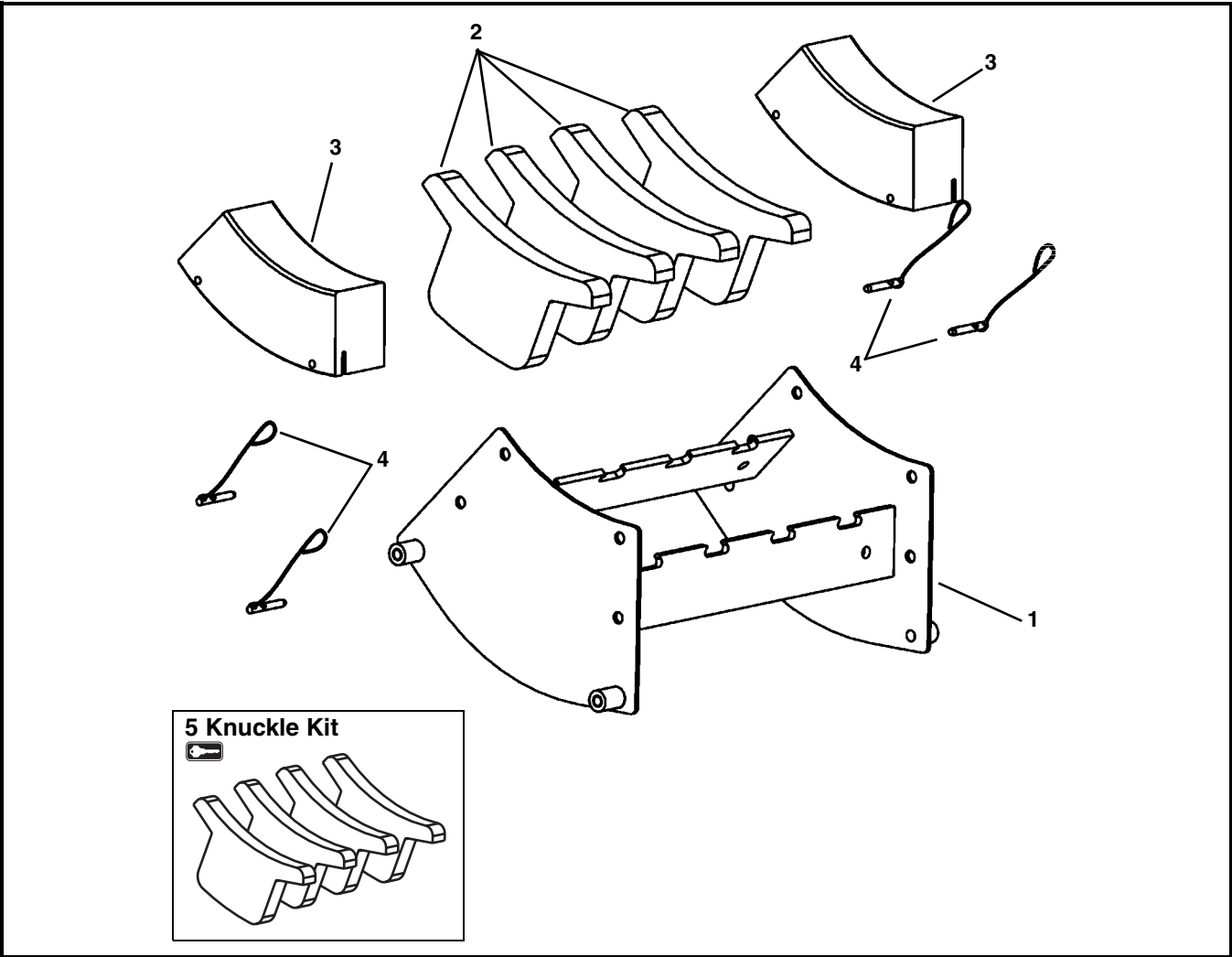

| Item | Part Number | Description                          |
|------|-------------|--------------------------------------|
| 1    | 5233WW      | Frame Assembly for 30° Knuckle       |
| 2    | 501691-30   | Wear Strips for 30° Knuckle          |
| 3    | 501692-30   | 1.5" Hold Down Guide for 30° Knuckle |
|      | 501878-30   | 3" Hold Down Guide for 30° Knuckle   |

| Item  | Part Number | Description                            |
|---|-------------|--|
| 4   | 501676      | Pin Assembly                           |
| 5   | 74LKH-WW-30 | Lower Knuckle Kit<br>(Includes Item 2) |
| WW = Conveyor width ref: 06 - 24 in 02 increments |             |  |

# Service Parts

## Conveyor Frame and Extension

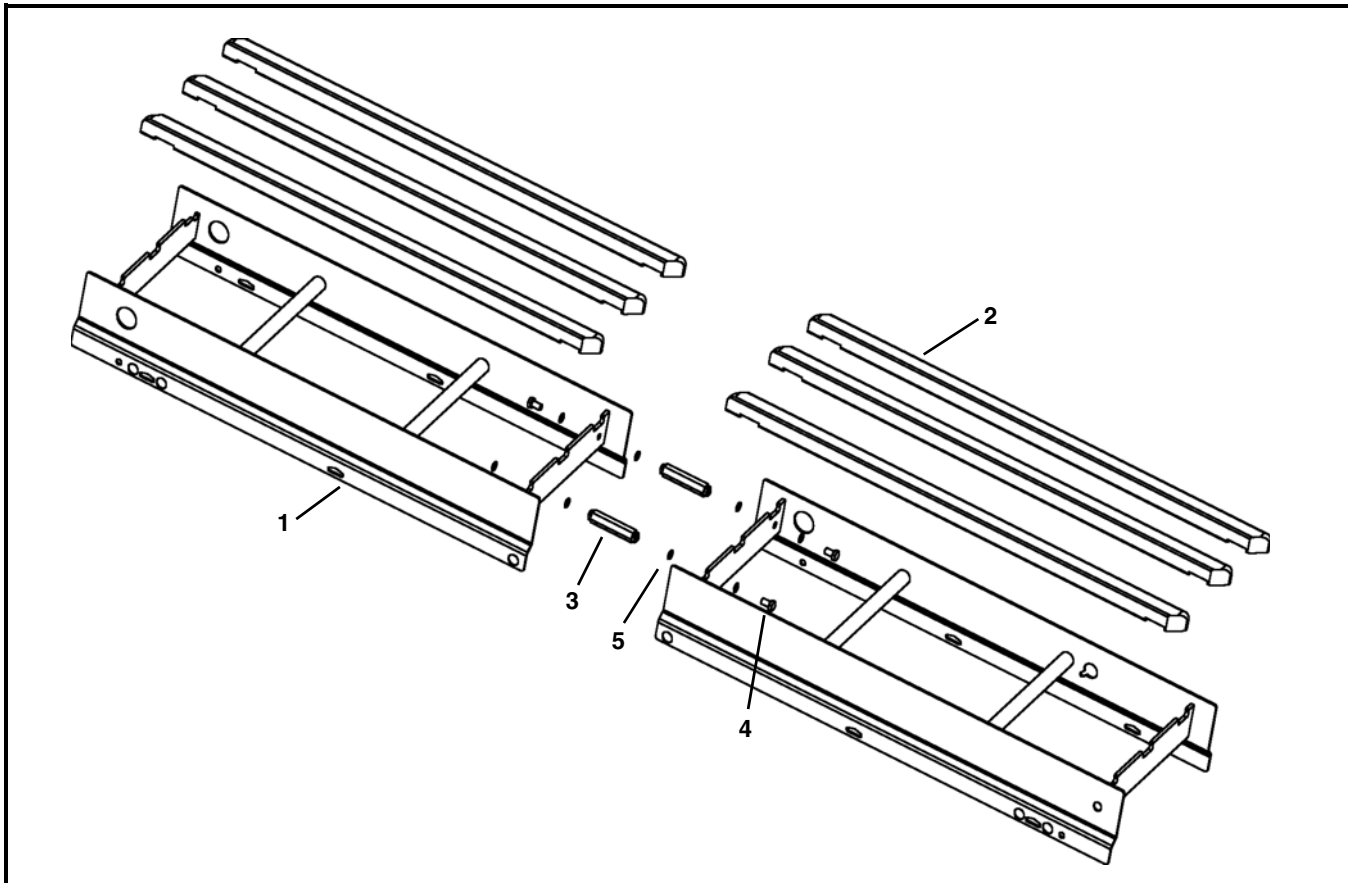

| Item | Part Number        | Description                           |
|------|--------------------|---------------------------------------|
| 1    | -----              | Consult Factory for Frame Part Number |
| 2    | 501800- <u>LLL</u> | Straight Wear Strip                   |
| 3    | 501190             | Hex Post Connector                    |
| 4    | 961016MSS          | Hex Head Cap Screw M10-1.5 x 16mm     |
| 5    | 807-1616           | O-Ring                                |

LLL = Conveyor length ref: 036 - 999 in 001 increments

|                     |    | Wear Strip Quantity (Item 2)   |         |         |         |         |         |         |         |
|---------------------|----|--------------------------------|---------|---------|---------|---------|---------|---------|---------|
|                     |    | Conveyor Length ( <u>LLL</u> ) |         |         |         |         |         |         |         |
|                     |    | 036-132                        | 133-252 | 253-372 | 373-492 | 493-612 | 613-732 | 733-852 | 853-999 |
| Conveyor Width (WW) | 06 | 2                              | 4       | 6       | 8       | 10      | 12      | 14      | 16      |
|                     | 08 | 2                              | 4       | 6       | 8       | 10      | 12      | 14      | 16      |
|                     | 10 | 3                              | 6       | 9       | 12      | 15      | 18      | 21      | 24      |
|                     | 12 | 3                              | 6       | 9       | 12      | 15      | 18      | 21      | 24      |
|                     | 14 | 3                              | 6       | 9       | 12      | 15      | 18      | 21      | 24      |
|                     | 16 | 4                              | 8       | 12      | 16      | 20      | 24      | 28      | 32      |
|                     | 18 | 4                              | 8       | 12      | 16      | 20      | 24      | 28      | 32      |
|                     | 20 | 5                              | 10      | 15      | 20      | 25      | 30      | 35      | 40      |
|                     | 22 | 5                              | 10      | 15      | 20      | 25      | 30      | 35      | 40      |
|                     | 24 | 5                              | 10      | 15      | 20      | 25      | 30      | 35      | 40      |
|                     | 26 | 6                              | 12      | 18      | 24      | 30      | 36      | 42      | 48      |
|                     | 28 | 6                              | 12      | 18      | 24      | 30      | 36      | 42      | 48      |
|                     | 30 | 6                              | 12      | 18      | 24      | 30      | 36      | 42      | 48      |
|                     | 32 | 7                              | 14      | 21      | 28      | 35      | 42      | 49      | 56      |
|                     | 34 | 7                              | 14      | 21      | 28      | 35      | 42      | 49      | 56      |
|                     | 36 | 8                              | 16      | 24      | 32      | 40      | 48      | 56      | 64      |

3" (76 mm) High Sides

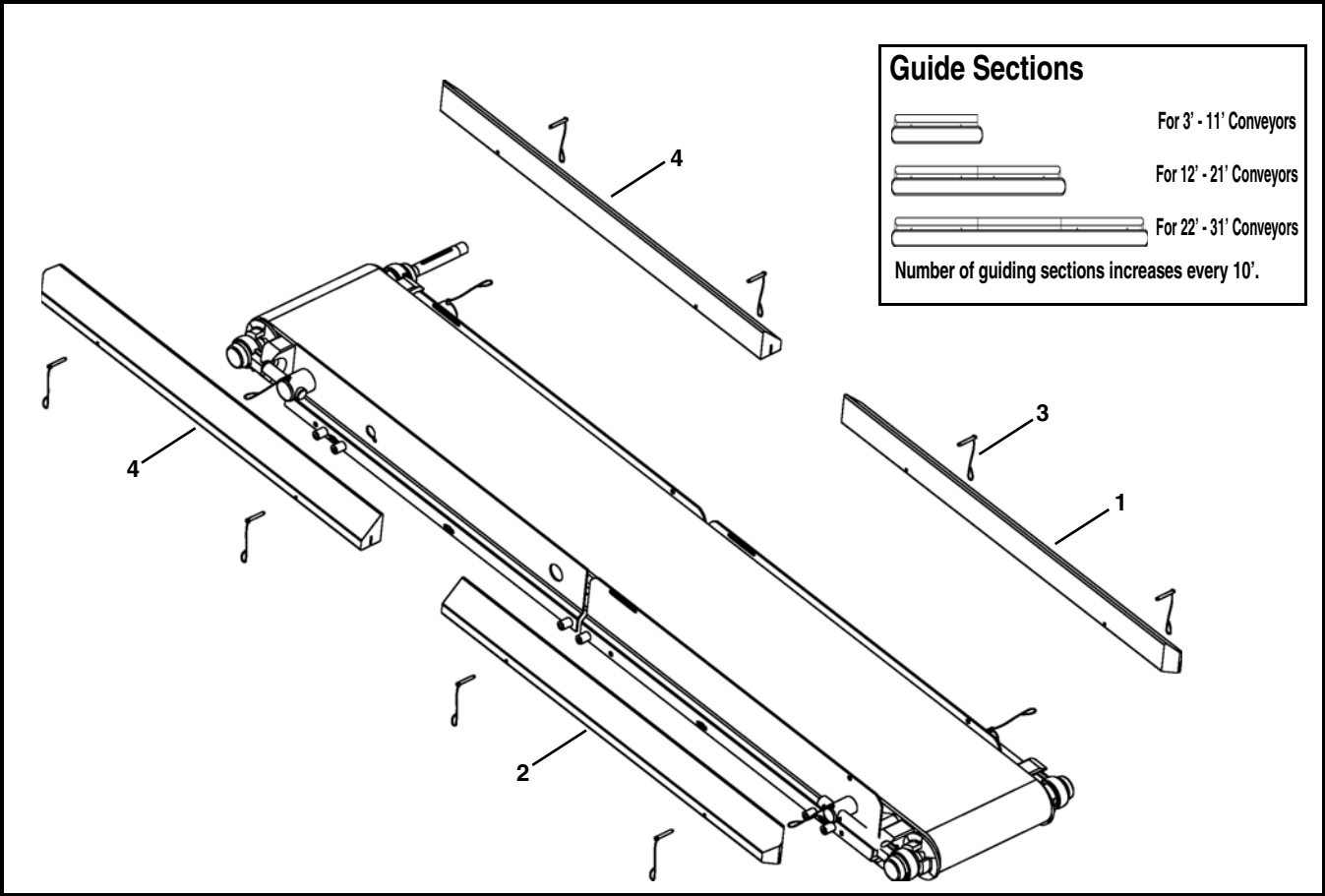

| Item | Part Number          | Description                |
|------|----------------------|----------------------------|
| 1    | 503501- <u>LLLLL</u> | Right Hand High Side Guide |
| 2    | 503601- <u>LLLLL</u> | Left Hand High Side Guide  |
| 3    | 501676               | Pin Assembly               |

| Item   | Part Number          | Description                |
|--|----------------------|----------------------------|
| 4  | 503401- <u>LLLLL</u> | Square End High Side Guide |
| <u>LLLLL</u> = Guide Length in inches with 2 decimal places. |                      |                            |
| Example: Guide Length = 95.25" <u>LLLLL</u> = 09525          |                      |                            |

# Service Parts

## Flat Belt Returns

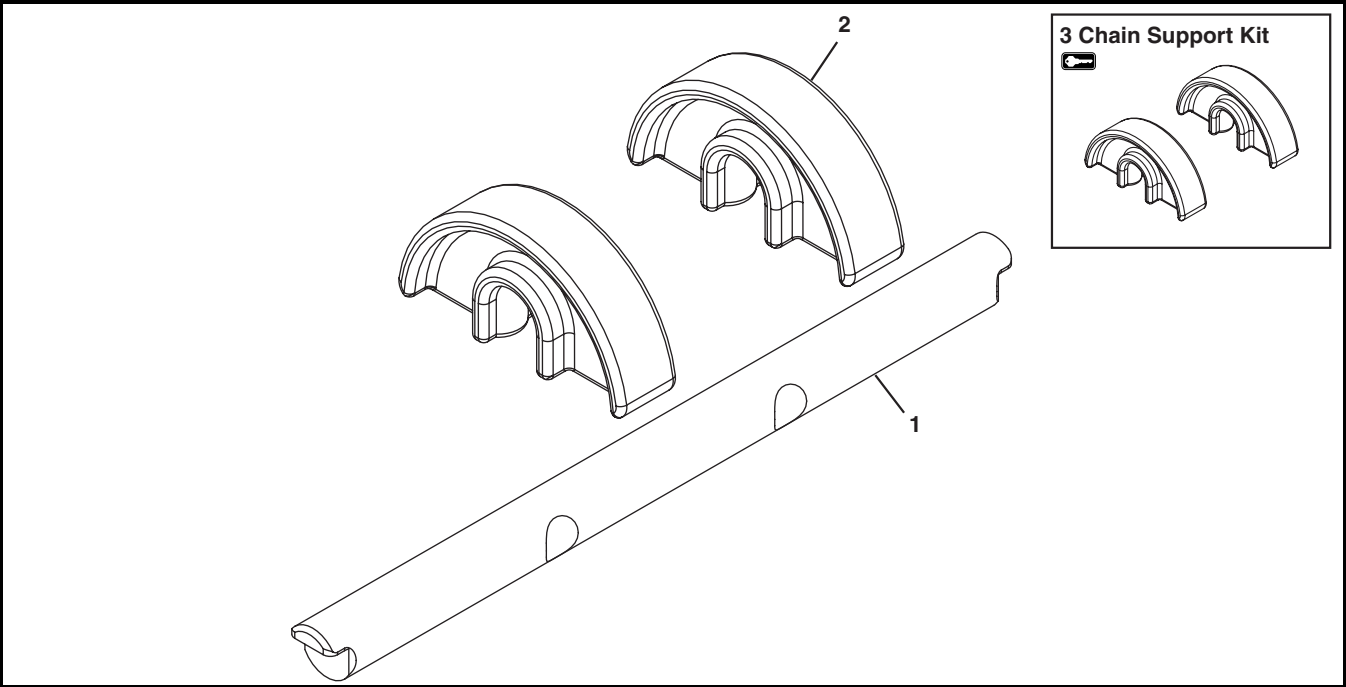

| Item | Part Number    | Description       |
|------|----------------|-------------------|
| 1    | 5032 <u>WW</u> | Return Shaft      |
| 2    | 500075         | Chain Return Shoe |

| Item   | Part Number    | Description                          |
|--|----------------|--------------------------------------|
| 3  | 74R- <u>WW</u> | Chain Support Kit ( Includes Item 2) |
| <u>WW</u> = Conveyor width ref: 06 - 36 in 02 increments |                |                                      |

## Flat Belt Chain Repair Kit

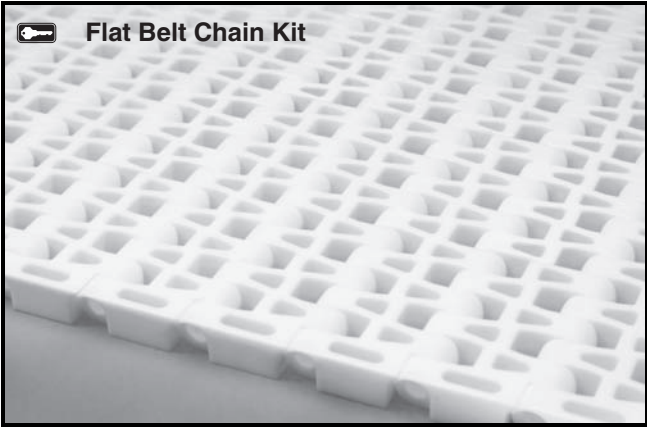

| Item   | Part Number              | Description  |
|--|--------------------------|--|
| 1  | 74 <u>BB</u> - <u>WW</u> | Flat Belt Chain Repair Kit (Includes 1 ft (305 mm) of flat belt chain and assembly pins) |
| <u>BB</u> = Chain Reference Number                       |                          |  |
| <u>WW</u> = Conveyor width ref: 06 - 36 in 02 increments |                          |  |

## Belt Removal Tool

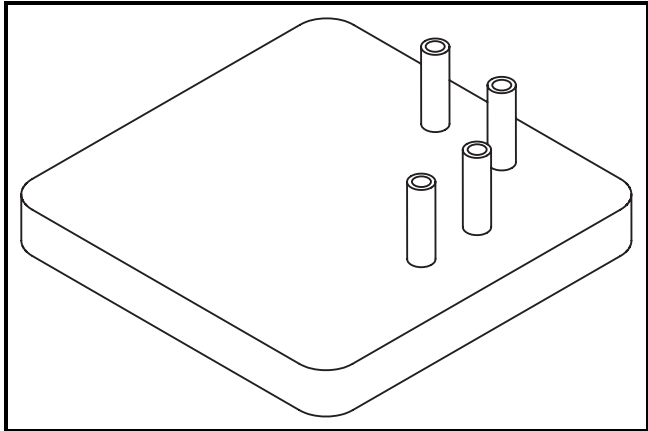

| Item | Part Number | Description                                     |
|------|-------------|---|
| 1    | 500582      | Tool Rod Removal for 1" Pitch Flush Grid Belt   |
|      | 500494      | Tool Rod Removal for 1/2" Pitch Flush Grid Belt |

## Ordering a Replacement Chain

Determine the length of chain required for the conveyor and round up to the nearest foot length. Order the proper number of chain repair kits (1' long each) for your conveyor. Dorner will ship chain kits that are of a reasonable length fully assembled.

### Example:

Overall chain length = 42' 5" (rounded up = 43')

Order: Qty (43) of 74BB-WW

BB = Chain reference number

WW = Conveyor width ref: 06 - 36 in 02 increments

## Configuring a Conveyor Part Number

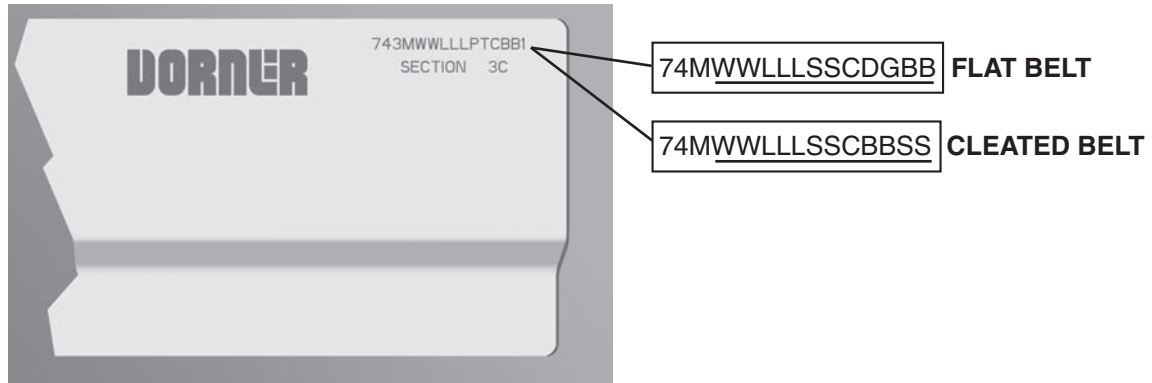

**Figure 79**

## Flat Belt Conveyor

Refer to the model number on the conveyor frame (**Figure 79**). From the model number, determine conveyor width (WW), length (LLL), drive stand location (S), idler stand location (S), cleaning options (C), drive/pulley type (D), profile (G) and belt material (BB).

### Example:

**74M12072CC1NA10**

7400 Series end drive, cleated belt conveyor, 12" (305mm) wide x 72" (1829mm) long, stands located 18" (457mm) from each end, frame cutout cleaning option, NA cleated belt material, side drive with standard pulleys on each end, and 10 link spacing for cleats.



# Return Policy

Returns must have prior written factory authorization or they will not be accepted. Items that are returned to Dorner without authorization will not be credited nor returned to the original sender. When calling for authorization, please have the following information ready for the Dorner factory representative or your local distributor:

1. Name and address of customer.
2. Dorner part number(s) of item(s) being returned.
3. Reason for return.
4. Customer's original order number used when ordering the item(s).
5. Dorner or distributor invoice number.

A representative will discuss action to be taken on the returned items and provide a Returned Goods Authorization number for reference.

There will be a return charge on all new undamaged items returned for credit where Dorner was not at fault. Dorner is not responsible for return freight on such items.

## **Conveyors and conveyor accessories**

|  |                      |
|--|----------------------|
| Standard catalog conveyors                       | 30%                  |
| MPB Series, cleated and specialty belt conveyors | 50%                  |
| 7400 & 7600 Series conveyors                     | non-returnable items |
| Engineered special products                      | case by case         |
| Drives and accessories                           | 30%                  |
| Sanitary stand supports                          | non-returnable items |

## **Parts**

|                                  |                      |
|----------------------------------|----------------------|
| Standard stock parts             | 30%                  |
| MPB, cleated and specialty belts | non-returnable items |

Returns will not be accepted after 60 days from original invoice date.

The return charge covers inspection, cleaning, disassembly, disposal and reissuing of components to inventory.

If a replacement is needed prior to evaluation of returned item, a purchase order must be issued. Credit (if any) is issued only after return and evaluation is complete.

Dorner has representatives throughout the world. Contact Dorner for the name of your local representative. Our Technical Sales, Catalog Sales and Service Teams will gladly help with your questions on Dorner products.

For a copy of Dorner's Warranty, contact factory, distributor, service center or visit our website at [www.dorner.com](http://www.dorner.com).

For replacement parts, contact an authorized Dorner Service Center or the factory.



Dorner Mfg. Corp. reserves the right to change or discontinue products without notice. All products and services are covered in accordance with our standard warranty. All rights reserved. © Dorner Mfg. Corp. 2008

**DORNER MFG. CORP.**  
975 Cottonwood Ave., PO Box 20  
Hartland, WI 53029-0020 USA  
USA  
TEL 1-800-397-8664 (USA)  
FAX 1-800-369-2440 (USA)  
Internet: [www.dorner.com](http://www.dorner.com)

Outside the USA:  
TEL 1-262-367-7600  
FAX 1-262-367-5827