

FL
150mm
Conveyor
System

FL

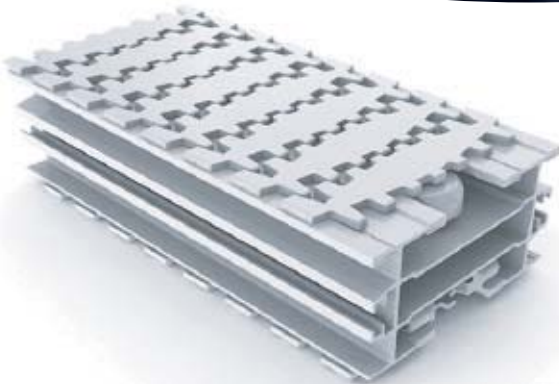

FL SERIES

Variety of chain type suitable for wide range of applications either horizontal or vertically product transportation. Capacity higher than FK, FS, FM. The maximum product width to be conveyed can be referred to guide rail assembly pages.

FL Series Characteristic

Beam Width: 150mm

Product Width: Refer to Guide Rail Assembly

Accessories Needed

Slide Rail Required: FASR-25 OR FASR-25U

Slide Rail Colour: White Or Natural Colour

Slide Rail Material: HDPE OR UHMW

Slide Rail Rivet & Screw: FASLR-4X6 or FASLS-M5

Connecting strip is used to connect 2 beams.

Connecting Strip: FACS-25x140A

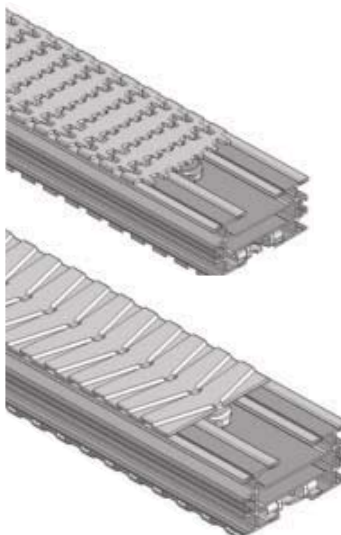
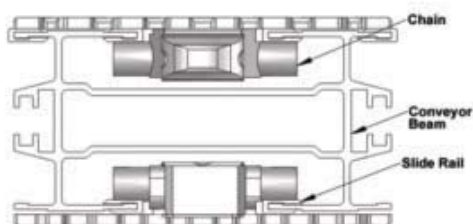

Conveyor Beam **FLCB-3**

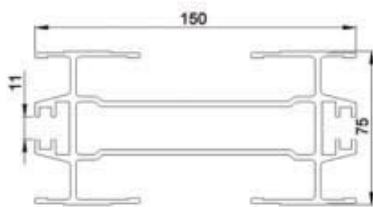

UOM : 3 Meter / Length

Chain Connecting Module **FLCC-160**

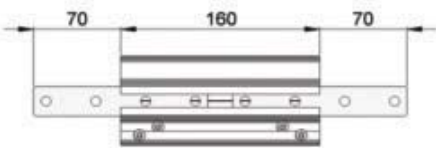

UOM: pc

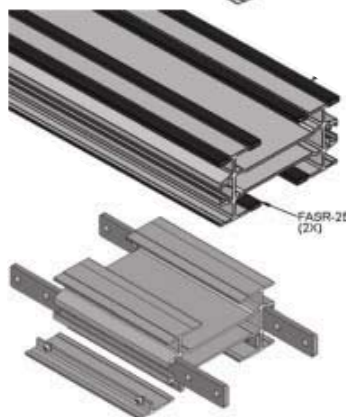

Chain Common Data

Packaging: 5m per box

Pitch: 35.5mm

Width: 150mm

Tensile Strength at 20°C: 6000N

Colour: White & Black (Conductive)

Material :-

Chain: White Acetal / POM

Pivot: Polyamide

Pivot Pin: Stainless Steel

Insert (Wedge & Friction): TPE Grey

Example for FLRC-5B-L#

= 1 cleated top chain with alternate of # link of plain chain



The above chain is FLRC-5B-L1, 1 link cleated top chain with alternate of 1 link of plain chain.

Note: # = 1, 2, 3, 4, 5.....20

Standard Plain Chain FLPC-5

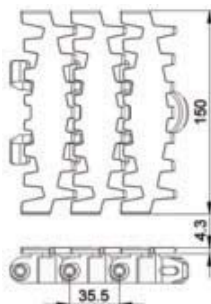

UOM: 5 Meter / box

Application: Suitable for horizontal and slope < 5° transport of products with accumulation.

Conductive Chain FLPC-5CD

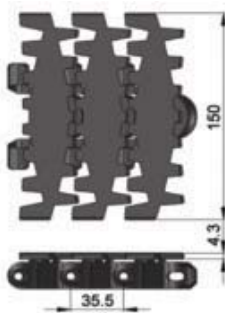

UOM: 5 Meter / box

Application: Suitable for transport of static sensitive product.

FL



Conductive Chain FLFT-5

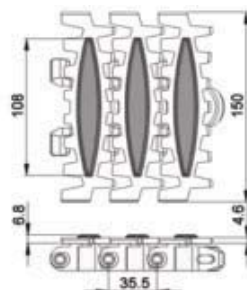

UOM: 5 Meter / box

Application: Suitable for transport product in slope > 5° but ≤ 30° without accumulation.

FL SERIES

Roller Top Chain **FLRT-5V**

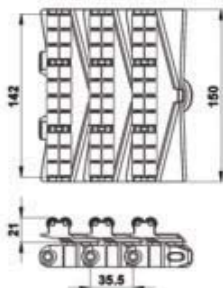
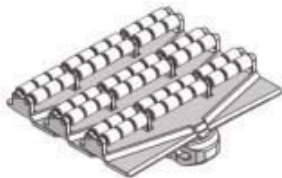

UOM: 5 Meter / box

Application: Suitable for accumulation of product with low friction and pressure..

Roller Cleat Chain **FLRC-5A-L#**

= 1, 2, 3, 4, 5.....20

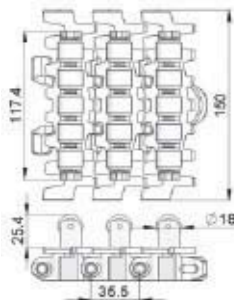
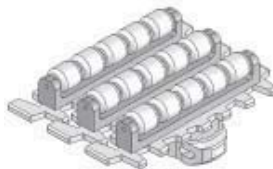

UOM: 5 Meter / box

Application: Suitable for vertical transportation of product in slope with no accumulation.

Roller Cleat Chain **FLRC-5B-L#**

= 1, 2, 3, 4, 5.....20

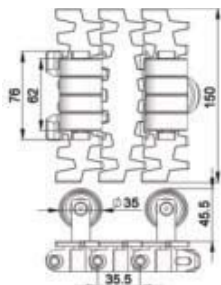
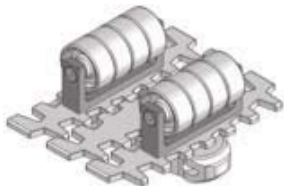

UOM: 5 Meter / box

Application: Suitable for vertical transportation of product in slope with no accumulation.

Cleat Top Chain **FLCT-5A30-L#**

= 1, 2, 3, 4, 5.....20

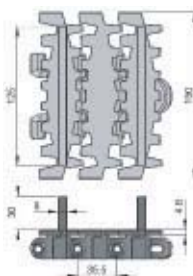
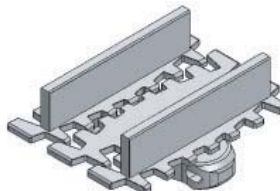

UOM: 5 Meter / box

Application: Suitable for vertical transportation of product in slope with no accumulation.

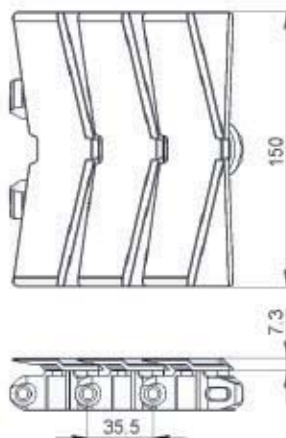
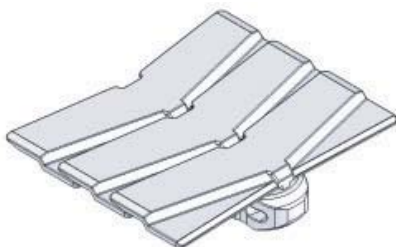
Standard Plain Chain-V FLPC-5V

UOM: 5 Meter / box

Application: (Safety Chain) Suitable for horizontal and slope $< 5^\circ$ transport of products with accumulation.

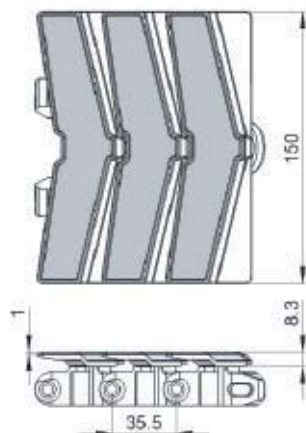
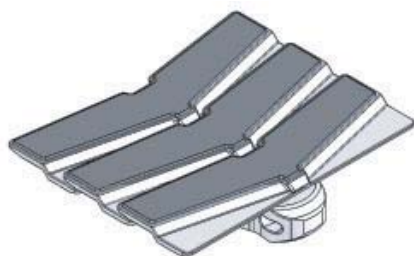
Safety Chain Friction Top FLFT-5V

UOM: 5 Meter / box

Application: (Safety Chain) Suitable for transport product in slope $> 5^\circ$ but $\leq 30^\circ$ without accumulation.

SEW gear motors are products of SEW Eurodrive

FL Direct End Drive with Motor (LEFT)

FLDD-A150-0.25L, 0.37L, 0.55L

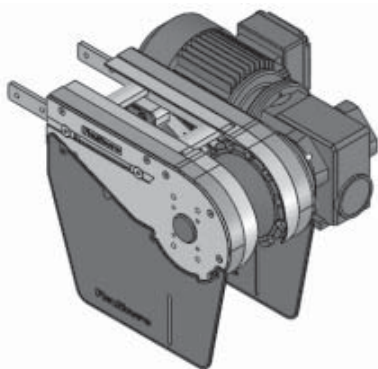
FL Direct End Drive without Motor (LEFT)

FLDD-A150-0L

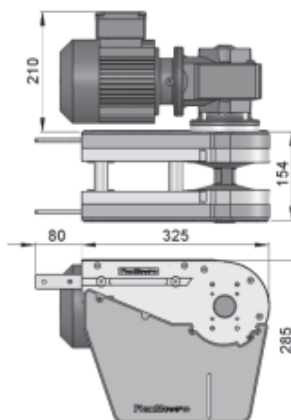

Max Traction Force : 1250N

The Direct End Drive Unit is without torque limiter. Standard attached gear motors are with SEW motor size 0.25kW, 0.37kW & 0.55kW. FLDD-A150-0L represents direct drive without gear motor. Multi channel drives are available upon request.

UOM : pc Chain required 2-way : 0.8 meter Slide rail required 2-way: 0.5 meter

FL
FL Direct End Drive with Motor (RIGHT)

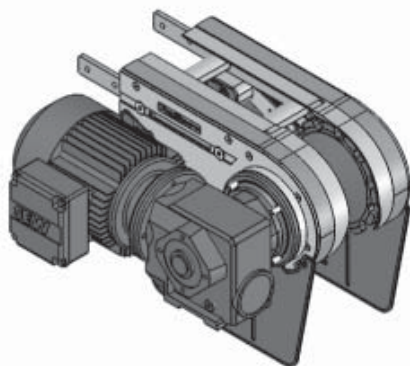
FLDD-A150-0.25R, 0.37R, 0.55R

FL Direct End Drive without Motor (RIGHT)

FLDD-A150-0R

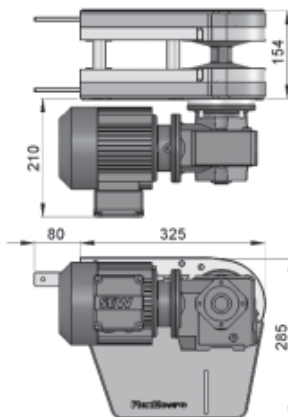
Max Traction Force : 1250N

The Direct End Drive Unit is without torque limiter. Standard attached gear motors are with SEW motor size 0.25kW, 0.37kW & 0.55kW. FLDD-A150-0R represents direct drive without gear motor. Multi channel drives are available upon request.

UOM : pc Chain required 2-way : 0.8 meter Slide rail required 2-way: 0.5 meter

SEW gear motors are products of SEW Eurodrive

FL SERIES

FL Suspended End Drive with Motor (LEFT)

FLSD-A150-0.25L, 0.37L, 0.55L

FL Suspended End Drive without Motor (LEFT)

FLSD-A150-0L

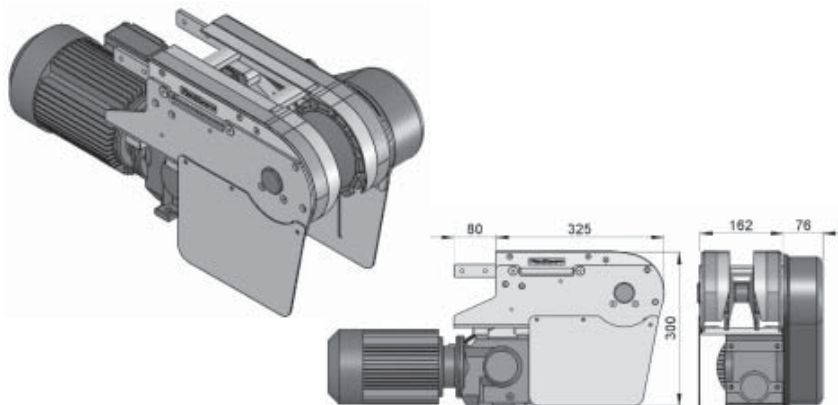

Max Traction Force : 1250N

The Suspended End Drive Unit is with torque limiter. Standard attached gear motors are with SEW motor size 0.25kW, 0.37kW & 0.55kW. FLSD-A150-0L represents suspended drive without gear motor.

UOM : pc Chain required 2-way : 0.8 meter Slide rail required 2-way: 0.5 meter

FL Suspended End Drive with Motor (RIGHT)

FLSD-A150-0.25R, 0.37R, 0.55R

FL Suspended End Drive without Motor (RIGHT)

FLSD-A150-0R

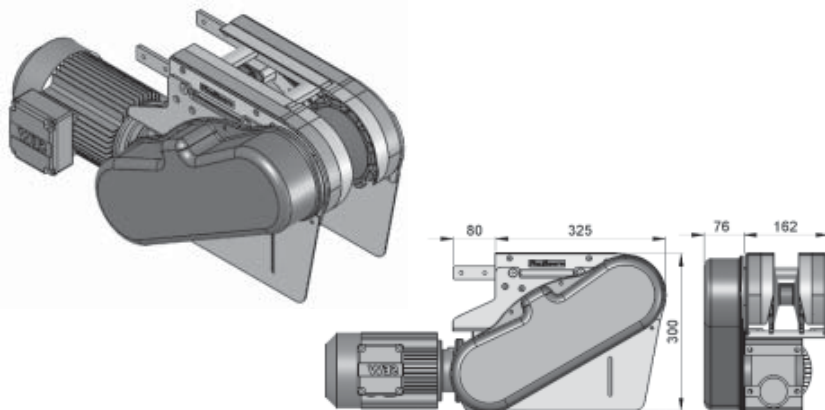

Max Traction Force : 1250N

The Suspended End Drive Unit is with torque limiter. Standard attached gear motors are with SEW motor size 0.25kW, 0.37kW & 0.55kW. FLSD-A150-0R represents suspended drive without gear motor.

UOM : pc Chain required 2-way : 0.8 meter Slide rail required 2-way: 0.5 meter

SEW gear motors are products of SEW Eurodrive

FL Combined Direct Drive & Idler (LEFT)

FLCDI-DD-0.25L1, 0.37L1, 0.55L1

FLCDI-DD-0L1

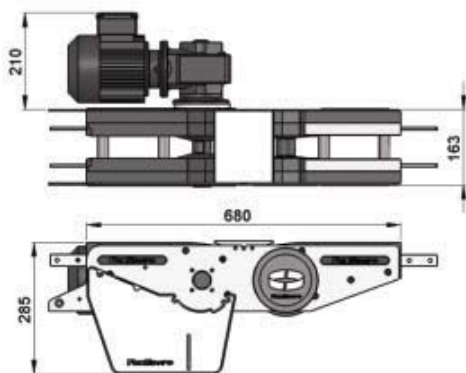
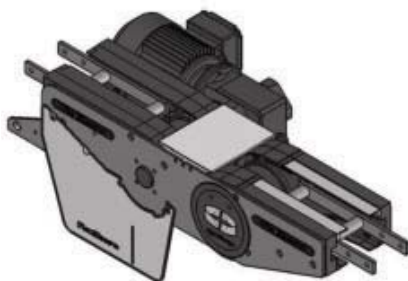
Max Traction Force : 1250N

The Combine Direct End Drive Unit is without torque limiter. Standard attached gear motors are with SEW motor size 0.25kW, 0.37kW & 0.55kW. FLCDI-DD-0L1 represents direct drive without gear motor.

UOM : pc Chain required 2-way : 1.6 meter Slide rail required 2-way: 1.0 meter

FL
FL Combined Direct Drive & Idler (RIGHT)

FLCDI-DD-0.25R1, 0.37R1, 0.55R1

FLCDI-DD-0R1

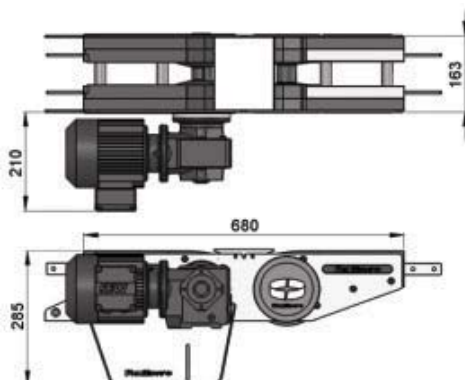
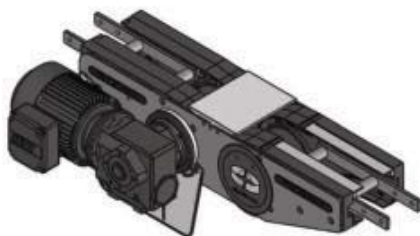
Max Traction Force : 1250N

The Combine Direct End Drive Unit is without torque limiter. Standard attached gear motors are with SEW motor size 0.25kW, 0.37kW & 0.55kW. FLCDI-DD-0R1 represents direct drive without gear motor.

UOM : pc Chain required 2-way : 1.6 meter Slide rail required 2-way: 1.0 meter

SEW gear motors are products of SEW Eurodrive

FL SERIES

FL Combined Suspended Drive & Idler (LEFT)

FLCDI-SD-0.25L1, 0.37L1, 0.55L1

FLCDI-SD-0L1



Max Traction Force : 1250N

The Combine Suspended End Drive Unit is with torque limiter. Standard attached gear motors are with SEW motor size 0.25kW, 0.37kW & 0.55kW. FLCDI-SD-0L1 represents suspended drive without gear motor.

UOM : pc Chain required 2-way : 1.6 meter Slide rail required 2-way: 1.0 meter

FL Combined Suspended Drive & Idler (RIGHT)

FLCDI-SD-0.25R1, 0.37R1, 0.55R1

FLCDI-SD-0R1



Max Traction Force : 1250N

The Combine Suspended End Drive Unit is with torque limiter. Standard attached gear motors are with SEW motor size 0.25kW, 0.37kW & 0.55kW. FLCDI-SD-0R1 represents direct drive without gear motor.

UOM : pc Chain required 2-way : 1.6 meter Slide rail required 2-way: 1.0 meter

SEW gear motors are products of SEW Eurodrive

FL Idler End-150

FLIE-A150

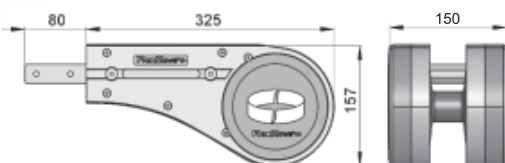
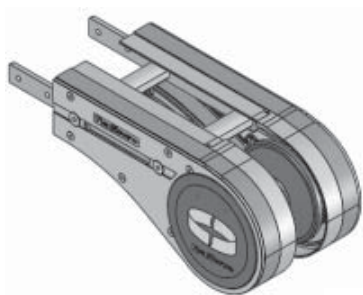

UOM : pc Chain required 2-way : 0.8 meter Slide rail required 2-way: 0.5 meter

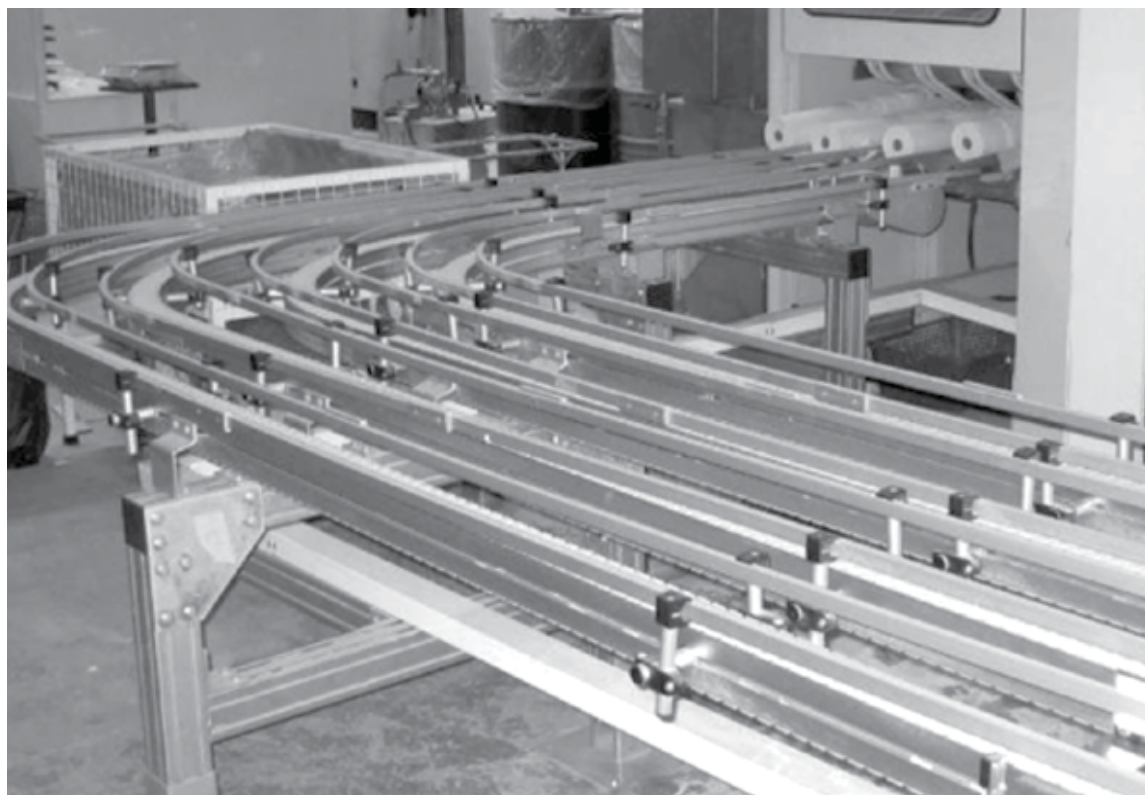

FL SERIES

FL Wheel Bend 180°

FLWB-180R210A

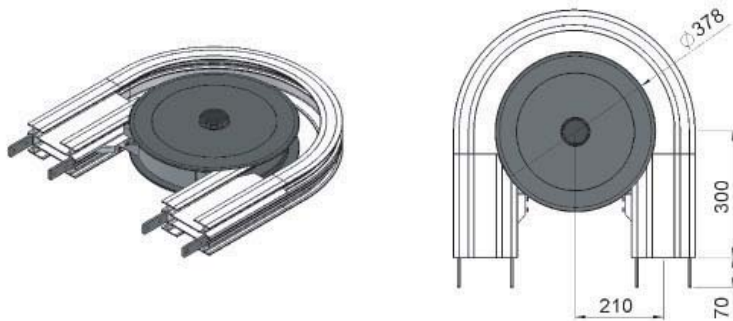

UOM : pc Chain required 2-way : 2.2 meter Slide rail required 2-way: 4.2 meter

FL Wheel Bend 90°

FLWB-90R210A

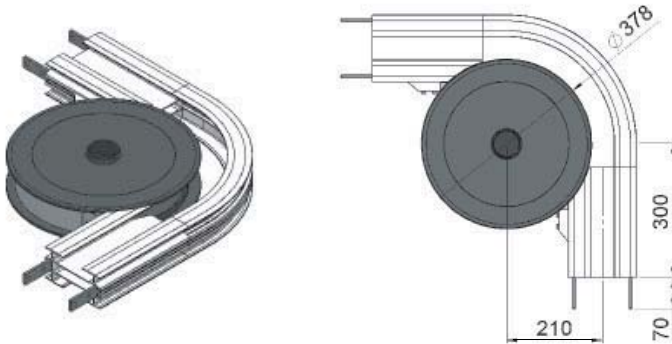

UOM : pc Chain required 2-way : 1.5 meter Slide rail required 2-way: 3.0 meter

FL Wheel Bend 60°

FLWB-60R210A

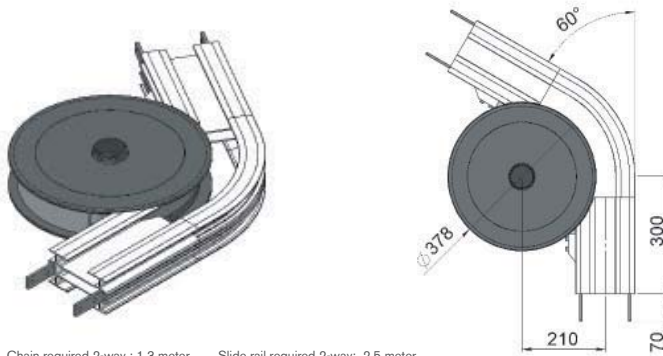

UOM : pc Chain required 2-way : 1.3 meter Slide rail required 2-way: 2.5 meter

FL Wheel Bend 45°

FLWB-45R210A

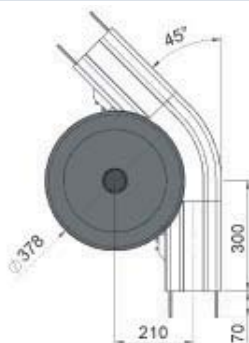
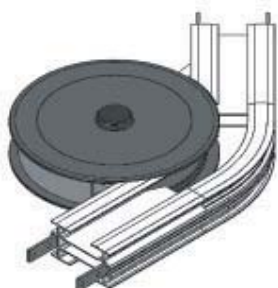

UOM : pc Chain required 2-way : 1.4 meter Slide rail required 2-way: 2.6 meter

FL Wheel Bend 30°

FLWB-30R210A

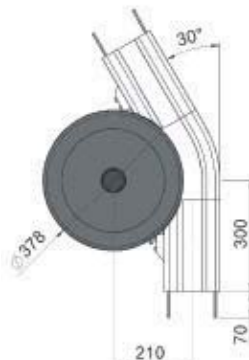
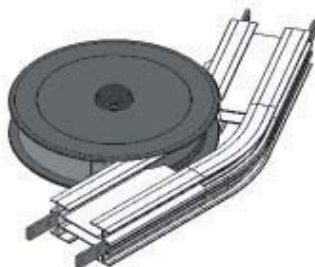

UOM : pc Chain required 2-way : 1.1 meter Slide rail required 2-way: 2.1 meter

FL Wheel Bend 5° - 180°

Example for FL Wheel Bend Ordering

- Wheel bend, $\varnothing^\circ \pm 1^\circ$
- FLWB- \varnothing° R210A

If an angle of 65° is needed for wheel bend,
so the ordering part number is

FLWB-65R210A

The outer bend is assembled using connecting strip (FACS-25x140A). Angle of \varnothing° must be indicated when ordering.

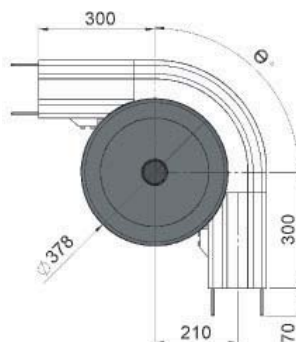

FL SERIES

FL Horizontal Plain Bend 15°



UOM : pc

Chain required 2-way (500, 700, 1000) : 1.1, 1.2, 1.4 meter
Slide rail required 2-way (500, 700, 1000): 2.2, 2.4, 2.8 meter

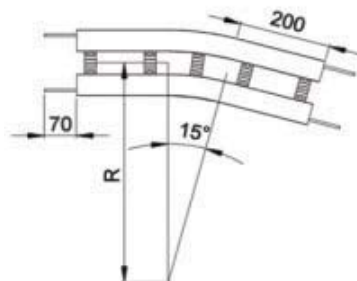

Horizontal plain bend, 15° ± 1°

R = 500 ± 10mm	FLHB-15R500
R = 700 ± 10mm	FLHB-15R700
R = 1000 ± 10mm	FLHB-15R1000

FL Horizontal Plain Bend 30°



UOM : pc

Chain required 2-way (500, 700, 1000) : 1.4, 1.6, 1.9 meter
Slide rail required 2-way (500, 700, 1000): 2.8, 3.2, 3.8 meter

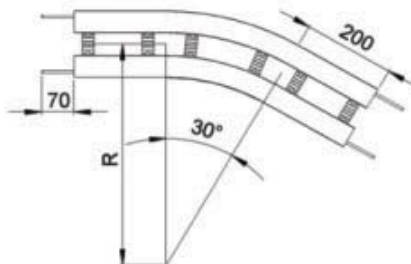

Horizontal plain bend, 30° ± 1°

R = 500 ± 10mm	FLHB-30R500
R = 700 ± 10mm	FLHB-30R700
R = 1000 ± 10mm	FLHB-30R1000

FL Horizontal Plain Bend 45°



UOM : pc

Chain required 2-way (500, 700, 1000) : 1.6, 1.9, 2.4 meter
Slide rail required 2-way (500, 700, 1000): 2.9, 3.3, 3.9 meter

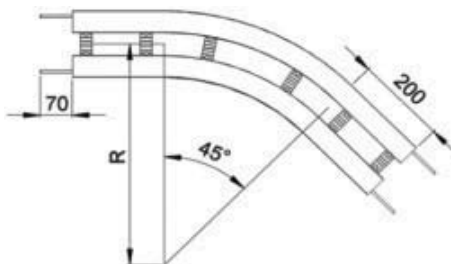

Horizontal plain bend, 45° ± 1°

R = 500 ± 10mm	FLHB-45R500
R = 700 ± 10mm	FLHB-45R700
R = 1000 ± 10mm	FLHB-45R1000

FL Horizontal Plain Bend 60°



UOM : pc

Chain required 2-way (500, 700, 1000) : 1.9, 2.3, 2.9 meter
Slide rail required 2-way (500, 700, 1000): 3.7, 4.6, 5.8 meter

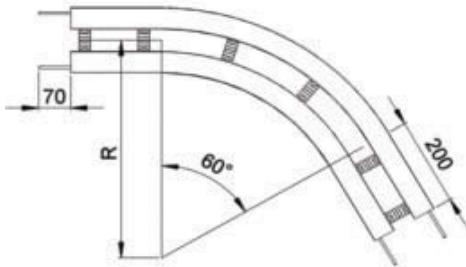

Horizontal plain bend, 60° ± 1°

R = 500 ± 10mm	FLHB-60R500
R = 700 ± 10mm	FLHB-60R700
R = 1000 ± 10mm	FLHB-60R1000

FL Horizontal Plain Bend 90°



UOM : pc

Chain required 2-way (500, 700, 1000) : 2.4, 3.0, 4.0 meter
Slide rail required 2-way (500, 700, 1000): 4.8, 6.0, 8.0 meter

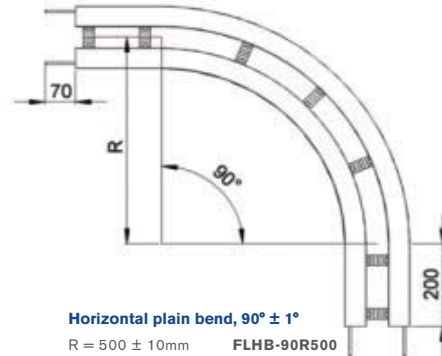

Horizontal plain bend, 90° ± 1°

R = 500 ± 10mm	FLHB-90R500
R = 700 ± 10mm	FLHB-90R700
R = 1000 ± 10mm	FLHB-90R1000

FL

FL SERIES

FL Horizontal Plain Bend 180°

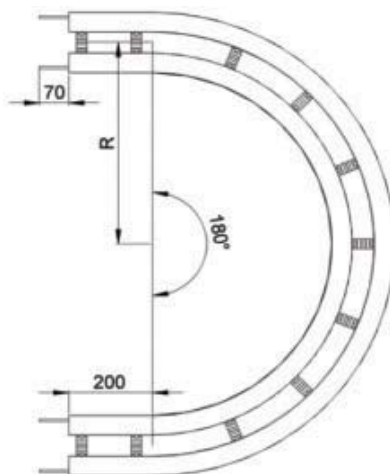

UOM : pc

Chain required 2-way (500, 700, 1000) : 4.0, 5.2, 7.1 meter
Slide rail required 2-way (500, 700, 1000): 7.9, 1.1, 14.2 meter

Horizontal plain bend, 180° ± 1°

R = 500 ± 10mm	FLHB-180R500
R = 700 ± 10mm	FLHB-180R700
R = 1000 ± 10mm	FLHB-180R1000

FL Horizontal Plain Bend 5° - 180°

Example for FL Horizontal Plain Bend Ordering

Horizontal plain bend, 0° ± 1°

R = 500 ± 10mm	FLHB- 0°R500
R = 700 ± 10mm	FLHB- 0°R700
R = 1000 ± 10mm	FLHB- 0°R1000

If an angle of 120° is needed for radius R500 horizontal plain bend, so the ordering part number is

FLHB-120R500

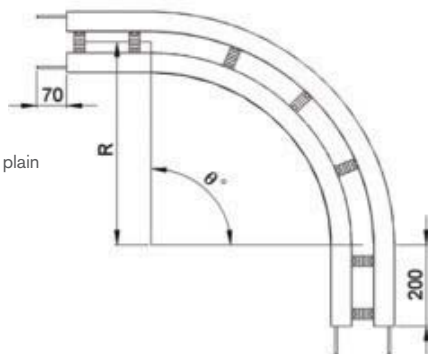

UOM : pc

Chain required 2-way (500, 700, 1000) : meter (variable to angle)
Slide rail required 2-way (500, 700, 1000): meter (variable to angle)

FL Vertical Bend 5°

FLVB-5R500

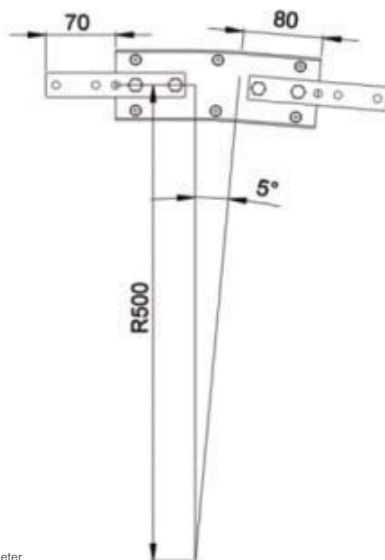
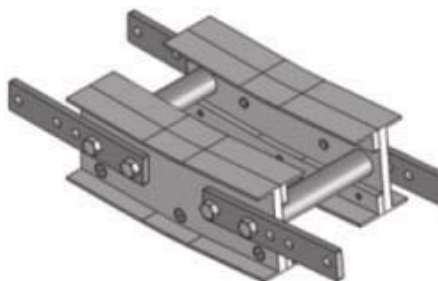

UOM : pc Chain required 2-way: 0.5 meter Slide rail required 2-way: 0.9 meter

FL

FL Vertical Bend 10°

FLVB-10R500

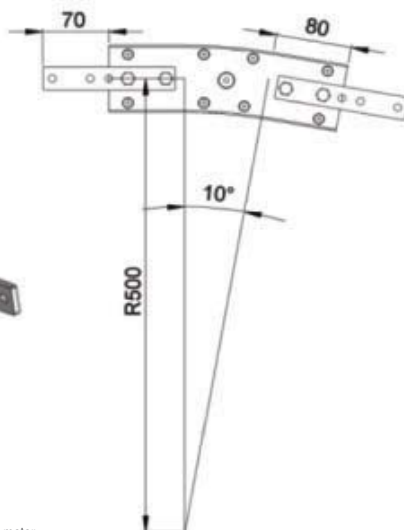
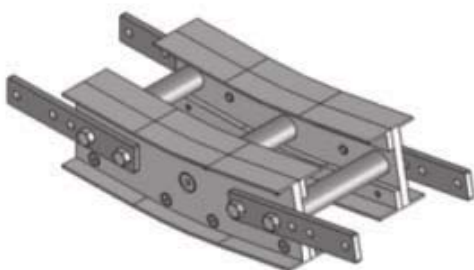

UOM : pc Chain required 2-way: 0.5 meter Slide rail required 2-way: 1.0 meter

FL SERIES

FL Vertical Bend 15°

FLVB-15R500

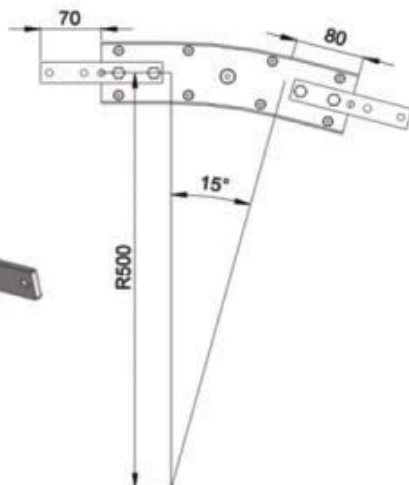
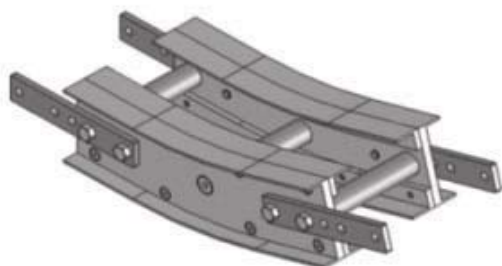

UOM : pc Chain required 2-way: 0.6 meter Slide rail required 2-way: 1.2 meter

FL Vertical Bend 20°

FLVB-20R500

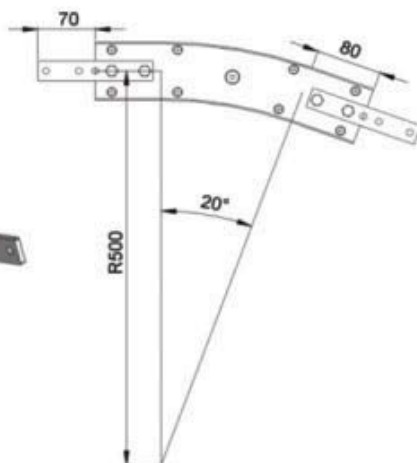
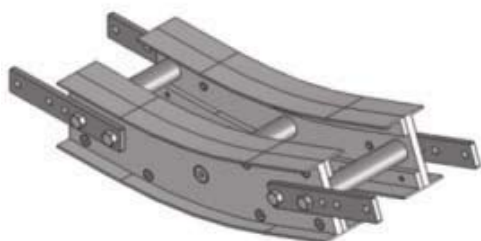

UOM : pc Chain required 2-way: 0.7 meter Slide rail required 2-way: 1.4 meter

FL Vertical Bend 30°

FLVB-30R500

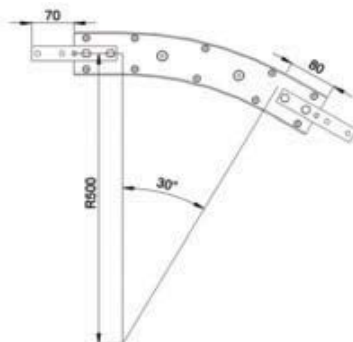
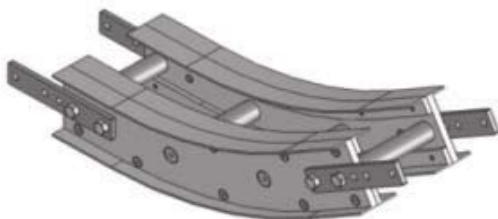

UOM : pc Chain required 2-way: 0.9 meter Slide rail required 2-way: 1.7 meter

FL Vertical Bend 45°

FLVB-45R500

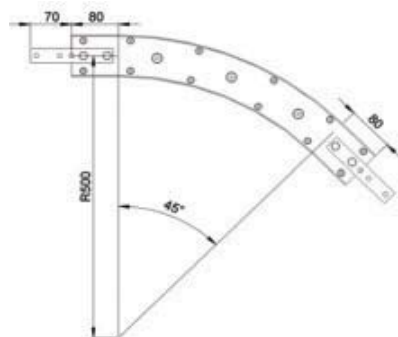
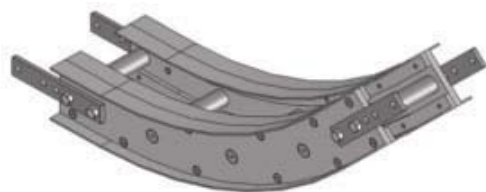

UOM : pc Chain required 2-way: 1.2 meter Slide rail required 2-way: 2.3 meter

FL Vertical Bend 5°-90°

Example for FL Vertical Bend Ordering

- Vertical bend, $\theta^\circ \pm 1^\circ$
- FLVB- θ° R500

If an angle of 65° is needed for vertical bend,
so the ordering part number is

FLVB-65R500

*The outer bend is assembled using connecting strip
(FACS-25x140A). Angle of "θ°" must be indicated
when ordering.*

