



# Variable Speed VFD Controllers

Installation, Maintenance, and Parts Manual



For other service manuals visit our website at:  
[www.dornerconveyors.com/manuals-literature](http://www.dornerconveyors.com/manuals-literature)

Record Conveyor Serial Number Here

---

# Table of Contents

---

|                                      |   |  |    |
|--------------------------------------|---|--|----|
| Introduction .....                   | 2 | Aluminum Stand Leg Mounting .....              | 8  |
| Warnings – General Safety .....      | 3 | 7200 and 7300 Series Controller Mounting ..... | 9  |
| Product Description .....            | 4 | AquaGard® Sanitary Controller Mounting.....    | 10 |
| Specifications .....                 | 4 | AquaPruf® Sanitary Controller Mounting.....    | 12 |
| Industrial Controllers .....         | 4 | Wiring.....                                    | 13 |
| Sanitary Controllers .....           | 5 | Preventive Maintenance and Adjustment .....    | 14 |
| Torque Specifications .....          | 5 | Required Tools .....                           | 14 |
| Installation .....                   | 6 | Controller Setup .....                         | 14 |
| Required Tools.....                  | 6 | Notes .....                                    | 15 |
| Determine Conveyor Type.....         | 6 | Service Parts.....                             | 16 |
| Industrial Conveyors .....           | 6 | Industrial VFD Controller .....                | 16 |
| Sanitary Conveyors .....             | 6 | Sanitary VFD Controller .....                  | 18 |
| Industrial Controller Mounting ..... | 6 | Return Policy.....                             | 20 |
| 2200 and 3200 Conveyor Mounting..... | 6 |  |    |

---

## Introduction

---

|                  |
|------------------|
| <b>IMPORTANT</b> |
|------------------|

|  |
|--|
| Some illustrations may show guards removed. Do NOT operate equipment without guards. |
|--|

Dorner’s Limited Warranty applies.

Dorner reserves the right to make changes at any time without notice or obligation.

Upon receipt of shipment:

- Compare shipment with packing slip. Contact factory regarding discrepancies.
- Inspect packages for shipping damage. Contact carrier regarding damage.
- Accessories may be shipped loose. See accessory instructions for installation.

## Warnings – General Safety

### WARNING

The safety alert symbol, black triangle with white exclamation, is used to alert you to potential personal injury hazards.

### DANGER



Climbing, sitting, walking or riding on conveyor will cause severe injury.  
**KEEP OFF CONVEYORS.**

### DANGER



**DO NOT OPERATE CONVEYORS IN AN EXPLOSIVE ENVIRONMENT.**

### WARNING

Controller must be properly grounded. Failure to properly ground controller may cause injury to personnel.

### DANGER



Hazardous voltage will cause severe injury or death.  
**LOCKOUT POWER BEFORE wiring.**

### WARNING



Exposed moving parts can cause severe injury.  
**DO NOT ATTEMPT ADJUSTMENTS WITH CONVEYOR RUNNING.**

### WARNING



Dorner cannot control the physical installation and application of conveyors. Taking protective measures is the responsibility of the user.

When conveyors are used in conjunction with other equipment or as part of a multiple conveyor system, **CHECK FOR POTENTIAL PINCH POINTS** and other mechanical hazards before system start-up.

# Product Description

Dorner Variable Speed VFD Controllers (**Figure 1**) are AC motor speed controllers for Standard and Heavy Load VFD gearmotors.

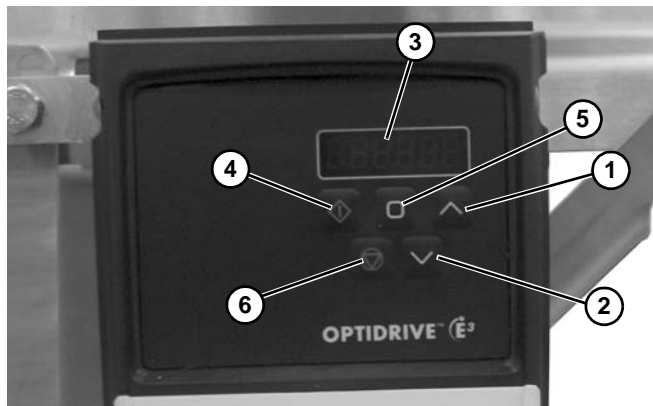

**Figure 1**

## NOTE

*For additional information, refer to the Invertek Drives Quick Start Guide shipped with your controller.*

### Illustration References:

- |   |                       |
|---|-----------------------|
| 1 | Decrease Speed Button |
| 2 | Increase Speed Button |
| 3 | Display               |
| 4 | Start Button          |
| 5 | Stop Button           |
| 6 | Enter Button          |

# Specifications

## Industrial Controllers

| Model Number | Input Voltage (VAC) & Phase | Input Frequency (Hz) | Output Voltage (VAC) & Phase | Max. HP (kW) | Max. Output in Amps |
|--------------|-----------------------------|----------------------|------------------------------|--------------|---------------------|
| 32MVA1122(X) | 115 Volts, Single Phase     | 60                   | 230 Volts, Three Phase       | 0.5 (0.37)   | 2.3                 |
| 32MVA2122(X) | 230 Volts, Single Phase     | 60                   | 230 Volts, Three Phase       | 0.5 (0.37)   | 2.3                 |
| 32MVA2322(X) | 230 Volts, Three Phase      | 60                   | 230 Volts, Three Phase       | 0.5 (0.37)   | 2.3                 |
| 32MVA4342(X) | 460 Volts, Three Phase      | 60                   | 460 Volts, Three Phase       | 0.5 (0.37)   | 1.2                 |
| 32MVA1121(X) | 115 Volts, Single Phase     | 60                   | 230 Volts, Three Phase       | 1.0 (0.75)   | 5.8                 |
| 32MVA2121(X) | 230 Volts, Single Phase     | 60                   | 230 Volts, Three Phase       | 1.0 (0.75)   | 4.3                 |
| 32MVA2321(X) | 230 Volts, Three Phase      | 60                   | 230 Volts, Three Phase       | 1.0 (0.75)   | 4.3                 |
| 32MVA4341(X) | 460 Volts, Three Phase      | 60                   | 460 Volts, Three Phase       | 1.0 (0.75)   | 2.2                 |
| 32MVA2127(X) | 230 Volts, Single Phase     | 60                   | 230 Volts, Three Phase       | 2.0 (1.50)   | 7                   |
| 32MVA2327(X) | 230 Volts, Three Phase      | 60                   | 230 Volts, Three Phase       | 2.0 (1.50)   | 7                   |
| 32MVA4347(X) | 460 Volts, Three Phase      | 60                   | 230 Volts, Three Phase       | 2.0 (1.50)   | 5.8                 |

(X): Blank = No Accessory Port; E = M12 Accessory Port Wired for End Stop Photo Eye Application; I = M12 Accessory Port Wired for Indexing Photo Eye Application

## Sanitary Controllers

| Model Number | Input Voltage (VAC) & Phase | Input Frequency (Hz) | Output Voltage (VAC) & Phase | Max. HP (kW) | Max. Output in Amps |
|--------------|-----------------------------|----------------------|------------------------------|--------------|---------------------|
| 76MVA1122S   | 115 Volts, Single Phase     | 60                   | 230 Volts, Three Phase       | 0.5 (0.37)   | 2.3                 |
| 76MVA2122S   | 230 Volts, Single Phase     | 60                   | 230 Volts, Three Phase       | 0.5 (0.37)   | 2.3                 |
| 76MVA2322S   | 230 Volts, Three Phase      | 60                   | 230 Volts, Three Phase       | 0.5 (0.37)   | 2.3                 |
| 76MVA4342S   | 460 Volts, Three Phase      | 60                   | 460 Volts, Three Phase       | 0.5 (0.37)   | 1.2                 |
| 76MVA1121S   | 115 Volts, Single Phase     | 60                   | 230 Volts, Three Phase       | 1.0 (0.75)   | 5.8                 |
| 76MVA2121S   | 230 Volts, Single Phase     | 60                   | 230 Volts, Three Phase       | 1.0 (0.75)   | 4.3                 |
| 76MVA2321S   | 230 Volts, Three Phase      | 60                   | 230 Volts, Three Phase       | 1.0 (0.75)   | 4.3                 |
| 76MVA4341S   | 460 Volts, Three Phase      | 60                   | 460 Volts, Three Phase       | 1.0 (0.75)   | 2.2                 |
| 76MVA2127S   | 230 Volts, Single Phase     | 60                   | 230 Volts, Three Phase       | 2.0 (1.50)   | 7                   |
| 76MVA2327S   | 230 Volts, Three Phase      | 60                   | 230 Volts, Three Phase       | 2.0 (1.50)   | 7                   |
| 76MVA4347S   | 460 Volts, Three Phase      | 60                   | 230 Volts, Three Phase       | 2.0 (1.50)   | 5.8                 |

### NOTE

*All Dorner OPTIDRIVE™ VFD's are supplied with an inline line filter to meet EN 61800-3 or other EMC standards. Consult the safety information section of the vendor manual.*

## Torque Specifications

|           | Flat Head |                         | Socket Head |                         | Button/Low Head |                         | Set Screw |                         |
|-----------|-----------|-------------------------|-------------|-------------------------|-----------------|-------------------------|-----------|-------------------------|
|           | Size      | Torque                  | Size        | Torque                  | Size            | Torque                  | Size      | Torque                  |
| M4 x 0.7  | 2.5 mm    | 3.4 Nm<br>(30 in lbs)   | 3 mm        | 5.9 Nm<br>(52 in lbs)   | 2.5 mm          | 2.9 Nm<br>(26 in lbs)   | 2 mm      | 2.1 Nm<br>(19 in lbs)   |
| M5 x 0.8  | 3 mm      | 6.9 Nm<br>(61 in lbs)   | 4 mm        | 12.0 Nm<br>(106 in lbs) | 3 mm            | 5.9 Nm<br>(52 in lbs)   | 2.5 mm    | 4.7 Nm<br>(42 in lbs)   |
| M6 x 1.0  | 4 mm      | 12.0 Nm<br>(106 in lbs) | 5 mm        | 20.3 Nm<br>(180 in lbs) | 4 mm            | 10.0 Nm<br>(89 in lbs)  | 3 mm      | 7.7 Nm<br>(68 in lbs)   |
| M8 x 1.25 | 5 mm      | 28.0 Nm<br>(248 in lbs) | 6 mm        | 48.8 Nm<br>(432 in lbs) | 5 mm            | 24.0 Nm<br>(212 in lbs) | 4 mm      | 17.8 Nm<br>(158 in lbs) |
| M10 x 1.5 | 6 mm      | 56.0 Nm<br>(496 in lbs) | 8 mm        | 97.5 Nm<br>(863 in lbs) | 6 mm            | 48.0 Nm<br>(425 in lbs) | 5 mm      | 35.0 Nm<br>(310 in lbs) |

# Installation

## Required Tools

- 3 mm hex wrench
- 4 mm hex wrench
- 5 mm hex wrench
- 7 mm wrench
- 10 mm wrench
- 13 mm wrench
- 17 mm wrench

## Determine Conveyor Type

Select the appropriate section based on your conveyor type:

### Industrial Conveyors

- For 2200 and 3200 series conveyors, see “2200 and 3200 Conveyor Mounting” on page 6.
- For aluminum stand leg mounting, see “Aluminum Stand Leg Mounting” on page 8.

### Sanitary Conveyors

- For 7200 and 7300 series conveyors, see “7200 and 7300 Series Controller Mounting” on page 9.
- For AquaGard series conveyors, see “AquaGard® Sanitary Controller Mounting” on page 10.
- For AquaPruf series conveyors, see “AquaPruf® Sanitary Controller Mounting” on page 12.

## Industrial Controller Mounting

**⚠ WARNING**



**Exposed moving parts can cause severe injury.**  
**LOCK OUT POWER** before removing guards or performing maintenance.

### 2200 and 3200 Conveyor Mounting

Installation Component List (Figure 2):

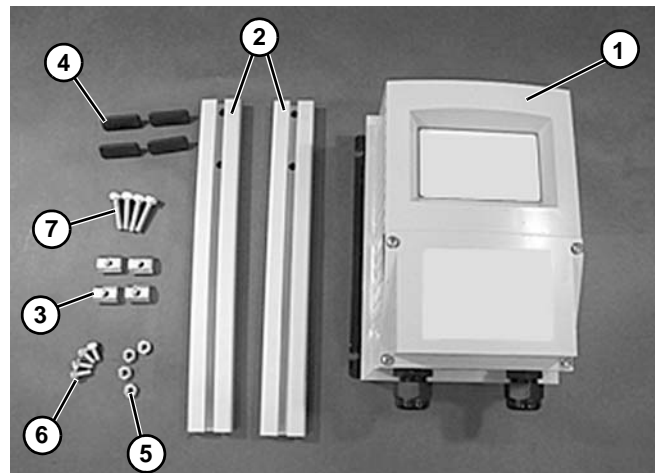
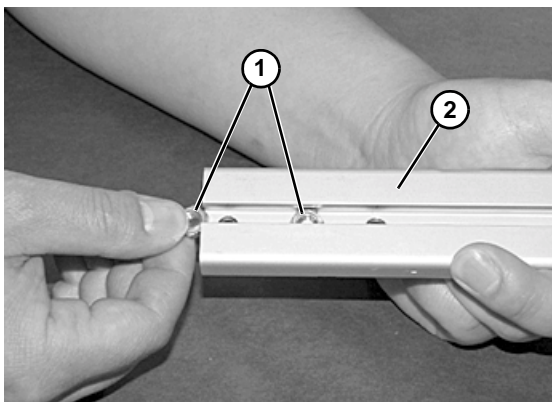

**Figure 2**

- |   |                         |
|---|-------------------------|
| 1 | VFD Controller          |
| 2 | Mounting Rails (x2)     |
| 3 | Drop-In Tee Bars (x4)   |
| 4 | End Caps (x4)           |
| 5 | Hex Nuts (x4)           |
| 6 | Socket Head Screws (x4) |
| 7 | Socket Head Screws (x4) |

# Installation

1. Insert two hex nuts (**Figure 3, item 1**) into slot on each mounting rail (**Figure 3, item 2**).



**Figure 3**

2. Insert end caps (**Figure 4, item 1**) into ends of mounting rails (**Figure 4, item 2**).

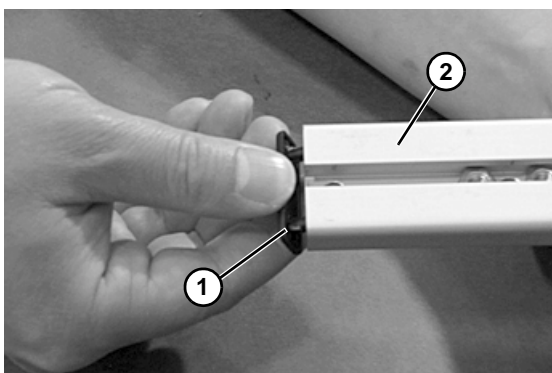

**Figure 4**

3. Attach mounting bars (**Figure 5, item 1**) to controller with screws (**Figure 5, item 2**).

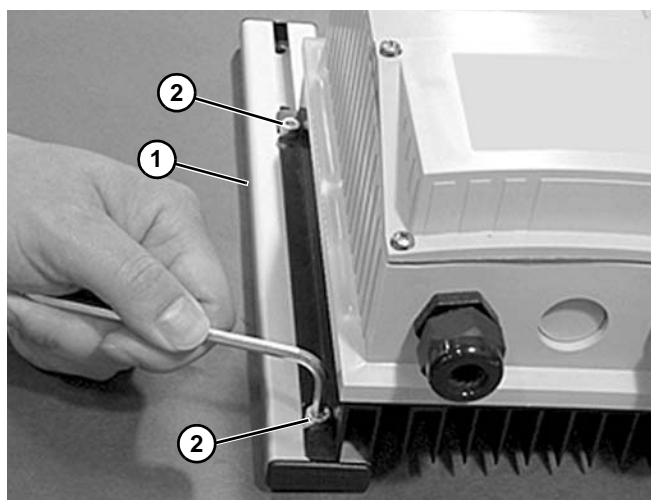

**Figure 5**

4. Install drop-in tee bars (**Figure 6, item 1**) in 2200 Series or 3200 Series conveyor T-slots.

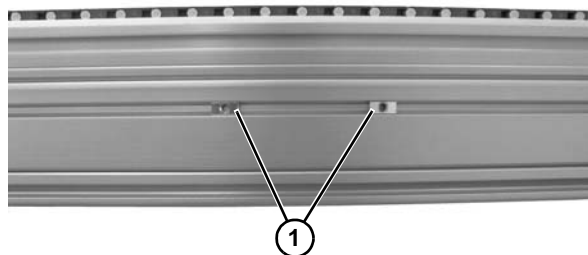

**Figure 6**

5. Attach controller (**Figure 7, item 1**) to conveyor with screws (**Figure 7, item 2**).

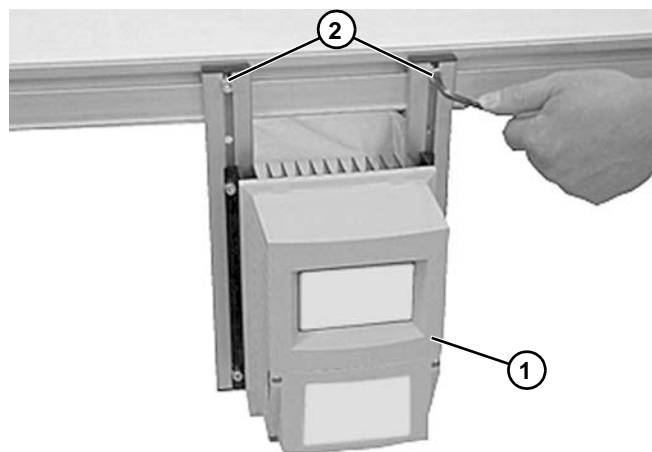
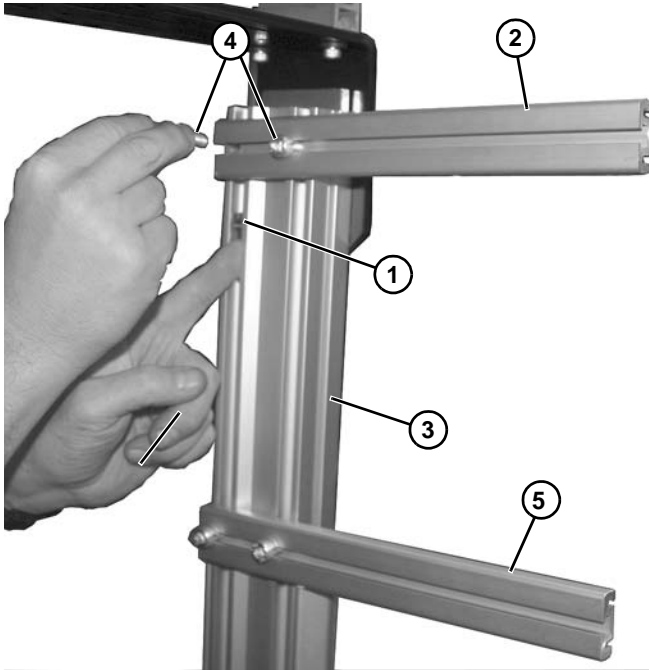

**Figure 7**

# Installation

## Aluminum Stand Leg Mounting

1. Install two drop-in tee bars (**Figure 8, item 1**) in stand leg T-slots. Attach upper mounting rail (**Figure 8, item 2**) to stand (**Figure 8, item 3**) with two screws (**Figure 8, item 4**).



**Figure 8**

2. Repeat step to install lower mounting rail (**Figure 8, item 5**).
3. Tighten four screws (**Figure 9, item 1**) until snug. Do not fully tighten at this time.



**Figure 9**

4. Install two nuts (**Figure 10, item 1**) into slot in upper mounting rail. Secure controller (**Figure 10, item 2**) into stand leg T-slot with two washers (**Figure 10, item 3**) and screws (**Figure 10, item 4**).

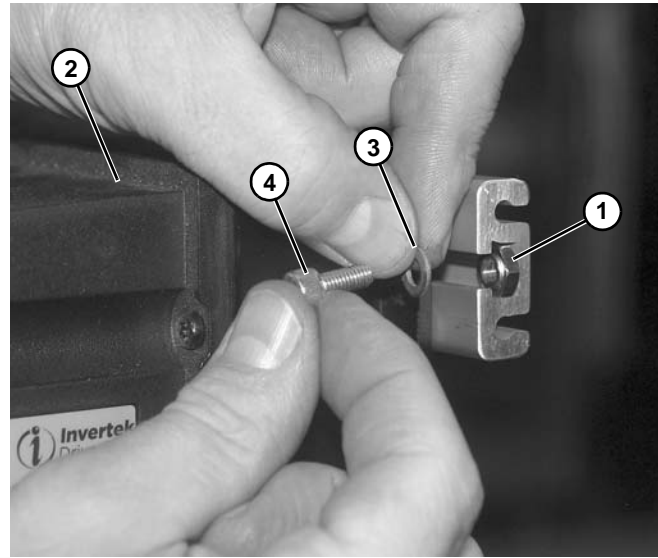

**Figure 10**

5. Repeat step to secure controller to lower mounting rail.
6. Tighten four screws (**Figure 11, item 1**).



**Figure 11**

7. Fully tighten the four screws securing the upper and lower mounting rails onto support stand, installed in step 3.



- Install end cap (Figure 12, item 1) onto each end of mounting rail (Figure 12, item 2).

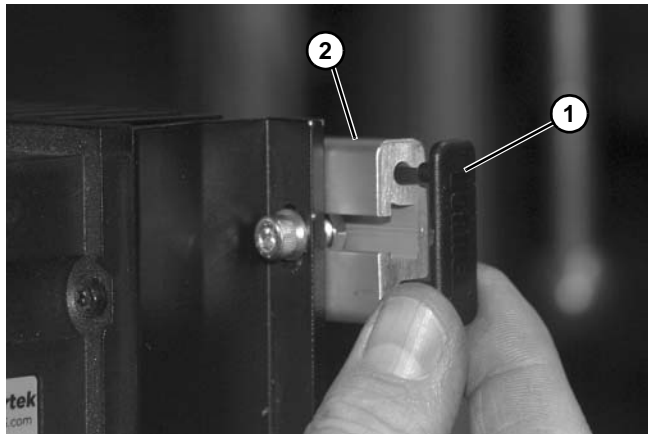



Figure 12

- Repeat to install remaining end caps (Figure 13).



Figure 13

## 7200 and 7300 Series Controller Mounting

|   |
|---|
| <b>⚠ WARNING</b>  |
|    |
| <p>Exposed moving parts can cause severe injury.<br/> <b>LOCK OUT POWER</b> before removing guards or performing maintenance.</p> |

### Installation Component List (Figure 14):

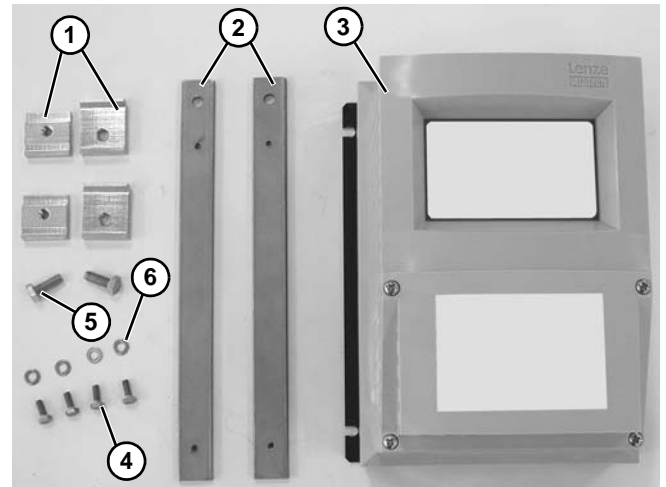

Figure 14

- |   |   |
|---|---|
| 1 | Accessory Mounting Clips (2x)<br>(Shipped with gearmotor mount package) |
| 2 | Mounting Plate (2x)   |
| 3 | VFD Controller  |
| 4 | Hex Head Screws (4x)  |
| 5 | Hex Head Screws (2x)  |
| 6 | Washers (4x)  |

- Attach mounting plates (Figure 15, item 1) to controller (Figure 15, item 2) with washers (Figure 15, item 3) and screws (Figure 15, item 4).

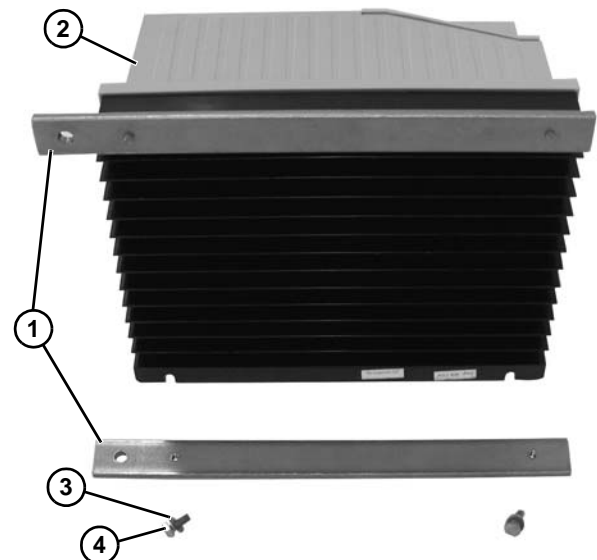

Figure 15

# Installation

- Loosely attach clips (Figure 16, item 1) to mounting bar (Figure 16, item 2) with screws (Figure 16, item 3).

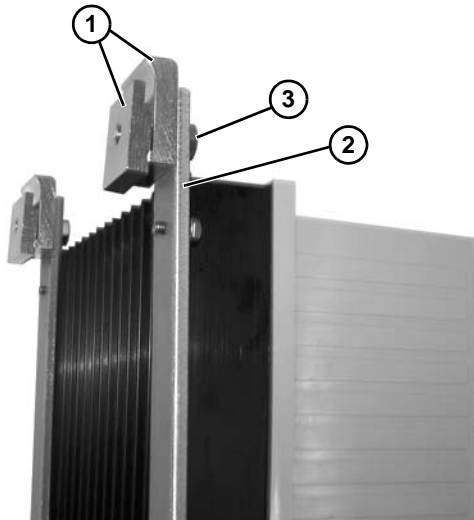

Figure 16

- Attach controller (Figure 17, item 1) to conveyor (Figure 17, item 2) with screws (Figure 17, item 3).

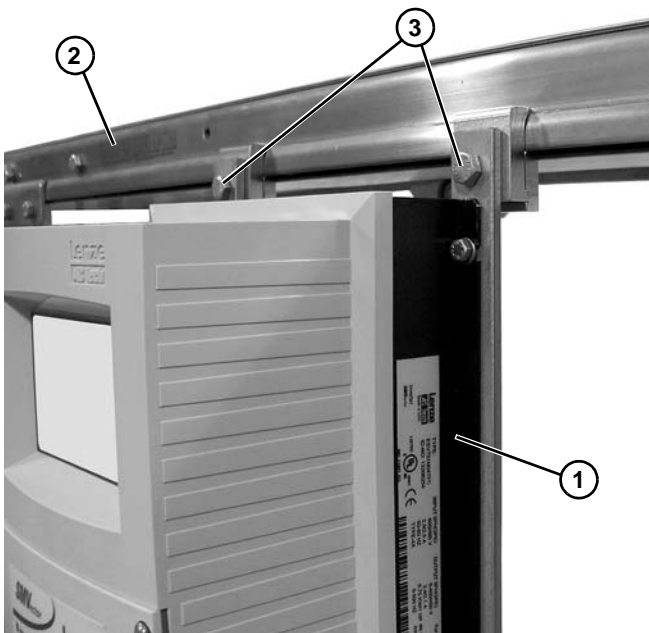

Figure 17

## AquaGuard® Sanitary Controller Mounting

**⚠ WARNING**

Exposed moving parts can cause severe injury.  
**LOCK OUT POWER** before removing guards or performing maintenance.

Installation Component List (Figure 18):

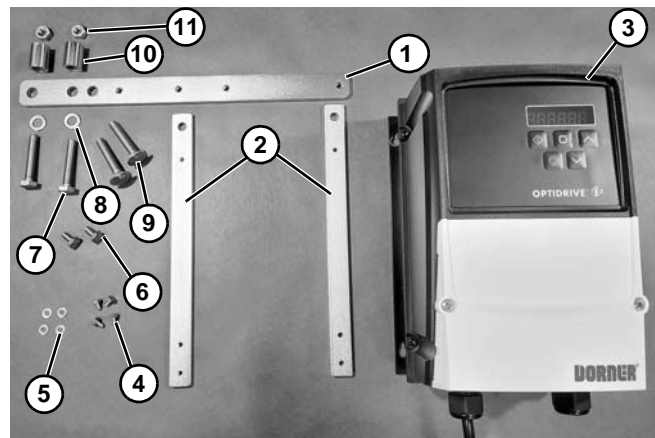
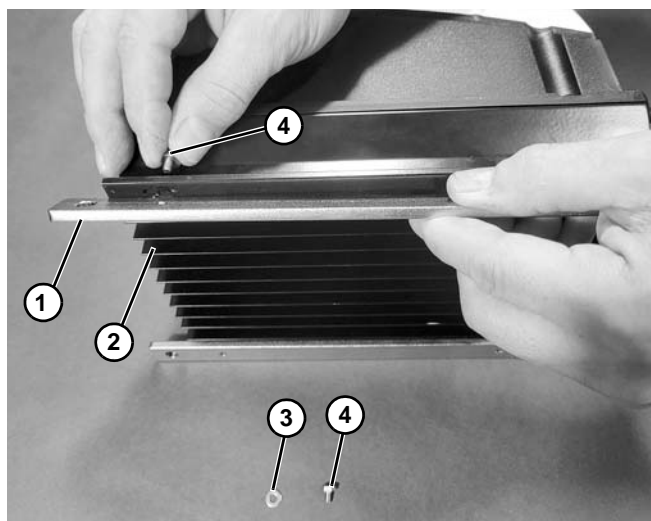

Figure 18

- |    |                        |
|----|------------------------|
| 1  | Controller Mount Plate |
| 2  | Mounting Plate (2x)    |
| 3  | VFD Controller         |
| 4  | Hex Head Screws (4x)   |
| 5  | Washers (4x)           |
| 6  | Hex Head Screws (2x)   |
| 7  | Hex Head Screws (2x)   |
| 8  | Washers (2x)           |
| 9  | Carriage Bolts (2x)    |
| 10 | Standoffs (2x)         |
| 11 | Hex Nut (2x)           |

# Installation

1. Attach mounting plates (**Figure 19, item 1**) to controller (**Figure 19, item 2**) with washers (**Figure 19, item 3**) and screws (**Figure 19, item 4**).



**Figure 19**

2. Attach controller mount plate (**Figure 20, item 1**) to mounting plates (**Figure 20, item 2**) with screws (**Figure 20, item 3**).

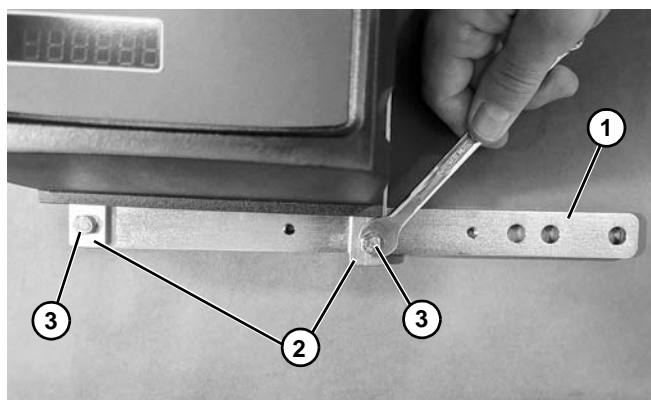

**Figure 20**

3. To install assembly to conveyor at stand location, remove stand carriage bolts and replace with new carriage bolts (**Figure 21, item 1**).

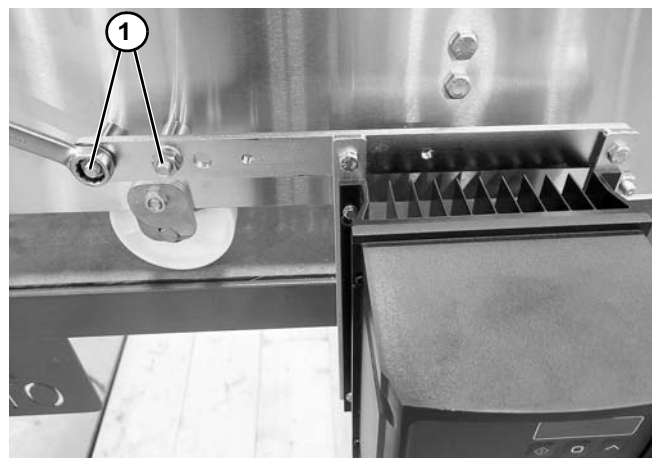

**Figure 21**

4. To install assembly to conveyor at frame connection, remove screws and replace with new screws (**Figure 22, item 1**).



**Figure 22**

# Installation

## AquaPruf® Sanitary Controller Mounting

|   |
|---|
| <b>⚠ WARNING</b>  |
|    |
| <p>Exposed moving parts can cause severe injury.</p> <p><b>LOCK OUT POWER</b> before removing guards or performing maintenance.</p> |

Installation Component List (Figure 23):

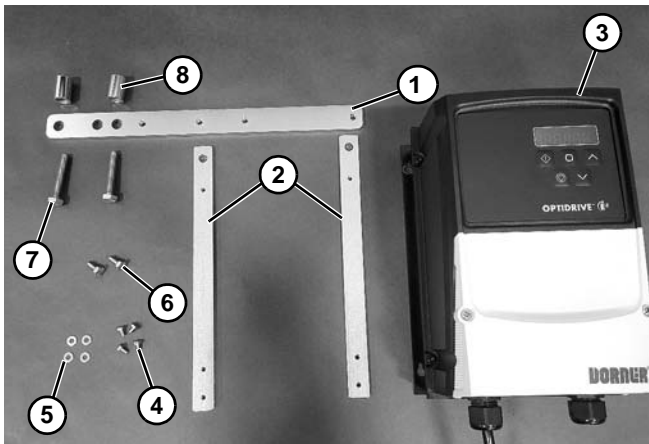

Figure 23

|   |                        |
|---|------------------------|
| 1 | Controller Mount Plate |
| 2 | Mounting Plates (2x)   |
| 3 | VFD Controller         |
| 4 | Hex Head Screws (4x)   |
| 5 | Washers (4x)           |
| 6 | Hex Head Screws (2x)   |
| 7 | Hex Head Screws (2x)   |
| 8 | Standoffs (2x)         |

1. Attach mounting plates (Figure 24, item 1) to controller (Figure 24, item 2) with washers (Figure 24, item 3) and screws (Figure 24, item 4).

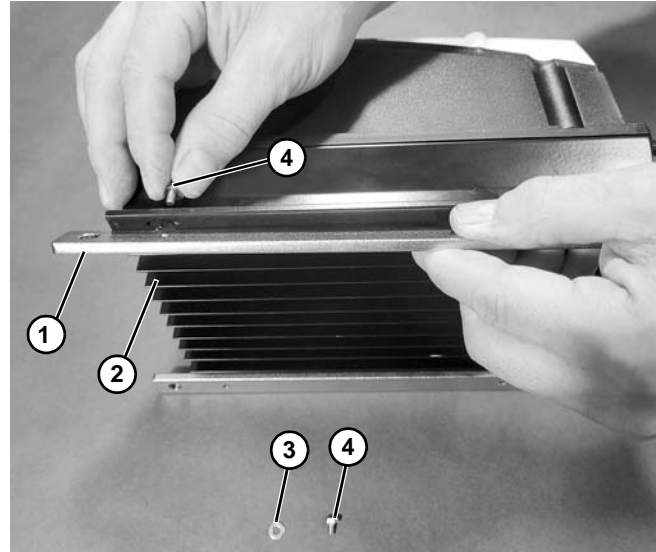

Figure 24

2. Attach controller mount plate (Figure 25, item 1) to mounting plates (Figure 25, item 2) with screws (Figure 25, item 3).

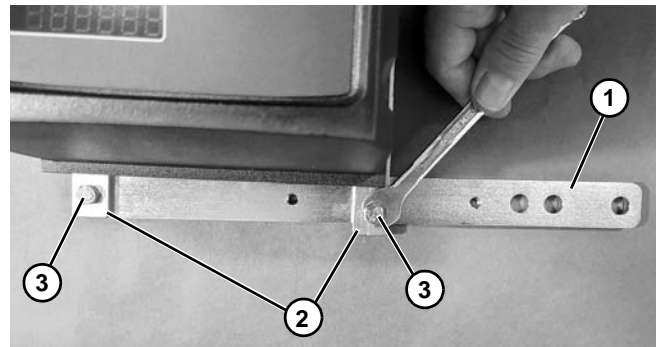

Figure 25

3. Install assembly to conveyor at stand location by removing screws and replacing with new screws (Figure 26, item 1).

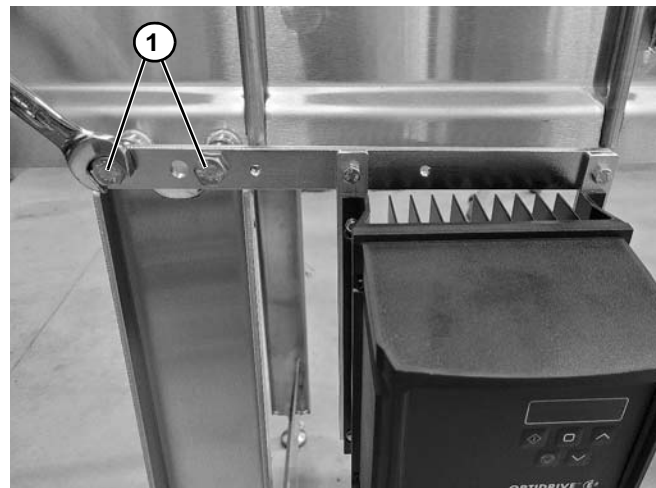

Figure 26

## Wiring

### **⚠ DANGER**



Hazardous voltage will cause severe injury or death.

**LOCKOUT POWER BEFORE wiring.**

### **⚠ WARNING**



Exposed moving parts can cause severe injury.

**LOCK OUT POWER** before removing guards or performing maintenance.

### **⚠ WARNING**

**Controller must be properly grounded.**  
Failure to properly ground control box may cause injury to personnel.

### **NOTE**

*A circuit breaker or a disconnect switch with fuses must be provided in accordance with the National Electrical Code (NEC) and all local codes.*

*Refer to Lenze Installation and Operating Manual shipped with your controller.*

### **NOTE**

*For electrical wiring or troubleshooting, refer to information provided by controller manufacturer.*

1. Make the input power connections through the line connection cord grip. Refer to the manufacturer's manual for terminations inside the VFD controller.

---

# Preventive Maintenance and Adjustment

---

## Required Tools

- Flat-blade screwdriver

## Controller Setup

| <b>⚠ DANGER</b>  |
|--|
|                   |
| <b>Hazardous voltage will cause severe injury or death.</b><br><b>LOCKOUT POWER BEFORE wiring.</b> |

| <b>⚠ WARNING</b>  |
|---|
|    |
| <b>Exposed moving parts can cause severe injury.</b><br><b>LOCK OUT POWER before removing guards or performing maintenance.</b> |

| <b>NOTE</b>   |
|---|
| <i>For additional information or desired settings other than listed, refer to the Invertek Drives Quick Start Guide shipped with your controller.</i> |

When purchased with a gearmotor, Dorner configures Variable Speed VFD Controllers as follows:

- 1 second acceleration time
- 1 second deceleration time
- Minimum frequency @ 10 Hz for Sanitary units, 6 Hz for Industrial units
- Maximum frequency @ 60 Hz
- Overloads set to motor Full Load Amperes (FLA)



# Service Parts

## NOTE

For replacement parts other than those shown in this section, contact an authorized Dorner distributor or Dorner directly. Recommended Critical Service Parts and Kits are identified by the Key Service Parts symbol . Dorner recommends keeping these parts on hand.

## Industrial VFD Controller

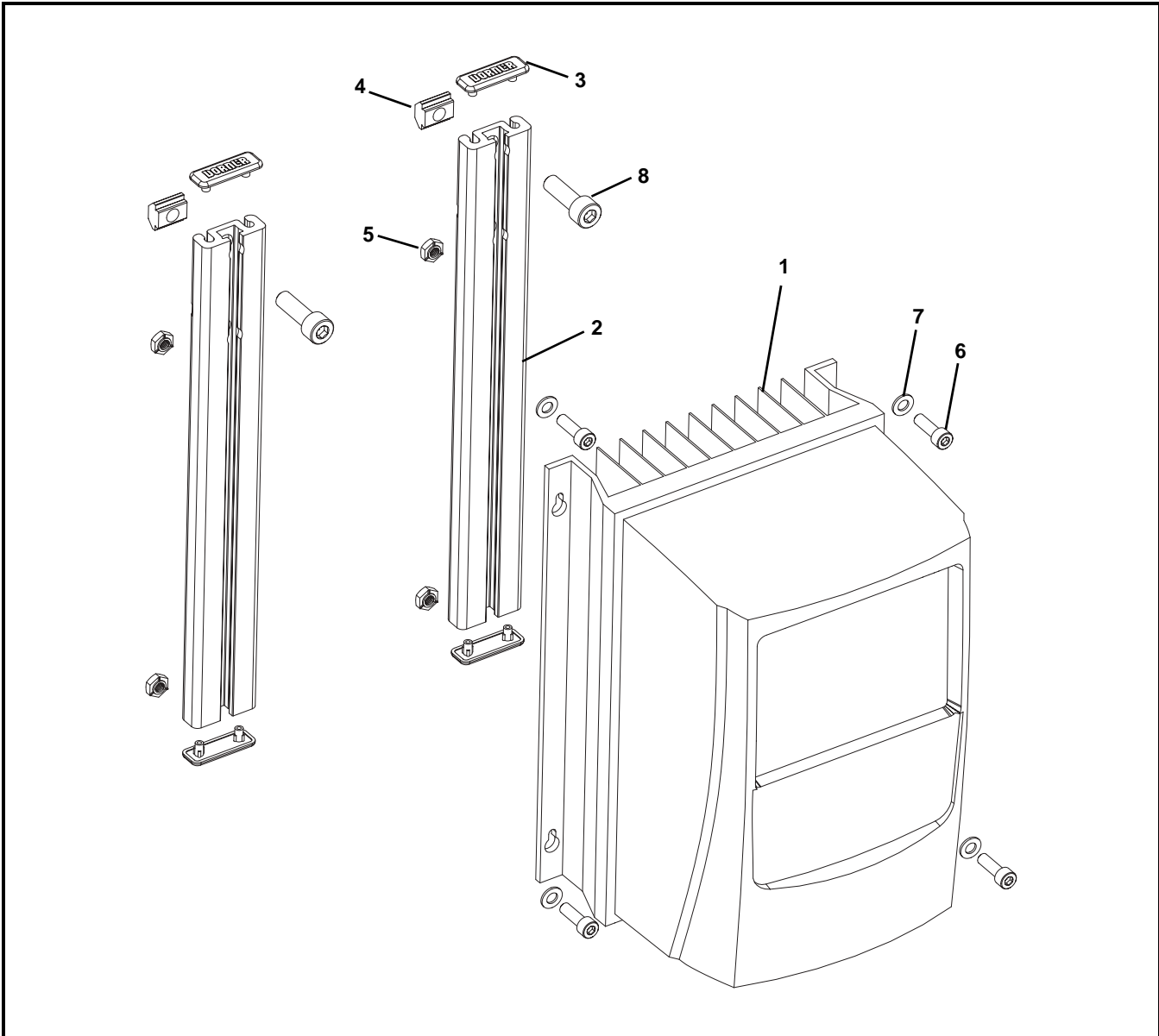



| Item   | Part Number | Description   |
|--|-------------|---|
| 1  | 805-2485    | VFD Controller, 0.5 Hp, 115 Volts Single Phase Input, 60Hz, 230 Volts, Three Phase Output |
|  | 805-2486    | VFD Controller, 0.5 Hp, 230 Volts Single Phase Input, 60Hz, 230 Volts, Three Phase Output |
|  | 805-2487    | VFD Controller, 0.5 Hp, 230 Volts Three Phase Input, 60Hz, 230 Volts, Three Phase Output  |
|  | 805-2488    | VFD Controller, 0.5 Hp, 460 Volts Three Phase Input, 60Hz, 230 Volts, Three Phase Output  |
|  | 805-2489    | VFD Controller, 1.0 Hp, 115 Volts Single Phase Input, 60Hz, 230 Volts, Three Phase Output |
|  | 805-2490    | VFD Controller, 1.0 Hp, 230 Volts Single Phase Input, 60Hz, 230 Volts, Three Phase Output |
|  | 805-2491    | VFD Controller, 1.0 Hp, 230 Volts Three Phase Input, 60Hz, 230 Volts, Three Phase Output  |
|  | 805-2492    | VFD Controller, 1.0 Hp, 460 Volts Three Phase Input, 60Hz, 230 Volts, Three Phase Output  |
|  | 805-2493    | VFD Controller, 2.0 Hp, 230 Volts Single Phase Input, 60Hz, 230 Volts, Three Phase Output |
|  | 805-2494    | VFD Controller, 2.0 Hp, 230 Volts Three Phase Input, 60Hz, 230 Volts, Three Phase Output  |
|  | 805-2495    | VFD Controller, 2.0 Hp, 460 Volts Three Phase Input, 60Hz, 230 Volts, Three Phase Output  |
| 2  | 205993      | Mounting Rail   |
| 3  | 210849      | Cap   |
| 4  | 202390M     | Drop-In Tee Bar   |
| 5  | 807-3003    | Weld Nut  |
| 6  | 920512M     | Socket Head Screw, M5-.80 x 12 mm   |
| 7  | 911-512     | Washer  |
| 8  | 920825M     | Socket Head Screw, M8-1.25 x 25 mm  |
| Service parts can be obtained through your distributor or directly from Dorner Mfg. Corp. (800) 397-8664 or customerservice@dorner.com |             |   |

# Service Parts

## Sanitary VFD Controller

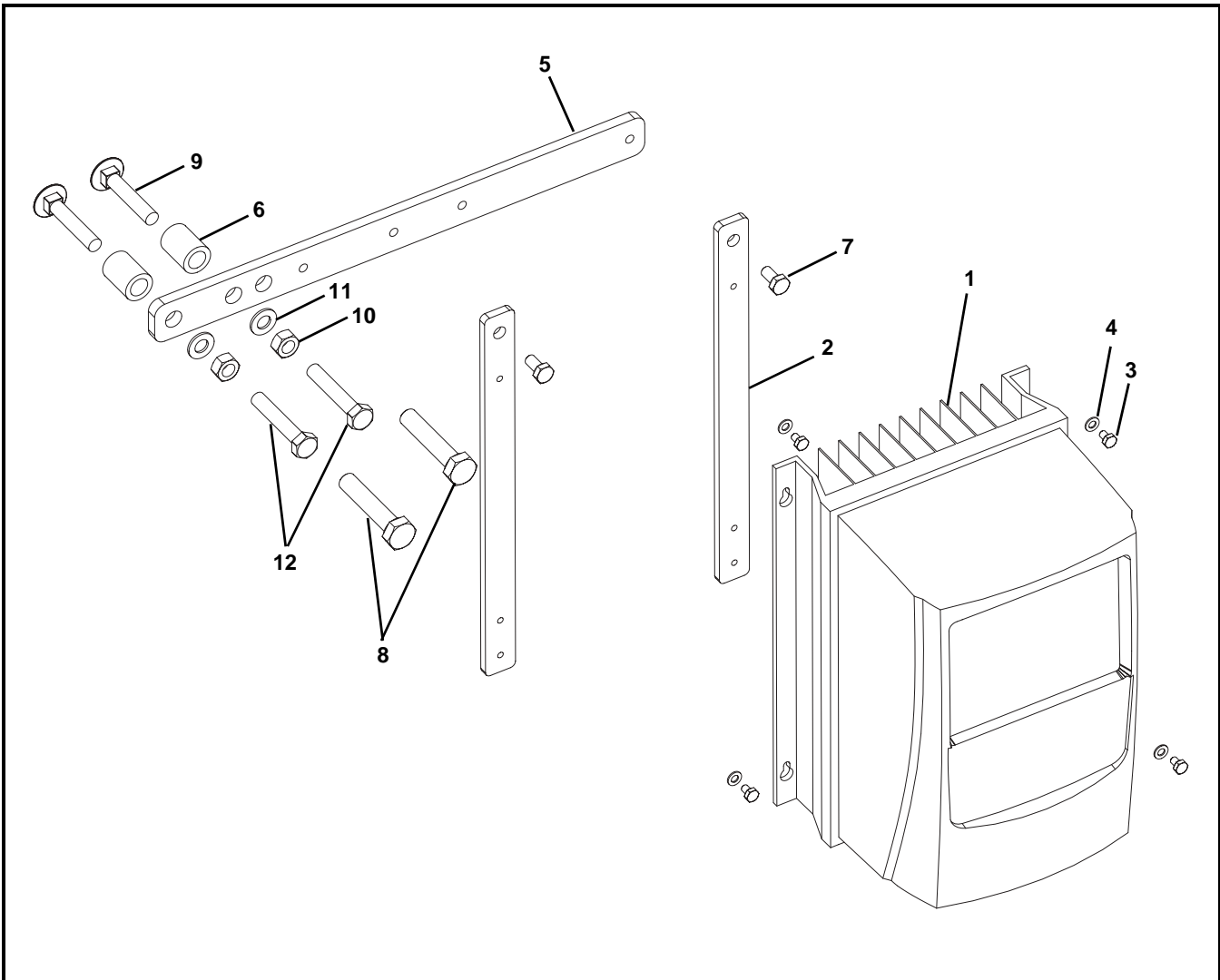

| Item   | Part Number | Description   |
|--|-------------|---|
| 1  | 805-2485    | VFD Controller, 0.5 Hp, 115 Volts Single Phase Input, 60Hz, 230 Volts, Three Phase Output |
|  | 805-2486    | VFD Controller, 0.5 Hp, 230 Volts Single Phase Input, 60Hz, 230 Volts, Three Phase Output |
|  | 805-2487    | VFD Controller, 0.5 Hp, 230 Volts Three Phase Input, 60Hz, 230 Volts, Three Phase Output  |
|  | 805-2488    | VFD Controller, 0.5 Hp, 460 Volts Three Phase Input, 60Hz, 230 Volts, Three Phase Output  |
|  | 805-2489    | VFD Controller, 1.0 Hp, 115 Volts Single Phase Input, 60Hz, 230 Volts, Three Phase Output |
|  | 805-2490    | VFD Controller, 1.0 Hp, 230 Volts Single Phase Input, 60Hz, 230 Volts, Three Phase Output |
|  | 805-2491    | VFD Controller, 1.0 Hp, 230 Volts Three Phase Input, 60Hz, 230 Volts, Three Phase Output  |
|  | 805-2492    | VFD Controller, 1.0 Hp, 460 Volts Three Phase Input, 60Hz, 230 Volts, Three Phase Output  |
|  | 805-2493    | VFD Controller, 2.0 Hp, 230 Volts Single Phase Input, 60Hz, 230 Volts, Three Phase Output |
|  | 805-2494    | VFD Controller, 2.0 Hp, 230 Volts Three Phase Input, 60Hz, 230 Volts, Three Phase Output  |
|  | 805-2495    | VFD Controller, 2.0 Hp, 460 Volts Three Phase Input, 60Hz, 230 Volts, Three Phase Output  |
| 2  | 506344      | Mounting Plate  |
| 3  | 960408MSS   | Hex Head Cap Screw, M4-0.70 x 8 mm  |
| 4  | 911-604     | Washer, M4  |
| 5  | 520396      | Controller Mount Plate  |
| 6  | 500693      | Standoff  |
| 7  | 960612MSS   | Hex Head Cap Screw, M6-1.00 x 12 mm   |
| 8  | 961045MSS   | Hex Head Cap Screw, M10-1.5 x 45 mm for AquaPruf Conveyors Only                           |
| 9  | 807-3600    | Carriage Bolt, M8-1.25 x 45 mm for AquaGard Conveyors Only                                |
| 10   | 990801MSS   | Hex Nut for AquaGard Conveyors Only   |
| 11   | 807-1951    | Washer, M8 for AquaGard Conveyors Only  |
| 12   | 960845MSS   | Hex Head Cap Screw, M8-1.25 x 45 mm for AquaGard Conveyors Only                           |
| Service parts can be obtained through your distributor or directly from Dorner Mfg. Corp. (800) 397-8664 or customerservice@dorner.com |             |   |

# Return Policy

Returns must have prior written factory authorization or they will not be accepted. Items that are returned to Dorner without authorization will not be credited nor returned to the original sender. When calling for authorization, please have the following information ready for the Dorner factory representative or your local distributor:

1. Name and address of customer.
2. Dorner part number(s) of item(s) being returned.
3. Reason for return.
4. Customer's original order number used when ordering the item(s).
5. Dorner or distributor invoice number. Include part serial number if available.

A representative will discuss action to be taken on the returned items and provide a Returned Materials Authorization (RMA) number for reference. RMA will automatically close 30 days after being issued. To get credit, items must be new and undamaged. There will be a return charge on all items returned for credit, where Dorner was not at fault. It is the customer's responsibility to prevent damage during return shipping. Damaged or modified items will not be accepted. The customer is responsible for return freight.

| Product Line                   | Product Type   |                                |                |             |                        |                                    |                                      |                             | Engineered to order parts |
|--------------------------------|--|--------------------------------|----------------|-------------|------------------------|------------------------------------|--------------------------------------|-----------------------------|---------------------------|
|                                | Standard Products  |                                |                |             |                        |                                    |                                      |                             |                           |
|                                | Conveyors  | Gearmotors & Mounting Packages | Support Stands | Accessories | Spare Parts (non-belt) | Spare Belts - Standard Flat Fabric | Spare Belts - Cleated & Spec. Fabric | Spare Belts - Plastic Chain | All equipment and parts   |
| 1100 Series                    | 30% return fee for all products except:<br>50% return fee for conveyors with modular belt, cleated belt or speciality belts<br><br>All Electrical items are assigned original manufacturers return policy. |                                |                |             |                        |                                    | non-returnable                       |                             | case-by-case              |
| 2200 Series                    |  |                                |                |             |                        |                                    |                                      |                             |                           |
| 3200 Series                    |  |                                |                |             |                        |                                    |                                      |                             |                           |
| Pallet Systems                 |  |                                |                |             |                        |                                    |                                      |                             |                           |
| FlexMove/SmartFlex             |  |                                |                |             |                        |                                    |                                      |                             |                           |
| GAL Series                     |  |                                |                |             |                        |                                    |                                      |                             |                           |
| All Electrical                 |  |                                |                |             |                        |                                    |                                      |                             |                           |
| 7100 Series                    | 50% return fee for all products  |                                |                |             |                        |                                    | non-returnable                       |                             | case-by-case              |
| 7200/7300 Series               |  |                                |                |             |                        |                                    |                                      |                             |                           |
| AquaGard 7350 Series Version 2 |  |                                |                |             |                        |                                    |                                      |                             |                           |
| GES Series                     |  |                                |                |             |                        |                                    |                                      |                             |                           |
| AquaGard 7350/7360 Series      | non-returnable   |                                |                |             |                        |                                    |                                      |                             |                           |
| AquaPruf Series                | non-returnable   |                                |                |             |                        |                                    |                                      |                             |                           |

Returns will not be accepted after 60 days from original invoice date. The return charge covers inspection, cleaning, disassembly, disposal and reissuing of components to inventory. If a replacement is needed prior to evaluation of returned item, a purchase order must be issued. Credit (if any) is issued only after return and evaluation is complete.

Dorner has representatives throughout the world. Contact Dorner for the name of your local representative. Our Customer Service Team will gladly help with your questions on Dorner products.

For a copy of Dorner's Warranty, contact Dorner, an authorized sales channel or visit our website: [www.dorner.com](http://www.dorner.com).

For replacement parts, contact an authorized Dorner Service Center or the factory.

[www.dorner.com](http://www.dorner.com)



© Dorner Mfg. Corp. 2021. All Rights Reserved.

## Dorner – North & South America

### Dorner – U.S.A.

**Headquarters**  
 975 Cottonwood Ave  
 Hartland, WI 53029, USA  
 (800) 397-8664  
 (262) 367-7600  
[info@dorner.com](mailto:info@dorner.com)

### Dorner – Canada

100-5515 North Service Road  
 Burlington, Ontario L7L 6G6  
 Canada  
 (289) 208-7306  
[info@dorner.com](mailto:info@dorner.com)

### Dorner – Latin America

Carretera a Nogales #5297, Nave 11.  
 Parque Industrial Nogales  
 Zapopan, Jalisco C.P. 45222 México  
 +52.33.30037400 | [info.latinamerica@dorner.com](mailto:info.latinamerica@dorner.com)

## Dorner – Europe

### Dorner – Germany

Karl-Heinz-Beckurts-Straße 7  
 52428 Jülich,  
 Germany  
 +49 (0) 2461/93767-0  
[info.europe@dorner.com](mailto:info.europe@dorner.com)

### Dorner – France

8 rue des Frères Caudron  
 78140 Velizy-Villacoublay  
 France  
 +33 (0)1 84 73 24 27  
[info.france@dorner.com](mailto:info.france@dorner.com)

## Dorner – Asia

128 Jalan Permatang Damar Laut, Bayan Lepas 11960  
 Penang, Malaysia  
 +604-626-2948 | [info.asia@dorner.com](mailto:info.asia@dorner.com)