

# AquaGard<sup>®</sup> LP Sanitary End Drive Conveyors

## Installation, Maintenance & Parts Manual



For other service manuals visit our website at:  
[www.dornerconveyors.com/manuals-literature](http://www.dornerconveyors.com/manuals-literature)



Original Instructions

851-967-EU Rev. A

Record Conveyor Serial Number Here

# Table of Contents

Introduction .....	3	Return Rollers for Flat Belt Conveyors	
Warnings – General Safety .....	4	70 mm - 152 mm & Cleated Belt Conveyors .....	40
Product Description .....	5	Return Rollers for Flat Belt Conveyors	
Specifications .....	6	Over 152 mm Wide .....	41
Models .....	6	Table Top Mounting Brackets	
Flat Belt Conveyor .....	6	For Flat Belt Conveyors .....	42
Cleated Belt Conveyor .....	6	Table Top Mounting Brackets	
Conveyor Supports: .....	7	For Cleated Belt Conveyors .....	43
Specifications .....	7	Configuring Conveyor Belt Part Number .....	44
Fastener Torque Specifications .....	7	Flat Belt Part Number Configuration .....	44
Installation .....	8	Cleated Belt Part Number Configuration .....	44
Required Tools .....	8	Notes .....	45
Recommended Installation Sequence .....	8	Return Policy .....	46
Conveyors Up to 2998 mm (118") .....	8		
Conveyors Longer than 2998 mm (118") .....	8		
Connecting Components .....	8		
Belt Installation .....	9		
Table Top Mounting Bracket Installation .....	10		
Stand Installation .....	11		
Belt Returns .....	12		
Cleated Belt and Flat Belt Returns			
70 mm - 152 mm Wide .....	12		
Flat Belt Returns over 152 mm Wide .....	14		
Guide Installation .....	16		
Fixed Guides .....	16		
Adjustable Guides .....	17		
Drive Package Installation .....	17		
Preventive Maintenance and Adjustment .....	18		
Required Tools .....	18		
Checklist .....	18		
Cleaning .....	18		
Lubrication .....	18		
Conveyor Bearings .....	18		
Return Rollers .....	18		
Maintaining the Conveyor Belt .....	18		
Troubleshooting .....	18		
Conveyor Belt Replacement .....	19		
Conveyor Belt Tensioning .....	21		
Conveyor Belt Tracking .....	21		
Pulley Replacement .....	22		
A - Drive Pulley .....	22		
B - Idler Pulley .....	23		
Bearing Replacement for Drive or Idler Pulley .....	24		
Bearing Removal .....	25		
Bearing Installation .....	25		
Belt Return Maintenance .....	26		
Cleated Belt and Flat Belt Returns			
70 mm - 152 mm Wide .....	26		
Flat Belt Returns over 152 mm Wide .....	27		
Service Parts .....	29		
End Drive Tail .....	29		
Idler Tail .....	30		
Frame .....	31		
25 mm High Sides .....	32		
75 mm High Sides .....	33		
152 mm High Sides .....	34		
Fully Adjustable Guides .....	35		
Tool-Less Fully Adjustable Guides .....	36		
25 mm Cleated High Sides .....	37		
75 mm Cleated High Sides .....	38		
152 mm Cleated High Sides .....	39		



## CAUTION

**Some illustrations may show guards removed. DO NOT operate equipment without guards.**

Upon receipt of shipment:

- Compare shipment with packing slip. Contact factory regarding discrepancies.
- Inspect packages for shipping damage. Contact carrier regarding damage. Accessories may be shipped loose.
- See accessory instructions for installation.

The Dorner Limited Warranty applies.

Dorner reserves the right to make changes at any time without notice or obligation.

Dorner has convenient, pre-configured kits of Critical Service Parts for all conveyor products. These time saving kits are easy to order, designed for fast installation, and guarantee you will have what you need when you need it. Recommended Critical Service Parts and Kits are marked in the Service Parts section of this manual with the Key Service Parts symbol .

# Warnings – General Safety

## WARNING

The safety alert symbol, black triangle with white exclamation, is used to alert you to potential personal injury hazards.

## DANGER



### SEVERE HAZARD!

**KEEP OFF CONVEYORS.** Climbing, sitting, walking or riding on conveyor will result in death or serious injury.

## WARNING



### SEVERE HAZARD!

**LOCK OUT POWER** before removing guards or performing maintenance. Exposed moving parts can cause serious injury.

## WARNING



### BURN HAZARD!

**DO NOT TOUCH** the motor while operating, or shortly after being turned off. Motors may be **HOT** and can cause serious burn injuries.

## WARNING



### PUNCTURE HAZARD!

Handle drive shaft keyway with care. It may be sharp and could puncture the skin, causing serious injury.

## DANGER



### EXPLOSION HAZARD!

- **DO NOT OPERATE CONVEYORS IN AN EXPLOSIVE ENVIRONMENT.** The electric gearmotor generates heat and could ignite combustible vapors.
- Failure to comply will result in death or serious injury.

## WARNING



### CRUSH HAZARD!

- **DO NOT** place hands or fingers inside the conveyor while it is running.
- **DO NOT** wear loose garments while operating the conveyor. Loose garments can become caught up in the conveyor.
- Failure to comply could result in serious injury.

## WARNING



### CRUSH HAZARD!

- **SUPPORT CONVEYOR SECTIONS PRIOR TO LOOSENING STAND HEIGHT OR ANGLE ADJUSTMENT SCREWS.**
- Loosening stand height or angle adjustment screws may cause conveyor sections to drop down, causing serious injury.

## WARNING



### SEVERE HAZARD!

- Dorner cannot control the physical installation and application of conveyors. Taking protective measures is the responsibility of the user.
- When conveyors are used in conjunction with other equipment or as part of a multiple conveyor system, **CHECK FOR POTENTIAL PINCH POINTS** and other mechanical hazards before system start-up.
- Failure to comply could result in serious injury.

---

# Product Description

---

Refer to **(Figure 1)** for typical conveyor components.

1	Conveyor
2	Gearmotor
3	Controller
4	Belt (Cleated Belt Shown)
5	Support Stands
6	End Drive
7	Idler End
8	Guides

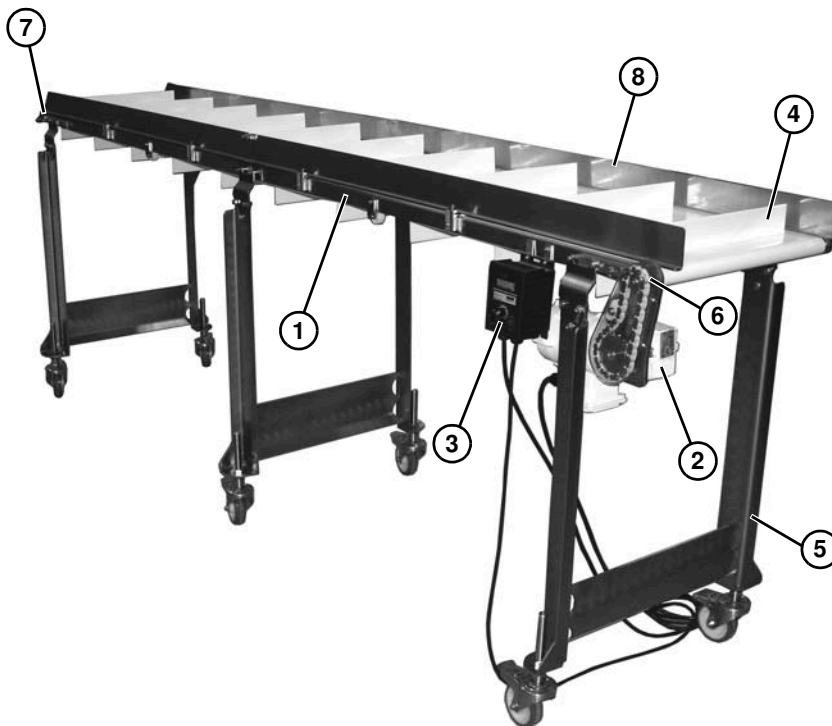

**Figure 1**

---

# Specifications

---

## Models

### Flat Belt Conveyor

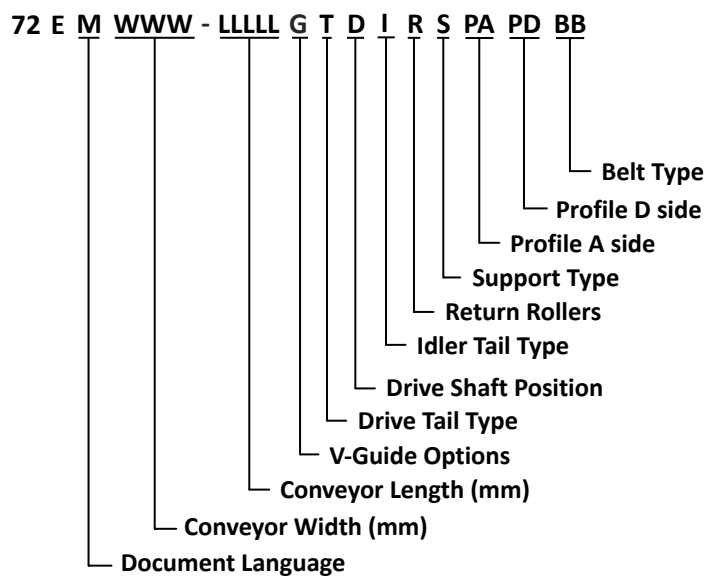

### Cleated Belt Conveyor

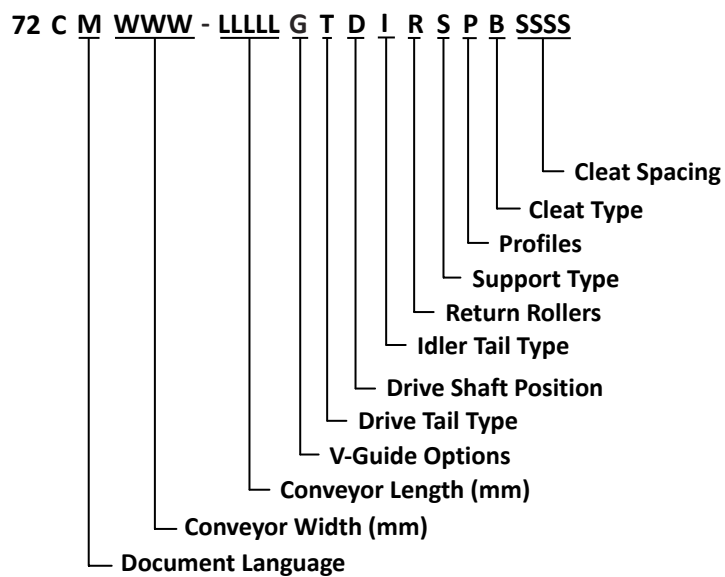

See “Engineering” Manual for details.

# Specifications

## Conveyor Supports:

### Maximum Distances:

- 1 = Support Stand on Drive End = 188 mm (7.4")
- 2 = Support Stand on Idler End = 156 mm (6.1")
- 3 = Between Support Stands = 1400 mm (55.1")\*\*
- \*\* For conveyors longer than 2998 mm (118"), install support at frame joint.

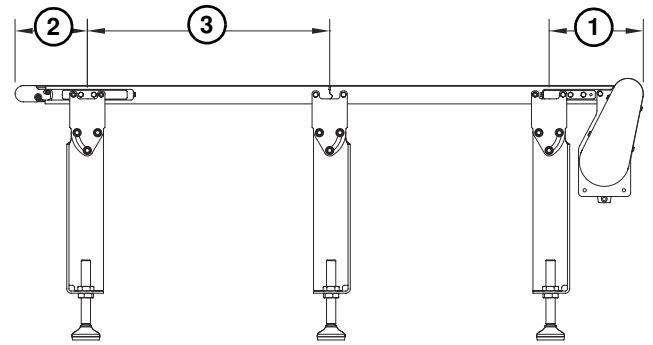

Figure 2

## Specifications

Conveyor Width Reference ( <u>WWW</u> )	070, 095, 152, 203, 254, 305, 406, 457
Conveyor Belt Width	70 mm (2.75"), 95 mm (3.75"), 152 mm (6"), 203 mm (8"), 254 mm (10"), 305 mm (12"), 406 mm (16"), 457 mm (18")
Maximum Conveyor Load (See NOTE Below)	22.7 kg (50 lbs.)
Belt Travel	102 mm (4.0") per revolution of pulley
Maximum Belt Speed	75 m/minute (246 ft/minute)
Conveyor Length Reference ( <u>LLLLL</u> )	00500 – 05485 in 00005 increments
Conveyor Length	500 mm (20") – 5485 mm (216") in 5 mm (.20") increments

### NOTE

Maximum conveyor loads are based on:

- Non-accumulating product
- Product moving toward gearmotor
- Conveyor being mounted horizontally
- Conveyor being located in a dry environment
- Conveyor equipped with standard belt only

## Fastener Torque Specifications

	Hex Head		Set Screw	
	Hex Size	Torque	Hex Size	Torque
M3 x 0.5	5.5 mm	0.9 Nm (8 in lbs)	2 mm	0.2 Nm (1.7 in lbs)
M4 x 0.7	7 mm	2.3 Nm (20 in lbs)	2 mm	0.7 Nm (6 in lbs)
M5 x 0.8	8 mm	4.6 Nm (40 in lbs)	2.5 mm	1.5 Nm (13 in lbs)
M6 x 1.0	10 mm	7.8 Nm (69 in lbs)	3 mm	2.5 Nm (22 in lbs)
M8 x 1.25	13 mm	19.0 Nm (169 in lbs)	4 mm	6.0 Nm (53 in lbs)
M10 x 1.5	16 mm	38.0 Nm (335 in lbs)	5 mm	12.0 Nm (106 in lbs)

Dorner recommends FDA approved grease on all threaded stainless steel fasteners.

# Installation

## NOTE

Dorner recommends cleaning all the "food zones" prior to placing conveyor into service. Insure adequate access is provided for cleaning and servicing equipment so that the required level of hygiene can be maintained.

## NOTE

Conveyor **MUST** be mounted straight, flat, and level within confines of conveyor. Use a level (**Figure 3, item 1**) during setup.

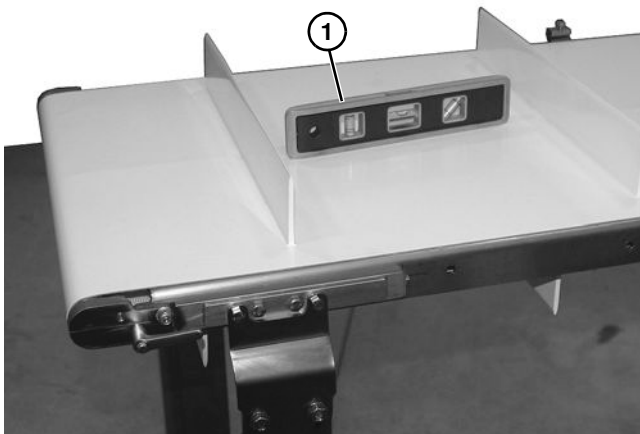

Figure 3

## Required Tools

- 8 mm wrench
- 10 mm wrench
- 13 mm wrench
- Level
- Torque wrench

## Recommended Installation Sequence

- Assemble conveyor (if required)
- Attach stands/mounting brackets to conveyor (see "Stand Installation" on page 11)
- Install gearmotor mounting package (see Gearmotor Mounting Packages manual 851-968)
- Attach return rollers (see "Belt Returns" on page 12)
- Attach guides/accessories (see "Service Parts" section starting on page 29)

## Conveyors Up to 2998 mm (118")

No assembly is required. Install stands/mounting brackets and return rollers. Refer to "Attaching Conveyor to Stands or Mounting Brackets" on page 11 and "Return Rollers" on page 12.

## Conveyors Longer than 2998 mm (118")

### Connecting Components

Typical connecting components (**Figure 4**).

- |   |                          |
|---|--------------------------|
| 1 | Conveyor frame           |
| 2 | Conveyor frame extension |
| 3 | Connector Strips (2x)    |
| 4 | Screws (4x)              |
| 5 | Screws (8x)              |

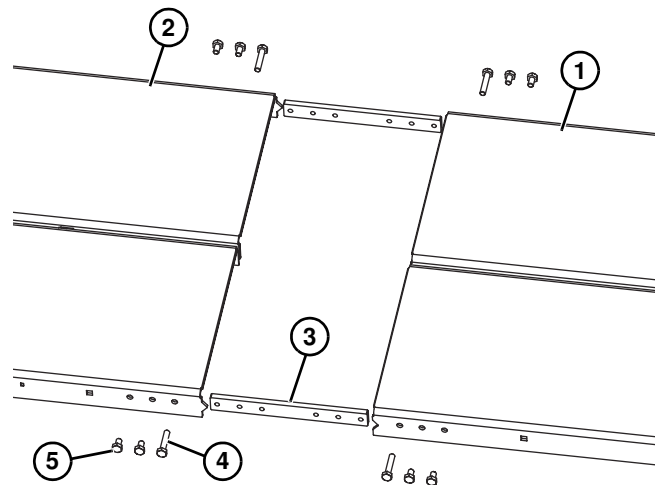

Figure 4

1. Install frame connecting bar (**Figure 5, item 1**) on conveyor frame (**Figure 5, item 2**) with two shorter screws (**Figure 5, item 3**) and one long screw (**Figure 5, item 4**). Do not tighten screws.

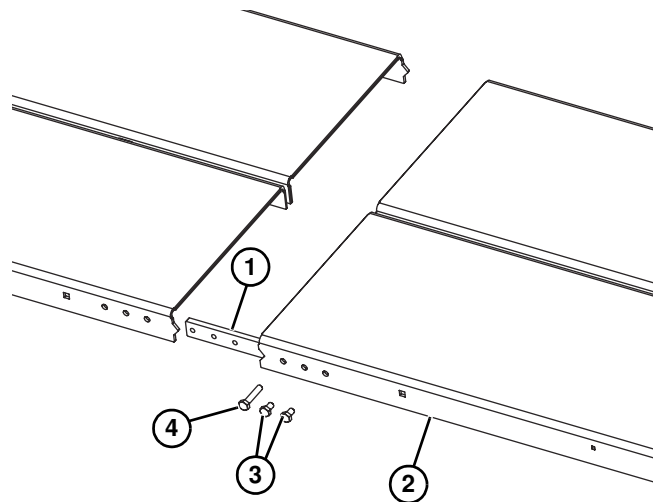
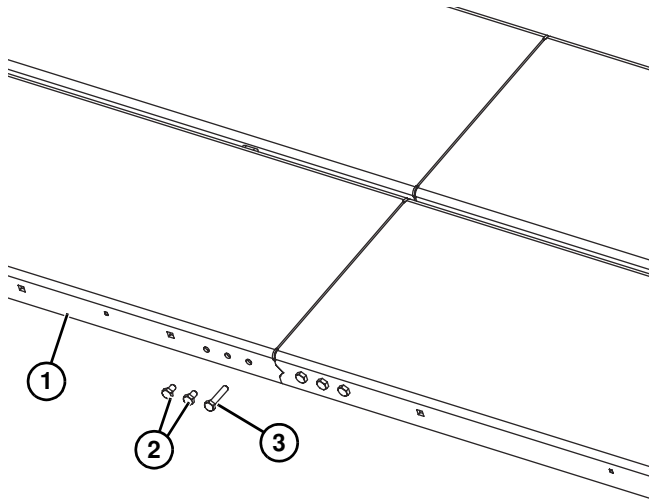

Figure 5

2. Repeat step on the opposite side of conveyor frame.



3. Install conveyor frame extension (**Figure 6, item 1**) on frame connecting bar with two short screws (**Figure 6, item 2**) and one long screw (**Figure 6, item 3**). Install three screws on opposite side.



**Figure 6**

4. Tighten the six screws on each side.

## Belt Installation

1. Loosen belt fastener (**Figure 7**) or tool-less fastener (**Figure 8**) on both sides of conveyor.

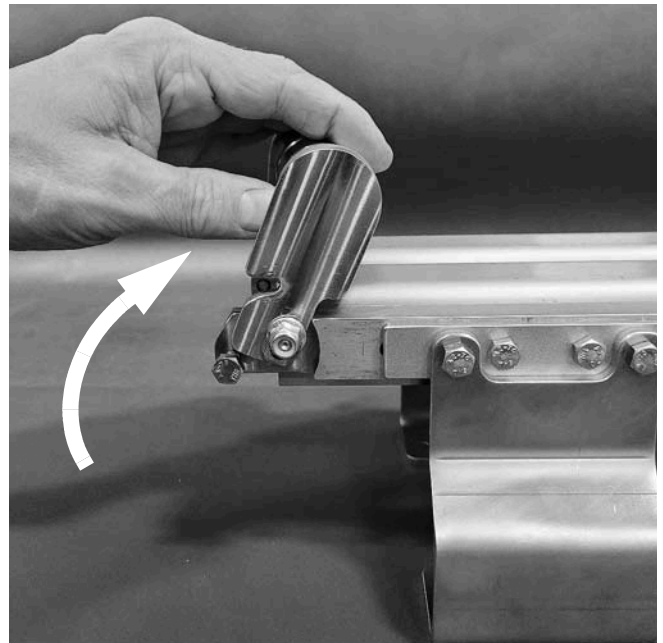

**Figure 7**



**Figure 8**

2. Rotate idler tail up (**Figure 9**).



**Figure 9**



## CAUTION

Pinch point occurs when rotating idler end.  
Use caution.

# Installation

3. Orient belt so splice outer fingers (**Figure 10, item 1**) point in the direction of belt travel as identified by the conveyor directional label (**Figure 10, item 2**).

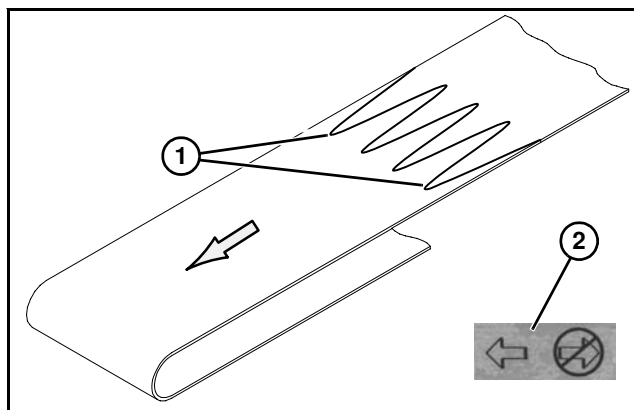

**Figure 10**

4. Install belt (**Figure 11, item 1**) on conveyor.

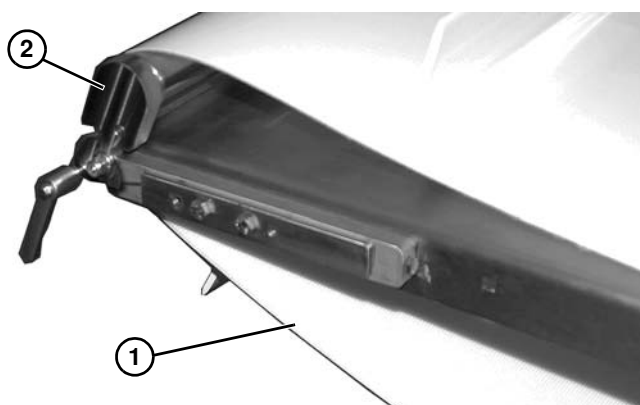

**Figure 11**

5. Lower idler end (**Figure 11, item 2**).

## CAUTION

Pinch point occurs when rotating idler end. Use caution.

6. Tension conveyor belt, if required. See "Conveyor Belt Tensioning" on page 21.
7. Track conveyor belt, if required. See "Conveyor Belt Tracking" on page 21.

## Table Top Mounting Bracket Installation

Typical table top mounting bracket components (**Figure 12**).

1	Mounting Bracket (x2)
2	Spacer (x4) (conveyor frame mount)
3	Carriage Bolt (x4) (conveyor frame mount)
4	Nut (x8)
5	Screw (x4)
6	Screw (x4) (conveyor tail mount)

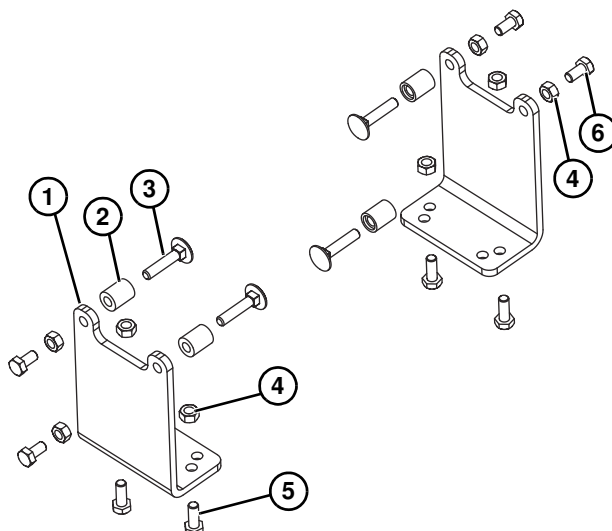

**Figure 12**

1. Drive End: Install carriage bolt (**Figure 13, item 1**) through square hole in conveyor frame on each side.

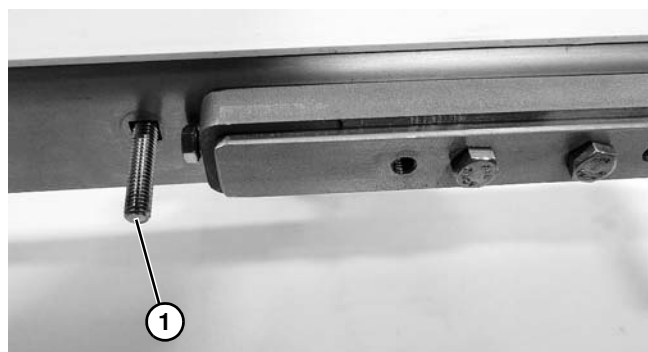

**Figure 13**

2. Drive End: Install table top mounting bracket (**Figure 14, item 1**) with carriage bolt, spacer, and nut (**Figure 14, item 2**), and screw (**Figure 14, item 3**) on each side.

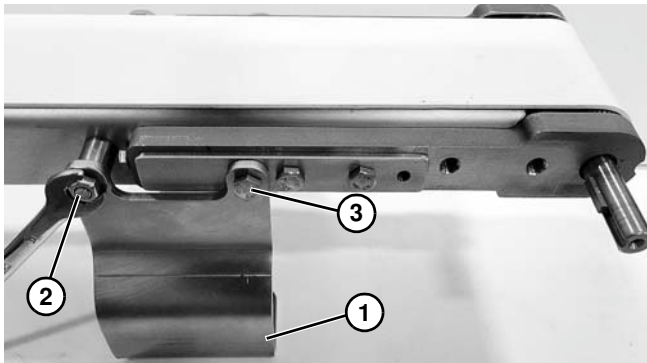

**Figure 14**

3. Idler End: Install table top mounting bracket (**Figure 15, item 1**) with two screws (**Figure 15, item 2**) on each side.

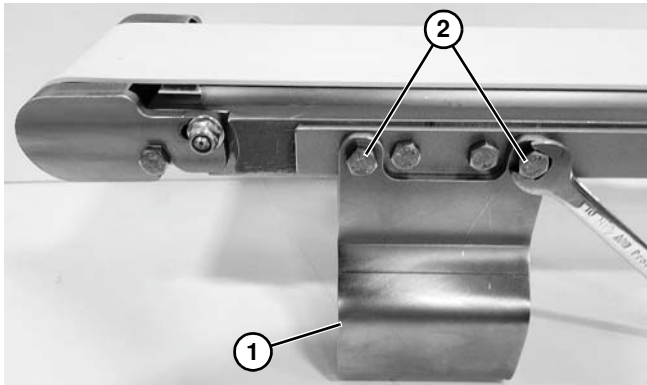

**Figure 15**

4. Center (if applicable): Attach table top mounting bracket (**Figure 16, item 1**) to the conveyor frame with two spacers (**Figure 16, item 2**) and two carriage bolts and nuts (**Figure 16, item 3**) on each side.

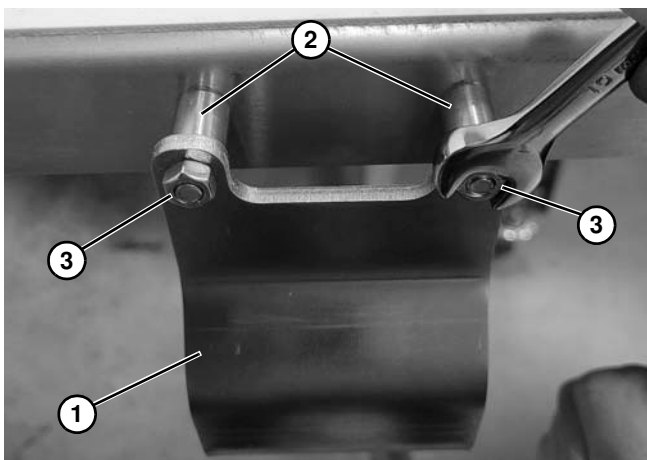

**Figure 16**

## Stand Installation

### NOTE

*For detailed assembly instructions, please see support stands manual 851-969.*

Typical stand components (**Figure 17**).

1	Conveyor Frame
2	Stand
3	Bracket
4	Carriage Bolt (x4) (conveyor frame mount)
5	Spacer (x4) (conveyor frame mount)
6	Nut (x4) (conveyor frame mount)
7	Screw (x4) (conveyor tail mount)

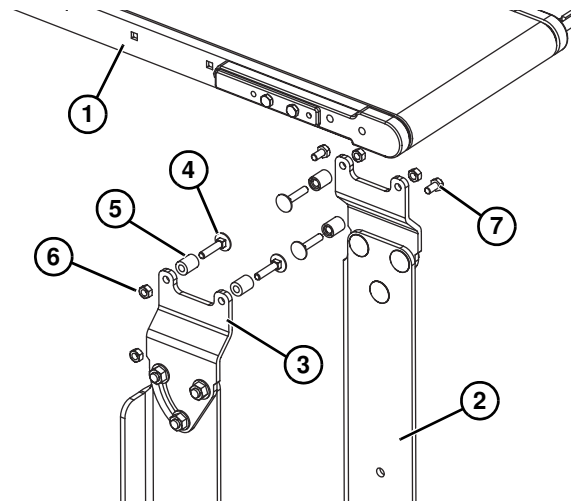

**Figure 17**

1. Position the stands on a flat, level surface.
2. Attach the stands to the frame:
  - Idler End: Attach stand to the conveyor frame with two screws (**Figure 18, item 1**) on each side.

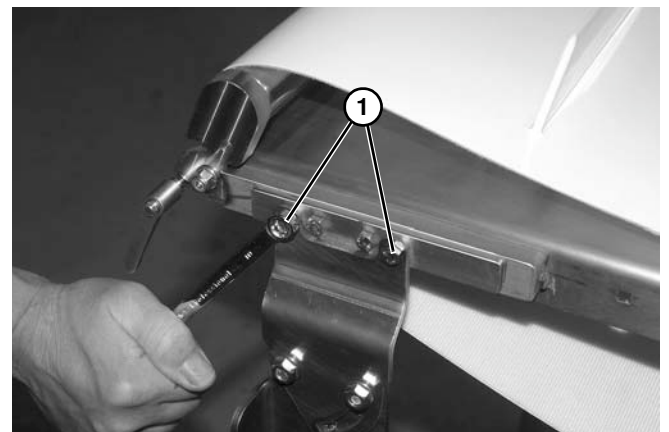

**Figure 18**

# Installation

- Center (if applicable): Attach stand to the conveyor frame with two spacers (**Figure 19, item 1**) and two carriage bolts and nuts (**Figure 19, item 2**) on each side.

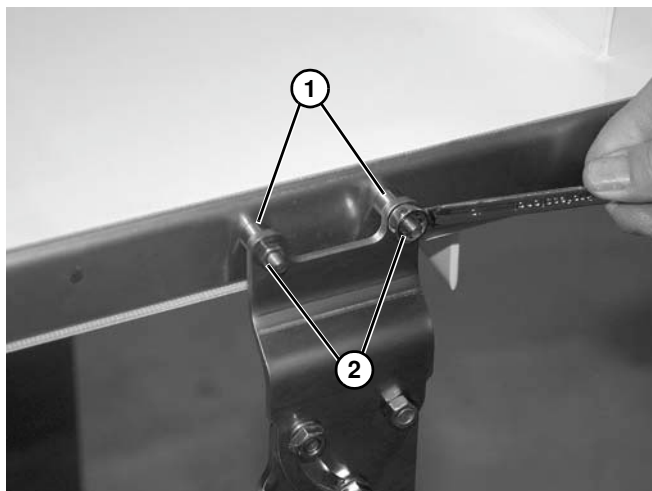

**Figure 19**

- Drive End: Attach stand to the conveyor frame with one spacer (**Figure 20, item 1**) using a carriage bolt and nut (**Figure 20, item 2**), and a screw (**Figure 20, item 3**) on each side.

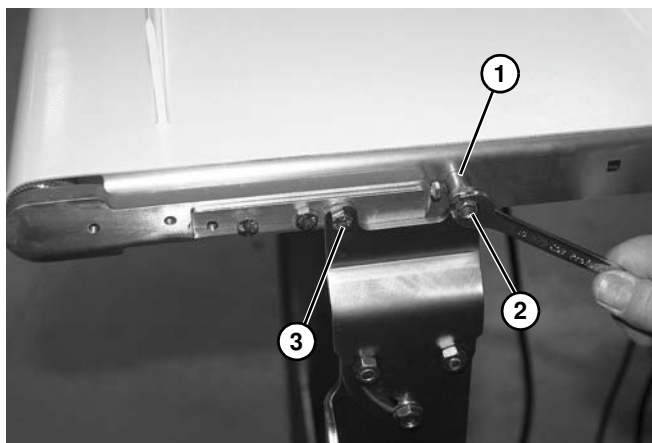

**Figure 20**

3. Tighten screws.

## Belt Returns

### Cleated Belt and Flat Belt Returns 70 mm - 152 mm Wide

Typical cleated return components (**Figure 21**).

1	Clip Bracket
2	Shaft Bracket
3	Carriage Bolt
4	Stub Shaft
5	Puck
6	Spacer
7	Nut

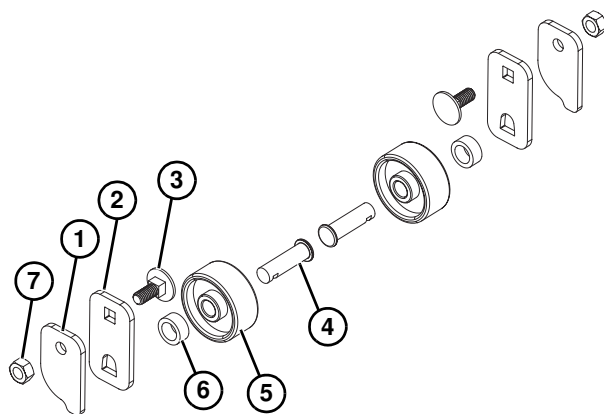

**Figure 21**

1. Install carriage bolt (**Figure 22, item 1**) through square hole in conveyor frame.

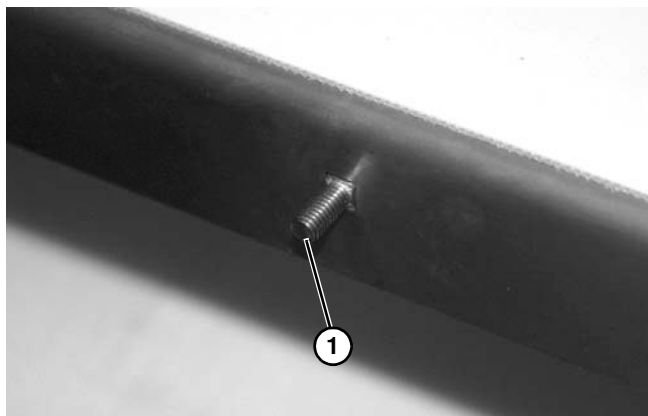
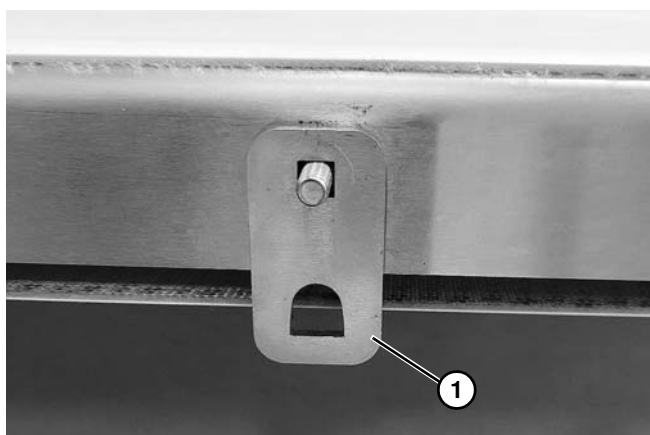

**Figure 22**



# Installation

2. Install shaft bracket (**Figure 23, item 1**) onto carriage bolt.



**Figure 23**

3. Install clip bracket (**Figure 24, item 1**) onto shaft bracket (**Figure 24, item 2**) and carriage bolt. Secure with nut (**Figure 24, item 3**). Leave assembly loose. Do not tighten at this time. Repeat on opposite side of conveyor.

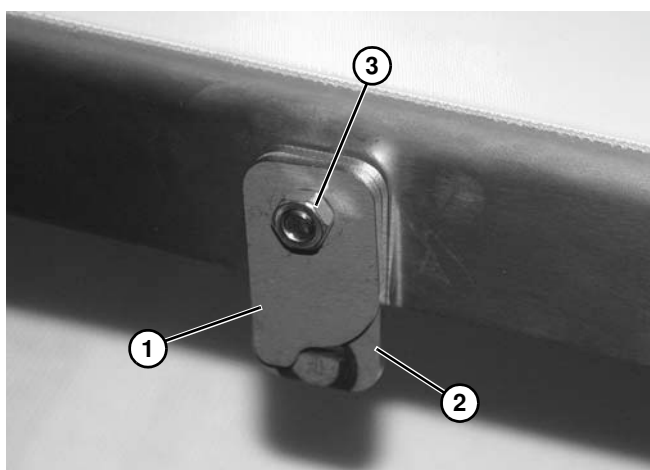

**Figure 24**

4. Assemble spacer tube (**Figure 25, item 1**) and roller (**Figure 25, item 2**) onto shaft (**Figure 25, item 3**).

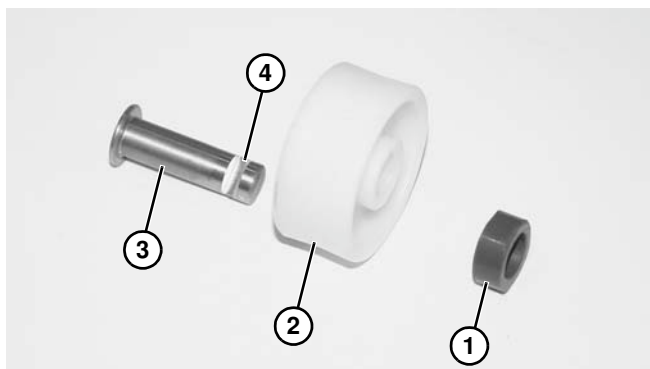
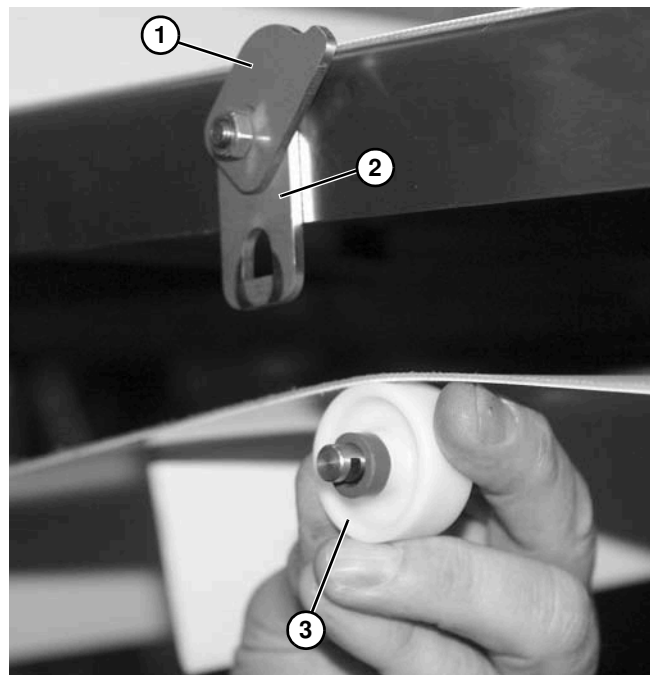

**Figure 25**

## NOTE

*Note orientation of components and notch (**Figure 25, item 4**) on shaft before installing assembly. Notch will be facing down to attach into retainer plate on conveyor.*

5. Raise clip bracket (**Figure 26, item 1**) from shaft bracket (**Figure 26, item 2**) on conveyor.



**Figure 26**

6. Install roller assembly (**Figure 26, item 3**) onto shaft bracket (**Figure 26, item 2**) on both sides of conveyor.
7. Make certain notch (**Figure 27, item 1**) in shaft is inserted into shaft bracket (**Figure 27, item 2**), and lower clip bracket (**Figure 27, item 3**) over shaft and shaft bracket.

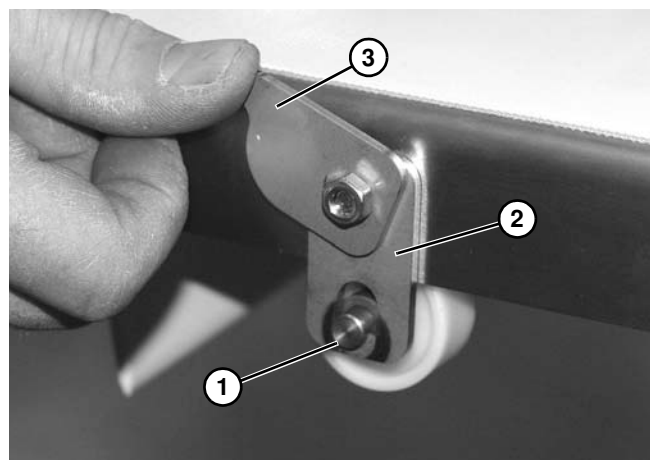

**Figure 27**

8. Tighten nut (**Figure 28, item 1**).

# Installation

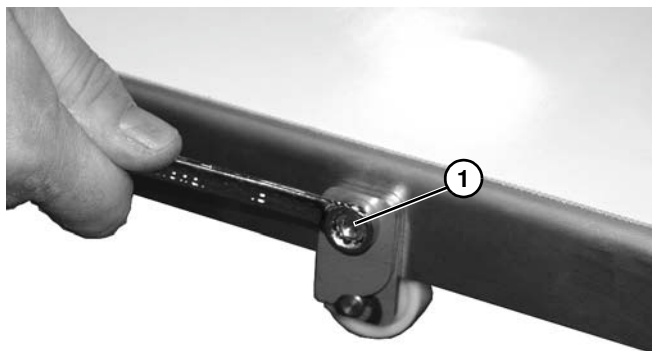

**Figure 28**

9. Repeat steps to install roller assembly on opposite side of conveyor.

## Flat Belt Returns over 152 mm Wide

Typical flat return components (Figure 29).

- |   |                 |
|---|-----------------|
| 1 | Clip Bracket    |
| 2 | Shaft Bracket   |
| 3 | Carriage Bolt   |
| 4 | Shaft           |
| 5 | End Spacer Tube |
| 6 | Spacer Tube     |
| 7 | Puck            |
| 8 | Nut             |

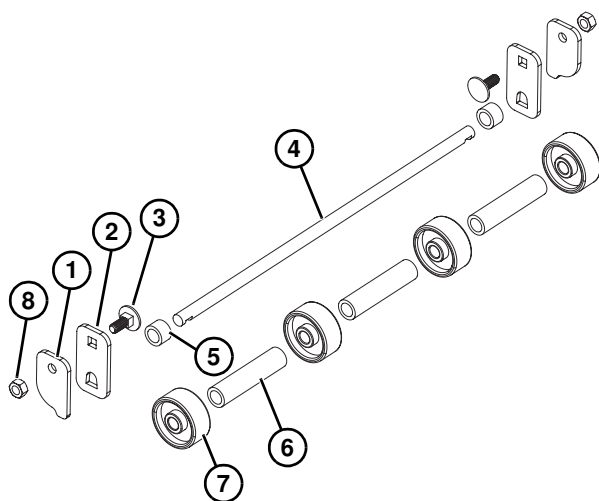

**Figure 29**

1. Install carriage bolt (Figure 30, item 1) through square hole in conveyor frame.

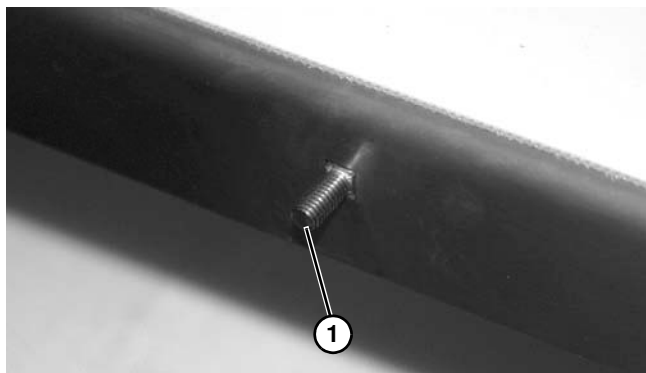

**Figure 30**

2. Install shaft bracket (Figure 31, item 1) onto carriage bolt.

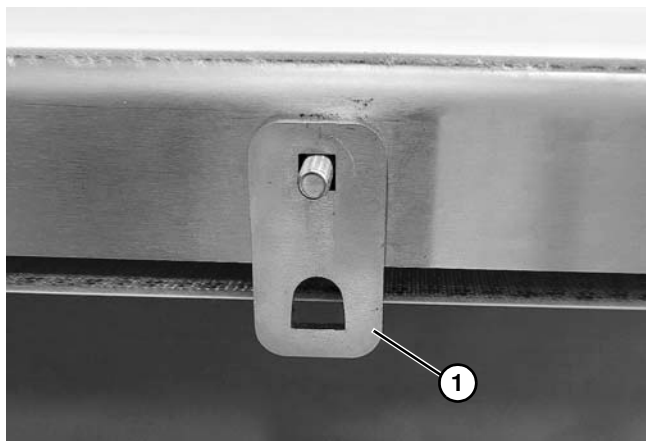

**Figure 31**

3. Install clip bracket (Figure 32, item 1) onto shaft bracket (Figure 32, item 2) and carriage bolt. Secure with nut (Figure 32, item 3). Leave assembly loose. Do not tighten at this time. Repeat on opposite side of conveyor.

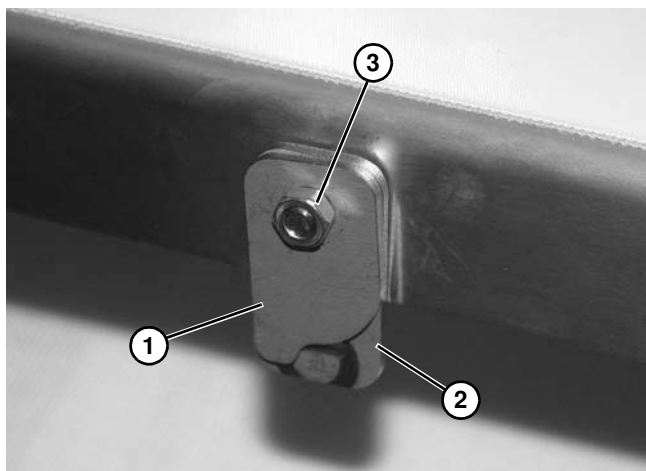

**Figure 32**

## Installation

4. Assemble spacer tubes (**Figure 33, item 1**), rollers (**Figure 33, item 2**), and end spacer tubes (**Figure 33, item 3**) onto shaft (**Figure 33, item 4**).

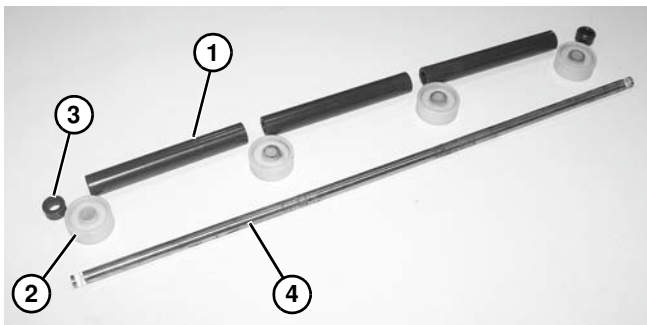

Figure 33

### NOTE

*Note orientation of components and notch (**Figure 34, item 1**) on shaft before installing assembly. Notch will be facing down to attach into retainer plate on conveyor.*

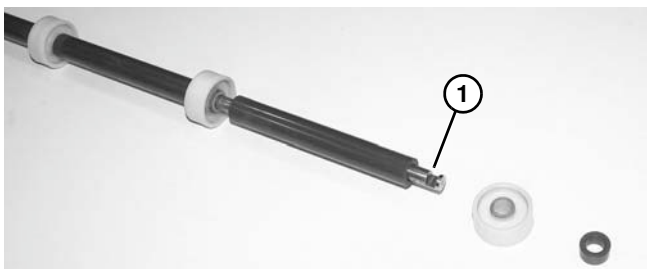

Figure 34

5. Raise clip bracket (**Figure 35, item 1**) from shaft bracket (**Figure 35, item 2**) on conveyor.

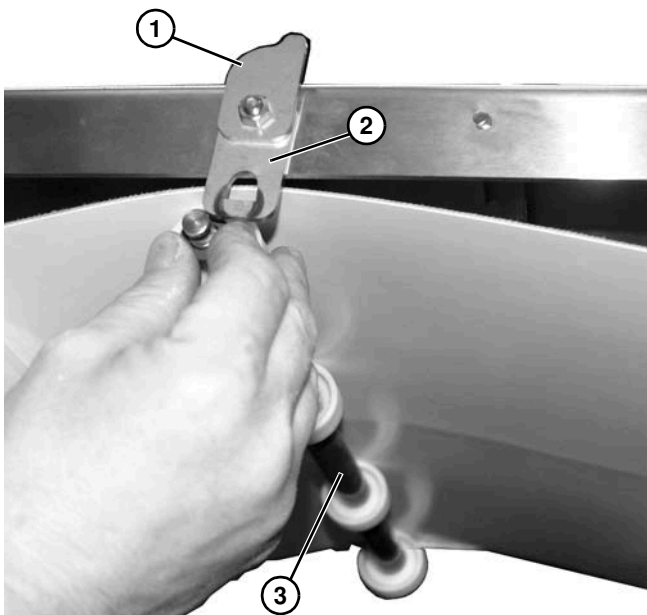

Figure 35

6. Install roller assembly (**Figure 35, item 3**) onto shaft brackets (**Figure 35, item 2**) on both sides of conveyor.
7. Make certain notch (**Figure 36, item 1**) in shaft is inserted into shaft bracket (**Figure 36, item 2**), and lower clip bracket (**Figure 36, item 3**) over shaft and shaft bracket. Repeat on opposite side of conveyor.



Figure 36

8. Tighten nut (**Figure 37, item 1**).

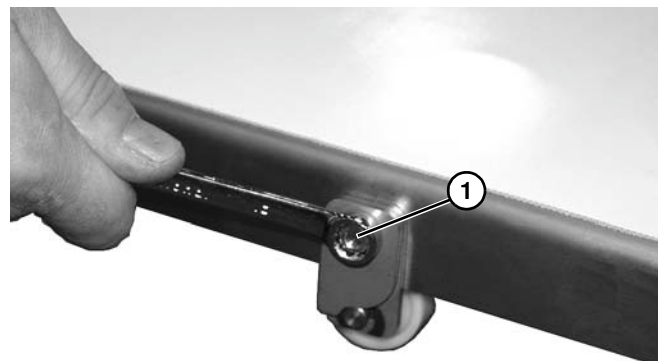

Figure 37

# Installation

## Guide Installation

### Fixed Guides

1. Install carriage bolt (**Figure 38, item 1**) through square hole (**Figure 38, item 2**) in conveyor frame, and install guide bracket (**Figure 38, item 3**).

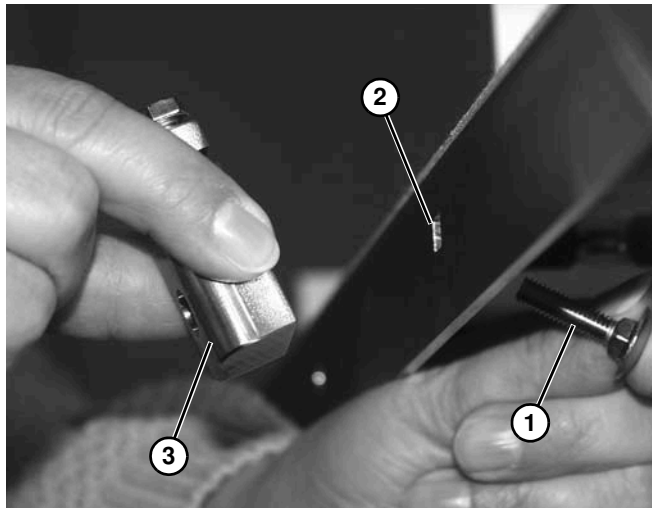

**Figure 38**

2. Use a nut (**Figure 39, item 1**) to secure guide bracket with carriage bolt. Tighten nut.

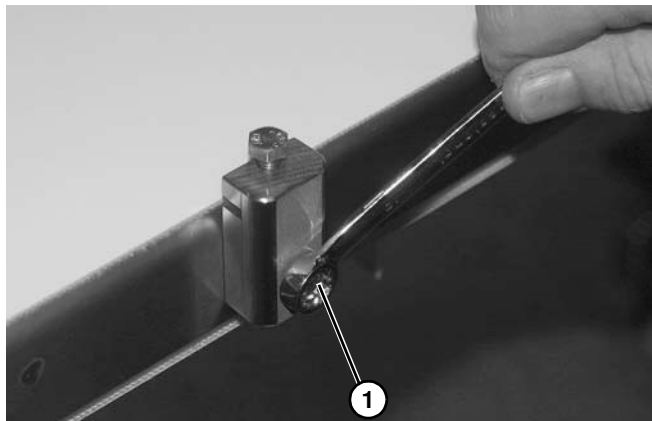
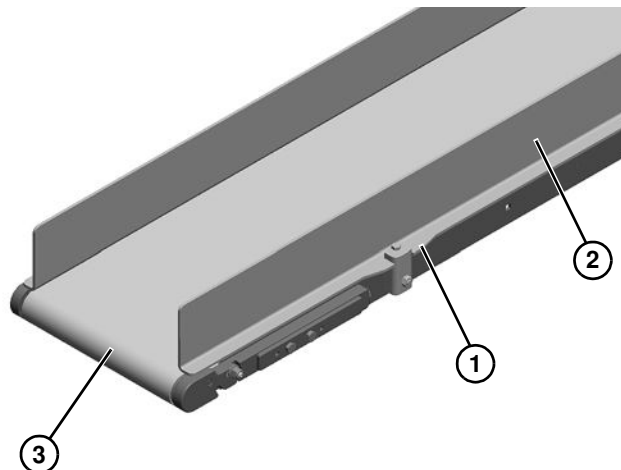

**Figure 39**

3. Repeat for remaining guide brackets required for your conveyor size.

#### NOTE

The guide location notch (**Figure 40, item 1**) on the high sides (**Figure 40, item 2**) must be positioned at the infeed end of the conveyor (**Figure 40, item 3**).



**Figure 40**

4. Install high sides (**Figure 41, item 1**) onto the guide brackets (**Figure 41, item 2**). Tighten screw (**Figure 41, item 3**) to secure.

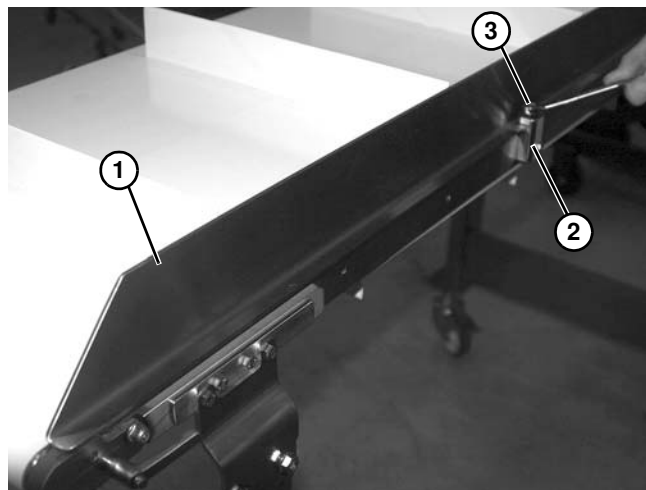

**Figure 41**

5. For conveyors over 2998 mm (118") long, connect guides (**Figure 42, item 1**) by installing connector plate(s) (**Figure 42, item 2**) onto studs (**Figure 42, item 3**) on guiding. Secure onto guide brackets (**Figure 42, item 4**).

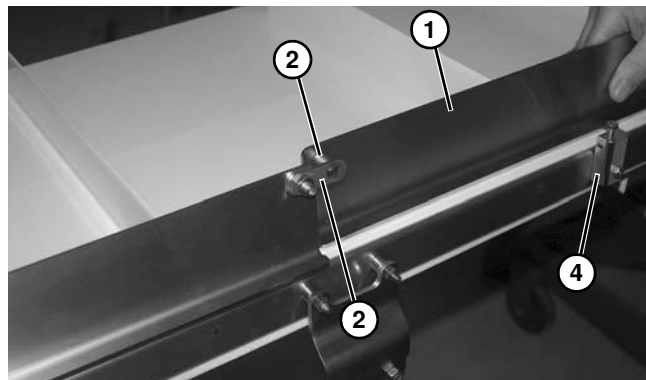
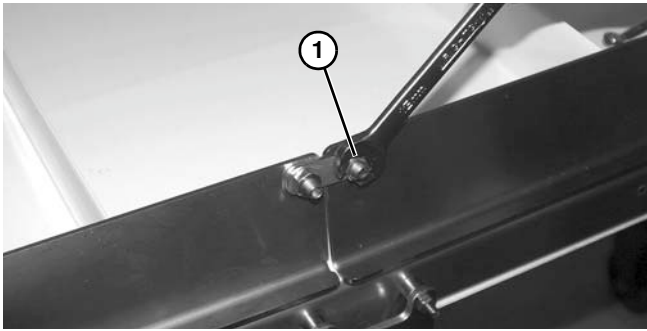

**Figure 42**



# Installation

6. Install and tighten nut (**Figure 43, item 1**) on stud to secure.

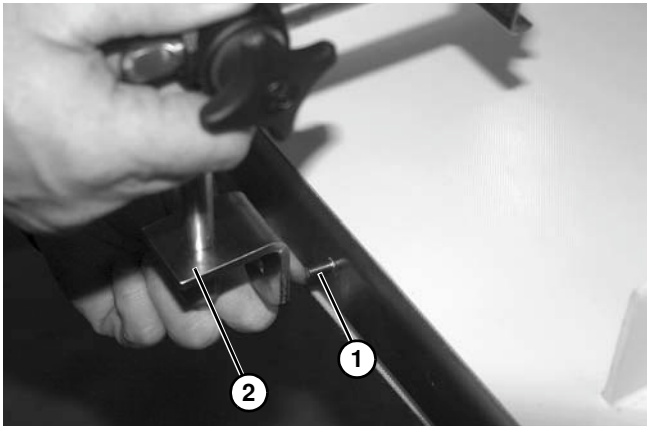

**Figure 43**

7. Repeat on the opposite side of conveyor.

## Adjustable Guides

1. Install carriage bolt (**Figure 44, item 1**) through square hole in frame, and install rail clamp (**Figure 44, item 2**) on to carriage bolt.



**Figure 44**

2. Install and tighten nut (**Figure 45, item 1**) onto carriage bolt to secure guide rail.

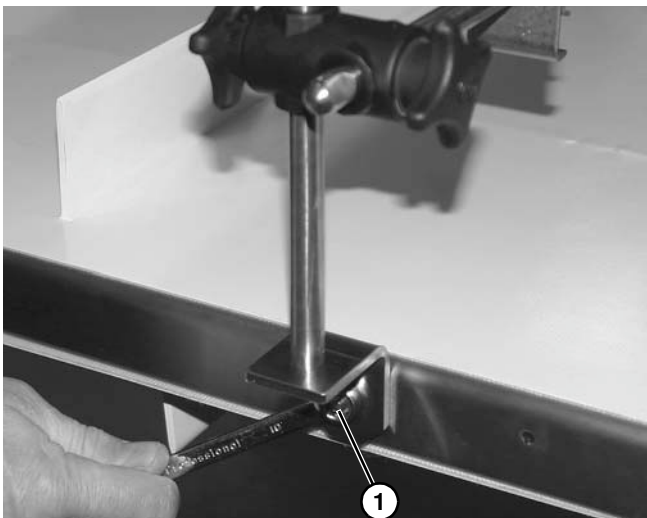

**Figure 45**

3. Install guide rail (**Figure 46, item 1**) onto guide brackets (**Figure 46, item 2**). Tighten screw (**Figure 46, item 3**) to secure.

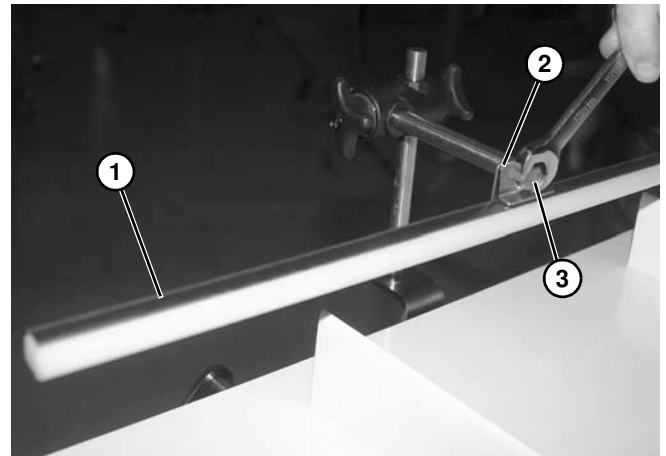

**Figure 46**

4. Loosen knob (**Figure 47, item 1**), and adjust the guide post (**Figure 47, item 2**) height, as needed. Tighten knob.

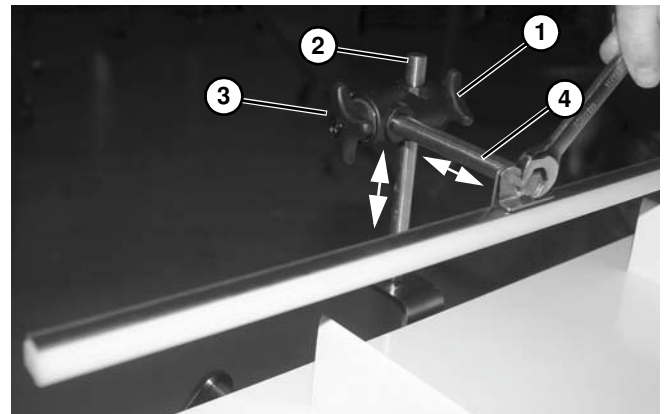

**Figure 47**

5. Loosen knob (**Figure 47, item 3**), and adjust the horizontal guide post (**Figure 47, item 4**) and guide rail, as needed. Tighten knob.
6. Repeat, as needed for remaining guiding brackets.

## Drive Package Installation

### NOTE

*For detailed assembly instructions, please see Gearmotor Mounting Packages manual 851-968.*

---

# Preventive Maintenance and Adjustment

---

## Required Tools

- 8 mm wrench
- 10 mm wrench
- 13 mm wrench
- Level
- Torque wrench

## Checklist

- Keep critical service parts on hand. Refer to the "Service Parts" section starting on page 29 for recommendations.
- Clean entire conveyor while disassembled
- Replace any worn or damaged parts.

## Cleaning

### NOTE

*Proper conveyor application, cleaning, and sanitation are the responsibility of the end user.*

### ⚠ CAUTION

**Dorner recommends cleaning all the "food zones" prior to placing conveyor into service. Ensure adequate access is provided for cleaning and servicing equipment so that the required level of hygiene can be maintained.**

### ⚠ WARNING



#### SEVERE HAZARD!

**LOCK OUT POWER before removing guards or performing maintenance. Exposed moving parts can cause serious injury.**

Use Dorner Belt Cleaner. Mild soap and water may also be used. Do not soak the belt.

For /05 woven polyester and /06 black anti-static belts, use a bristled brush to improve cleaning.

## Lubrication

### Conveyor Bearings

No lubrication is required. Replace bearings if worn.

### Return Rollers

No lubrication is required. Replace rollers if worn.

## Maintaining the Conveyor Belt

### Troubleshooting

Inspect conveyor belt for:

- Surface cuts or wear
- Stalling or slipping
- Damage to V-guide

Surface cuts and wear indicate:

- Sharp or heavy parts impacting belt
- Jammed parts
- Improperly installed bottom wipers (if installed)
- Accumulated dirt in wipers (if installed)
- Foreign material inside the conveyor
- Improperly positioned accessories
- Bolt-on guiding is pinching belt

Stalling or slipping indicates:

- Excessive load on belt
- Conveyor belt or drive timing belt are not properly tensioned
- Worn knurl or impacted dirt on drive pulley
- Intermittent jamming or drive train problems

Damage to V-guide indicates:

- Twisted or damaged conveyor frame
- Dirt impacted on pulleys
- Excessive or improper side loading

# Preventive Maintenance and Adjustment

## Conveyor Belt Replacement

 <b>WARNING</b>

<b>SEVERE HAZARD!</b> <b>LOCK OUT POWER</b> before removing guards or performing maintenance. Exposed moving parts can cause serious injury.

1. Remove guides (**Figure 48, item 1**) when required. See “Guide Installation” on page 16.

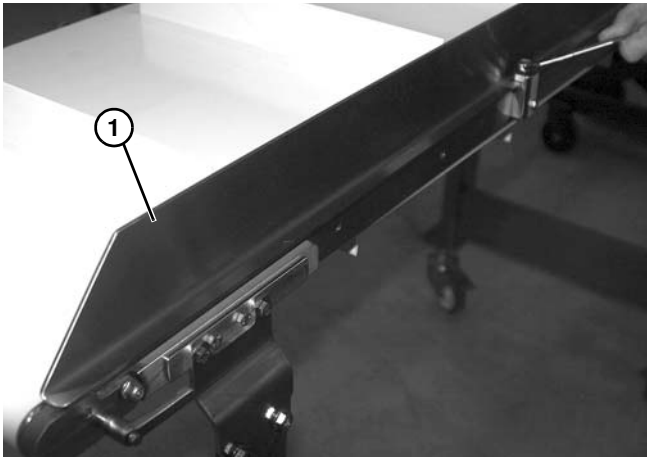

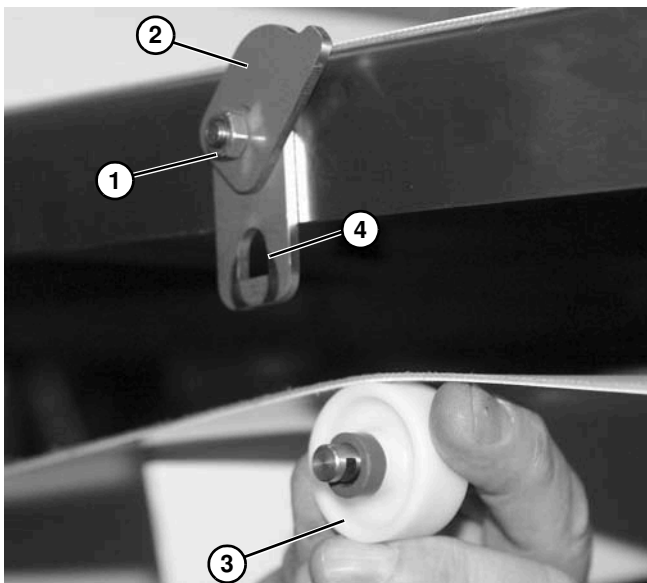

**Figure 48**

2. Loosen nut (**Figure 49, item 1**), raise clip bracket (**Figure 49, item 2**), and remove belt returns (**Figure 49, item 3**) from slotted holes (**Figure 49, item 4**) in shaft bracket. Repeat on both sides of conveyor frame, as needed.



**Figure 49**

 <b>WARNING</b>

<b>Removing mounting brackets without support will cause conveyor to tip, causing severe injury. PROVIDE SUPPORT UNDERNEATH THE CONVEYOR WHEN CHANGING THE BELT.</b>

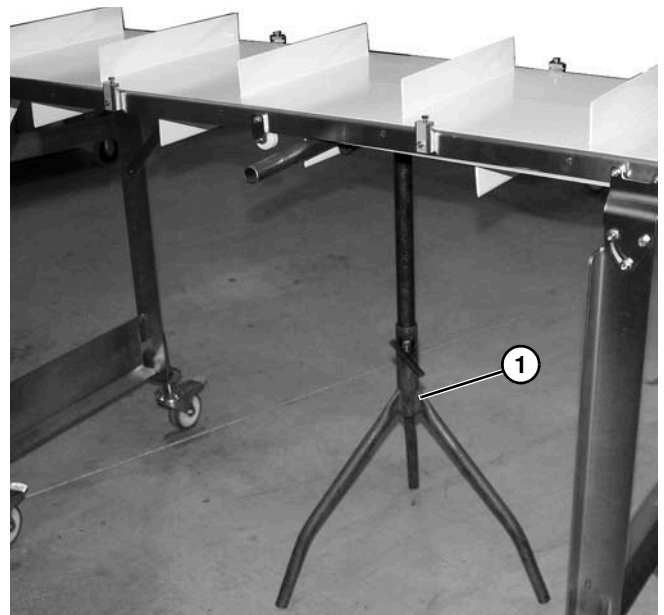
3. Place temporary support stands (**Figure 50, item 1**) at both ends of the conveyor. Place an additional support stand under the drive motor, if equipped. See **WARNING**.



**Figure 50**

4. Remove drive package (**Figure 51, item 1**). See Gearmotor Mounting Packages manual 851-968 for details.



**Figure 51**

# Preventive Maintenance and Adjustment

5. Loosen two screws (**Figure 52, item 1**) securing end plate (**Figure 52, item 2**) onto conveyor. Repeat on opposite side.

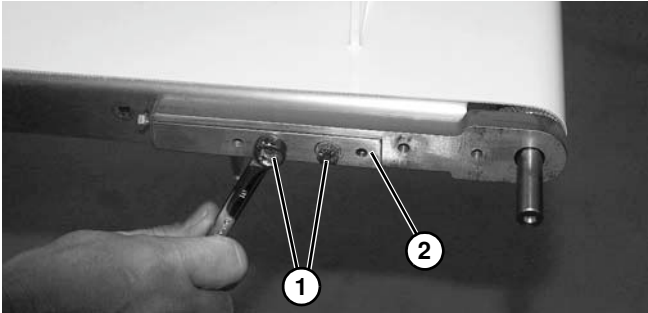

**Figure 52**

6. Rotate screw (**Figure 53, item 1**) counterclockwise to retract drive spindle assembly (**Figure 53, item 2**). Repeat on opposite side to approximately the same distance.

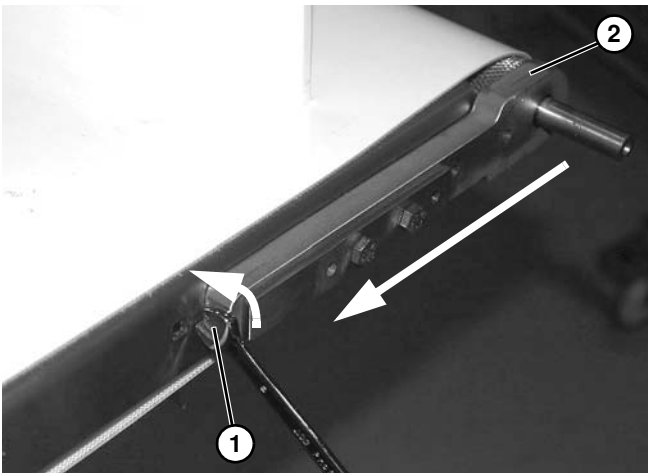

**Figure 53**

7. Repeat steps 6-7 on idler end of conveyor.
8. Rotate idler end (**Figure 54, item 1**) upward as shown.

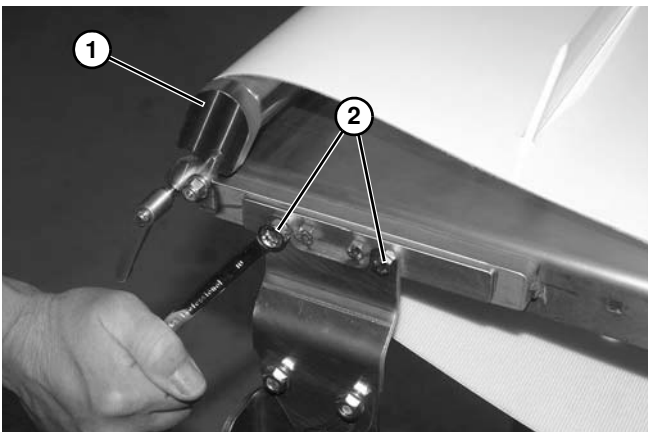
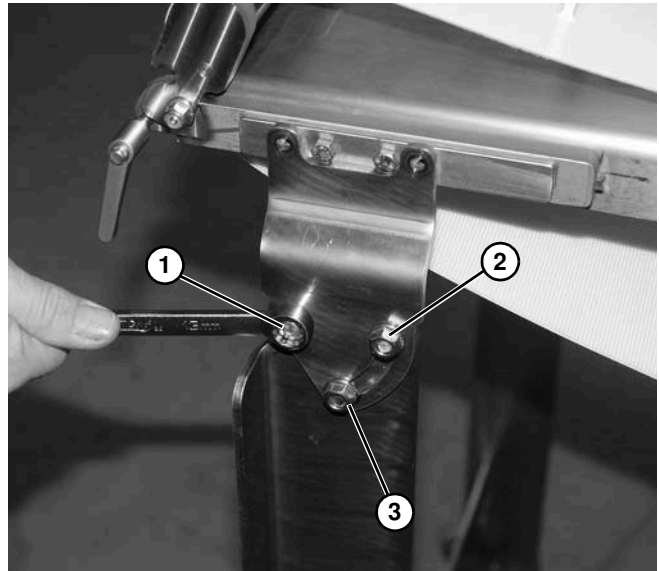

**Figure 54**

## **⚠ CAUTION**

**Pinch point occurs when rotating idler end.  
Use caution.**

9. Remove two screws (**Figure 54, item 2**) securing the stand brackets from one side of the conveyor.
10. Remove screw (**Figure 55, item 1**), and screw and nut (**Figure 55, item 2**) from conveyor bracket.



**Figure 55**

11. Loosen nut (**Figure 55, item 3**) on lower screw.
12. Lower stand bracket (**Figure 56, item 1**).

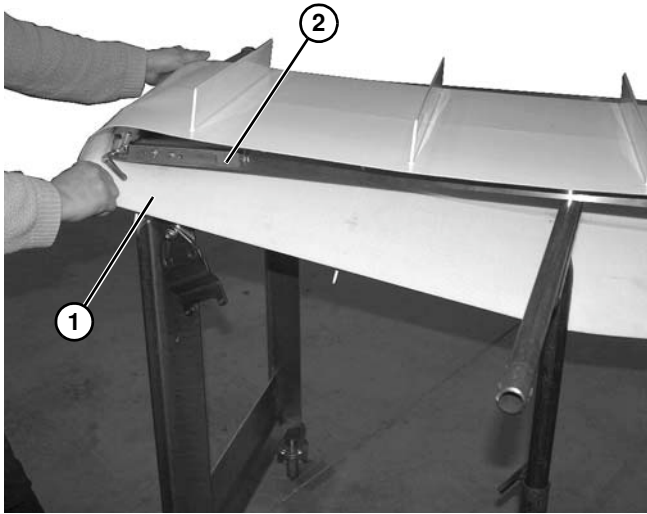

**Figure 56**



# Preventive Maintenance and Adjustment

13. Remove the belt (**Figure 57, item 1**) from the conveyor (**Figure 57, item 2**).



**Figure 57**

14. Repeat procedure for the opposite end of the conveyor to fully remove the belt.  
15. Reinstall the belt. Refer to “Belt Installation” on page 9.  
16. Reinstall belt returns.  
17. If equipped, reinstall guiding.  
18. Tension and track drive and conveyor if required. See “Conveyor Belt Tensioning” on page 21 and “Conveyor Belt Tracking” on page 21”.

## Conveyor Belt Tensioning

### **WARNING**



#### **SEVERE HAZARD!**

**LOCK OUT POWER** before removing guards or performing maintenance. Exposed moving parts can cause serious injury.

### **CAUTION**

Over-tensioning of conveyor may stretch conveyor belt and reduce bearing life.

1. On tension end of the conveyor, loosen two screws (**Figure 58, item 1**) on each side of conveyor.

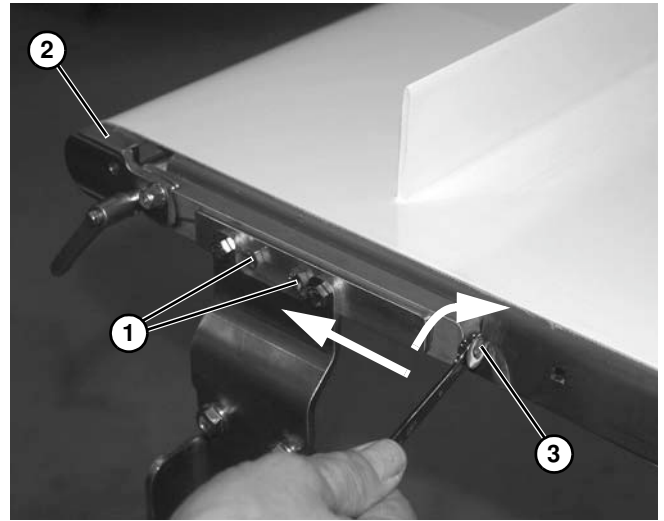

**Figure 58**

2. Extend idler spindle assembly (**Figure 58, item 2**) by turning screw (**Figure 58, item 3**) clockwise on both sides of the conveyor to sufficiently tension belt to handle conveyor load.  
3. Tighten four screws (**Figure 58, item 1**) to secure idler spindle assembly (**Figure 58, item 2**).

### **NOTE**

*If the maximum take-up stroke is achieved, replace the conveyor belt.*

4. Verify proper tracking. If belt tracking is necessary, adjust either side of idler tail end (See “Conveyor Belt Tracking” on page 21.) Repeat adjusting tension on drive end, as needed.

## Conveyor Belt Tracking

### **WARNING**



#### **SEVERE HAZARD!**

**LOCK OUT POWER** before removing guards or performing maintenance. Exposed moving parts can cause serious injury.

### **CAUTION**

Over-tensioning of conveyor may stretch conveyor belt and reduce bearing life.

# Preventive Maintenance and Adjustment

1. On tension end of the conveyor, loosen two screws (**Figure 59, item 1**) on one side of conveyor.

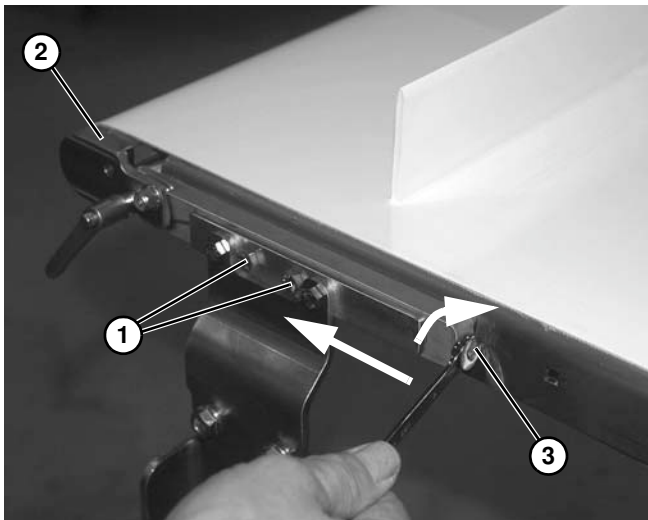

**Figure 59**

2. Extend idler spindle assembly (**Figure 59, item 2**) by turning screw (**Figure 59, item 3**) clockwise to apply tension belt or counterclockwise to remove tension on belt.
3. Tighten two screws (**Figure 59, item 1**) to secure idler spindle assembly (**Figure 59, item 2**).

## NOTE

*If the maximum take-up stroke is achieved, replace the conveyor belt.*

## Pulley Replacement

### WARNING



#### SEVERE HAZARD!

**LOCK OUT POWER** before removing guards or performing maintenance. Exposed moving parts can cause serious injury.

Remove conveyor belt to access pulley(s). See "Conveyor Belt Replacement" on page 19. Remove the desired pulley following instructions:

- A – Drive Pulley
- B – Idler Pulley

## A – Drive Pulley

### WARNING



#### PUNCTURE HAZARD!

Handle drive shaft keyway with care. It may be sharp and could puncture the skin, causing serious injury.

1. Remove the gearmotor mounting package. See Gearmotor Mounting Packages manual 851-968 for details.
2. Remove two screws (**Figure 60, item 1**) and connecting strip (**Figure 60, item 2**) from side of conveyor opposite drive shaft.

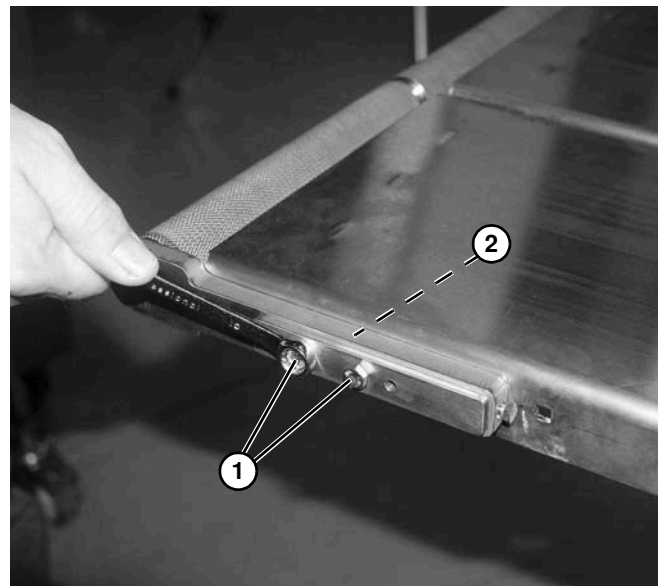

**Figure 60**

## Preventive Maintenance and Adjustment

3. Remove head plate (**Figure 61, item 1**) and drive pulley (**Figure 61, item 2**).

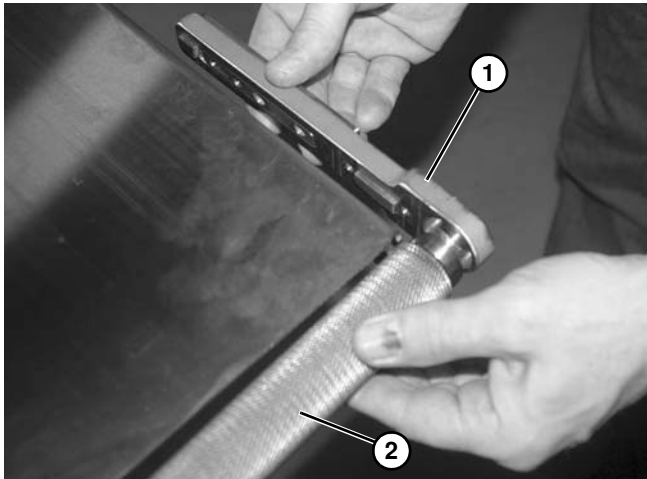

**Figure 61**

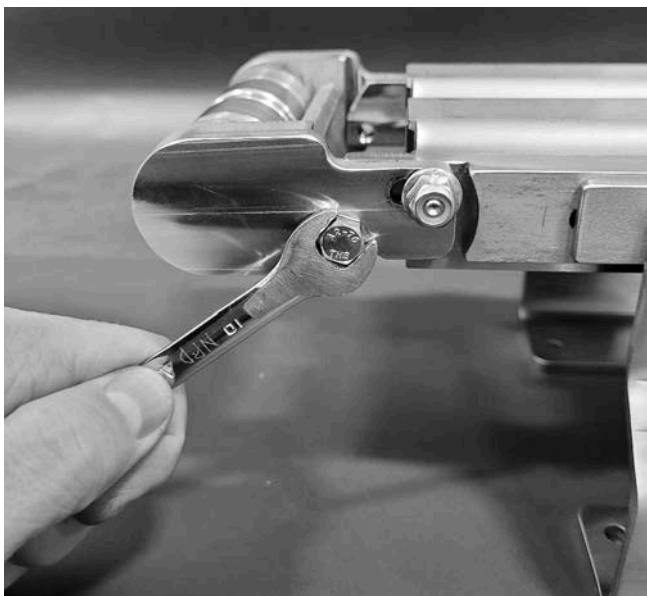

**Figure 62**

4. Install in reverse order of removal.

### B – Idler Pulley

1. Loosen belt fastener (**Figure 63**) or tool-less fastener (**Figure 64**) on both sides of conveyor.

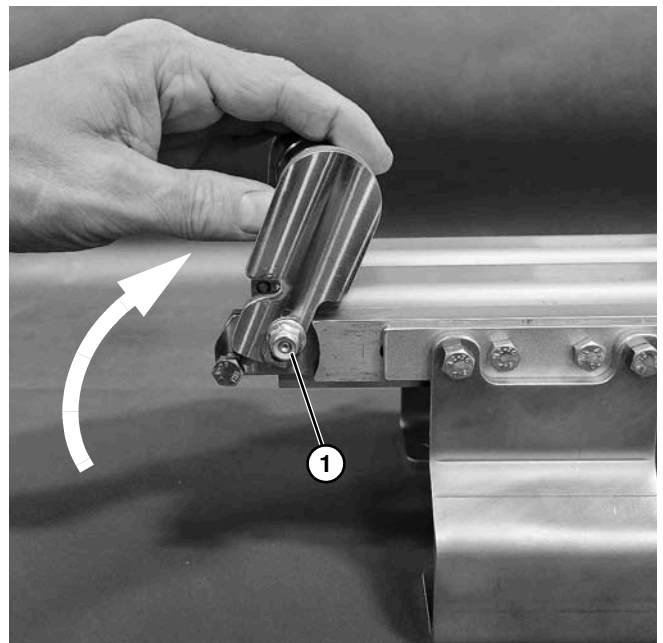

**Figure 63**



**Figure 64**

2. Rotate idler tail up (**Figure 65**).



**Figure 65**



### CAUTION

Pinch point occurs when rotating idler end.  
Use caution.

# Preventive Maintenance and Adjustment

3. Remove locknut (Figure 66, item 1).



Figure 66

4. Remove head plate (Figure 67, item 1) off of idler end stud (Figure 67, item 2), and remove from idler pulley (Figure 67, item 3) and cross support post (Figure 67, item 4).

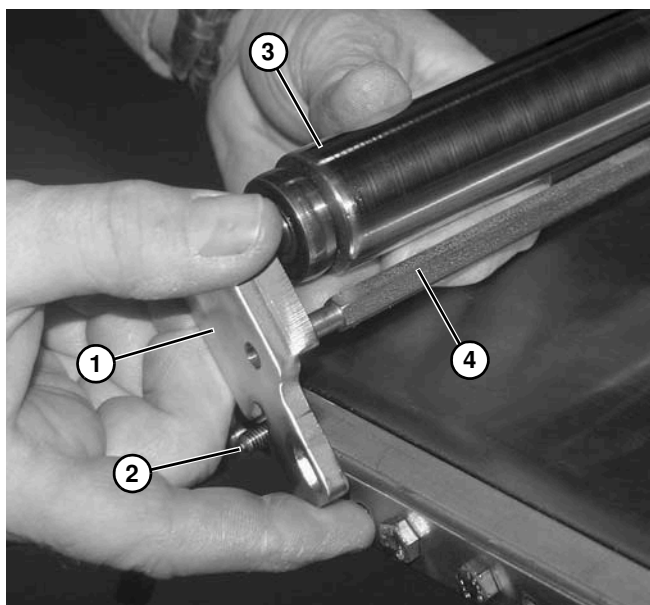

Figure 67



Figure 68

5. Install in reverse order of removal.

## Bearing Replacement for Drive or Idler Pulley

### ⚠ WARNING



#### SEVERE HAZARD!

LOCK OUT POWER before removing guards or performing maintenance. Exposed moving parts can cause serious injury.

### ⚠ WARNING



#### PUNCTURE HAZARD!

Handle drive shaft keyway with care. It may be sharp and could puncture the skin, causing serious injury.



# Preventive Maintenance and Adjustment

## Bearing Removal

### IMPORTANT

*Once removed, do not re-use bearings.*

1. Place bearing removal tool (**Figure 69, item 1**) (part # 456063) below bearing (**Figure 69, item 2**) with lip (**Figure 69, item 3**) located in gap (**Figure 69, item 4**) between bearing and spindle hub (**Figure 69, item 5**) as shown.

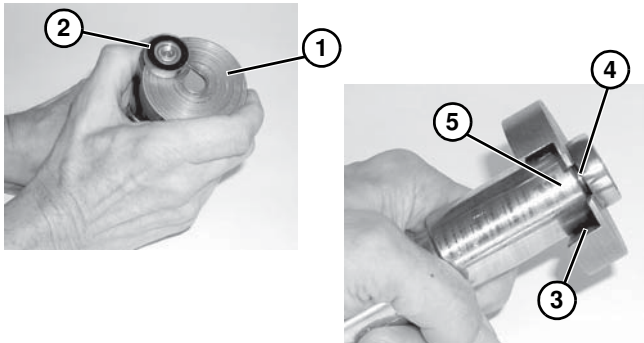

**Figure 69**

2. Using a puller (**Figure 70, item 1**), remove and discard bearing.

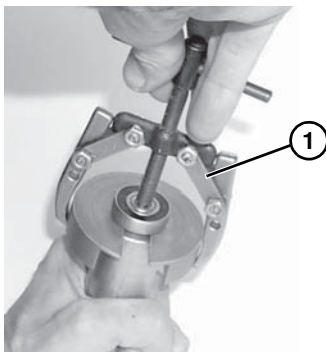

**Figure 70**

## Bearing Installation

1. Inspect bearing seating surface(s) for damage. Replace spindle if damaged.
2. Slide bearing (part # 240338) (**Figure 71, item 1**) onto spindle (**Figure 71, item 2**).

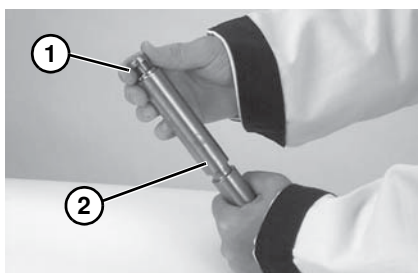

**Figure 71**

3. Slide sleeve (**Figure 72, item 1**) of tool (part # 456085) over bearing.

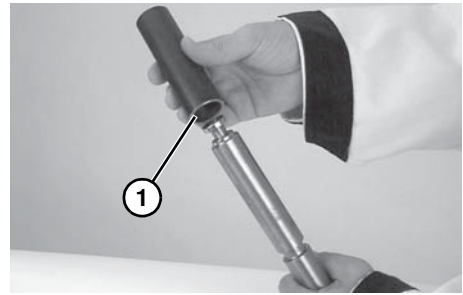

**Figure 72**

4. Place open end of pusher (**Figure 73, item 1**) into sleeve.

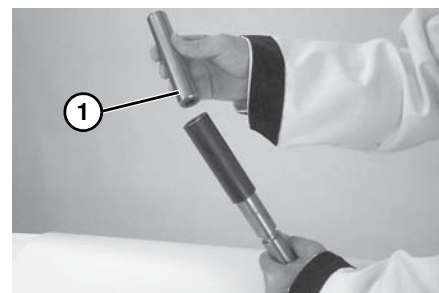

**Figure 73**

5. Using an arbor press or similar device, press bearing onto pulley shaft (**Figure 74**).

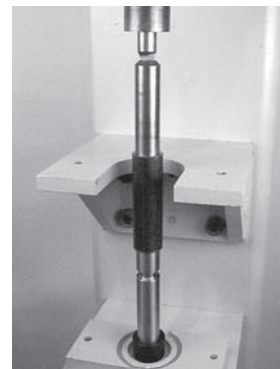

**Figure 74**

6. Repeat steps 1 through 5 for each bearing.

# Preventive Maintenance and Adjustment

## Belt Return Maintenance

<b>⚠ WARNING</b>

<b>SEVERE HAZARD!</b> LOCK OUT POWER before removing guards or performing maintenance. Exposed moving parts can cause serious injury.

### Cleated Belt and Flat Belt Returns 70 mm - 152 mm Wide

1. Loosen nut (Figure 75, item 1).

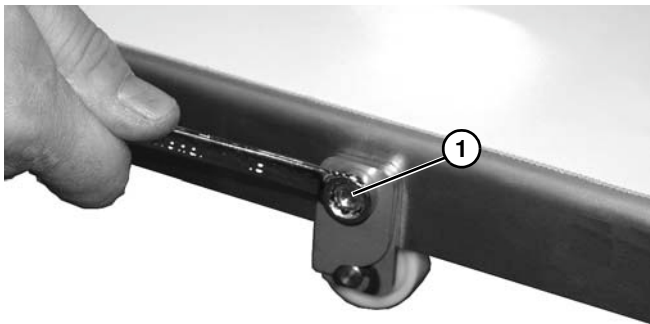

Figure 75

2. Raise clip bracket (Figure 76, item 1) from shaft bracket (Figure 76, item 2) on conveyor.

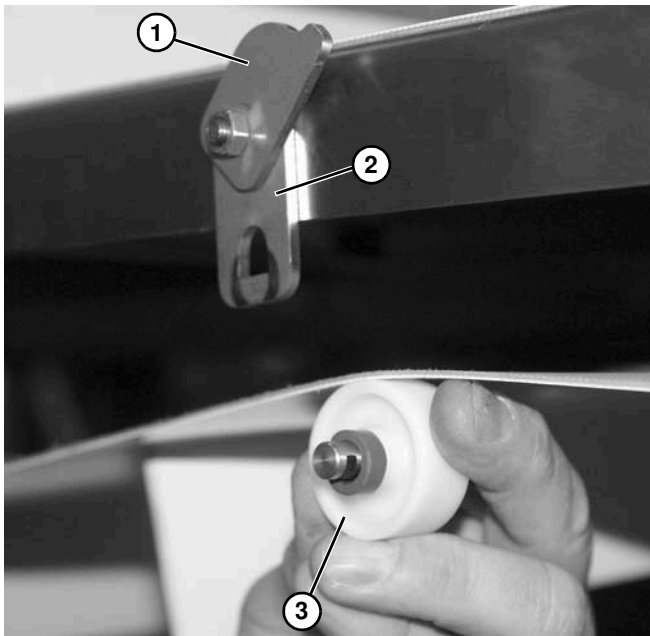

Figure 76

3. Remove roller assembly (Figure 76, item 3) from shaft bracket (Figure 76, item 2).

4. Disassemble spacer tube (Figure 77, item 1) and roller (Figure 77, item 2) from shaft (Figure 77, item 3).

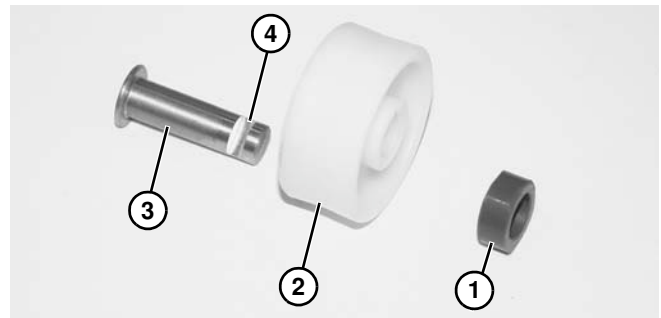

Figure 77

5. Replace damaged or worn parts.

### NOTE

*Note orientation of components and notch (Figure 77, item 4) on shaft before installing assembly. Notch will be facing down to attach into retainer plate on conveyor.*

6. Install roller assembly (Figure 78, item 1) onto shaft bracket (Figure 78, item 2) on both sides of conveyor.
7. Make certain notch (Figure 78, item 3) in shaft is inserted into shaft bracket (Figure 78, item 2), and lower clip bracket (Figure 78, item 4) over shaft and shaft bracket.

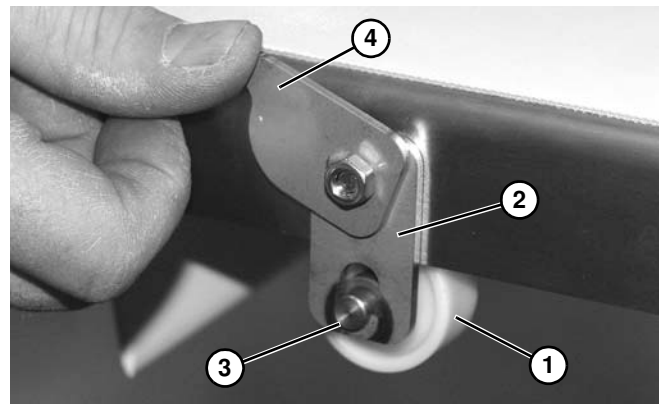

Figure 78

8. Tighten nut (Figure 79, item 1).

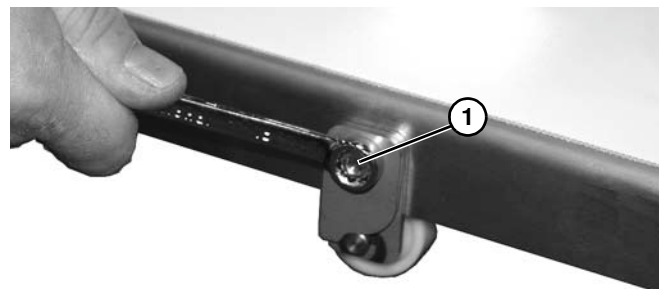
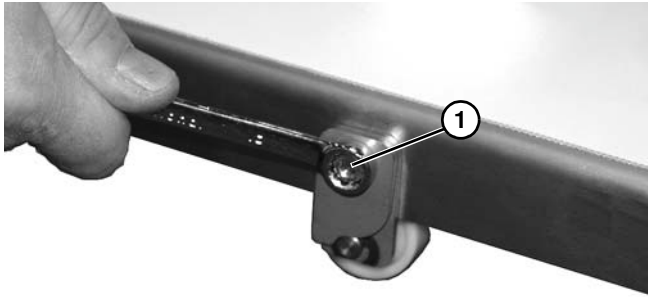

Figure 79

# Preventive Maintenance and Adjustment

## Flat Belt Returns over 152 mm Wide

1. Loosen nut (**Figure 80, item 1**).



**Figure 80**

2. Raise clip bracket (**Figure 81, item 1**) from shaft bracket (**Figure 81, item 2**) on conveyor.

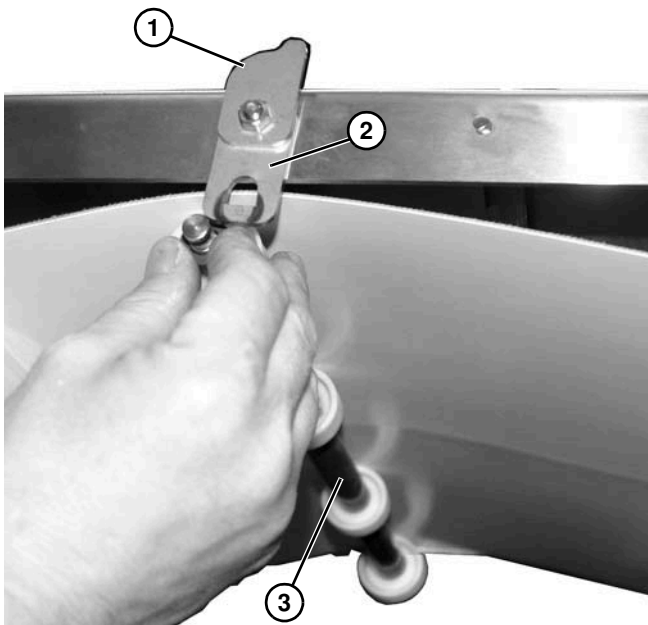

**Figure 81**

3. Remove roller assembly (**Figure 81, item 3**) from shaft brackets (**Figure 81, item 2**) on both sides of conveyor.
4. Disassemble spacer tubes (**Figure 82, item 1**), rollers (**Figure 82, item 2**), and end spacer tubes (**Figure 82, item 3**) from shaft (**Figure 82, item 4**).

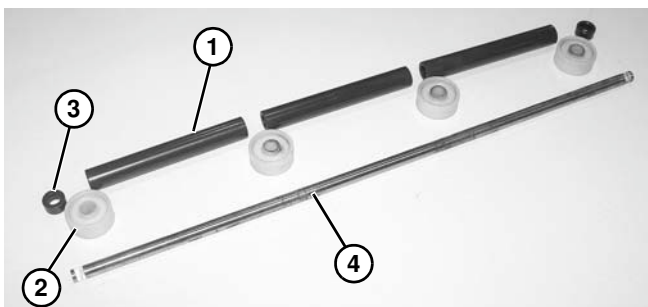
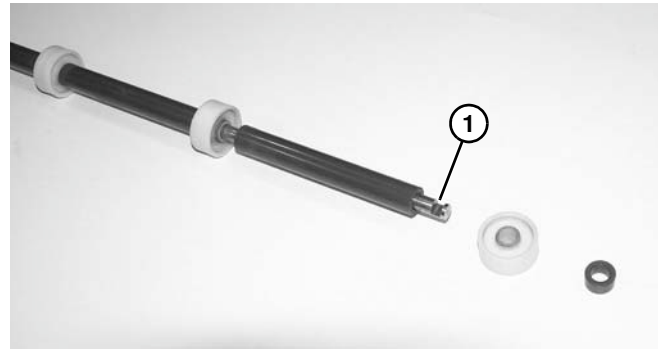

**Figure 82**

5. Replace damaged or worn parts.

### NOTE

*Note orientation of components and notch (**Figure 83, item 1**) on shaft before installing assembly. Notch will be facing down to attach into retainer plate on conveyor.*



**Figure 83**

6. Raise clip bracket (**Figure 84, item 1**) from shaft bracket (**Figure 84, item 2**) on conveyor.

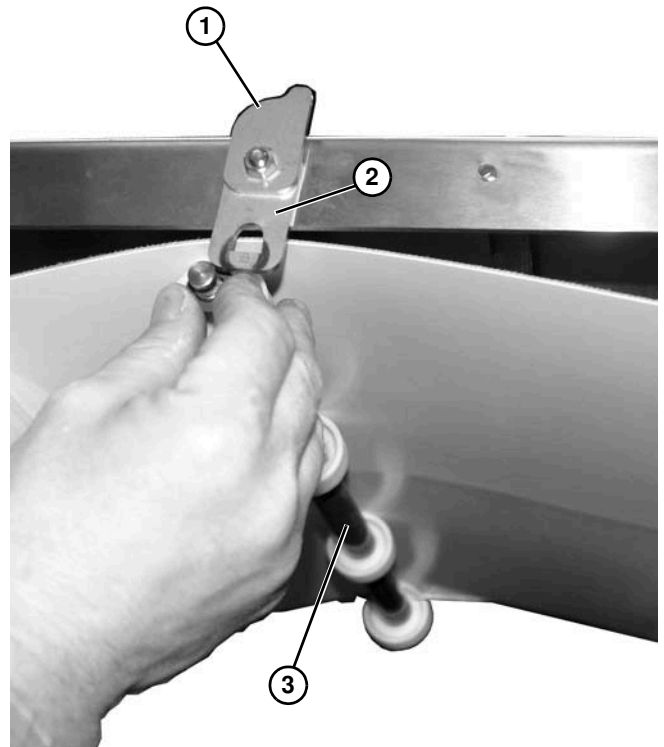

**Figure 84**

7. Install roller assembly (**Figure 84, item 3**) onto shaft brackets (**Figure 84, item 2**) on both sides of conveyor.

---

## Preventive Maintenance and Adjustment

---

8. Make certain notch (**Figure 85, item 1**) in shaft is inserted into shaft bracket (**Figure 85, item 2**), and lower clip bracket (**Figure 85, item 3**) over shaft and shaft bracket. Repeat on opposite side of conveyor.

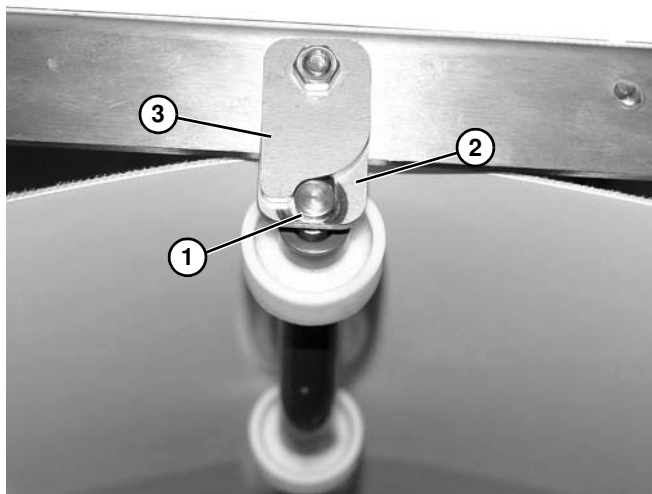

**Figure 85**

9. Tighten nut (**Figure 86, item 1**).

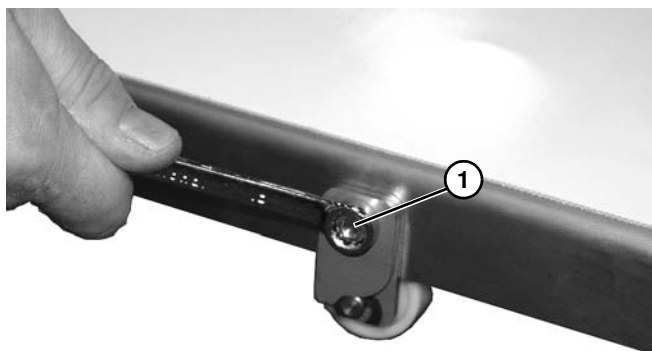
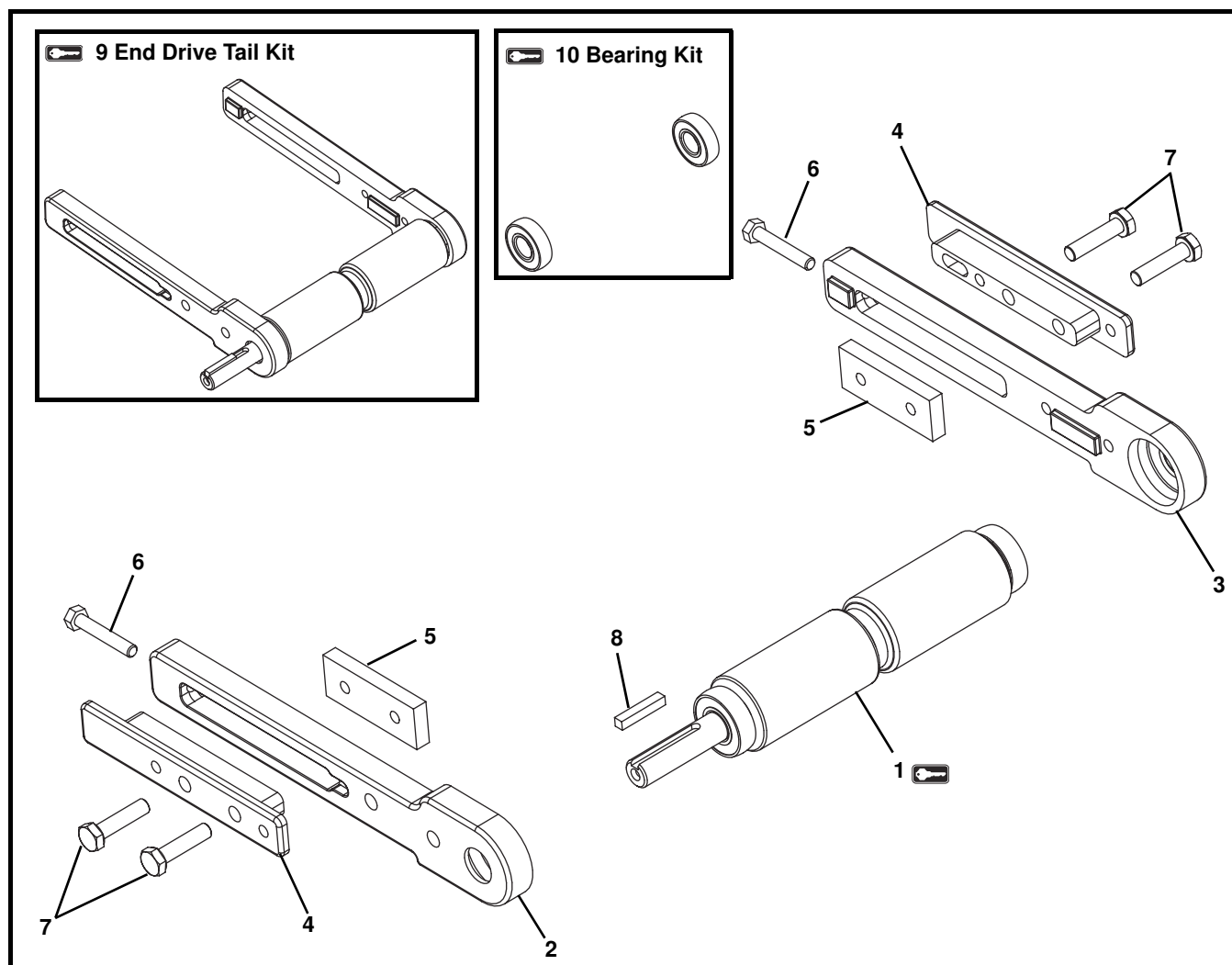



**Figure 86**

## NOTE

For replacement parts other than those shown in this section, contact an authorized Dorner distributor or Dorner directly. Recommended Critical Service Parts and Kits are identified by the Key Service Parts symbol . Dorner recommends keeping these parts on hand.

## End Drive Tail



Item	Part Number	Description
	531488- <u>WWW</u> -M	Drive Spindle Assembly
	531489- <u>WWW</u> -M	Dual Shaft Drive Spindle Assembly
2	530968	Head Plate, Right Hand
3	530969	Head Plate, Left Hand
4	530970	Clamping Block
5	530971	Locknut Plate
6	960530MSS	Hex Head Cap Screw, M5-0.80 x 30 mm
7	960625MSS	Hex Head Cap Screw, M6-1.00 x 25 mm
8	980422MSS	Square Key, 4 mm x 22 mm

Item	Part Number	Description
	531160- <u>WWW</u> -M	Drive Tail Kit for A & B Drive Position Conveyors (Includes Items 1, 2, 3, and 8)
	531161- <u>WWW</u> -M	Drive Tail Kit for C & D Drive Position Conveyors (Includes Items 1, 2, 3, and 8)
	531162- <u>WWW</u> -M	Dual Shaft Drive Tail Kit (Includes Items 1, 2, 3, and 8)
10	531155	Bearing Kit
<u>WWW</u> = Conveyor width reference in mm 0070, 0095, 0152, 0203, 0254, 0305, 0406, & 0457		
See Specifications chart on page 7 for conveyor belt widths.		
Service parts can be obtained through your distributor or directly from Dorner Mfg. Corp. (800) 397-8664 or customerservice@dorner.com		



# Service Parts

## Idler Tail

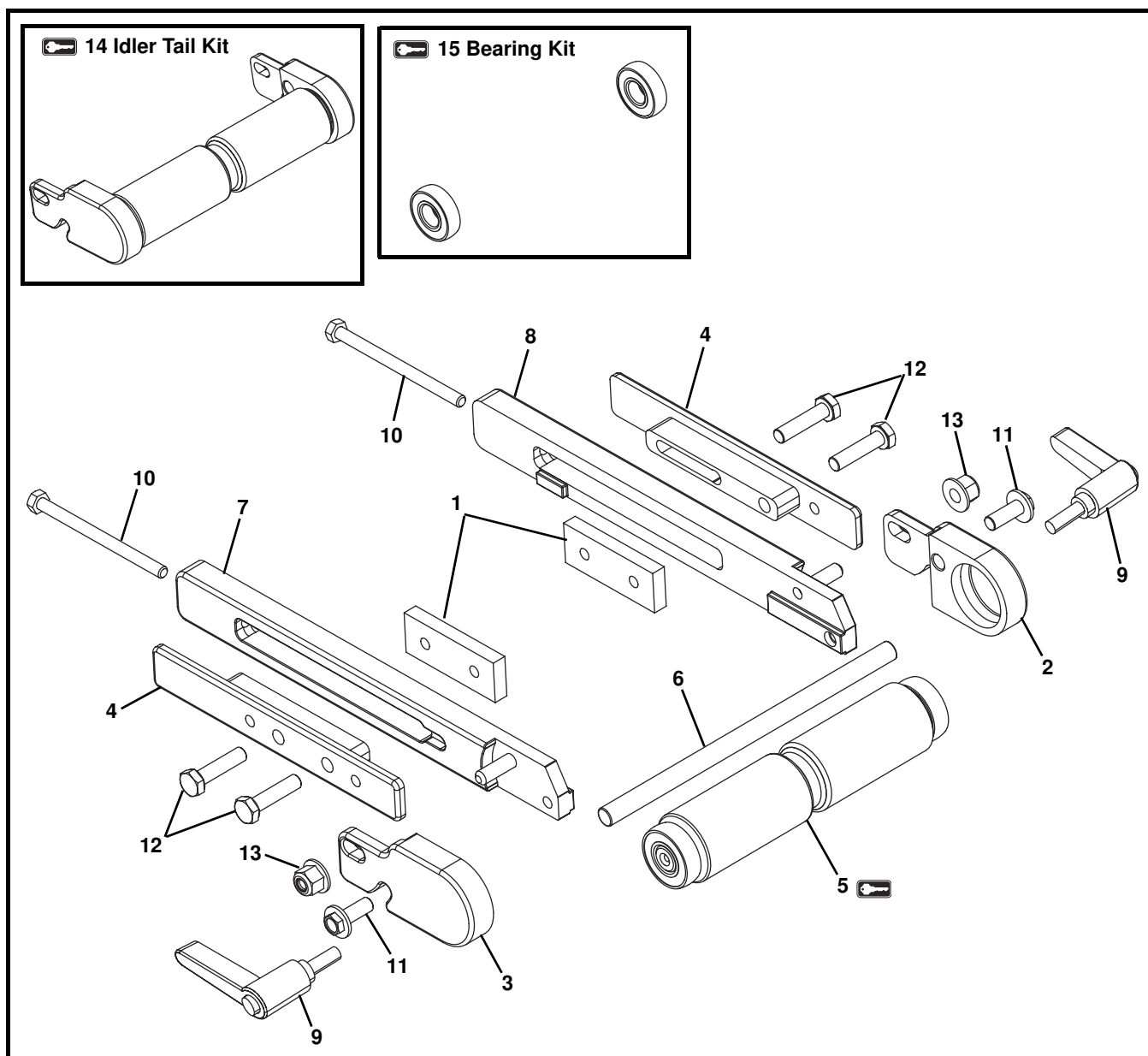

Item	Part Number	Description
1	530971	Locknut Plate
2	530973	Tip Up Plate, Right Hand
3	530974	Tip Up Plate, Left Hand
4	530982	Clamping Block
5	531487- <u>WWWW</u> -M	Idler Spindle Assembly
6	531147- <u>WWWW</u> -M	Round Shaft
7	531148-LH	Tension Headplate, Left Hand
8	531148-RH	Tension Headplate, Right Hand
9	807-3268	Handles for Tool-less Tip Up Tail only
10	960570MSS	Hex Head Cap Screw, M6-1.00 x 70 mm
11	960616MSSF	Flanged Hex Head Cap Screw, M6-1.00 x 16 mm

Item	Part Number	Description
12	960625MSS	Hex Head Cap Screw, M6-1.00 x 25 mm
13	990612MSS	Lock Nut, M6-1.00
14	531157- <u>WWWW</u> -M	Idler Tail Kit (Includes items 2, 3, and 5)
15	531155	Bearing Kit

WWWW = Conveyor width reference in mm 0070, 0095, 0152, 0203, 0254, 0305, 0406, & 0457

See Specifications chart on page 7 for conveyor belt widths.

Service parts can be obtained through your distributor or directly from Dorner Mfg. Corp. (800) 397-8664 or customerservice@dorner.com

## Frame

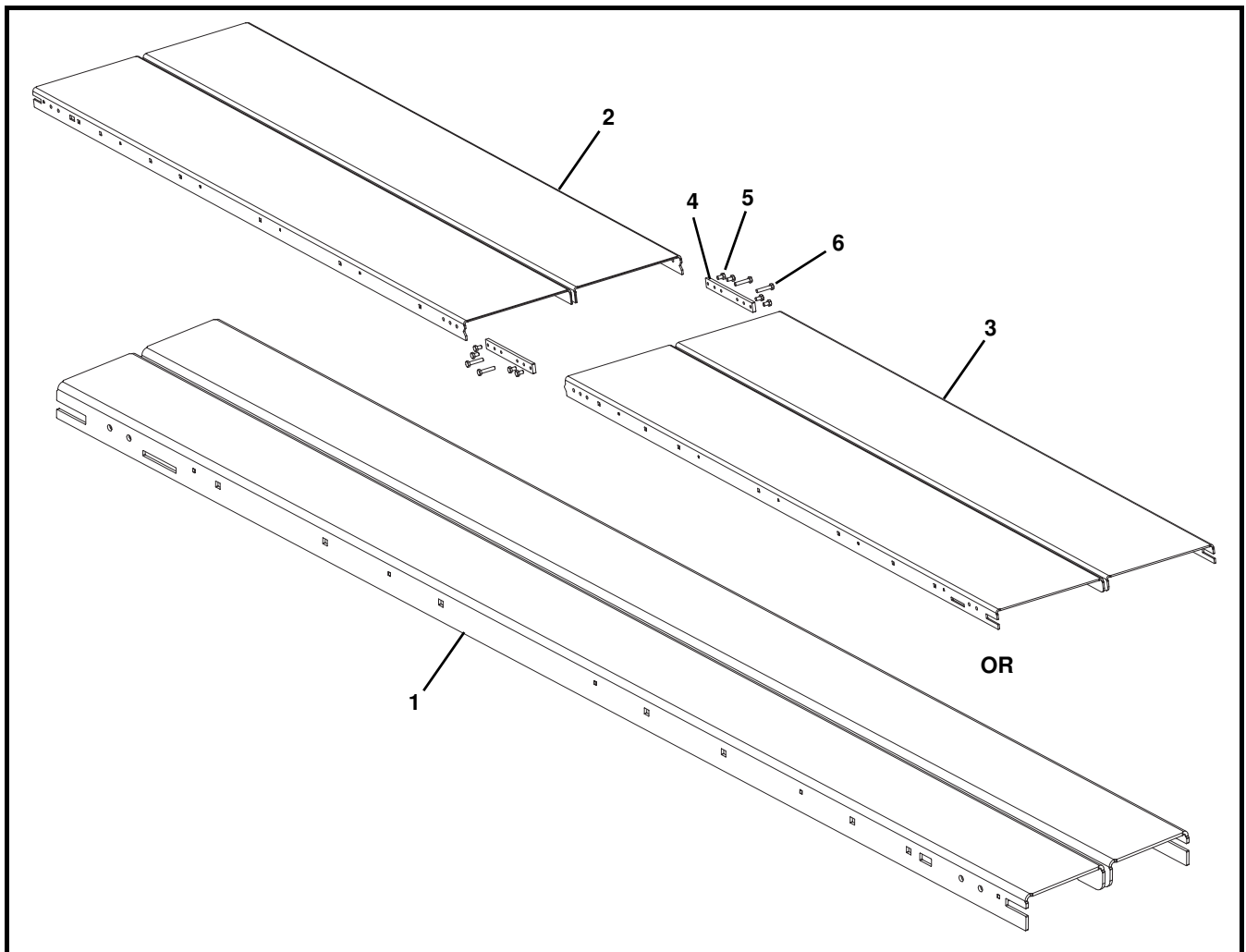

Item	Part Number	Description
1	530978- <u>WWWWW</u> - <u>LLLLL</u> -M	Frame Assembly for Single Piece Frame
2	531077- <u>WWWWW</u> - <u>LLLLL</u> -M	Drive End Frame Assembly for Multi Piece Frame
3	531078- <u>WWWWW</u> - <u>LLLLL</u> -M	Idler End Frame Assembly for Multi Piece Frame
4	531074	Connecting Bar for Multi Piece Frame only
5	960610MSS	Hex Head Cap Screw, M6-1.00 x 10 mm for Multi Piece Frame only

Item	Part Number	Description
6	960630MSS	Hex Head Cap Screw, M6-1.00 x 30 mm for Multi Piece Frame only
<u>WWWWW</u> = Conveyor width reference in mm 0070, 0095, 0152, 0203, 0254, 0305, 0406, & 0457		
<u>LLLLL</u> = Part length in mm.		
Example: Part length = 1000 mm <u>LLLLL</u> = 01000		
See Specifications chart on page 7 for conveyor belt widths and lengths.		
Service parts can be obtained through your distributor or directly from Dorner Mfg. Corp. (800) 397-8664 or <a href="mailto:customerservice@dorner.com">customerservice@dorner.com</a>		

# Service Parts

## 25 mm High Sides

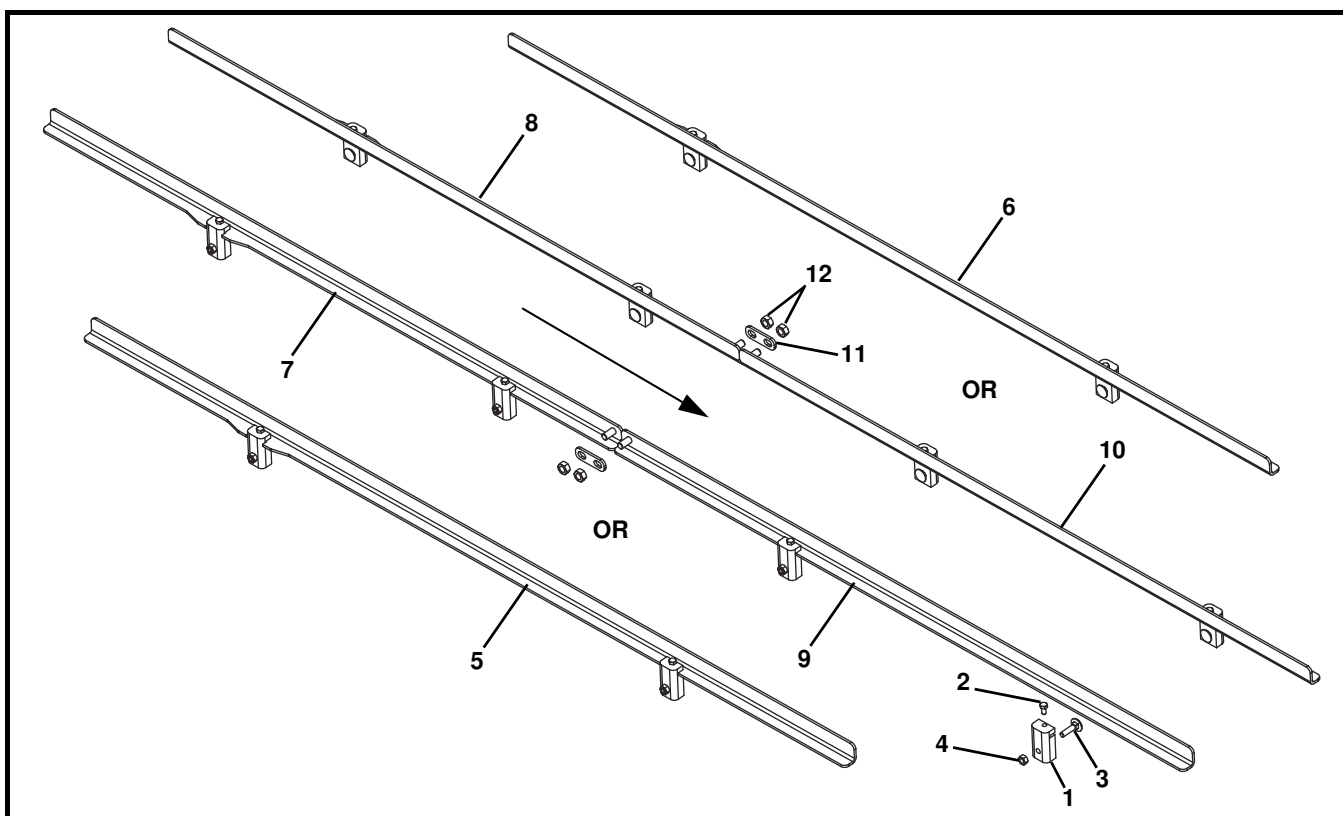

Item	Part Number	Description
1	531100	Mounting Block
2	960510MSS	Hex Head Cap Screw, M5-0.80 x 10 mm
3	900625MSS	Carriage Bolt, M6 x 25 mm
4	990601MSS	Nut, M6
5	531102-025- <u>LLLL</u> -M-RH	25 mm High Side for Single Piece Guides, Right Hand
6	531102-025- <u>LLLL</u> -M-LH	25 mm High Side for Single Piece Guides, Left Hand
7	531103-025- <u>LLLL</u> -M-RH	25 mm High Side for Multi Piece Guides, Infeed, Right Hand
8	531103-025- <u>LLLL</u> -M-LH	25 mm High Side for Multi Piece Guides, Infeed, Left Hand
9	531104-025- <u>LLLL</u> -M-RH	25 mm High Side for Multi Piece Guides, Discharge, Right Hand
10	531104-025- <u>LLLL</u> -M-LH	25 mm High Side for Multi Piece Guides, Discharge, Left Hand
11	516935	Guiding Connector Plate
12	990801MSS	Hex Nut, M8-1.25
<u>LLLL</u> = Part length in mm.		
Example: Part length = 1000 mm <u>LLLL</u> = 01000		
See Specifications chart on page 7 for conveyor belt lengths.		
Service parts can be obtained through your distributor or directly from Dorner Mfg. Corp. (800) 397-8664 or customerservice@dorner.com		



## 75 mm High Sides

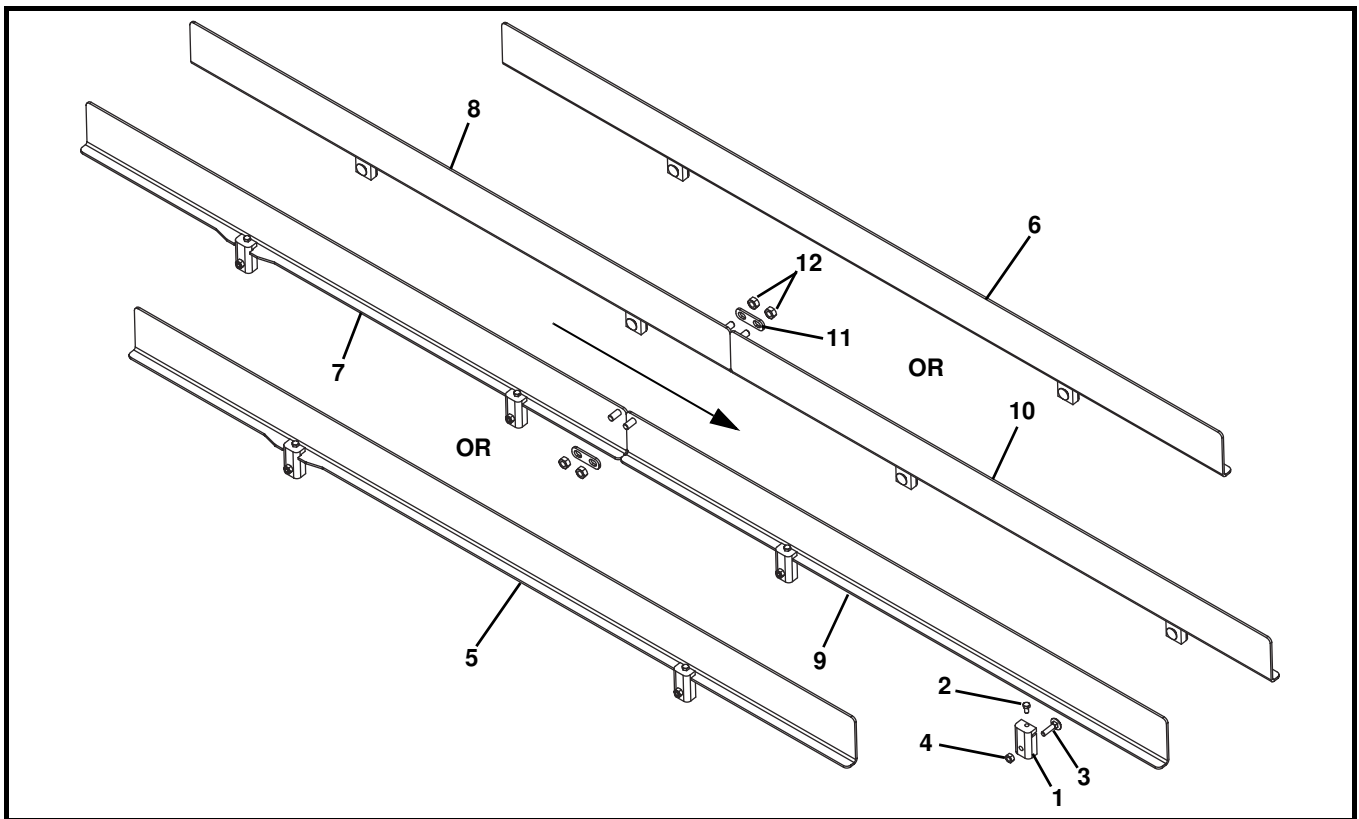

Item	Part Number	Description
1	531100	Mounting Block
2	960510MSS	Hex Head Cap Screw, M5-0.80 x 10 mm
3	900625MSS	Carriage Bolt, M6 x 25 mm
4	990601MSS	Nut, M6
5	531102-075- <u>LLLL</u> -M-RH	75 mm High Side for Single Piece Guides, Right Hand
6	531102-075- <u>LLLL</u> -M-LH	75 mm High Side for Single Piece Guides, Left Hand
7	531103-075- <u>LLLL</u> -M-RH	75 mm High Side for Multi Piece Guides, Infeed, Right Hand
8	531103-075- <u>LLLL</u> -M-LH	75 mm High Side for Multi Piece Guides, Infeed, Left Hand
9	531104-075- <u>LLLL</u> -M-RH	75 mm High Side for Multi Piece Guides, Discharge, Right Hand
10	531104-075- <u>LLLL</u> -M-LH	75 mm High Side for Multi Piece Guides, Discharge, Left Hand
11	516935	Guiding Connector Plate
12	990801MSS	Hex Nut, M8-1.25
<u>LLLL</u> = Part length in mm.		
Example: Part length = 1000 mm <u>LLLL</u> = 01000		
See Specifications chart on page 7 for conveyor belt lengths.		
Service parts can be obtained through your distributor or directly from Dorner Mfg. Corp. (800) 397-8664 or customerservice@dorner.com		

# Service Parts

## 152 mm High Sides

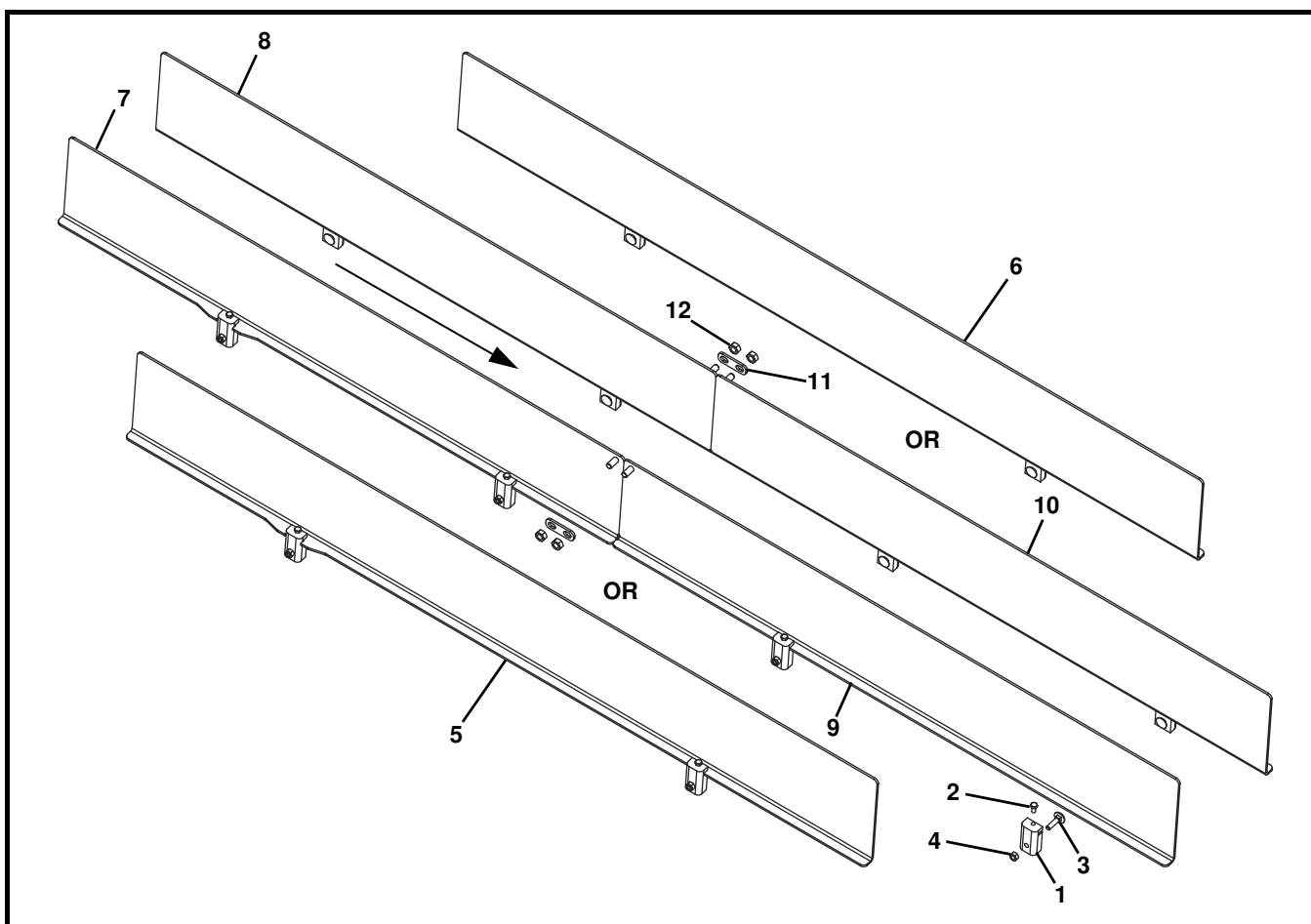

Item	Part Number	Description
1	531100	Mounting Block
2	960510MSS	Hex Head Cap Screw, M5-0.80 x 10 mm
3	900625MSS	Carriage Bolt, M6 x 25 mm
4	990601MSS	Nut, M6
5	531102-152- <u>LLLL</u> -M-RH	152 mm High Side for Single Piece Guides, Right Hand
6	531102-152- <u>LLLL</u> -M-LH	152 mm High Side for Single Piece Guides, Left Hand
7	531103-152- <u>LLLL</u> -M-RH	152 mm High Side for Multi Piece Guides, Infeed, Right Hand
8	531103-152- <u>LLLL</u> -M-LH	152 mm High Side for Multi Piece Guides, Infeed, Left Hand

Item	Part Number	Description
9	531104-152- <u>LLLL</u> -M-RH	152 mm High Side for Multi Piece Guides, Discharge, Right Hand
10	531104-152- <u>LLLL</u> -M-LH	152 mm High Side for Multi Piece Guides, Discharge, Left Hand
11	516935	Guiding Connector Plate
12	990801MSS	Hex Nut, M8-1.25

LLLL = Part length in mm.  
 Example: Part length = 1000 mm LLLL = 01000  
 See Specifications chart on page 7 for conveyor belt lengths.  
 Service parts can be obtained through your distributor or directly from Dorner Mfg. Corp. (800) 397-8664 or customerservice@dorner.com

## Fully Adjustable Guides

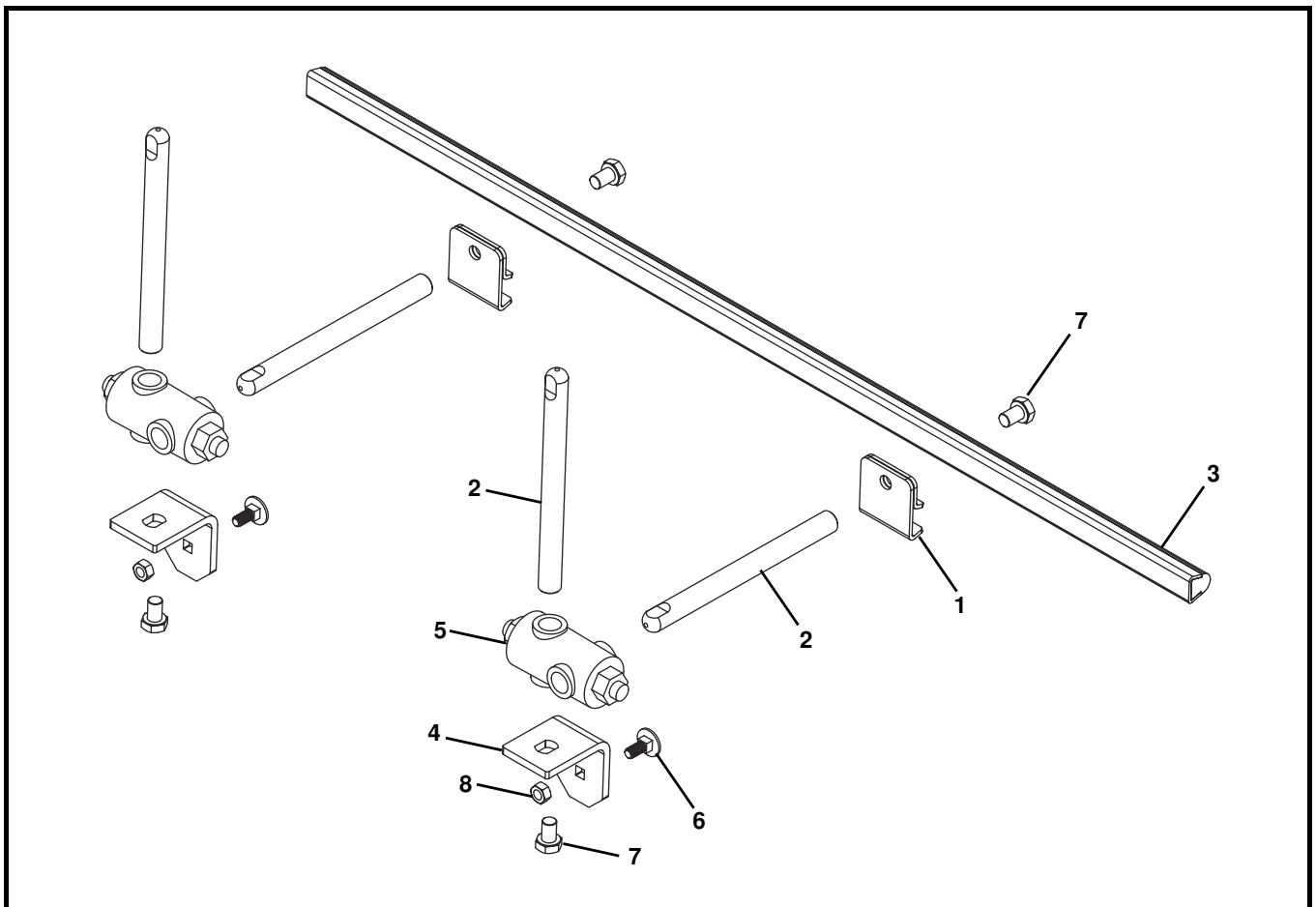

Item	Part Number	Description
1	531145	Guide Bracket
2	532300	Post
3	532167-LLLLL-M	Round Guide Rail
4	807-015	Rail Clamp
5	807-1387	Cross Block
6	900616MSS	Carriage Bolt, M6 x 16 mm
7	960812MSS	Hex Head Cap Screw, M8-1.25 x 12 mm
8	990601MSS	Nut, M6
LLLLL = Part length in mm.		
Example: Part length = 1000 mm LLLLL = 01000		
See Specifications chart on page 7 for conveyor belt lengths.		
Service parts can be obtained through your distributor or directly from Dorner Mfg. Corp. (800) 397-8664 or customerservice@dorner.com		

# Service Parts

## Tool-Less Fully Adjustable Guides

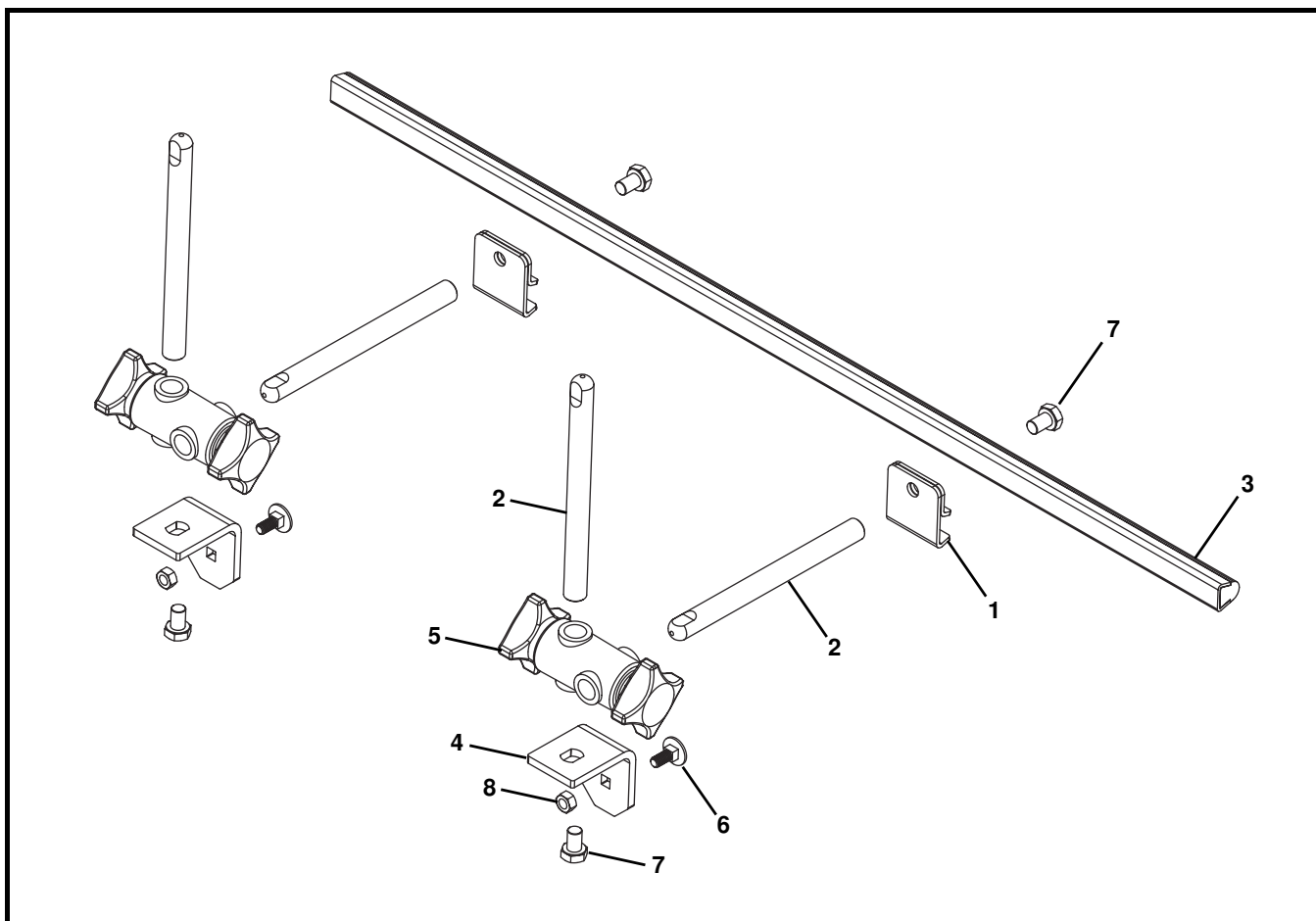

Item	Part Number	Description
1	531145	Guide Bracket
2	532300	Post
3	532167-LLLLL-M	Round Guide Rail
4	807-015	Rail Clamp
5	807-1470	Tool-less Cross Block
6	900616MSS	Carriage Bolt, M6 x 16 mm
7	960812MSS	Hex Head Cap Screw, M8-1.25 x 12 mm
8	990601MSS	Nut, M6
LLLLL = Part length in mm.		
Example: Part length = 1000 mm LLLLL = 01000		
See Specifications chart on page 7 for conveyor belt lengths.		
Service parts can be obtained through your distributor or directly from Dorner Mfg. Corp. (800) 397-8664 or customerservice@dorner.com		

## 25 mm Cleated High Sides

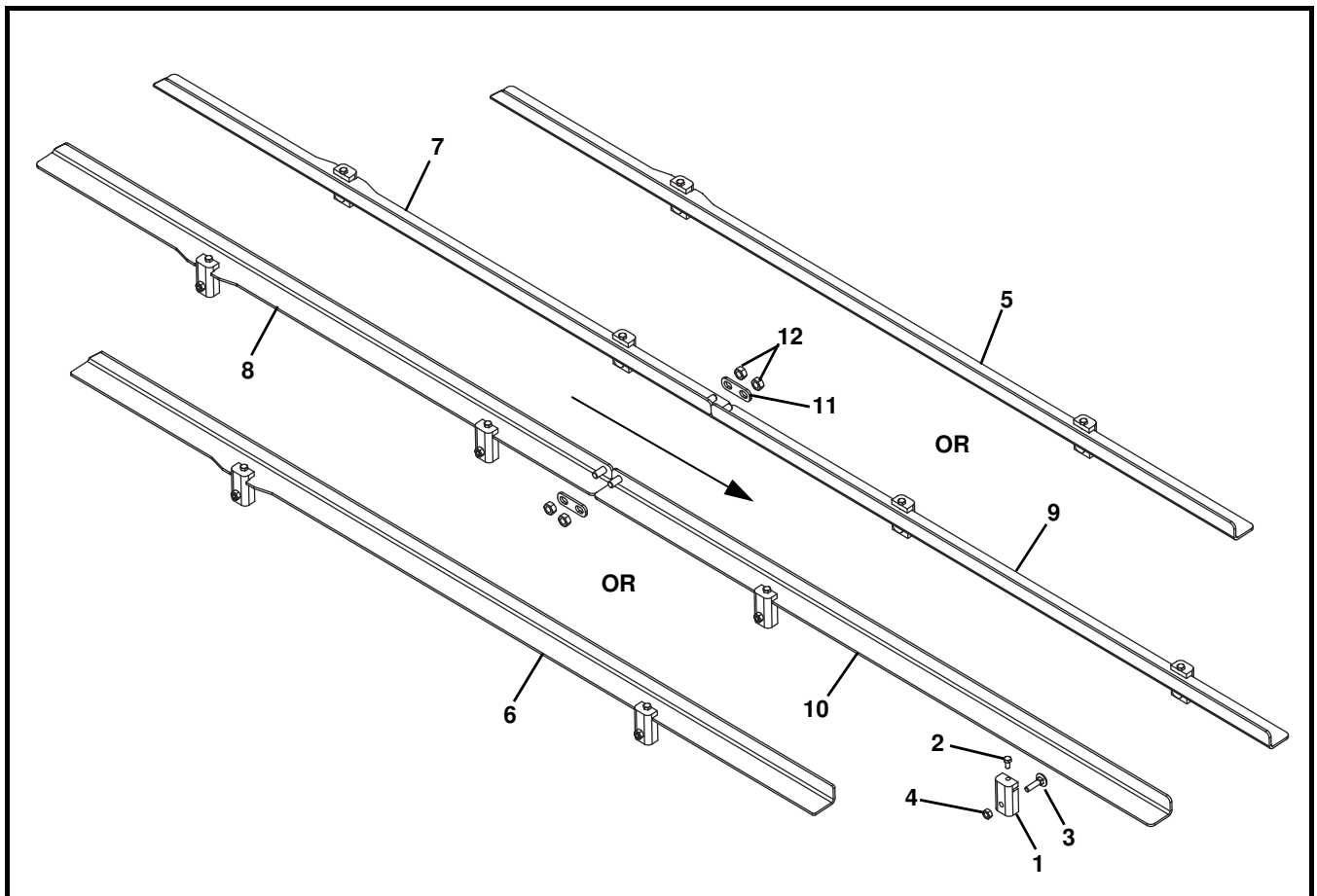

Item	Part Number	Description
1	531100	Mounting Block
2	960510MSS	Hex Head Cap Screw, M5-0.80 x 10 mm
3	900625MSS	Carriage Bolt, M6 x 25 mm
4	990601MSS	Nut, M6
5	531144-025- <u>LLLLL</u> -M-LH	25 mm Cleated High Side for Single Piece Guides, Left Hand
6	531144-025- <u>LLLLL</u> -M-RH	25 mm Cleated High Side for Single Piece Guides, Right Hand
7	531140-025- <u>LLLLL</u> -M-LH	25 mm Cleated High Side for Infeed section, Infeed, Left Hand
8	531140-025- <u>LLLLL</u> -M-RH	25 mm Cleated High Side for Infeed section, Infeed, Right Hand

Item	Part Number	Description
9	531141-025- <u>LLLLL</u> -M-LH	25 mm Cleated High Side for Discharge section, Discharge, Left Hand
10	531141-025- <u>LLLLL</u> -M-RH	25 mm Cleated High Side for Discharge section, Discharge, Right Hand
11	516935	Guiding Connector Plate
12	990801MSS	Hex Nut, M8-1.25

LLLLL = Part length in mm.

Example: Part length = 1000 mm LLLLL = 01000

See Specifications chart on page 7 for conveyor belt lengths.

Service parts can be obtained through your distributor or directly from Dorner Mfg. Corp. (800) 397-8664 or [customerservice@dorner.com](mailto:customerservice@dorner.com)

# Service Parts

## 75 mm Cleated High Sides

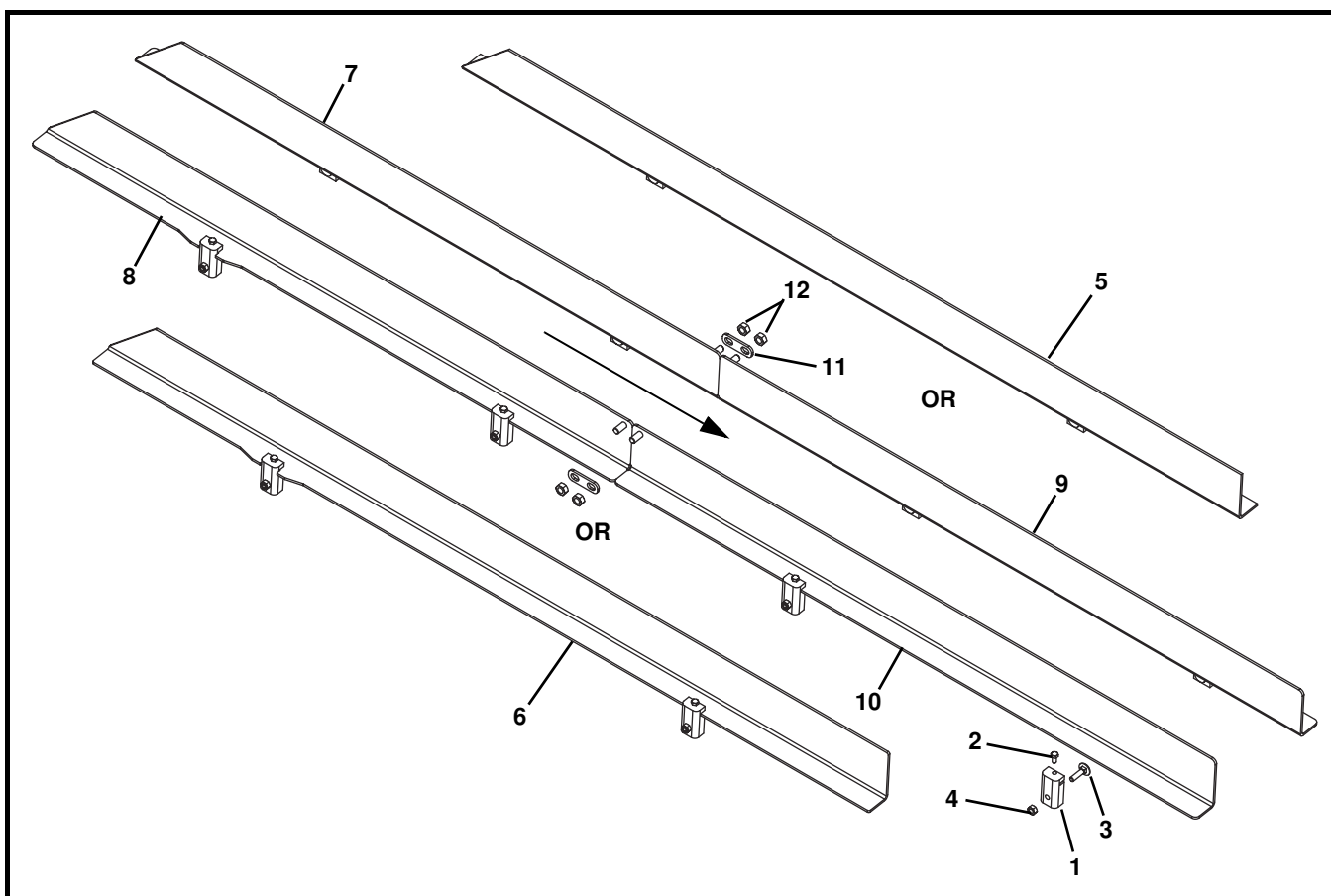

Item	Part Number	Description
1	531100	Mounting Block
2	960510MSS	Hex Head Cap Screw, M5-0.80 x 10 mm
3	900625MSS	Carriage Bolt, M6 x 25 mm
4	990601MSS	Nut, M6
5	531144-075- <u>LLLL</u> -M-LH	75 mm Cleated High Side for Single Piece Guides, Left Hand
6	531144-075- <u>LLLL</u> -M-RH	75 mm Cleated High Side for Single Piece Guides, Right Hand
7	531140-075- <u>LLLL</u> -M-LH	75 mm Cleated High Side for Infeed section, Infeed, Left Hand
8	531140-075- <u>LLLL</u> -M-RH	75 mm Cleated High Side for Infeed section, Infeed, Right Hand

Item	Part Number	Description
9	531141-075- <u>LLLL</u> -M-LH	75 mm Cleated High Side for Discharge section, Discharge, Left Hand
10	531141-075- <u>LLLL</u> -M-RH	75 mm Cleated High Side for Discharge section, Discharge, Right Hand
11	516935	Guiding Connector Plate
12	990801MSS	Hex Nut, M8-1.25
<u>LLLL</u> = Part length in mm.		
Example: Part length = 1000 mm <u>LLLL</u> = 01000		
See Specifications chart on page 7 for conveyor belt lengths.		
Service parts can be obtained through your distributor or directly from Dorner Mfg. Corp. (800) 397-8664 or customerservice@dorner.com		

## 152 mm Cleated High Sides

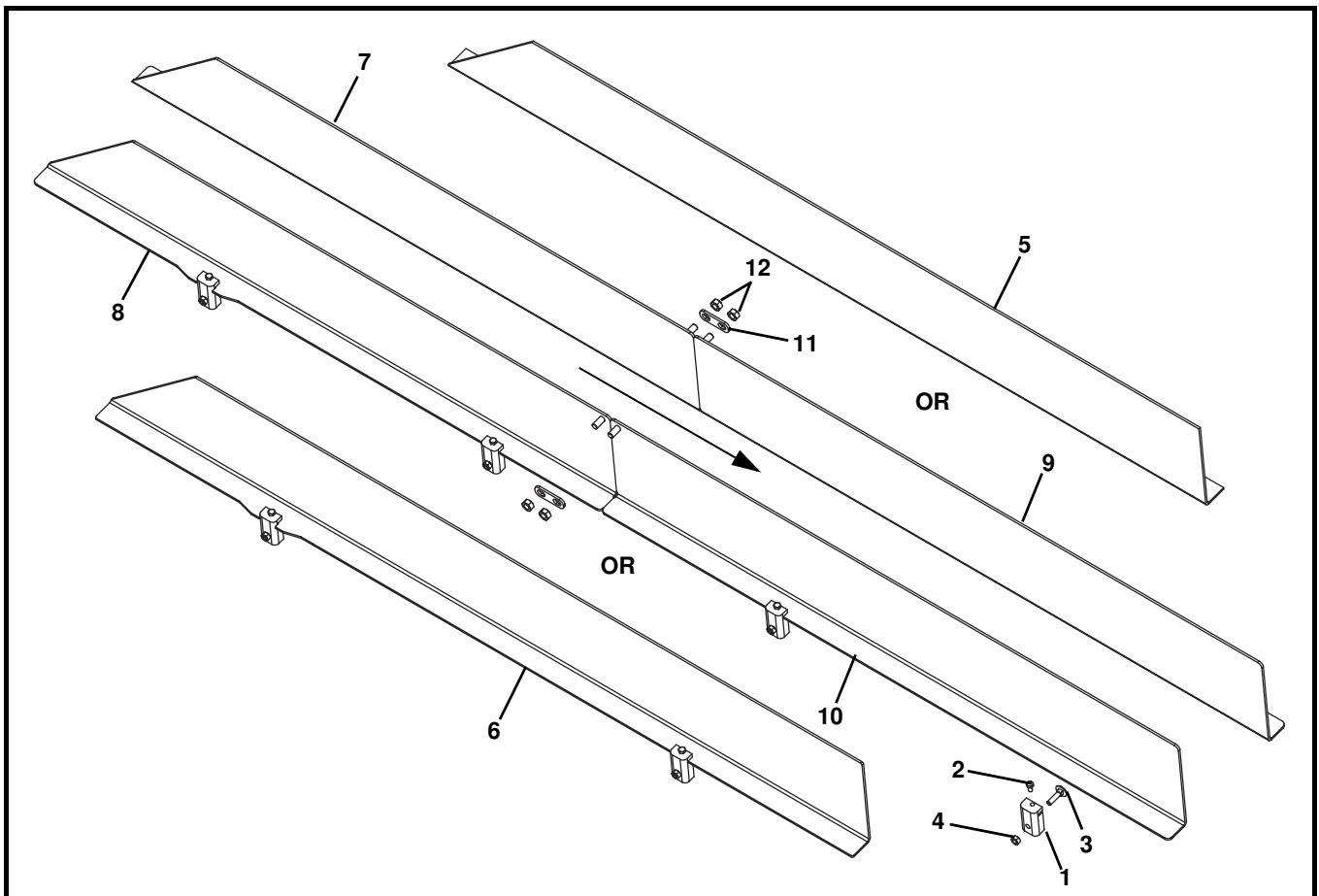

Item	Part Number	Description
1	531100	Mounting Block
2	960510MSS	Hex Head Cap Screw, M5-0.80 x 10 mm
3	900625MSS	Carriage Bolt, M6 x 25 mm
4	990601MSS	Nut, M6
5	531144-152- <u>LLLLL</u> -M-LH	152 mm Cleated High Side for Single Piece Guides, Left Hand
6	531144-152- <u>LLLLL</u> -M-RH	152 mm Cleated High Side for Single Piece Guides, Right Hand
7	531140-152- <u>LLLLL</u> -M-LH	152 mm Cleated High Side for Infeed section, Infeed, Left Hand
8	531140-152- <u>LLLLL</u> -M-RH	152 mm Cleated High Side for Infeed section, Infeed, Right Hand

Item	Part Number	Description
9	531141-152- <u>LLLLL</u> -M-LH	152 mm Cleated High Side for Discharge section, Discharge, Left Hand
10	531141-152- <u>LLLLL</u> -M-RH	152 mm Cleated High Side for Discharge section, Discharge, Right Hand
11	516935	Guiding Connector Plate
12	990801MSS	Hex Nut, M8-1.25

LLLLL = Part length in mm.  
Example: Part length = 1000 mm LLLLL = 01000  
See Specifications chart on page 7 for conveyor belt lengths.  
Service parts can be obtained through your distributor or directly from Dorner Mfg. Corp. (800) 397-8664 or customerservice@dorner.com

## Service Parts

### Return Rollers for Flat Belt Conveyors 70 mm - 152 mm & Cleated Belt Conveyors

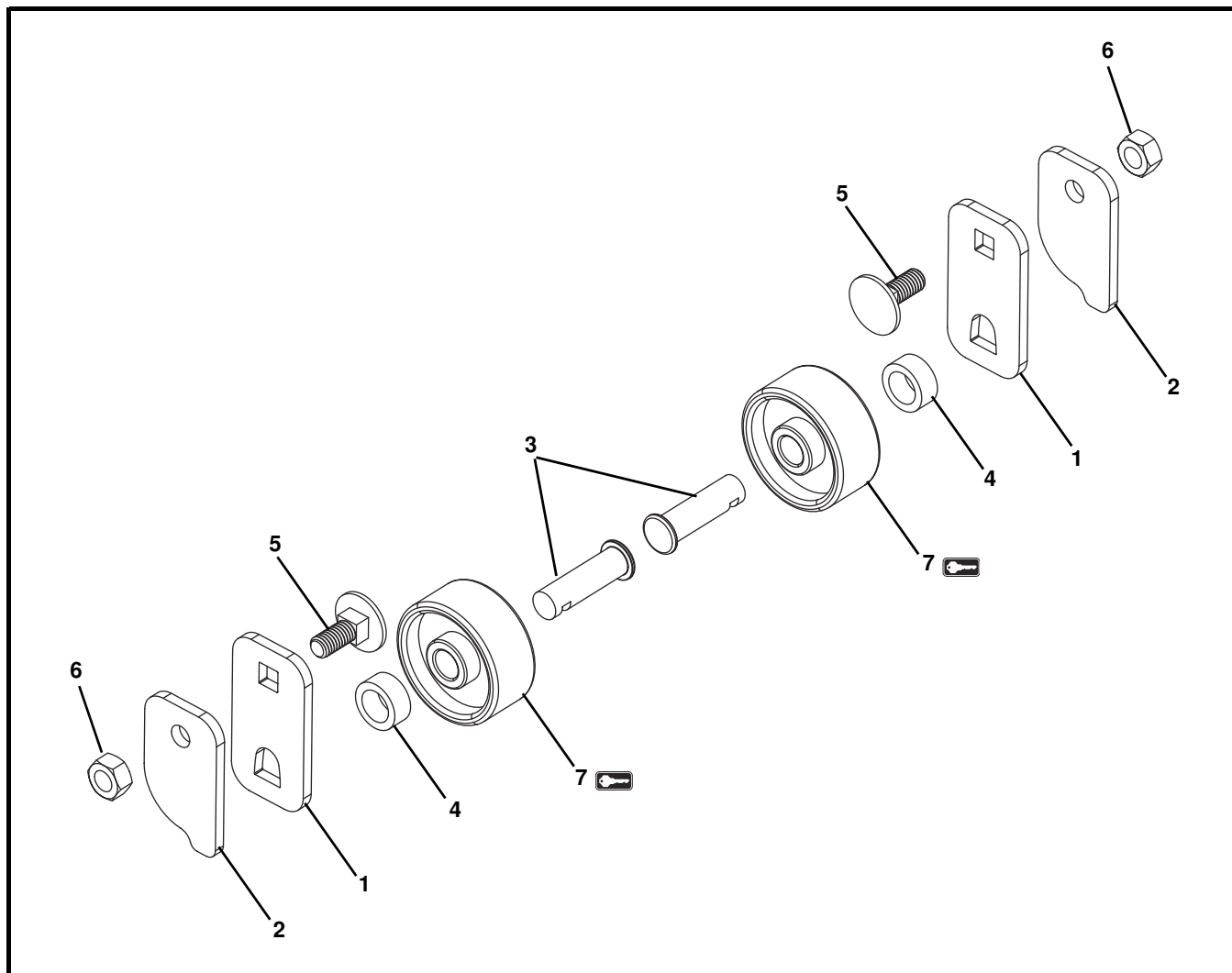

Item	Part Number	Description
1	531065	Shaft Bracket
2	531066	Clip Bracket
3	531067	Stub Shaft
4	531069-0006	Spacer Tube
5	807-4103	Carriage Bolt, M6 x 16 mm
6	990601MSS	Nut, M6
7	FAFR-35	Roller

 Service parts can be obtained through your distributor or directly from Dorner Mfg. Corp. (800) 397-8664 or customerservice@dorner.com



## Return Rollers for Flat Belt Conveyors Over 152 mm Wide

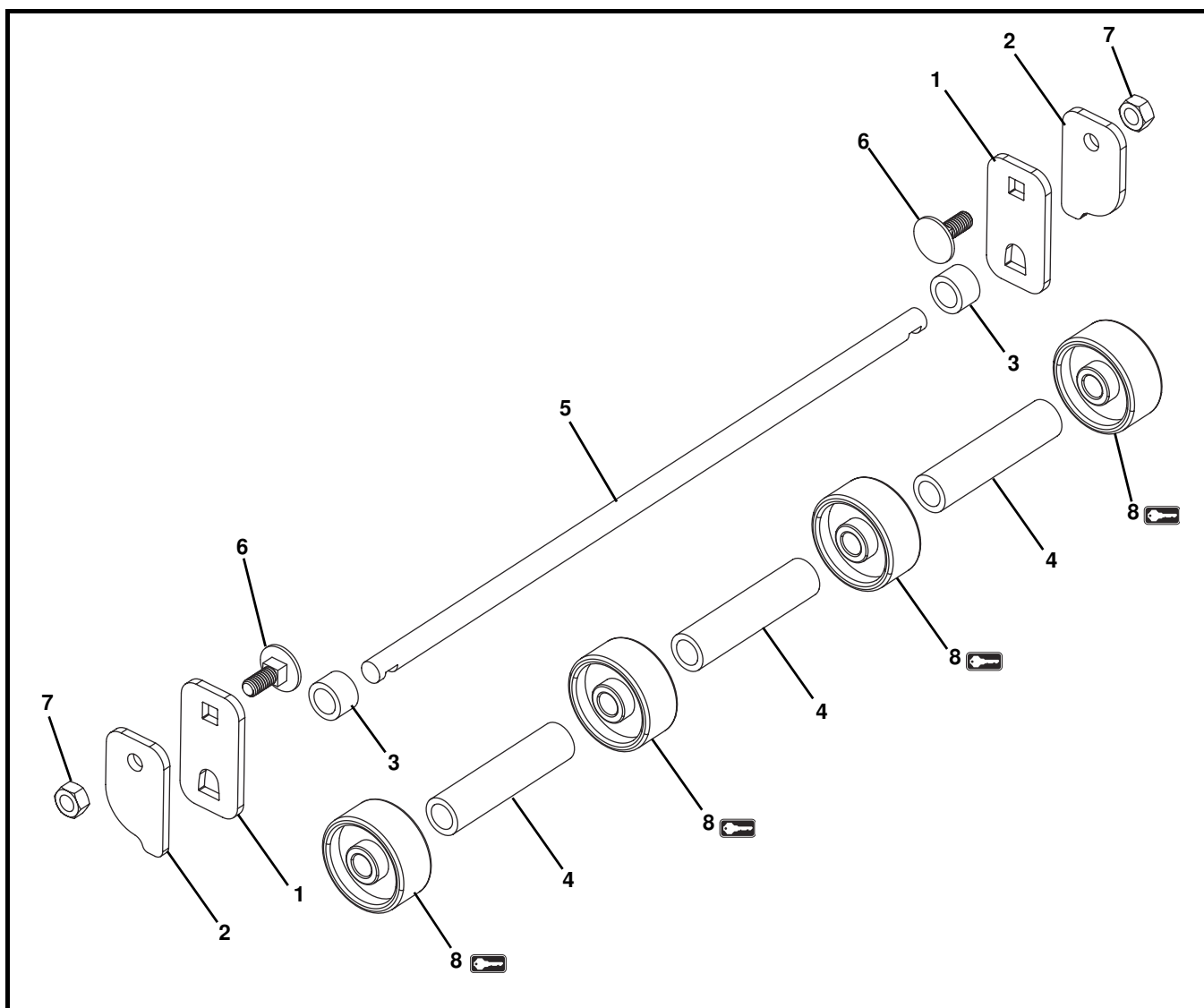

Item	Part Number	Description
1	531065	Shaft Bracket
2	531066	Clip Bracket
3	531069-0009	End Spacer Tube
4	531069- <u>LLLL</u> -M	Spacer Tube
5	531070- <u>WWWW</u> -M	Shaft
6	807-4103	Carriage Bolt, M6 x 16 mm
7	990601MSS	Nut, M6
8	FAFR-35	Roller

LLLL = Part length in mm.

Example: Part length = 650 mm LLLL = 00650

WWWW = Conveyor width reference in mm 0070, 0095, 0152, 0203, 0254, 0305, 0406, & 0457

See Specifications chart on page 7 for conveyor belt lengths and widths.

Service parts can be obtained through your distributor or directly from Dorner Mfg. Corp. (800) 397-8664 or [customerservice@dorner.com](mailto:customerservice@dorner.com)

# Service Parts

## Table Top Mounting Brackets For Flat Belt Conveyors

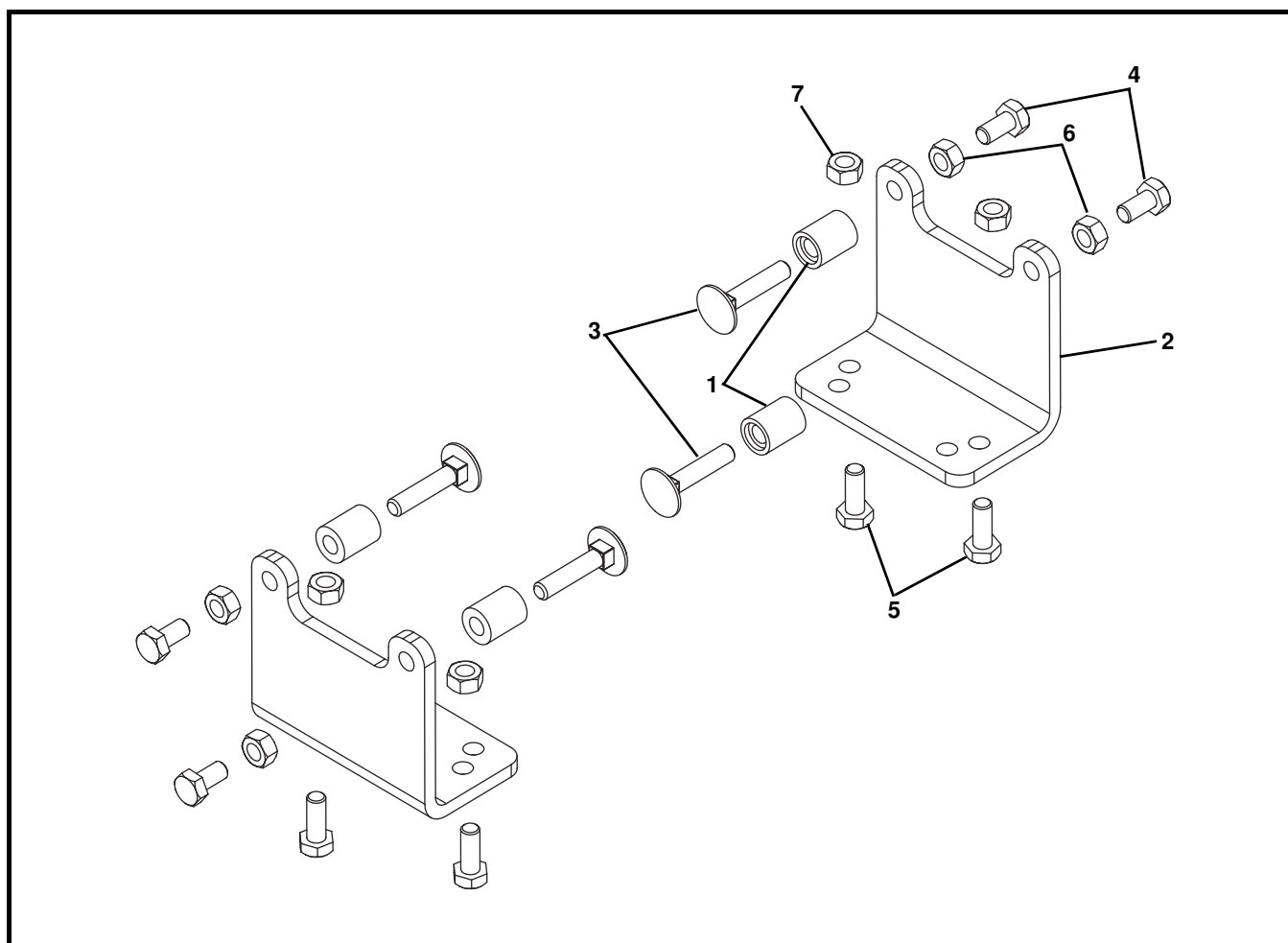

Item	Part Number	Description
1	531092	Spacer (conveyor frame mount)
2	531149	Bracket
3	900630MSS	Carriage Bolt, M6 x 30 mm (conveyor frame mount)
4	960612MSS	Hex Head Cap Screw, M6-1.00 x 12 mm (conveyor tail mount)
5	960616MSS	Hex Head Cap Screw, M6-1.00 x 16 mm
6	990601MSS	Nut, M6 (conveyor frame mount)
7	990601MSS	Nut, M6
Service parts can be obtained through your distributor or directly from Dorner Mfg. Corp. (800) 397-8664 or customerservice@dorner.com		

## Table Top Mounting Brackets For Cleated Belt Conveyors

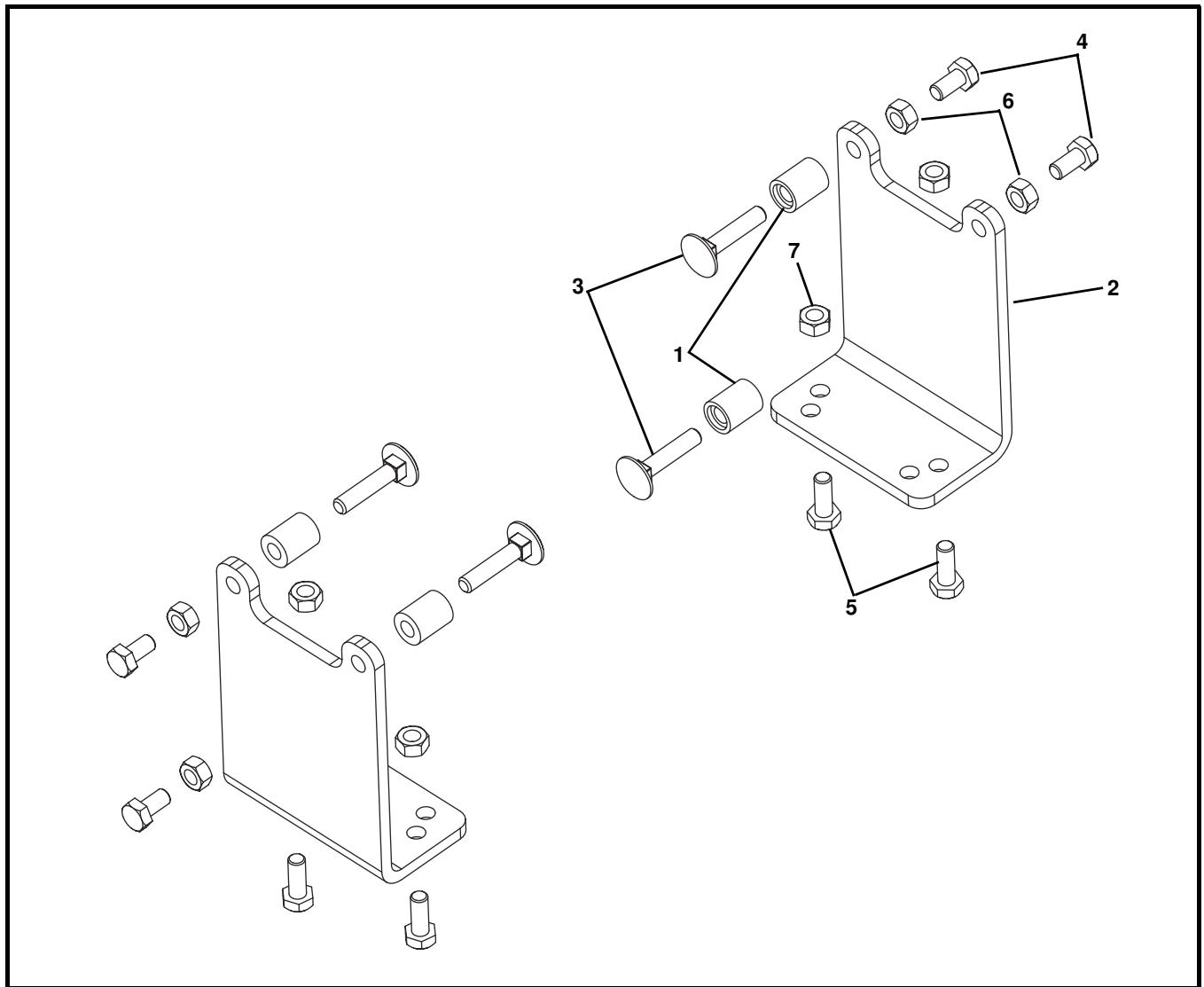

Item	Part Number	Description
1	531092	Spacer (conveyor frame mount)
2	531117	Bracket
3	900630MSS	Carriage Bolt, M6 x 30 mm (conveyor frame mount)
4	960612MSS	Hex Head Cap Screw, M6-1.00 x 12 mm (conveyor tail mount)
5	960616MSS	Hex Head Cap Screw, M6-1.00 x 16 mm
6	990601MSS	Nut, M6 (conveyor frame mount)
7	990601MSS	Nut, M6
Service parts can be obtained through your distributor or directly from Dorner Mfg. Corp. (800) 397-8664 or customerservice@dorner.com		

---

# Service Parts

---

## Configuring Conveyor Belt Part Number

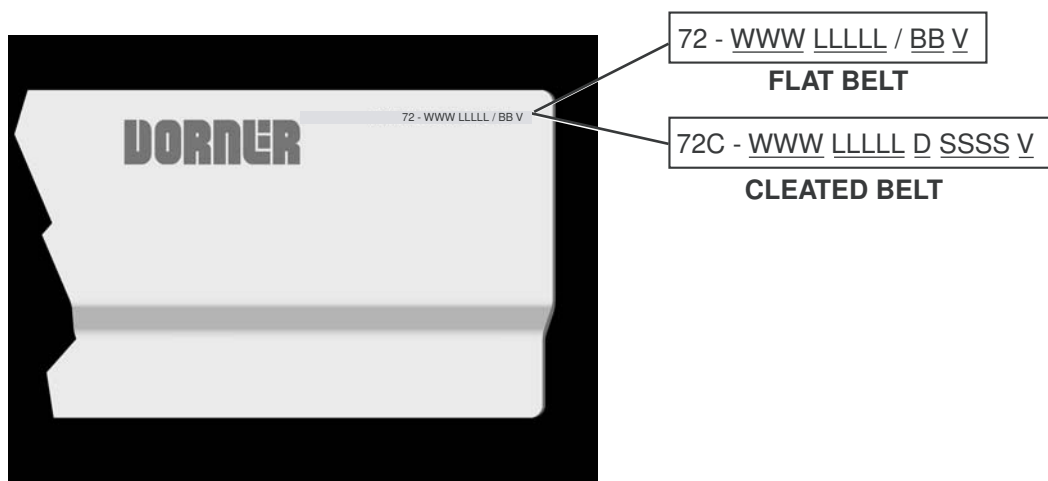

*Figure 87*

### Flat Belt Part Number Configuration

Refer to model number on the conveyor frame (**Figure 87**). From the model number determine the conveyor width (WWW), length (LLLLL) and belt type (BB). Use data to configure belt part number as indicated below. \*Add “V” for v-guided belts or add “VG” for 06, 08, 57, 59, and 64 v-guided belt types.

**72-WWW LLLLL / BB V\***  
**72-\_\_\_\_\_ / \_\_\_\_\_ V\***  
(Fill In)

### Cleated Belt Part Number Configuration

Refer to model number on the conveyor frame (**Figure 87**). From the model number determine the conveyor width (WWW), length (LLLLL), cleat type (B) and cleat spacing (SSSS). Use data to configure belt part number as indicated below. \*Add “V” for v-guided belts.

**72C-WWW LLLLL B SSSS V\***  
**72C-\_\_\_\_\_ V\***  
(Fill In)



# Return Policy

Returns must have prior written factory authorization or they will not be accepted. Items that are returned to Dorner without authorization will not be credited nor returned to the original sender. When calling for authorization, please have the following information ready for the Dorner factory representative or your local distributor:

1. Name and address of customer.
2. Dorner part number(s) of item(s) being returned.
3. Reason for return.
4. Customer's original order number used when ordering the item(s).
5. Dorner or distributor invoice number. Include part serial number if available.

A representative will discuss action to be taken on the returned items and provide a Returned Materials Authorization (RMA) number for reference. RMA will automatically close 30 days after being issued. To get credit, items must be new and undamaged. There will be a return charge on all items returned for credit, where Dorner was not at fault. It is the customer's responsibility to prevent damage during return shipping. Damaged or modified items will not be accepted. The customer is responsible for return freight.

	Product Type								
	Standard Products								Engineered to order parts
Product Line	Conveyors	Gearmotors & Mounting Packages	Support Stands	Accessories	Spare Parts (non-belt)	Spare Belts - Standard Flat Fabric	Spare Belts - Cleated & Spec. Fabric	Spare Belts - Plastic Chain	All equipment and parts
1100 Series	30% return fee for all products except: 50% return fee for conveyors with modular belt, cleated belt or speciality belts  All Electrical items are assigned original manufacturers return policy.						non-returnable		case-by-case
2200 Series									
3200 Series									
Pallet Systems									
FlexMove/SmartFlex									
GAL Series									
All Electrical									
7100 Series	50% return fee for all products								
7200/7300 Series									
AquaGard 7350 Series Version 2									
GES Series									
AquaGard 7350/7360 Series	non-returnable								
AquaPruf Series									

Returns will not be accepted after 60 days from original invoice date. The return charge covers inspection, cleaning, disassembly, disposal and reissuing of components to inventory. If a replacement is needed prior to evaluation of returned item, a purchase order must be issued. Credit (if any) is issued only after return and evaluation is complete.

Dorner has representatives throughout the world. Contact Dorner for the name of your local representative. Our Customer Service Team will gladly help with your questions on Dorner products.

For a copy of Dorner's Warranty, contact Dorner, an authorized sales channel or visit our website: [www.dorner.com](http://www.dorner.com).

For replacement parts, contact an authorized Dorner Service Center or the factory.

[www.dorner.com](http://www.dorner.com)



© Dorner Mfg. Corp. 2021. All Rights Reserved.



## Dorner – North & South America

### Dorner – U.S.A.

#### Headquarters

975 Cottonwood Ave  
Hartland, WI 53029, USA  
(800) 397-8664  
(262) 367-7600  
[info@dorner.com](mailto:info@dorner.com)

### Dorner – Canada

100-5515 North Service Road  
Burlington, Ontario L7L 6G6  
Canada  
(289) 208-7306  
[info@dorner.com](mailto:info@dorner.com)

### Dorner – Latin America

Carretera a Nogales #5297, Nave 11.  
Parque Industrial Nogales  
Zapopan, Jalisco C.P. 45222 México  
+52.33.30037400 | [info.latinamerica@dorner.com](mailto:info.latinamerica@dorner.com)

## Dorner – Europe

### Dorner – Germany

Karl-Heinz-Beckurts-Straße 7  
52428 Jülich,  
Germany  
+49 (0) 2461/93767-0  
[info.europe@dorner.com](mailto:info.europe@dorner.com)

### Dorner – France

8 rue des Frères Caudron  
78140 Velizy-Villacoublay  
France  
+33 (0)1 84 73 24 27  
[info.france@dorner.com](mailto:info.france@dorner.com)

## Dorner – Asia

128 Jalan Permatang Damar Laut, Bayan Lepas 11960  
Penang, Malaysia  
+604-626-2948 | [info.asia@dorner.com](mailto:info.asia@dorner.com)